



Thermistor motor protection relay Device for warning and switching-off 22.5 mm enclosure Spring-type terminal 1 NO contact + 1 CO contact US = 24 V-240 V AC/DC Manual/Auto/Remote reset with ATEX approval 3 LEDs (READY/WARNING/TRIPPED) Safe galvanic isolation Test/reset button Wire break monitoring Short circuit monitoring non-volatile 2 separate PTC sensor circuits

| | |
|---|---|
| product brand name | SIRIUS |
| product category | SIRIUS 3RN2 thermistor motor protection |
| product designation | Thermistor motor protection relay |
| design of the product | Standard evaluation unit with ATEX approval and 2 sensor circuits for warning and disconnection, open-circuit and short-circuit detection in both sensor circuits, safe disconnection, non-volatile |
| product type designation | 3RN2 |
| General technical data | |
| product function | thermistor motor protection |
| display version LED | Yes |
| insulation voltage for overvoltage category III according to IEC 60664 with degree of pollution 3 rated value | 300 V |
| degree of pollution | 3 |
| surge voltage resistance rated value | 6 kV |
| maximum permissible voltage for safe isolation | |
| • between auxiliary and auxiliary circuit | 300 V |
| • between control and auxiliary circuit | 300 V |
| protection class IP | IP20 |
| shock resistance according to IEC 60068-2-27 | 11g / 15 ms |
| vibration resistance according to IEC 60068-2-6 | 10 ... 55 Hz: 0.35 mm |
| mechanical service life (switching cycles) typical | 10 000 000 |
| electrical endurance (switching cycles) at AC-15 at 230 V typical | 100 000 |
| thermal current of the switching element with contacts maximum | 5 A |
| reference code according to IEC 81346-2 | K |
| Substance Prohibitance (Date) | 05/28/2009 |
| Product Function | |
| product function | |
| • error memory | Yes |
| • dynamic open-circuit detection | Yes |
| • external reset | Yes |
| • auto-RESET | Yes |
| • manual RESET | Yes |
| Control circuit/ Control | |
| type of voltage of the control supply voltage | AC/DC |
| control supply voltage at AC | |
| • at 50 Hz rated value | 24 ... 240 V |
| • at 60 Hz rated value | 24 ... 240 V |
| control supply voltage at DC | |

| | |
|---|--|
| <ul style="list-style-type: none"> • rated value | 24 ... 240 V |
| operating range factor control supply voltage rated value at DC <ul style="list-style-type: none"> • initial value • full-scale value | 0.85 1.1 |
| operating range factor control supply voltage rated value at AC at 50 Hz <ul style="list-style-type: none"> • initial value • full-scale value | 0.85 1.1 |
| operating range factor control supply voltage rated value at AC at 60 Hz <ul style="list-style-type: none"> • initial value • full-scale value | 0.85 1.1 |
| inrush current peak <ul style="list-style-type: none"> • at 24 V • at 240 V | 0.7 A 12 A |
| duration of inrush current peak <ul style="list-style-type: none"> • at 24 V • at 240 V | 0.25 ms 0.2 ms |
| Measuring circuit | |
| buffering time in the event of power failure minimum | 30 ms |
| Precision | |
| relative metering precision | 2 % |
| Auxiliary circuit | |
| material of switching contacts | AgSnO2 |
| number of NC contacts for auxiliary contacts | 0 |
| number of NO contacts for auxiliary contacts | 1 |
| number of CO contacts for auxiliary contacts | 1 |
| operational current of auxiliary contacts at DC-13 <ul style="list-style-type: none"> • at 24 V • at 125 V • at 250 V | 1 A 0.2 A 0.1 A |
| Main circuit | |
| operating frequency rated value | 50 ... 60 Hz |
| ampacity of the output relay at AC-15 at 250 V at 50/60 Hz | 3 A |
| ampacity of the output relay at DC-13 <ul style="list-style-type: none"> • at 24 V • at 125 V | 1 A 0.2 A |
| continuous current of the DIAZED fuse link of the output relay | 6 A |
| Electromagnetic compatibility | |
| conducted interference <ul style="list-style-type: none"> • due to burst according to IEC 61000-4-4 • due to conductor-earth surge according to IEC 61000-4-5 • due to conductor-conductor surge according to IEC 61000-4-5 | 2 kV (power ports) / 1 kV (signal ports) 2 kV (line to ground) 1 kV (line to line) |
| electrostatic discharge according to IEC 61000-4-2 | 6 kV contact discharge / 8 kV air discharge |
| Galvanic isolation | |
| design of the electrical isolation | Protective separation |
| galvanic isolation <ul style="list-style-type: none"> • between input and output • between the outputs • between the voltage supply and other circuits | Yes Yes Yes |
| Safety related data | |
| Safety Integrity Level (SIL) according to IEC 61508 | 1 |
| performance level (PL) according to EN ISO 13849-1 | c |
| category according to EN ISO 13849-1 | 1 |
| Safe failure fraction (SFF) | 74 % |
| average diagnostic coverage level (DCavg) | 18 % |
| failure rate [FIT] | |

| | |
|--|--|
| <ul style="list-style-type: none"> • at rate of recognizable hazardous failures (λ_{dd}) | 0.000000068 1/h |
| <ul style="list-style-type: none"> • at rate of non-recognizable hazardous failures (λ_{du}) | 0.00000031 1/h |
| PFHD with high demand rate according to EN 62061 | 0.00000038 1/h |
| PFDAvg with low demand rate according to IEC 61508 | 0.0041 |
| MTBF | 97 y |
| MTTFd | 303 y |
| hardware fault tolerance according to IEC 61508 | 0 |
| Connections/ Terminals | |
| product component removable terminal for auxiliary and control circuit | Yes |
| type of electrical connection | spring-loaded terminal (push-in) |
| <ul style="list-style-type: none"> • for auxiliary and control circuit | spring-loaded terminals (push-in) |
| type of connectable conductor cross-sections | |
| <ul style="list-style-type: none"> • solid | 0.5 ... 4 mm ² |
| <ul style="list-style-type: none"> • finely stranded with core end processing | 0.5 ... 2.5 mm ² |
| <ul style="list-style-type: none"> • finely stranded without core end processing | 0.5 ... 4 mm ² |
| <ul style="list-style-type: none"> • at AWG cables solid | 20 ... 12 |
| <ul style="list-style-type: none"> • at AWG cables stranded | 20 ... 12 |
| connectable conductor cross-section | |
| <ul style="list-style-type: none"> • solid | 0.5 ... 4 mm ² |
| <ul style="list-style-type: none"> • finely stranded with core end processing | 0.5 ... 2.5 mm ² |
| <ul style="list-style-type: none"> • finely stranded without core end processing | 0.5 ... 4 mm ² |
| AWG number as coded connectable conductor cross section | |
| <ul style="list-style-type: none"> • solid | 20 ... 12 |
| <ul style="list-style-type: none"> • stranded | 20 ... 12 |
| Installation/ mounting/ dimensions | |
| mounting position | any |
| fastening method | screw and snap-on mounting onto 35 mm standard mounting rail |
| height | 100 mm |
| width | 22.5 mm |
| depth | 90 mm |
| required spacing | |
| <ul style="list-style-type: none"> • with side-by-side mounting <ul style="list-style-type: none"> — forwards — backwards — upwards — downwards — at the side | 0 mm |
| | 0 mm |
| | 0 mm |
| | 0 mm |
| | 0 mm |
| <ul style="list-style-type: none"> • for grounded parts <ul style="list-style-type: none"> — forwards — backwards — upwards — at the side — downwards | 0 mm |
| | 0 mm |
| | 0 mm |
| | 0 mm |
| | 0 mm |
| <ul style="list-style-type: none"> • for live parts <ul style="list-style-type: none"> — forwards — backwards — upwards — downwards — at the side | 0 mm |
| | 0 mm |
| | 0 mm |
| | 0 mm |
| | 0 mm |
| Ambient conditions | |
| installation altitude at height above sea level maximum | 2 000 m |
| ambient temperature | |
| <ul style="list-style-type: none"> • during operation | -25 ... +60 °C |
| <ul style="list-style-type: none"> • during storage | -40 ... +85 °C |
| <ul style="list-style-type: none"> • during transport | -40 ... +85 °C |
| relative humidity during operation | 70 % |
| explosion protection category for dust | [Ex t] [Ex p] |
| explosion protection category for gas | [Ex e] [Ex d] [Ex px] |

Certificates/ approvals

General Product Approval

EMC



[Confirmation](#)



EAC



For use in hazardous locations

Declaration of Conformity

Test Certificates

Marine / Shipping



[Type Test Certificates/Test Report](#)



other

[Confirmation](#)

Further information

Information- and Downloadcenter (Catalogs, Brochures,...)

<https://www.siemens.com/ic10>

Industry Mall (Online ordering system)

<https://mall.industry.siemens.com/mall/en/en/Catalog/product?mlfb=3RN2023-2DW30>

Cax online generator

<http://support.automation.siemens.com/WW/CAXorder/default.aspx?lang=en&mlfb=3RN2023-2DW30>

Service&Support (Manuals, Certificates, Characteristics, FAQs,...)

<https://support.industry.siemens.com/cs/ww/en/ps/3RN2023-2DW30>

Image database (product images, 2D dimension drawings, 3D models, device circuit diagrams, EPLAN macros, ...)

http://www.automation.siemens.com/bilddb/cax_de.aspx?mlfb=3RN2023-2DW30&lang=en

Characteristic: Derating

<https://support.industry.siemens.com/cs/ww/en/ps/3RN2023-2DW30/manual>

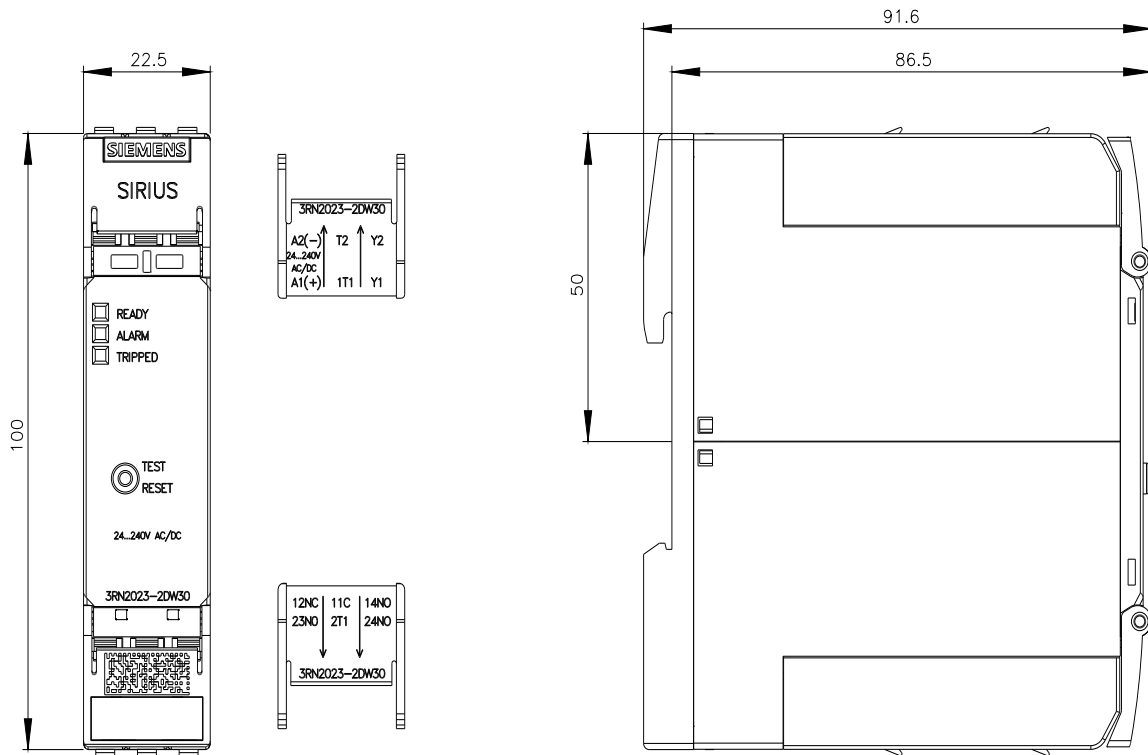

last modified:

1/26/2022 