

a) Part as supplied.

KTKK 5011Q

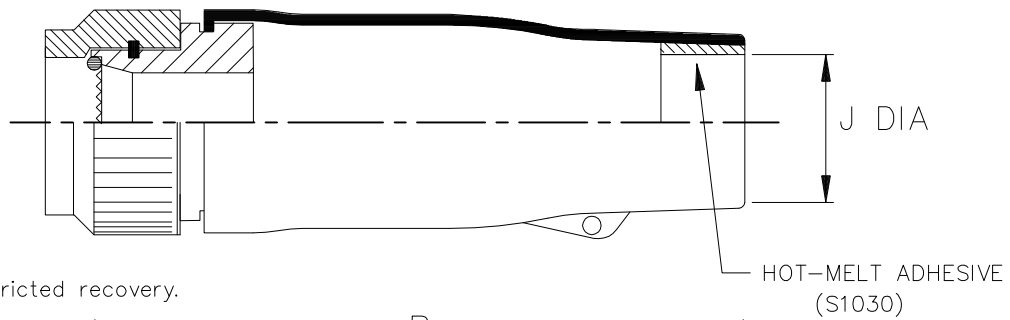

b) Part after unrestricted recovery.

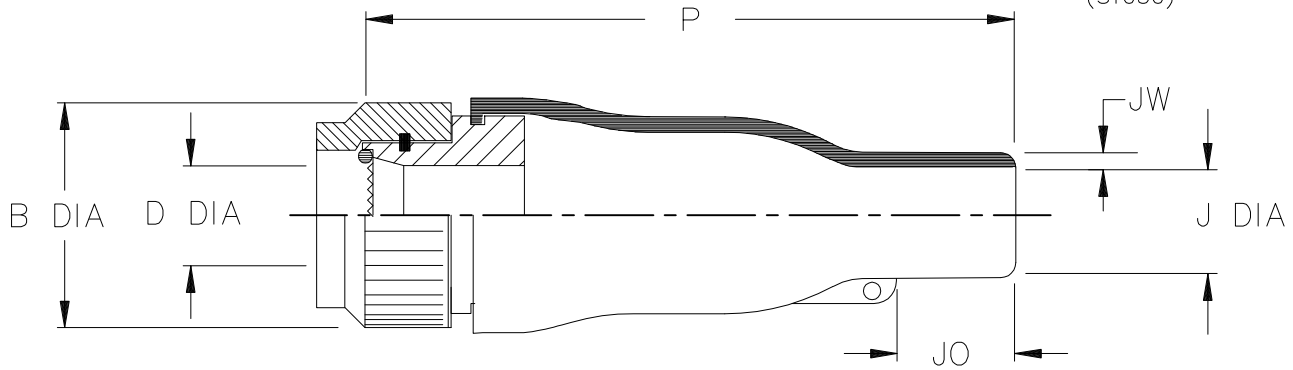

Raychem connector code: - 64
 Connector series: - VEAM CIR06BRT
 Adaptor Series: - 215M7**-19-Q**-K-NS
 Moulded Part Material: - -100, RW 2082

Assembly will be Part Marked with Part Number.
 Kits to include cleaning tissue, 1 piece 100 grit emery cloth.
 Assembly to be installed per Raychem instruction sheet AER#90611.

Dimensions in millimetres {inches}.

a) Part as supplied.

b) Part after unrestricted recovery.

Part No.	SHELL SIZE	B	D	J		P	JO	JW	CABLE RANGE	
		DIA	DIA	MIN	MAX	±10%	REF	±30%	MIN	MAX
		MAX	MIN	a	b	b	b	b		
KTKK 5011Q	18	34.4 {1.35}	16.4 {0.64}	24 {0.94}	8.4 {0.33}	98 {3.84}	20 {0.77}	1.0 {0.04}	8.8 {0.35}	16 {0.62}

Copyright(!)

The copyright in this drawing is the property of TE Connectivity. The drawing is issued on the condition that it is not copied, reproduced or disclosed to a third party, either in whole or in part without the prior written consent of TE Connectivity.

Drawn N. NAGAR Checked Issue 1 Date 12/08/13

Conforms to ISO Recommendations
3rd Angle Projection
Not to Scale

Approval
Design H. SMITH MKTG. D. JONES Q.A. H. JOHNS

