

THIS DRAWING IS A CONTROLLED DOCUMENT.

PART NUMBER	REV	FIRST USED
680621-1	B	122500-1
680621-2	B	565435-5
680621-3	B	354500-1

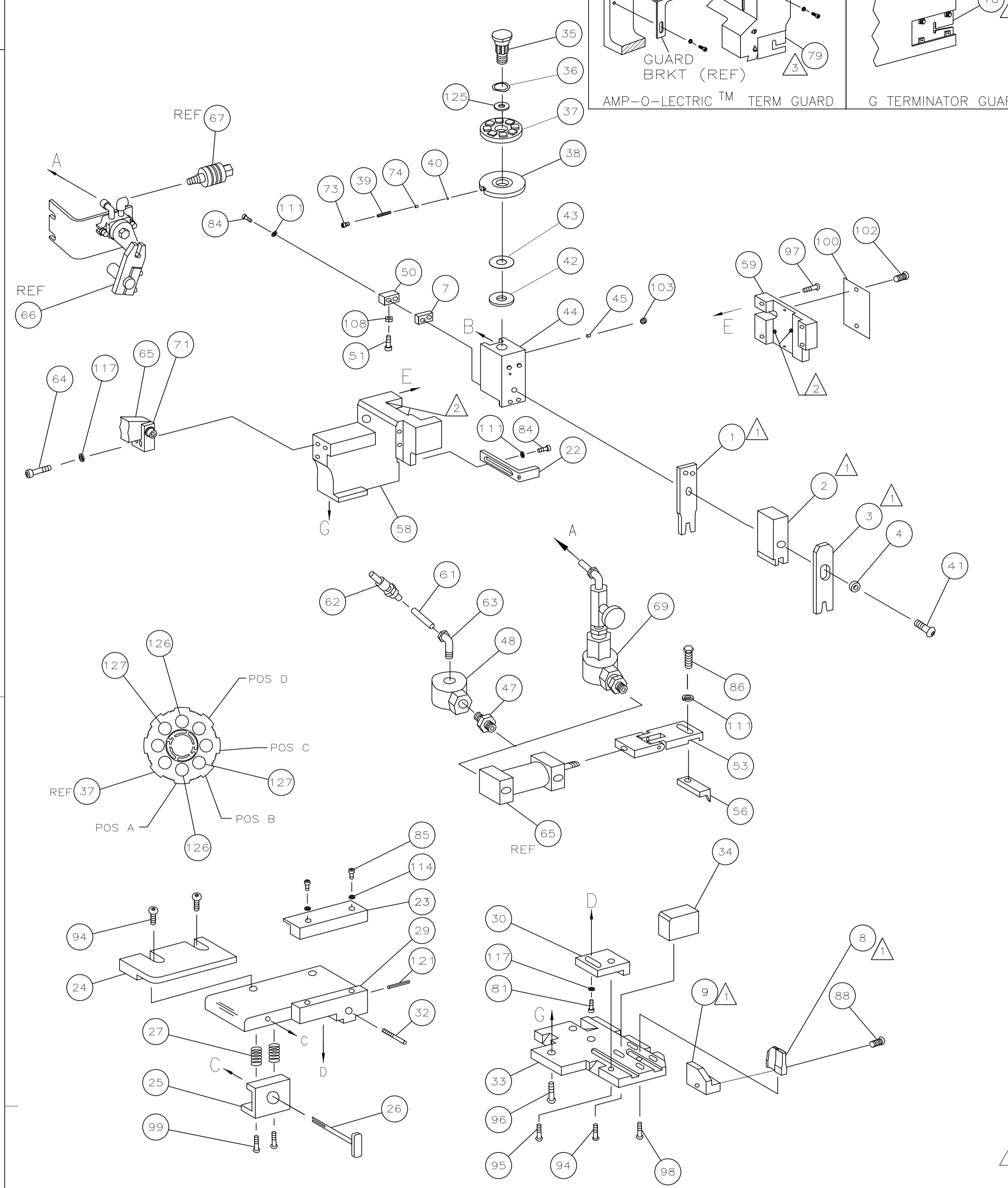

- 1 RECOMMENDED SPARE PARTS.
- 2 GREASE LIGHTLY.
- 3 GUARD MUST BE IN PLACE WHEN OPERATING APPLICATOR IN A BENCH MACHINE.
- 4 SEE DRAWING FOR COMPONENTS
- 5 INSULATION RANGE TO BE DETERMINED AT SET UP.

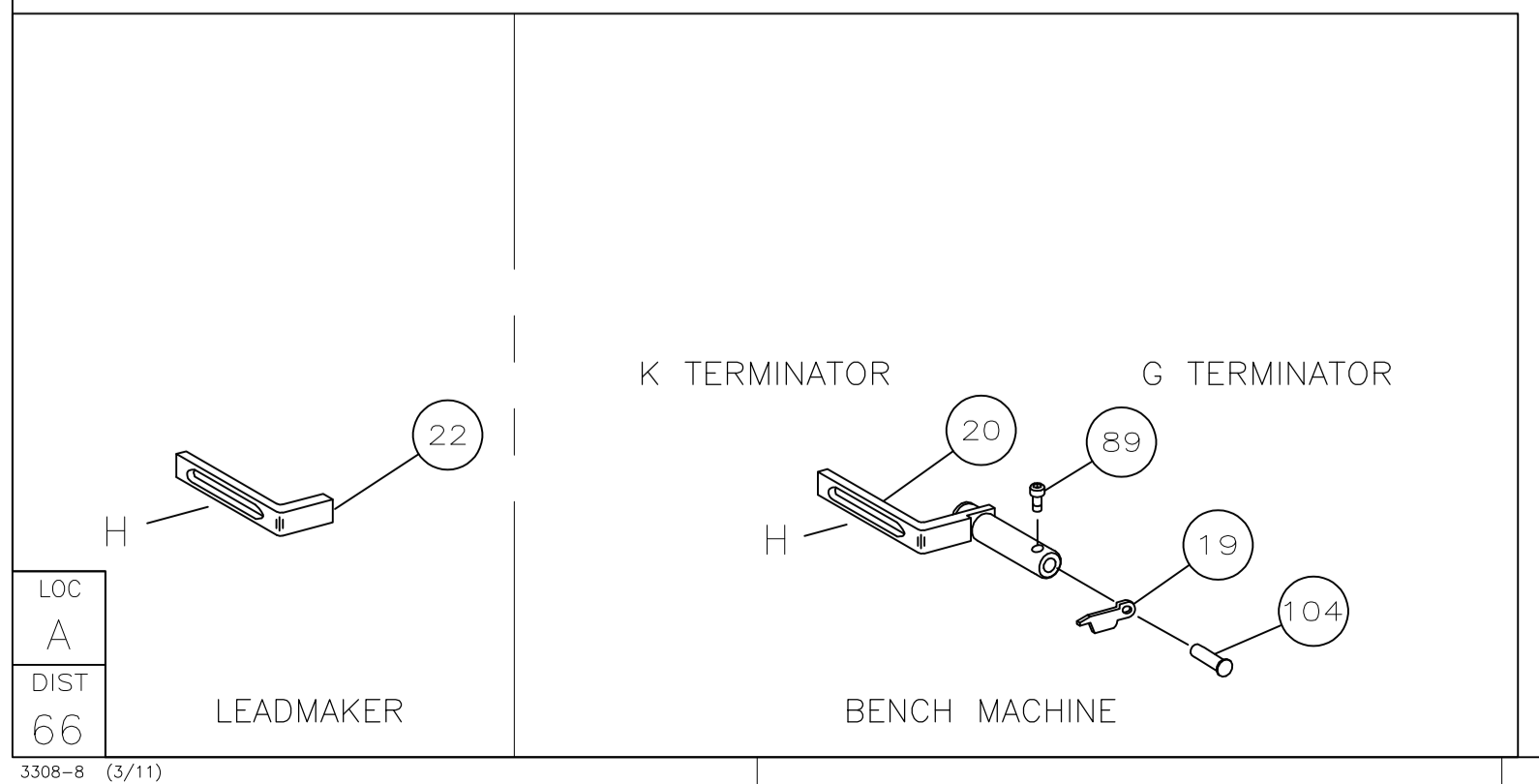

AMP		MFR	CRIMP DATA (NON-AMP TERMINAL-CUST SPEC)		
286710		12160636	PAD LTR	CRIMP HEIGHT	
286712		12110646		WIRE SIZE	
			A	.083 ±.002 [2.10 ±.05mm]	
			B	.071 ±.002 [1.80 ±.05mm]	
			C	NOT USED	
			D	NOT USED	
			CRIMP SIZE	TYPE RANGE	
			WIRE	.120 [3.05mm] F 14-12	
			INSUL	.180 [4.57mm] F 5	
WIRE STRIP LENGTH	TERM APPL SPEC	FEED	APPL INSTRUCTION	SET UP GAGE	LAYOUT
.281-.312	NONE	.590	408-8040	458637-1	L2098

QTY REQD PER ASSY	PART NO	DESCRIPTION	ITEM NO			
			129			
			128			
2	2	2	8-354778-7	PIN, WIRE DISC (.2930)B	127	
2	2	2	6-354778-3	PIN, WIRE DISC (.2810)A	126	
1	1	1	986950-1	WASHER, FLAT PRECISION	125	
1	1	1	217238-1	GENERAL INSTRUCTION PACKAGE	124	
1	1	1	4088040	SF APPL INST 408-8040	123	
					122	
1	1	1	4-21028-0	PIN,SLT SPR(Ø.093x.75)ST GDE PL	121	
					120	
					119	
					118	
3	3	3	21024-5	WASHER, LOCK(#10)ADJ BLOCK	117	
					116	
					115	
2	2	2	21024-2	WASHER,LOCK(#4)FRONT STP GUIDE	114	
					113	
					112	
4	4	4	21024-4	WASHER,LOCK(#8)STRIPPER	111	
					110	
					109	
1	1	1	21018-5	NUT,HEX(NO.6)HOLDDOWN	108	
					107	
					106	
					105	
1	1	-	992031-1	PIN, CLEVIS	104	
1	1	1	21009-2	SCR,SKT SET(1/4-20x.25 LW)RAM	103	
2	2	2	21017-2	SCR,DRIVE(#2x.19)ID PLATE	102	
					101	
1	1	1	461264-1	PLATE, IDENTIFICATION	100	
2	2	2	3-21002-0	SCR,BHC(10-32x.88)DRAG	99	
1	1	1	22733-8	SCR,BHC(8-32x.38 LW)ANVIL	98	
4	4	4	2-21002-9	SCR,BHC(10-32x.75)CAP	97	
3	3	3	2-22733-8	SCR,BHC(1/4-20x.62)HSG	96	
1	1	1	2-21002-7	SCR,BHC(10-32x.50)SG ADJ BLK	95	
4	4	4	2-21002-2	SCR,BHC(8-32x.50)TERM H DWN	94	
					93	
					92	
					91	
					90	
1	1	-	7-21000-9	SCR,SHC(4-40x.19)STRIPPER	89	
1	1	1	3-21000-0	SCR,HEX HD(8-32x.88)SHEAR	88	
2	2	2	2-21000-8	SCR,HEX HD(8-32x.62)SHEAR	87	
1	1	1	2-22603-1	SCR,HEX HD(8-32x.38)FEED FINGER	86	
2	2	2	1-21000-5	SCR,SHC(4-40x.25)F ST GUIDE	85	
3	3	3	2-21000-7	SCR,SHC(8-32x.50)STRIPPER	84	
					83	
					82	
1	1	1	3-21000-4	SCR,SHC(10-32x.38)SG ADJ BL	81	
					80	
-	1	-	462992-7	GUARD ASSY	79	
REF	-	-	679532-1	INSERT, GUARD	78	
					77	
					76	
					75	
1	1	1	690603-1	SPRING, ASSIST	74	
1	1	1	23030-1	SCR,SHC(6-32x.25 SL)INS DISC	73	
					72	
1	1	1	459610-3	MOUNT, FEED BRACKET	71	
-3	-2	-1	U/M	PART NO	DESCRIPTION	ITEM NO

USED ON		
-1	LEADMAKER	AIRFEED
-2	BENCH MODEL K	AIRFEED
-3	BENCH MODEL G	AIRFEED

QTY REQD PER ASSY	PART NO	DESCRIPTION	ITEM NO			
			70			
-	1	-	692655-5	AIR FEED VALVE ASSY	69	
					68	
-	REF	-	24042-2	VALVE, SHUT OFF	67	
-	REF	-	692655-6	AIR FEED VALVE ASSY	66	
1	1	1	461065-1	AIR FEED ASSY (1 INCH)	65	
2	2	2	3-21000-7	SCR,SHC(10-32x.75)AIR ASSY	64	
1	-	1	980285-2	ELBOW, SWIVEL 1/8 NPT - 1/4 T	63	
1	-	1	23238-1	QUICK DISCONNECT	62	
21.00	-	21.00	IN	27319-4	TUBING, POLY-FLO Ø.25	61
					60	
1	1	1	454220-1	CAP, RAM	59	
1	1	1	454485-1	HOUSING	58	
					57	
1	1	1	3-694433-2	PAWL, FEED	56	
					55	
					54	
1	1	1	461062-1	FEED FINGER ASSY	53	
					52	
1	1	1	811242-2	BUMPER, HOLDDOWN	51	
1	1	1	690753-1	SPACER, TONKER	50	
					49	
1	-	1	22374-7	VALVE, QUICK EXHAUST	48	
1	-	1	22304-1	NIPPLE, HEX 1/8 NPT	47	
					46	
1	1	1	690191-1	PLUG, NYLON	45	
1	1	1	819307-6	RAM	44	
1	1	1	690125-1	WASHER, LAMINATED	43	
1	1	1	690124-1	WASHER, RAM	42	
1	1	1	690686-2	BOLT, CRIMPER(5/16x1.00)	41	
1	1	1	23241-6	BALL, STEEL	40	
1	1	1	690170-1	SPRING, COMPRESSION	39	
1	1	1	690142-1	DISC, INSULATION	38	
1	1	1	354777-1	WIRE DISC, PLASTIC	37	
1	1	1	22480-5	WASHER, SPRING	36	
1	1	1	690212-1	POST, RAM	35	
1	1	1	690786-1	SUPPORT, TERMINAL	34	
1	1	1	455675-1	PLATE, BASE	33	
1	1	1	690432-3	SCREW, ADJUSTMENT	32	
					31	
1	1	1	455689-1	BLOCK, STRIP GUIDE ADJ	30	
1	1	1	5-455671-2	PLATE, STRIP GUIDE	29	
					28	
2	2	2	1-22284-0	SPRING, DRAG	27	
1	1	1	690546-1	LEVER, DRAG RELEASE	26	
1	1	1	690754-7	DRAG, TERMINAL	25	
1	1	1	1-690440-9	GUIDE, STRIP (REAR)	24	
1	1	1	690712-9	GUIDE, STRIP (FRONT)	23	
-	-	1	690472-2	STRIPPER	22	
					21	
1	1	-	679218-1	STRIPPER WIRE STOP ASSY	20	
1	1	-	458949-2	STRIPPER	19	
					18	
					17	
					16	
					15	
					14	
					13	
					12	
					11	
					10	
1	1	1	853714-5	PLATE, REAR SHEAR	9	
1	1	1	1214596-3	ANVIL	8	
1	1	1	1-240641-9	SPACER, DEPRESSOR (REAR)	7	
					6	
					5	
1	1	1	238009-1	SPACER, BLOCK CRIMPER	4	
1	1	1	4-456134-6	CRIMPER, INSULATION	3	
1	1	1	853720-5	BLADE,SLUG	2	
1	1	1	6-458141-8	CRIMPER, WIRE	1	
-3	-2	-1	U/M	PART NO	DESCRIPTION	ITEM NO

LOC A
DIST 66

LEADMAKER
BENCH MACHINE

DIMENSIONS: INCHES
 TOLERANCES UNLESS OTHERWISE SPECIFIED:
 0 PLC ±.005
 1 PLC ±.010
 2 PLC ±.015
 3 PLC ±.020
 4 PLC ±.030
 SURFACE TEXTURE: $\sqrt{\text{ }}$

DW: W.HOOVER
 CHR: C.ERISMAN
 APVD: T.ELBIN
 NAME: _____
 SIDE FEED HDM APPLICATOR

SCALE: - A1
 SIZE: 680621
 DRAWING NO: 680621
 SHEET 1 of 1
 REV B

DATE: 4-2014
 MY: GB
 P: LTR
 REVISION RECORD

CUSTOMER ACCESSIBLE PRODUCTION DRAWING