

LOC	DIST	REVISIONS			
		REV	DATE	BY	CHKD
GP	00	E	19FEB2011	HMR	JTL
		F	20FEB2014	JW	SH
		FI	11JUL2014	JW	SH

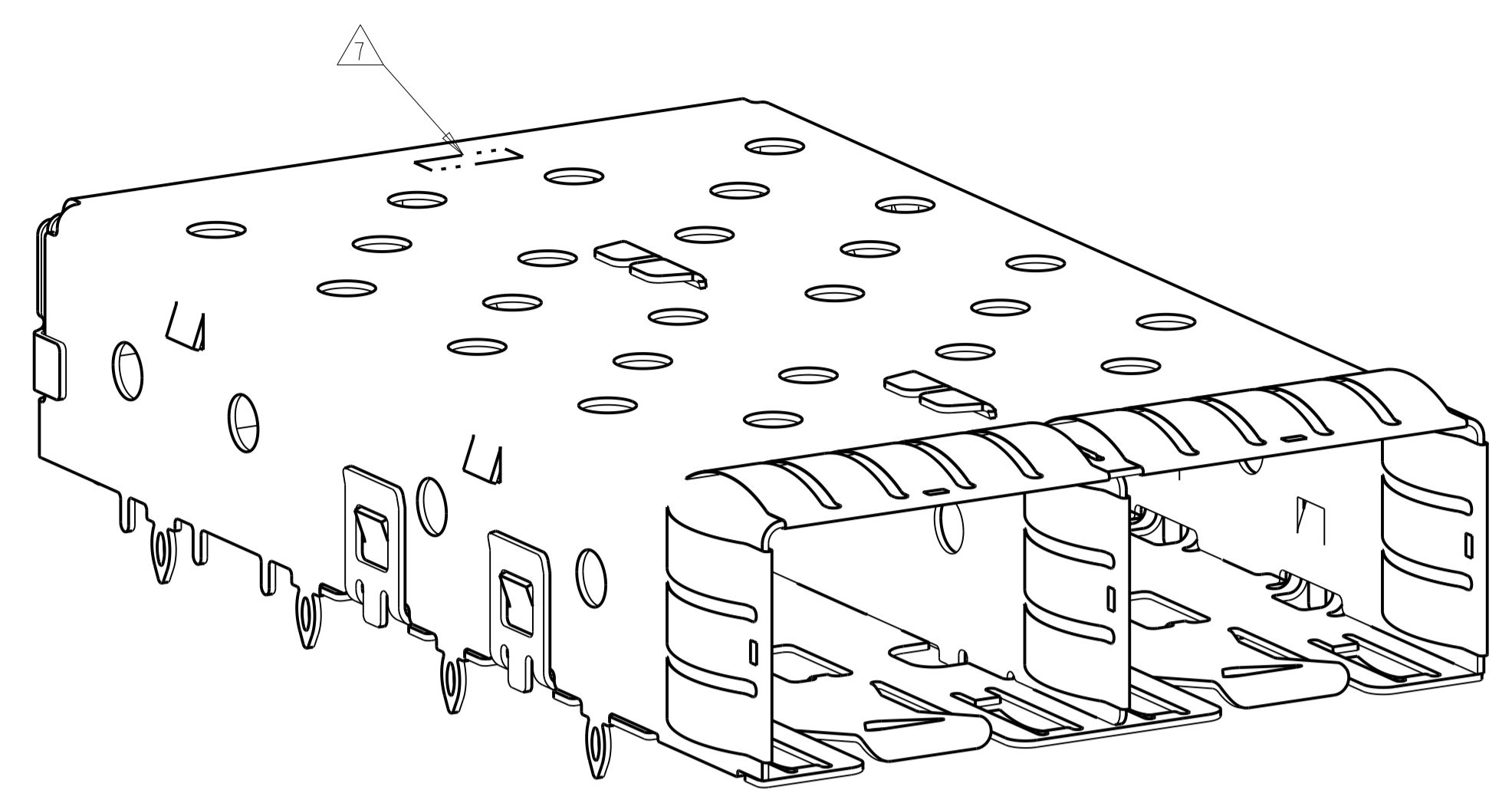

- △ MATERIAL: COPPER ALLOY.
- △ FINISH:
CAGE: 1.25µm MIN TIN OVER NICKEL FLASH. NON PLATED EDGES PERMISSIBLE.
SPRINGS: 0.8µm MIN TIN OVER 0.8µm MIN NICKEL. NON PLATED EDGES PERMISSIBLE.
- △ PADS AND VIAS CHASSIS GROUND.
- △ DATUMS AND BASIC DIMENSIONS ESTABLISHED BY CUSTOMERS.
- △ MATES WITH SFP MSA COMPLIANT TRANSCEIVERS.
- △ REFERENCE APPLICATION SPEC 114-13120, HOLE A, FOR RECOMMENDED DRILL HOLE DIAMETER AND PLATING THICKNESSES.
- △ COMPANY LOGO IN APPROXIMATE AREA SHOWN
- △ DATE CODE AND PART NUMBER IN APPROXIMATE AREA SHOWN.
- △ MATERIAL: NICKEL SILVER ALLOY(NO PLATING)

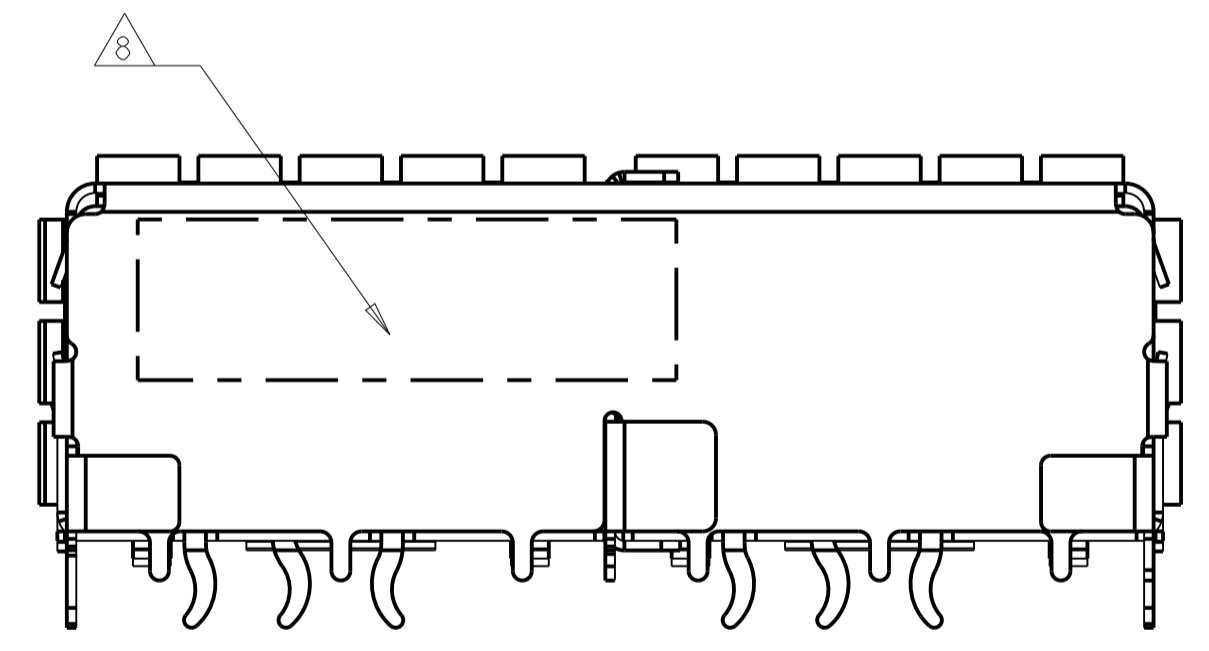
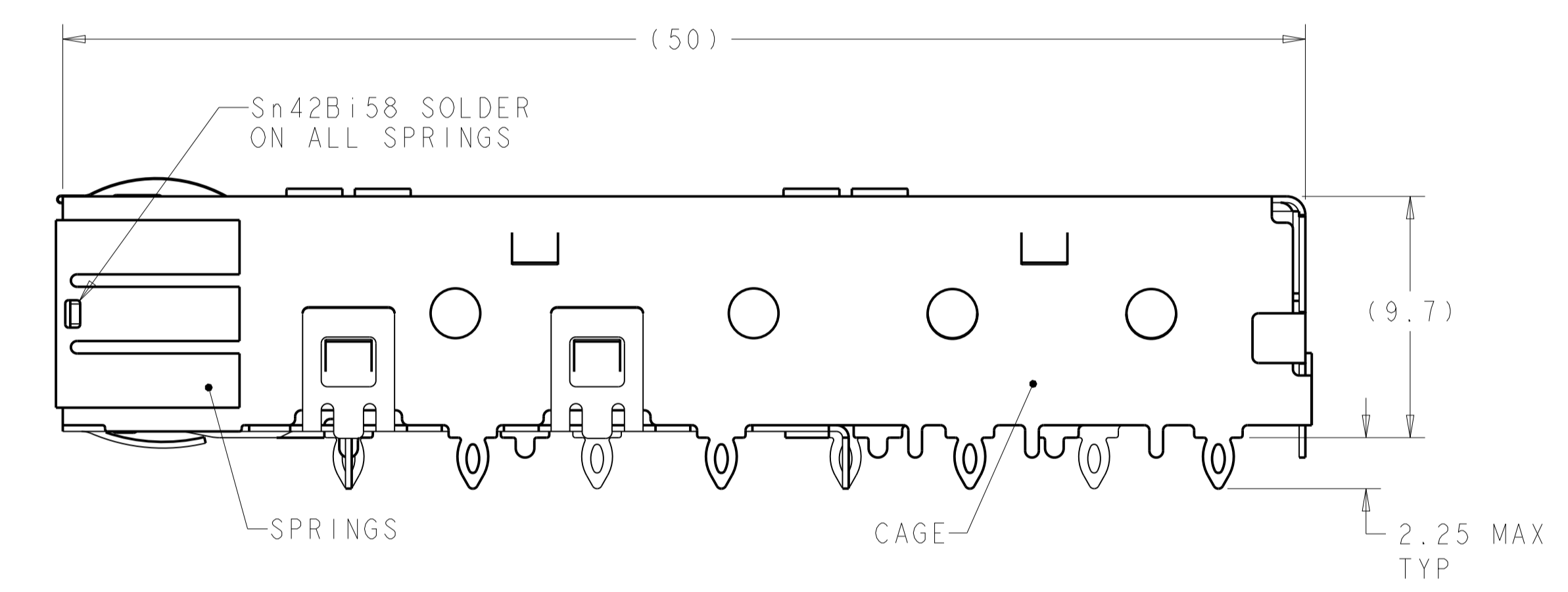
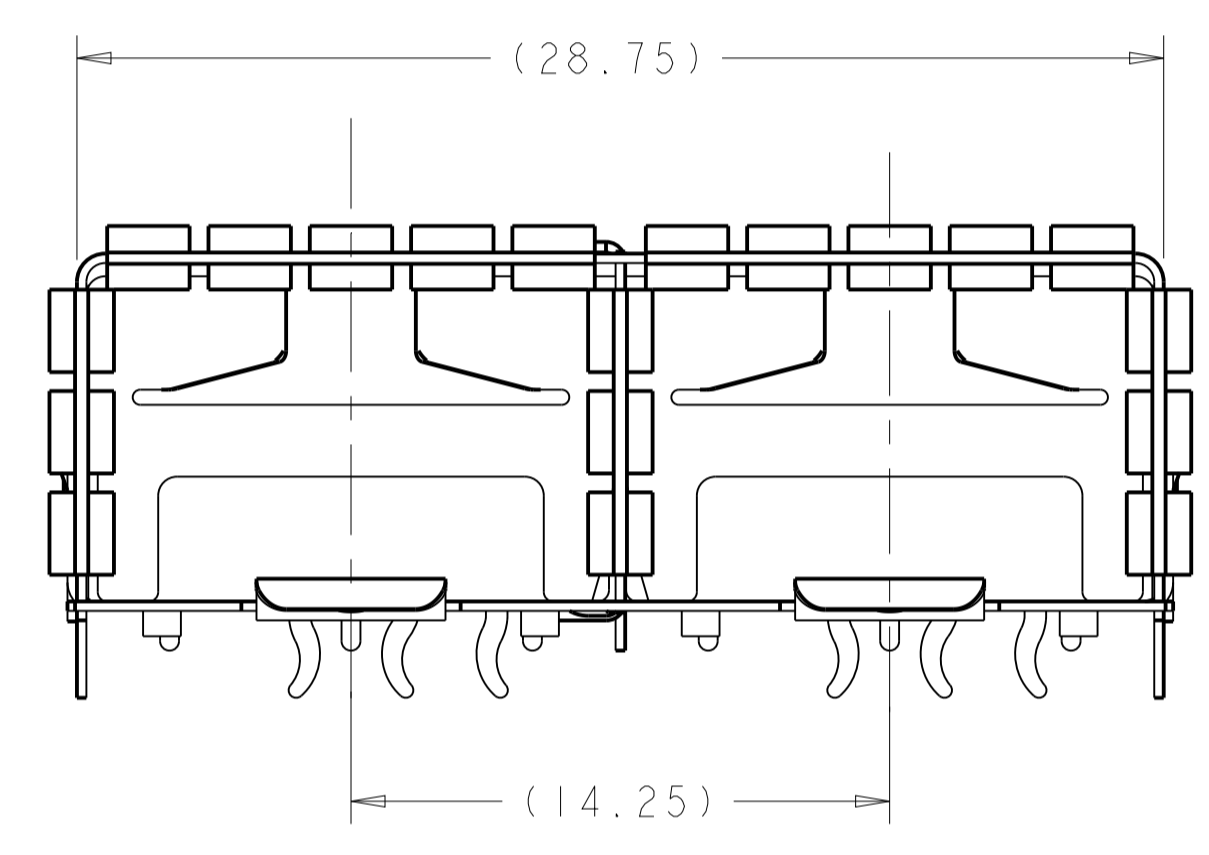
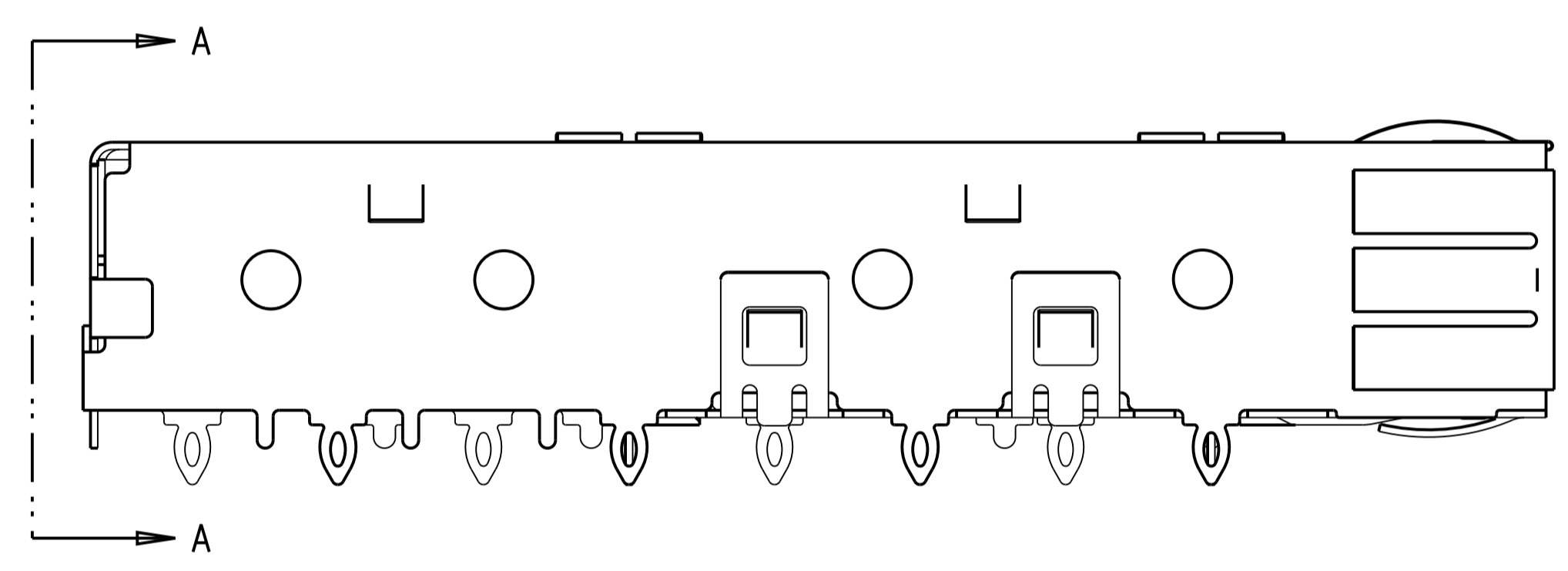

SECTION A-A

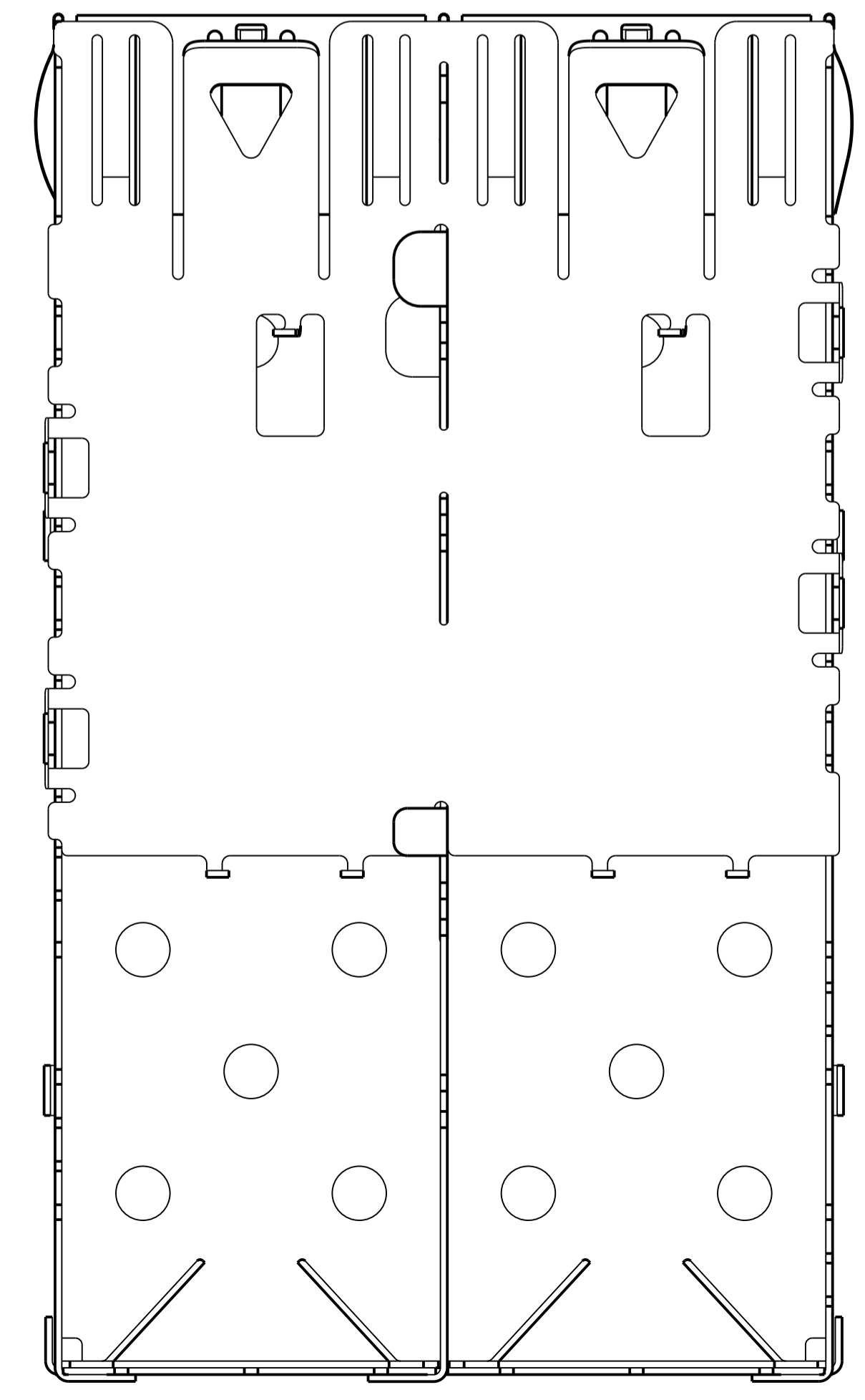

NO	△	0.15	10.15	30.75	29.5	1X2 ASSEMBLY	1888424-2
	△	0.15	10.15	30.75	29.5	1X2 ASSEMBLY	1888424-1
FINISH MATERIAL		D±0.1	C±0.1	B MIN	A±0.1	DESCRIPTION	PART NUMBER

THIS DRAWING IS A CONTROLLED DOCUMENT.		OWN	B. MCMASTER	30NOV06
DIMENSIONS:		CHK	J. KOPPENHEFFER	30NOV06
mm		APVD	J. KOPPENHEFFER	30NOV06
TOLERANCES UNLESS OTHERWISE SPECIFIED:		NAME		
0 PLC	±	SFP ENHANCED EM1		
2 PLC	±0.10	1X2 CAGE ASSEMBLY		
3 PLC	±	SIZE		
4 PLC	±	CAGE CODE		
ANGLES	±2°	DRAWING NO		
MATERIAL	△	RESTRICTED TO		
FINISH	△	A1		
CUSTOMER DRAWING		SCALE 5:1 SHEET 1 OF 2 REV FI		

LOC	DIST	REV	DATE	BY	APPV
GP	00				

REVISIONS			DATE	BY	APPV
		SEE SHEET 1			

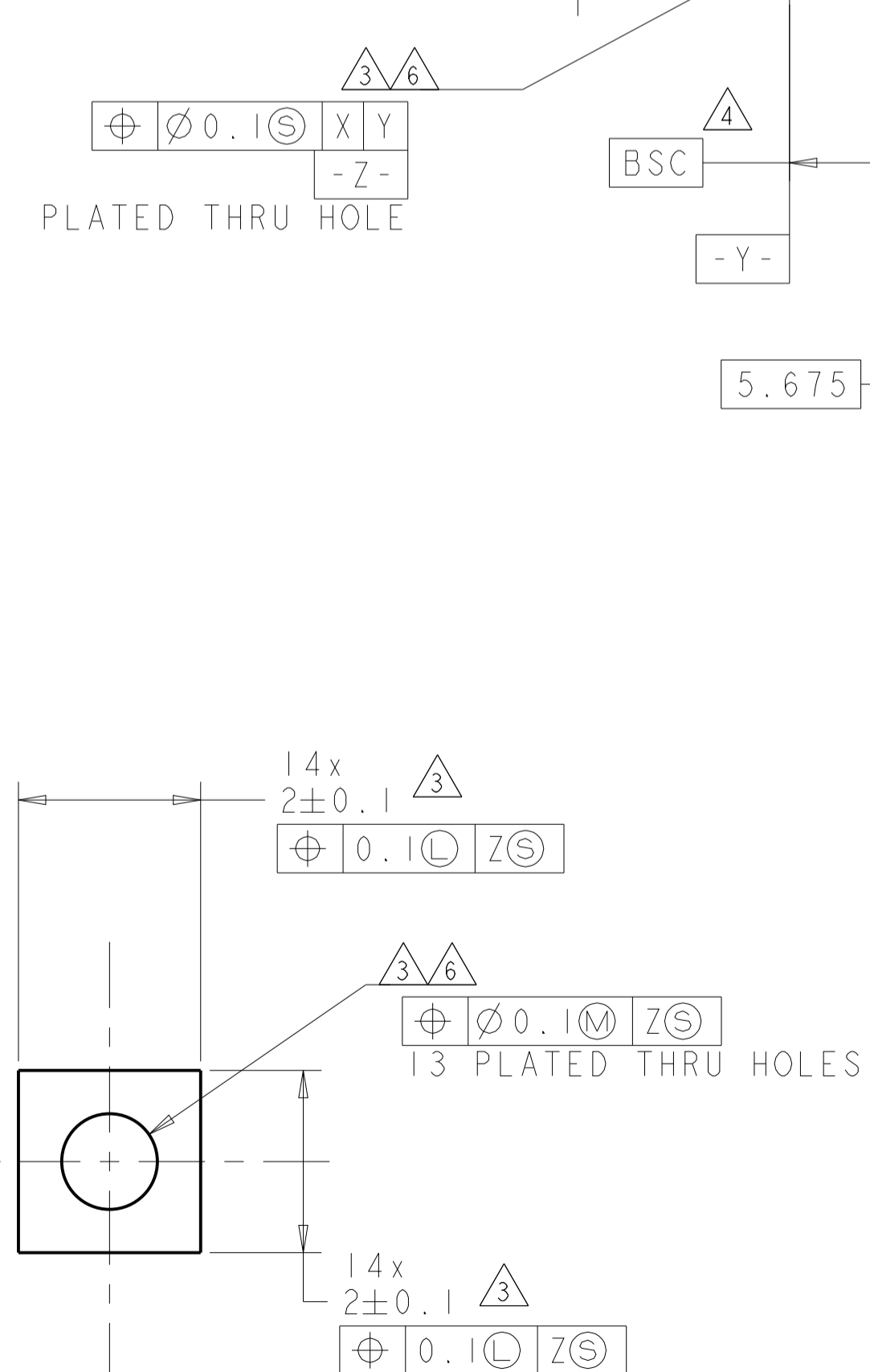
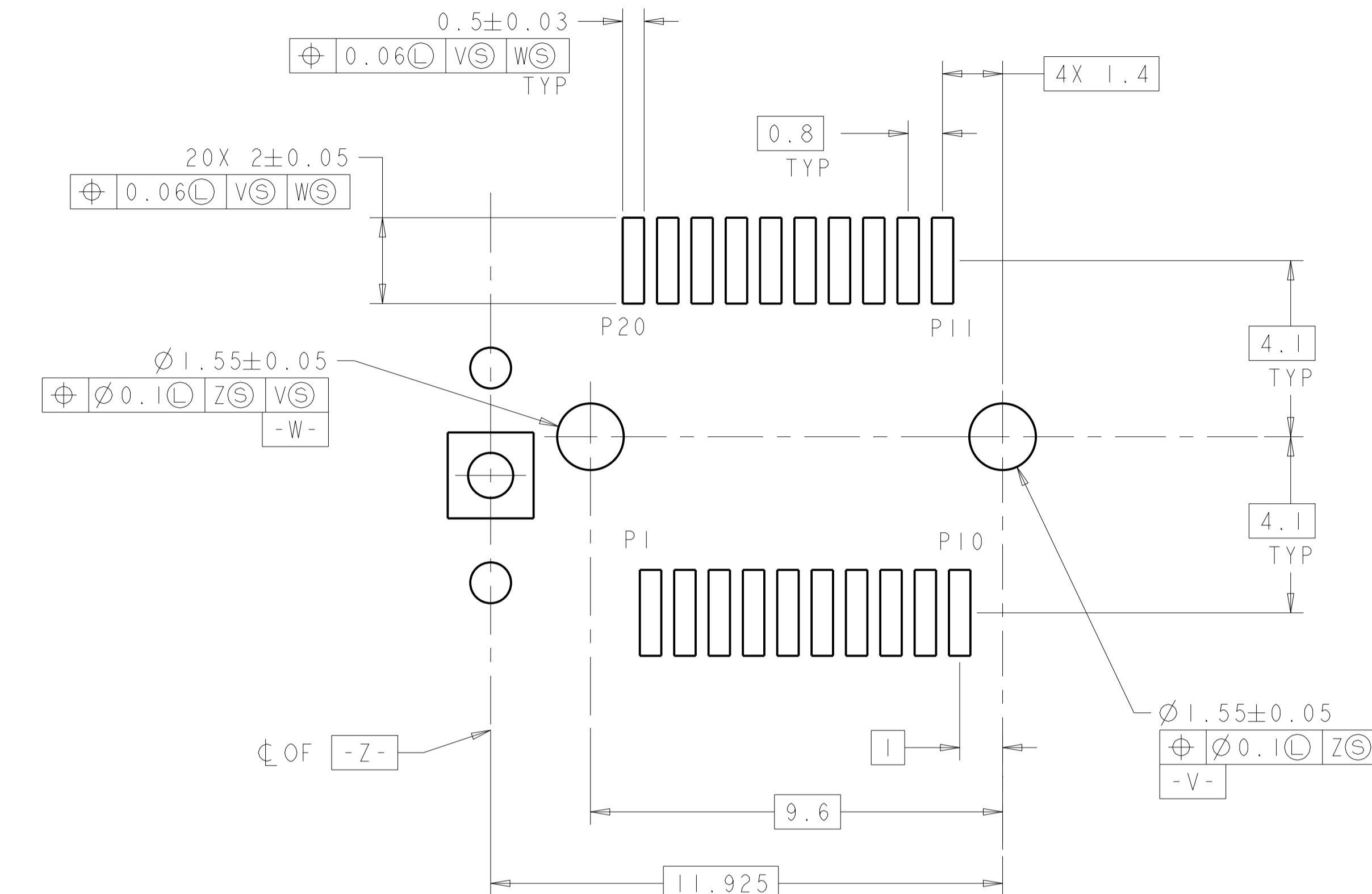
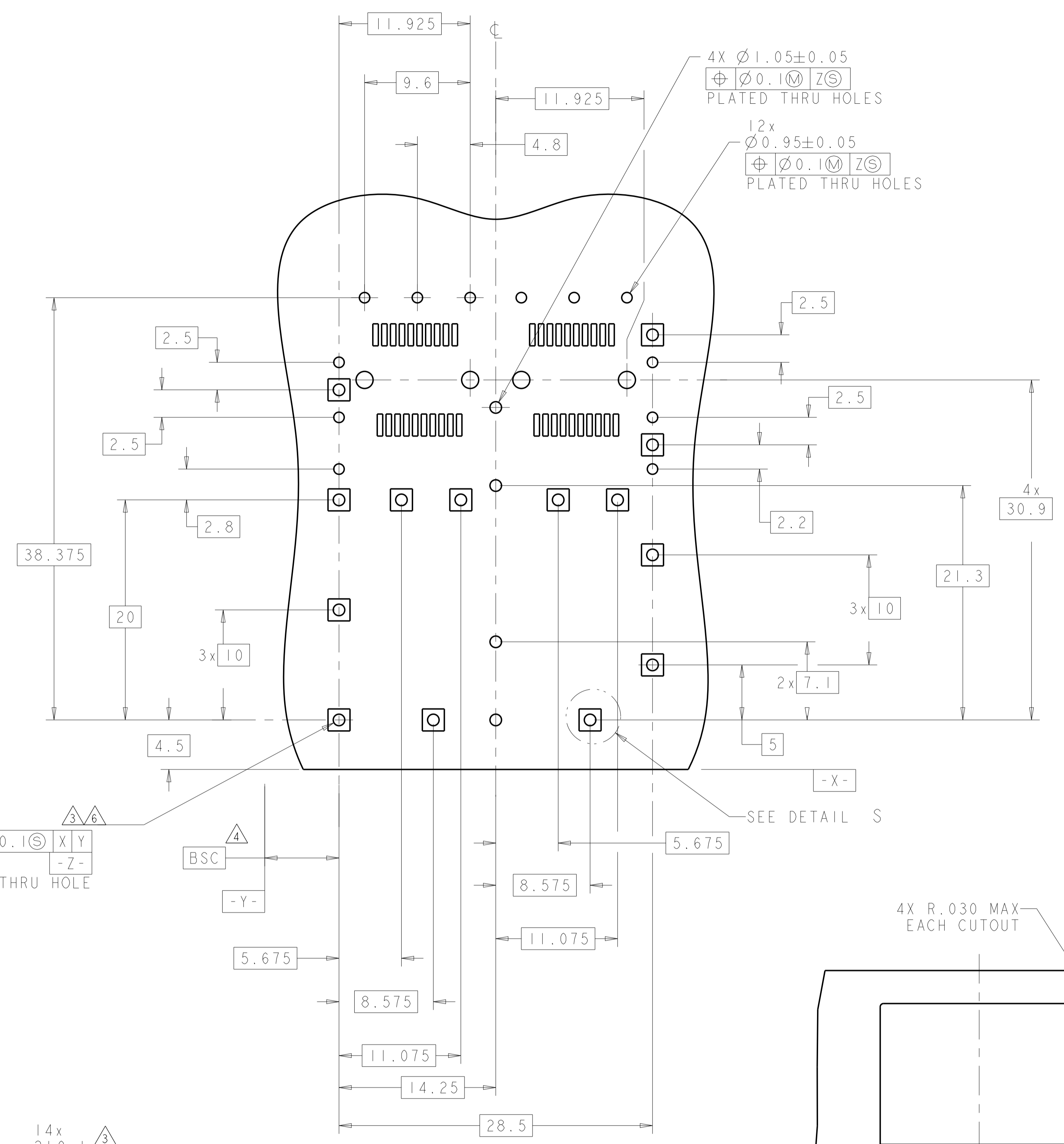

RECOMMENDED PC BOARD
CONFIGURATION
SCALE 4:1

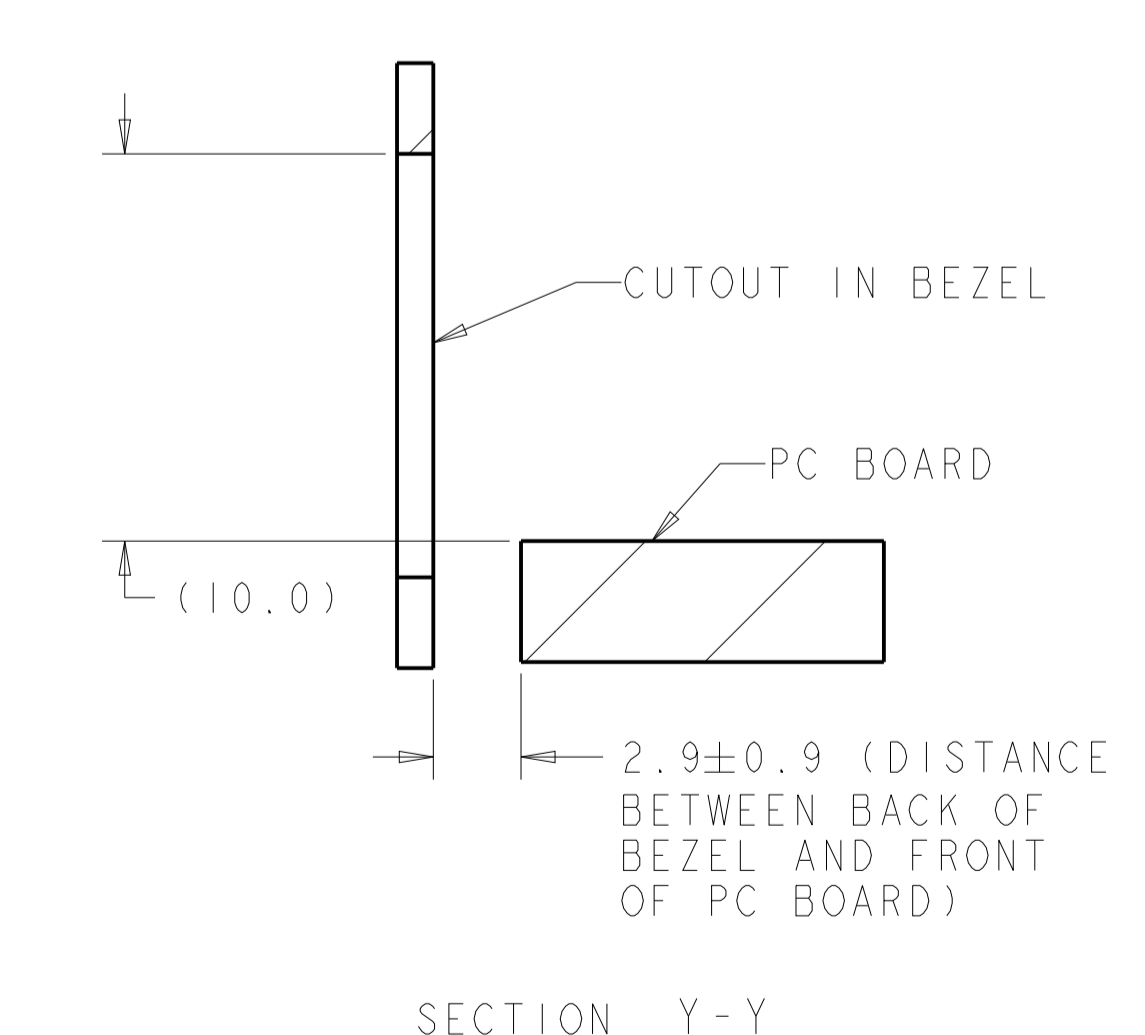
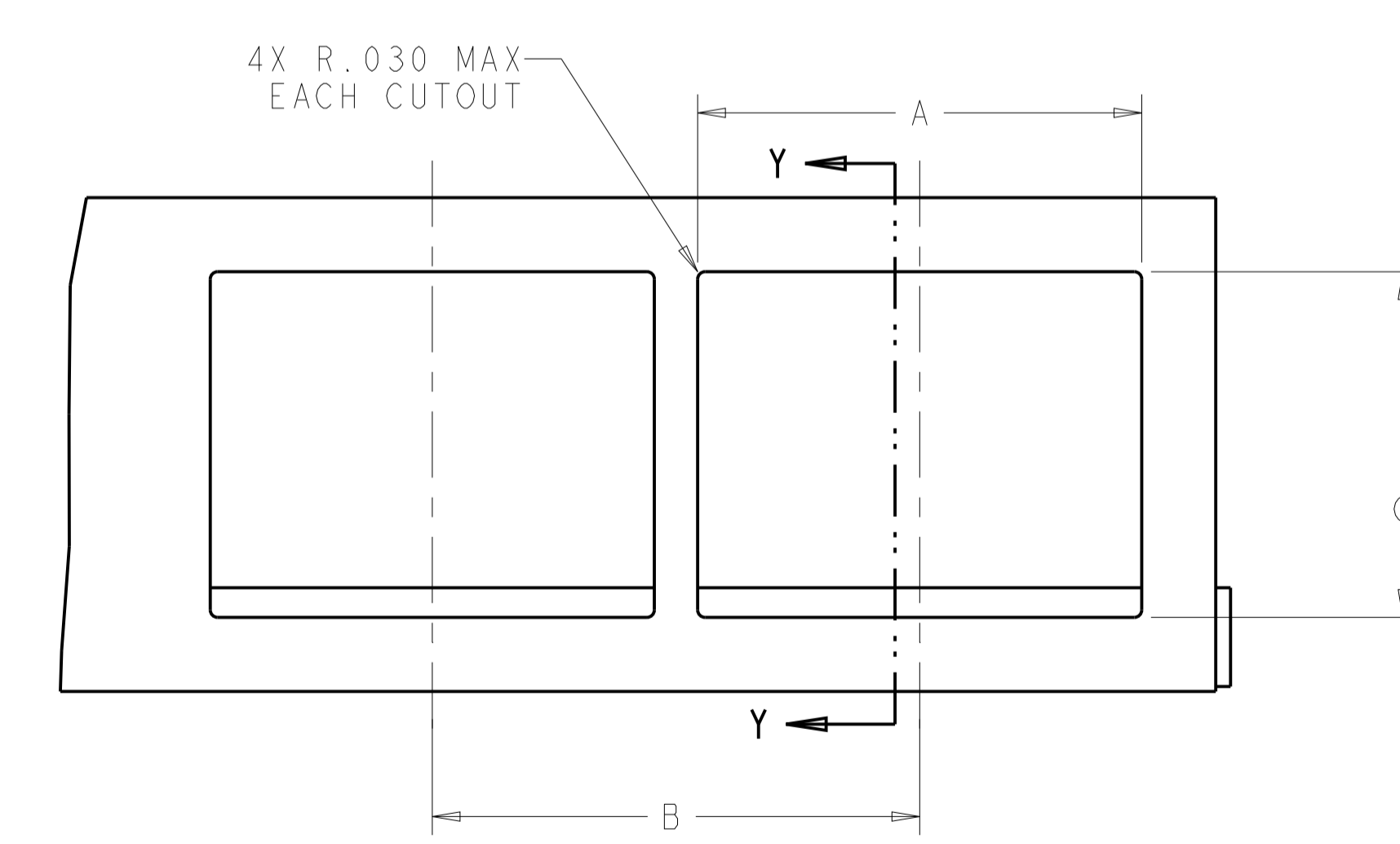

THIS DRAWING IS A CONTROLLED DOCUMENT.		OWN: B. MCMASTER 30NOV06	STE TE Connectivity	
DIMENSIONS: mm		CHK: J. KOPPENHEFFER 30NOV06	NAME: SFP ENHANCED EM1 1X2 CAGE ASSEMBLY	
TOLERANCES UNLESS OTHERWISE SPECIFIED:		APVD: J. KOPPENHEFFER 30NOV06	SIZE: A1	
0 PLC	±	PRODUCT SPEC	RESTRICTED TO	
1 PLC	±0.10	APPLICATION SPEC	CAGE CODE: 1888424	
2 PLC	±	114-13120	SCALE: 4:1	
3 PLC	±	WEIGHT	SHEET 2 OF 2	
4 PLC	±	FINISH	REV: F1	
ANGLES: ±2°		CUSTOMER DRAWING	DATE: 108-1950	