

WM 3-D MODEL: TM-111111-0212

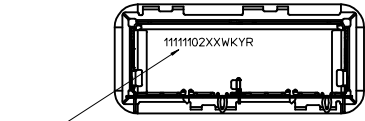
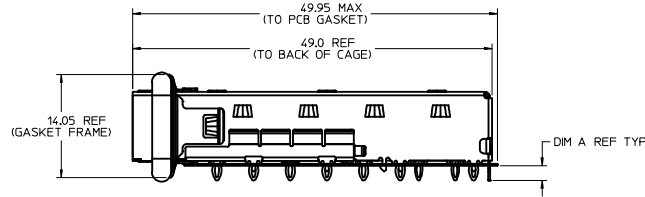
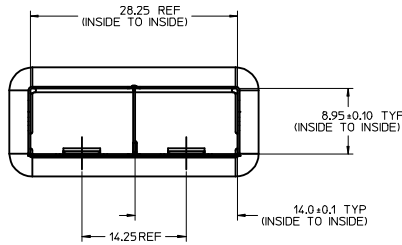
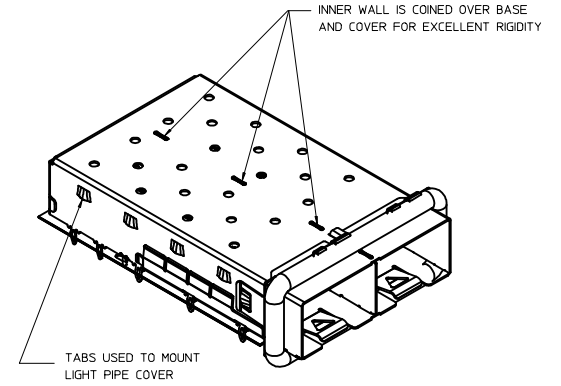
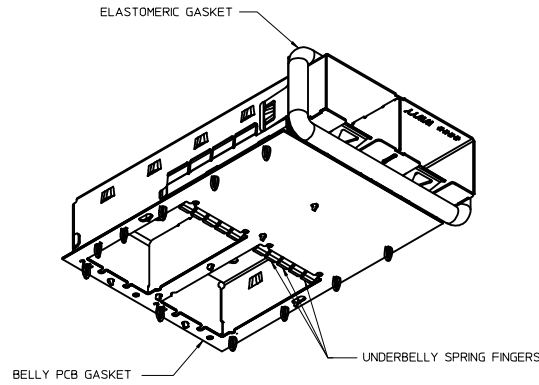
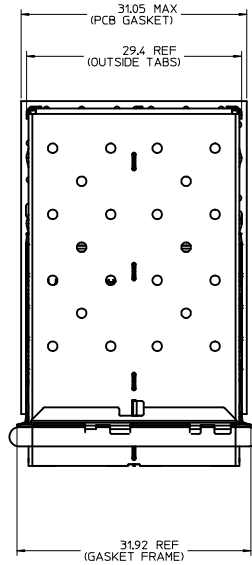

PART NO. AND WEEK/YEAR DATE CODE TO BE PRINTED ON BACK OF CAGE APPROXIMATELY AS SHOWN. SEE TABLE BELOW FOR DATE CODE INFORMATION.

DATE	WEEK/YEAR DATE CODE
WK 01 THRU 52	EXAMPLE: 01 - FIRST WEEK OF YEAR 52 - LAST WEEK OF YEAR
YR 11, 12, 13, ETC.	EXAMPLE: YEAR 2013-13

NOTES (UNLESS OTHERWISE SPECIFIED):

- MATERIAL:
CAGE: 0.25mm THICK COPPER ALLOY, NICKEL PLATED
ELASTOMERIC GASKET: CONDUCTIVE ELASTOMER
BELLY PCB GASKET: COATED POLYIMIDE
- PORTS ARE DESIGNED FOR zSFP+, SFP+, AND SFP TRANSCEIVERS
- OPTIONAL LIGHTPIPE ASSEMBLY AVAILABLE
- LEAD FREE. NO ROHS EXEMPTIONS

MOLEX P/N	DIM A	MIN. PCB THICKNESS FOR SINGLE SIDED	MIN. PCB THICKNESS FOR BELLY TO BELLY	ELASTOMERIC GASKET FLAMMABILITY RATING
1111110210	2.79	1.57	3.00	UL94 HB
1111110212	2.02		2.28	UL94 V-0
1111110216	2.79		3.00	UL94 V-0

SEE REVISION TABLE	ECN NO: CP02016-3004	2016/02/04
D	DRWN:ACHENG03	2016/02/04
CHKO:	APPR:RCHEN08	2016/02/19
REV	DESCRIPTION	

QUALITY SYMBOLS	GENERAL TOLERANCES (UNLESS SPECIFIED)
▽=0	4 PLACES ± --- + ---
▽=0	3 PLACES ± --- + ---
▽=0	2 PLACES ± 0.15 + ---
	1 PLACE ± 0.25 + ---
	0 PLACE ± ±
	ANGULAR ± 1 °
	DRAFT WHERE APPLICABLE MUST REMAIN WITHIN DIMENSIONS

DIMENSION STYLE		SCALE	DESIGN UNITS	THIRD ANGLE PROJECTION
MM ONLY		3:1	METRIC	☉
DRAWN BY	DATE	TITLE		
MDANIELS	2011/08/19	ZSFP+ 1X2 CAGE ASSY W/ PRESS FIT, ELASTOMER & BELLY PCB GASKETS		
CHECKED BY	DATE	molex		
KJANOTA	2011/08/22	SD-111111-0210		
APPROVED BY	DATE	SHEET NO. 1 OF 5		
KJANOTA	2011/09/08			

MATERIAL NO. SEE CHART DOCUMENT NO. SD-111111-0210

PCB LAYOUT FOR SINGLE SIDE MOUNT

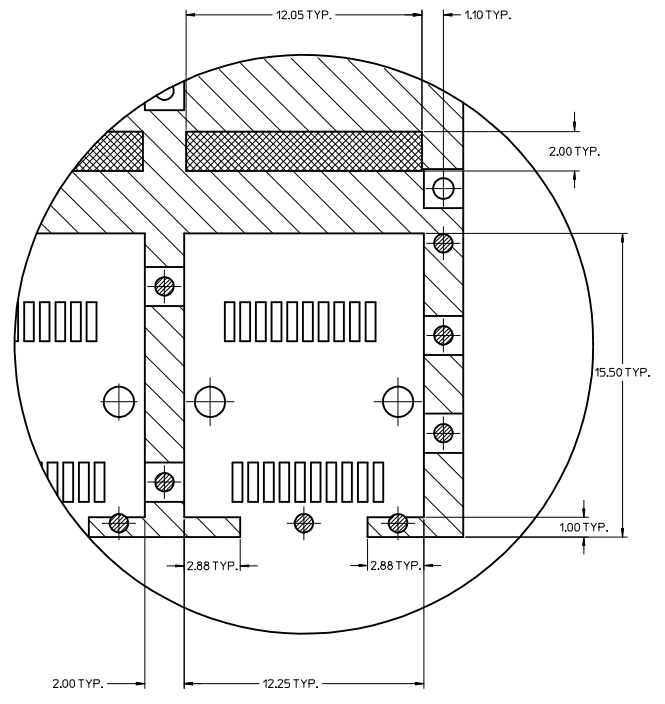
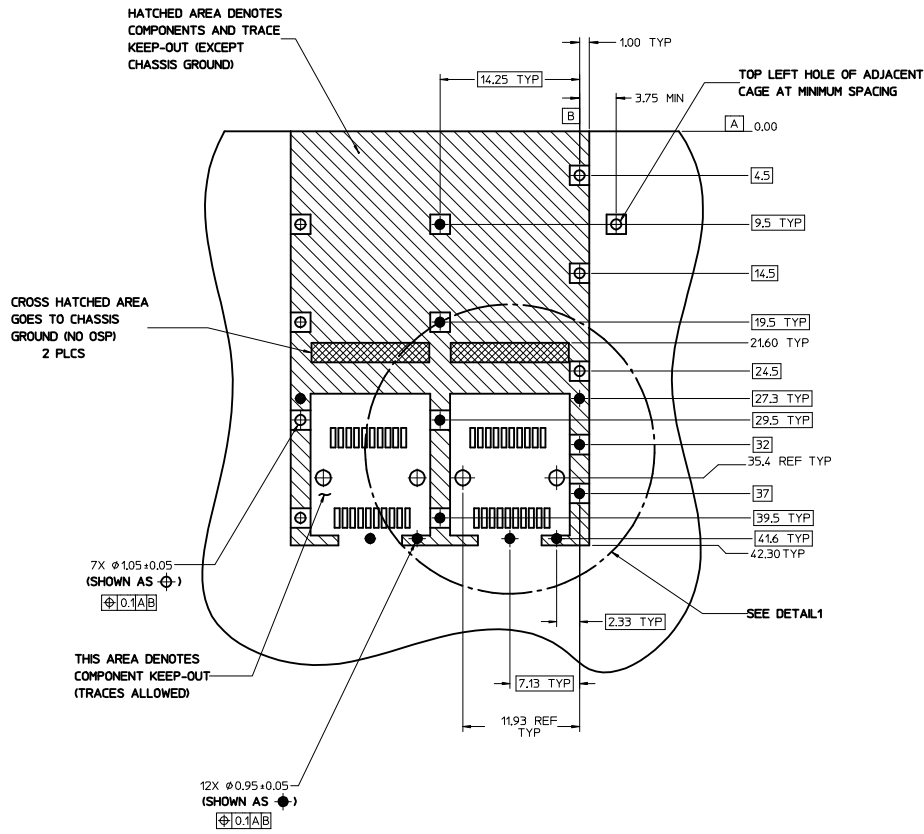

DETAIL 1
SCALE 8:1
HOST CONNECTOR DETAIL

NOTES (UNLESS OTHERWISE SPECIFIED):

1. PADS AND VIAS CONNECT TO CHASSIS GROUND (RECOMMEND PADS TO BE 2.00mm SQUARE)
2. RECOMMENDED THRU HOLE PLATING INCLUDES HASL, OSP, OR IMMERSION (GOLD, SILVER, OR TIN)
3. CONNECTOR PAD LAYOUT WILL ACCOMMODATE MOLEX CONNECTOR SERIES 170382 OR EQUIVALENT
4. HOLE PATTERN REPEATS FOR EACH PORT. SPACING BETWEEN PORTS IS 14.25mm.

SEE REVISION TABLE EC NO: CPG2016-3004 DRAWN BY: DRWNA/CHENG03 CHYK: APPR:RCHEN08 2016/02/04 2016/02/19	QUALITY SYMBOLS	GENERAL TOLERANCES (UNLESS SPECIFIED)	DIMENSION STYLE	SCALE	DESIGN UNITS	THIRD ANGLE PROJECTION
	▽=0	mm INCH	MM ONLY	3:1	METRIC	☉
	▽=0	4 PLACES ± --- ± ---	DRAWN BY DATE	TITLE		
	▽=0	3 PLACES ± --- ± ---	MDANIELS 2011/08/19	ZSFP+ 1X2 CAGE ASSY W/ PRESS FIT, ELASTOMER & BELLY PCB GASKETS		
	2 PLACES ± 0.15 ± ---	CHECKED BY DATE	MATERIAL NO.			SHEET NO.
	1 PLACE ± 0.25 ± ---	KJANOTA 2011/08/22	SD-111111-0210			2 OF 5
	0 PLACE ± ±	APPROVED BY DATE	DOCUMENT NO.			
		KJANOTA 2011/09/08	SEE SHEET 1			
			THIS DRAWING CONTAINS INFORMATION THAT IS PROPRIETARY TO MOLEX INCORPORATED AND SHOULD NOT BE USED WITHOUT WRITTEN PERMISSION			

PCB LAYOUT FOR BELLY TO BELLY MOUNTING

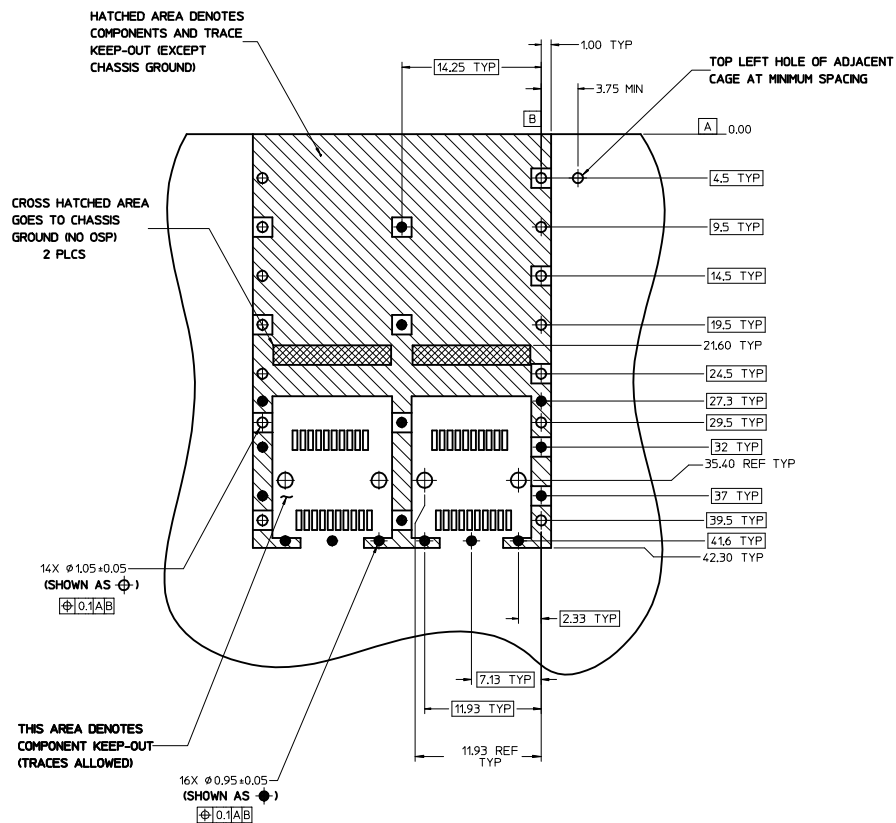

NOTE:

SEE SHEET 2 FOR
HOST CONNECTOR DETAIL

NOTES (UNLESS OTHERWISE SPECIFIED):

1. PADS AND VIAS CONNECT TO CHASSIS GROUND (RECOMMEND PADS TO BE 2.00mm SQUARE)
2. RECOMMENDED THRU HOLE PLATING INCLUDES HASL, OSP, OR IMMERSION (GOLD, SILVER, OR TIN)
3. CONNECTOR PAD LAYOUT WILL ACCOMMODATE MOLEX CONNECTOR SERIES 170382 OR EQUIVALENT
4. HOLE PATTERN REPEATS FOR EACH PORT. SPACING BETWEEN PORTS IS 14.25mm.

SEE REVISION TABLE IEC NO: CPG2016-3004 D DRYNACHENGO 2016/02/04 CHKD: APPR: CHEN08 2016/02/19	QUALITY SYMBOLS	GENERAL TOLERANCES (UNLESS SPECIFIED)	DIMENSION STYLE	SCALE	DESIGN UNITS	THIRD ANGLE PROJECTION
	▽=0	mm INCH	MM ONLY	3:1	METRIC	
	▽=0	4 PLACES ± --- ± ---	DRAWN BY	DATE	TITLE	
	▽=0	3 PLACES ± --- ± ---	MDANIELS	2011/08/19	ZSFP+ 1X2 CAGE ASSY W/ PRESS FIT, ELASTOMER & BELLY PCB GASKETS	
	ANGULAR ± 1 °	DRAFT WHERE APPLICABLE MUST REMAIN WITHIN DIMENSIONS	CHECKED BY	DATE	DOCUMENT NO.	
			KJANOTA	2011/08/22	SD-111111-0210	
			APPROVED BY	DATE	SHEET NO.	
			KJANOTA	2011/09/08	3 OF 5	
			MATERIAL NO. SEE SHEET 1 SIZE D THIS DRAWING CONTAINS INFORMATION THAT IS PROPRIETARY TO MOLEX INCORPORATED AND SHOULD NOT BE USED WITHOUT WRITTEN PERMISSION			

BEZEL AND BOARD POSITION DIMENSIONS FOR SINGLE SIDE MOUNTING

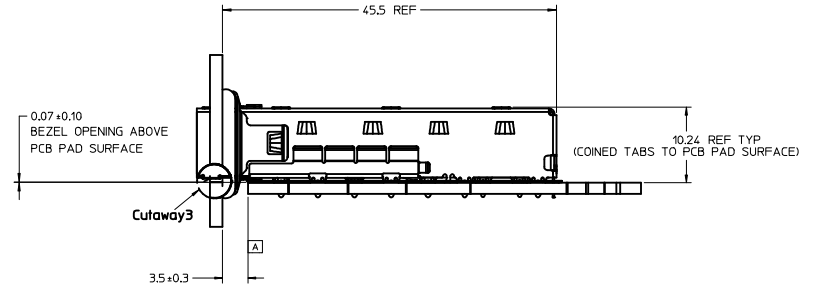
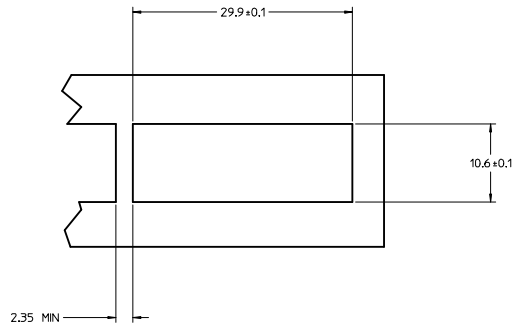

BEZEL AND BOARD POSITION DIMENSIONS FOR BELLY TO BELLY MOUNTING

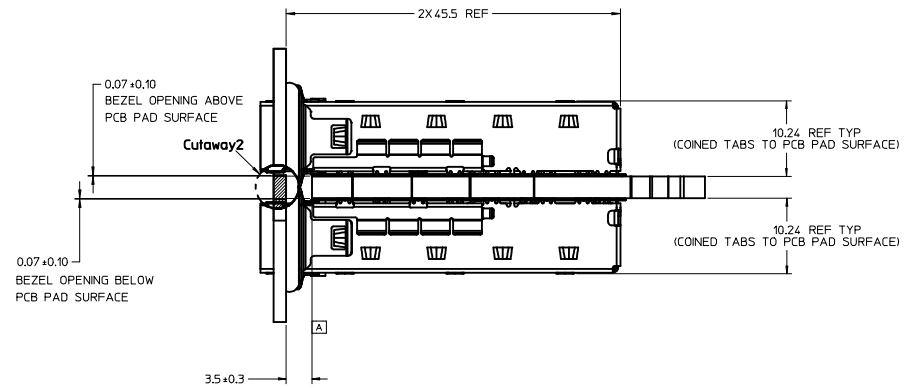
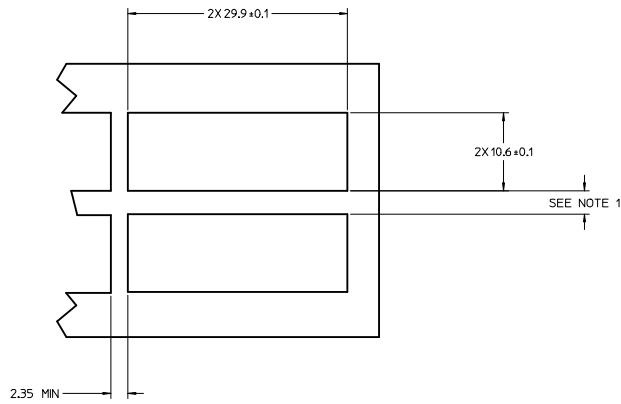

NOTES (UNLESS OTHERWISE SPECIFIED):

1. PCB THICKNESS VARIATION MUST BE CONSIDERED WHEN DETERMINING BEZEL OPENING SIZE AND LOCATION

SEE REVISION TABLE EC NO: CPG2016-3004 DRAWN BY: DRWNA/CHENG03 CHKD: CHYK APPROV: CHEN08 DATE: 2016/02/19	QUALITY SYMBOLS ∇=0 ∇=0 ∇=0	GENERAL TOLERANCES (UNLESS SPECIFIED) mm INCH 4 PLACES ± --- ± --- 3 PLACES ± --- ± --- 2 PLACES ± 0.15 ± --- 1 PLACE ± 0.25 ± --- 0 PLACE ± ±	DIMENSION STYLE MM ONLY	SCALE 3:1	DESIGN UNITS METRIC	THIRD ANGLE PROJECTION	
	MATERIAL NO. SEE SHEET 1	DATE 2011/08/19	DATE 2011/08/22	DATE 2011/09/08	TITLE ZSFP+ 1X2 CAGE ASSY W/ PRESS FIT, ELASTOMER & BELLY PCB GASKETS	DOCUMENT NO. SD-111111-0210	SHEET NO. 4 OF 5
	DRAFT WHERE APPLICABLE MUST REMAIN WITHIN DIMENSIONS						
	THIS DRAWING CONTAINS INFORMATION THAT IS PROPRIETARY TO MOLEX INCORPORATED AND SHOULD NOT BE USED WITHOUT WRITTEN PERMISSION						

DATE	REV	DESCRIPTION
2011/09/08	A	INITIAL RELEASE
2012/05/02	B	1. UPDATED THE TITLE IN TITLE BLOCK AND MODIFY THE GENERAL TOLERANCES 2. ADDED 111110212 AND 111110216 TO P/N TABLE, UPDATE RoHS NOTE AND MATERIAL NOTES ON SHEET 1 3. UPDATED DIMENSIONS TO MATCH STD DIMENSIONING METHOD 4. UPDATED THE HOST CONNECTOR DETAIL ON SHEET 2 5. UPDATED THE BEZEL OPENING DIMENSIONS AND ADD DATUM A ON SHEET 4
2012/08/15	C	UPDATE P/N 11111-0212 FLAMMABILITY RATING FROM UL94 HB TO UL94 V-0 ON CHART [SHEET 1]
2016/02/04	D	SHEET 4: D9: CORRECT TYPO. CHANGED 'ABOVE' TO 'BELOW'

SEE REVISION TABLE IEC NO: CPG2016-3004 DRAWN: ACHENG03 2016/02/04 CHKD: APPR: RCHEN08 2016/02/19 REV:	QUALITY SYMBOLS	GENERAL TOLERANCES (UNLESS SPECIFIED)	DIMENSION STYLE	SCALE	DESIGN UNITS	THIRD ANGLE PROJECTION
	▽=0	4 PLACES ± mm INCH	MM ONLY	3:1	METRIC	☉
	▽=0	3 PLACES ± 0.15				
	▽=0	2 PLACES ± 0.25				
	ANGULAR ± 1 °	DRAFT WHERE APPLICABLE MUST REMAIN WITHIN DIMENSIONS	MATERIAL NO.	DRAWN BY DATE		TITLE
			SEE SHEET 1	DANIELS 2011/08/19		ZSFP+ 1X2 CAGE ASSY W/ PRESS FIT, ELASTOMER & BELLY PCB GASKETS
				CHECKED BY DATE		
				KJANOTA 2011/08/22		
				APPROVED BY DATE		
				KJANOTA 2011/09/08		
				DOCUMENT NO.	SHEET NO.	
				SD-111111-0210	5 OF 5	
				THIS DRAWING CONTAINS INFORMATION THAT IS PROPRIETARY TO MOLEX INCORPORATED AND SHOULD NOT BE USED WITHOUT WRITTEN PERMISSION		