

THIS DRAWING IS A CONTROLLED DOCUMENT

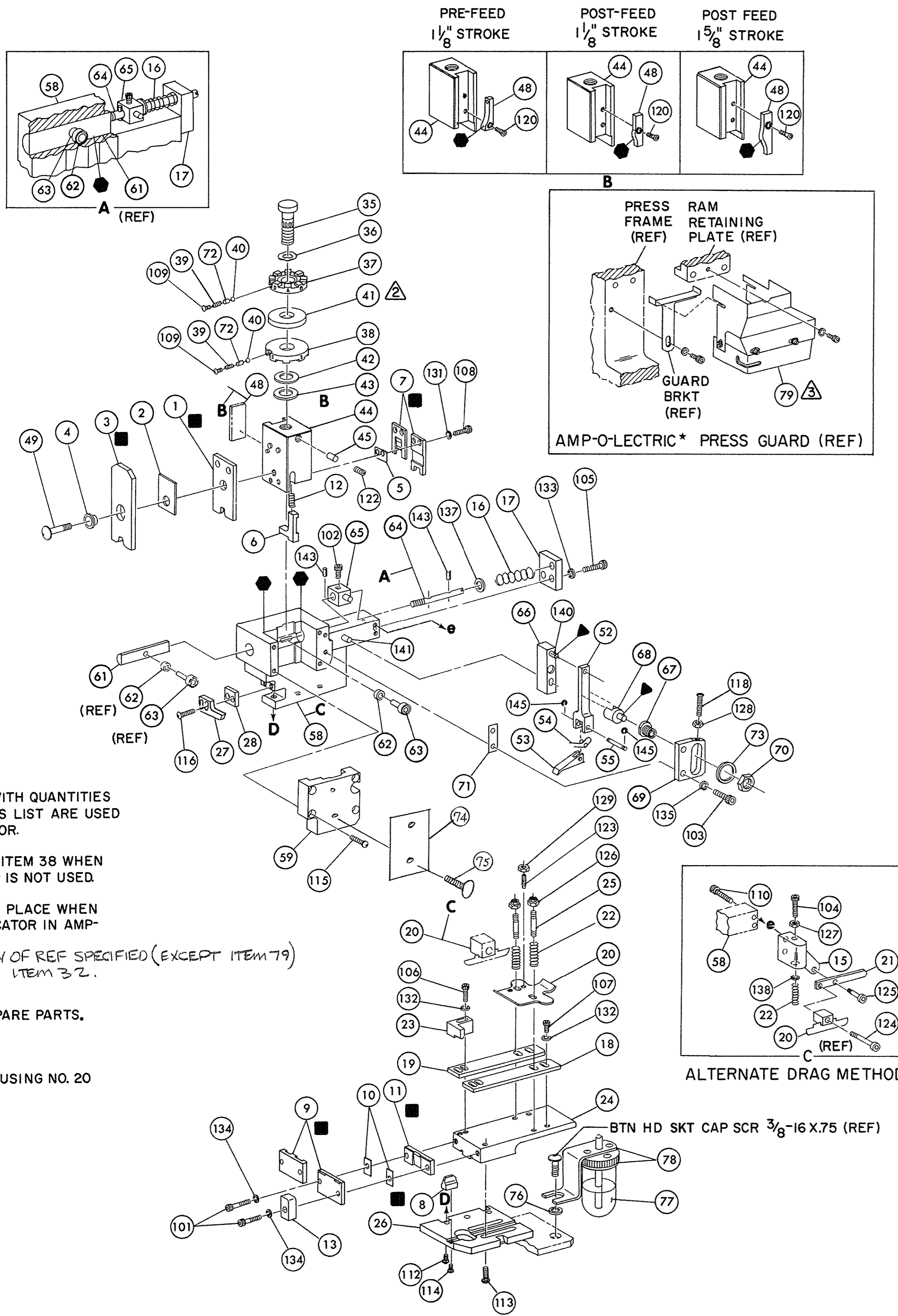

- NOTES:**
- 1. ONLY THE ITEMS WITH QUANTITIES SPECIFIED ON PARTS LIST ARE USED ON THIS APPLICATOR.
 - 2. USED IN PLACE OF ITEM 38 WHEN INSULATION CRIMP IS NOT USED.
 - 3. GUARD MUST BE IN PLACE WHEN OPERATING APPLICATOR IN AMP-O-LECTRIC PRESS.
 - 4. PARTS WITH QTY OF REF SPECIFIED (EXCEPT ITEM 79) ARE USED ON ITEM 32.
- KEY:**
- RECOMMENDED SPARE PARTS.
 - ▲ LUBRICATE DAILY USING NO. 20 MACHINE OIL.
 - GREASE LIGHTLY.

REF	PART NO	DESCRIPTION	ITEM NO	REF	PART NO	DESCRIPTION	ITEM NO
REF	21045-3	RING, RETAINING 'C' (.187 DIA) FEED PIN	145	REF	454220-1	CAP, RAM	59
REF	5-21028-1	PIN, SLOT SPG (.12 DIA X .50) FD ADJ ROD	143	REF	453736-1	HOUSING	58
REF	1-21030-7	PIN, DOWEL (.187 DIA X 1.50) HOUSING	141	REF	240624-1	PIN, FEED FINGER	55
REF	1-21030-1	PIN, DOWEL (.187 DIA X .50) LEVER	140	REF	691499-1	SPRING, FEED FINGER	54
REF	22260-5	WASHER, FLAT (NO 6) DRAG SPRING	138	REF	240635-1	FINGER, FEED	53
REF	21899-4	WASHER, FLAT (5/16 DIA) SCR ADJ	137	REF	240634-3	LEVER, TERMINAL	52
REF	21024-5	WASHER, LOCK (NO 10) FEED ADJ PLATE	136				50
2	21024-5	WASHER, LOCK (NO 10) SHEAR PLATES	134	1	7-21002-9	BOLT, CRIMPER	49
REF	21024-5	WASHER, LOCK (NO 10) FEED ROD GUIDE	133	1	690501-3	CAM, POST FEED 1/8\"/>	

QTY	PART NO	DESCRIPTION	ITEM NO
REF	454398-1	ROD, FEED	61
			60

REMARKS		NO	REV
APPL USED ON MACHINE PART NO		TO APPLY TERMINAL SPEC 114-2084	
CUSTOMER NAME		DISTRIBUTION	
ADDRESS		ORIGINAL	
CITY		CUSTOMER COPY	
		FIELD ENG COPY	

CRIMPING DATA				APPLICATOR WILL APPLY	
PAD LTR	CRIMP HEIGHT	WIRE SIZE	WIRE STRIP LENGTH	60546	
A	.086	14			
B	.076	16			
C	.070	18			
D	.066	20			