

PEN	INK COLOR
PX-10	WHITE

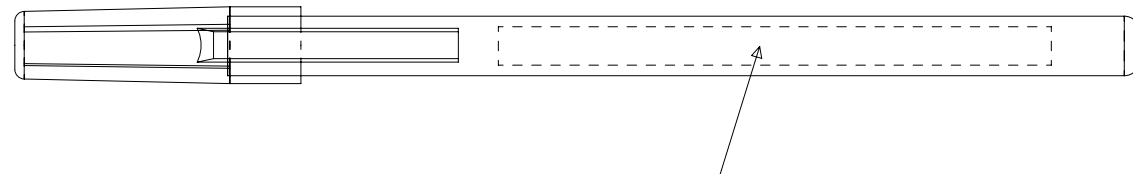

PANDUIT
 Nylon Marking Pen – White Ink
 Part No. PX-10
 www.panduit.com

NOTES:

1. FAST DRYING, PERMANENT INK - LEGIBLE IDENTIFICATION ON NYLON.
2. USED WITH MARKER TIES, WRITE-ON LABELS AND TAGS, WHERE ORDINARY MARKING PENS WILL NOT WORK.
3. MARKING PEN FOR BLACK OR OTHER DARK COLORED PARTS - REGULAR TIP.
4. INDOOR USE.

NOTE: ABOVE LOGO AND TEXT ILLUSTRATION IS FOR REFERENCE ONLY. SEE CURRENT ARTWORK; *Marking Pen-PX-10.pdf* 1 8/25/2015 2:23:21 PM FOR PRINTED BOX IMAGES. ART IS ON FILE WITH PANDUIT MARKETING GROUP.

REV	DATE	BY	CHK	APR	DESCRIPTION	ECN
02	8/26/15	BWG	MPH	JADE	"SHAKE WELL" REMOVED FROM LOGO ART & IS NOW IN MANUFACTURES INSTRUCTIONS ON PEN BODY. ADDED ILLUSTRATIONS NOTE & LOGO IMAGE.	SS-42999/02
1	5/17/13	BWG	KJM	RTFI	TITLE BORDER UPDATED WITH NO CHANGE TO MARKER.	SS-42999/01

TITLE		WHITE INK NYLON PX-10 MARKER	
CONTROL DRAWING			
ITEM REVISION NAME	W10001EC/02		
DATASET FILE NAME	W10001EC_DC/02-SS_42999_REV02		
UNLESS OTHERWISE SPECIFIED, DIMENSIONAL TOLERANCES ARE: IN [mm]		MATERIAL:	
.X :	.XXX :	DRAWING NUMBER: SS-42999	
.XX :	ANGLES :		
THIRD ANGLE PROJECTION		DRAWING NUMBER: SS-42999	
DRAWN BY	DATE	CHK	SCALE
BWG	5/17/13	RTFI	NONE
SHT 1 OF 1			SIZE B

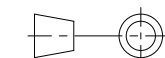

D10100DB/13