

CAD FILE
SBT08991.DGN
SD 87089-**-91

▽

DO NOT SCALE DRAWING

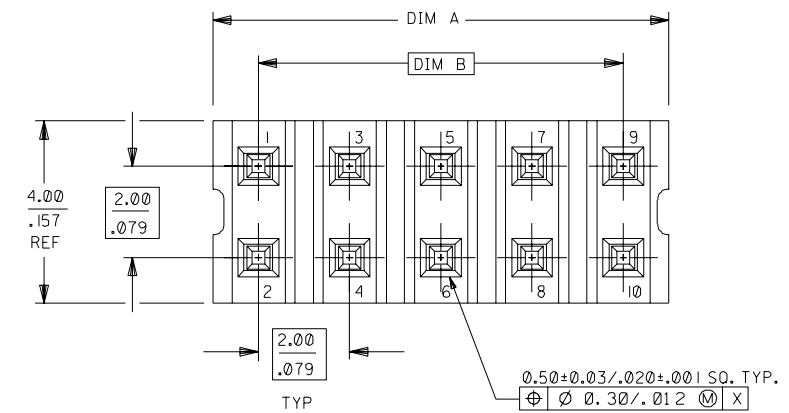

PART NUMBER LEGEND
87089- * * 9 1
CKT SIZE

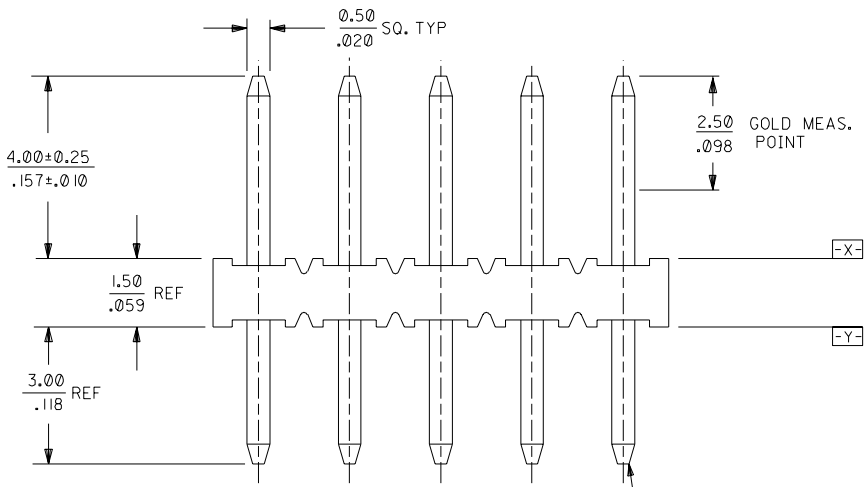

- NOTES:
- 1) 10 CKT SIZE SHOWN FOR ILLUSTRATION ONLY
 - 2) CKT I.D. NUMBERS ARE SHOWN FOR LOCATION IDENTIFICATION AND ARE NOT PRESENT ON MOLDED PARTS
 - 3) PLATING : 0.38um/15u" GOLD IN SELECTED AREA AND 1.90um/75u" MIN. TIN/LEAD IN SELECTED AREA OVER 1.27um/50u" MIN. NICKEL OVERALL

⚠ 4CKT & 6CKT SIZES ARE MADE BY CUTTING ASSEMBLY PART NOS. 87089-0891 & -1291. THE CUT END MUST NOT EXCEED THE TOLERANCE OF THE OVERALL LENGTH SPECIFIED.

0.50 ± 0.03 / .020 ± .001 SQ. TYP.
⊕ ∅ 0.30 / .012 Ⓜ Y

PART No.	CKT SIZE	DIM A		DIM B	
		MM	INCH	MM	INCH
87089-04**	4	3.90	.154	2.00	.079
87089-06**	6	5.90	.232	4.00	.157
87089-08**	8	7.90	.311	6.00	.236
87089-10**	10	9.90	.390	8.00	.315
87089-12**	12	11.90	.468	10.00	.394
87089-14**	14	13.90	.547	12.00	.472
87089-16**	16	15.90	.626	14.00	.551
87089-18**	18	17.90	.705	16.00	.630
87089-20**	20	19.90	.783	18.00	.709
87089-22**	22	21.90	.862	20.00	.787
87089-24**	24	23.90	.941	22.00	.866
87089-26**	26	25.90	1.020	24.00	.945
87089-28**	28	27.90	1.098	26.00	1.024
87089-30**	30	29.90	1.177	28.00	1.102
87089-32**	32	31.90	1.256	30.00	1.181
87089-34**	34	33.90	1.334	32.00	1.260
87089-36**	36	35.90	1.413	34.00	1.338
87089-38**	38	37.90	1.492	36.00	1.417
87089-40**	40	39.90	1.571	38.00	1.496
87089-42**	42	41.90	1.650	40.00	1.575
87089-44**	44	43.90	1.728	42.00	1.653
87089-46**	46	45.90	1.807	44.00	1.732
87089-48**	48	47.90	1.886	46.00	1.811
87089-50**	50	49.90	1.965	48.00	1.890

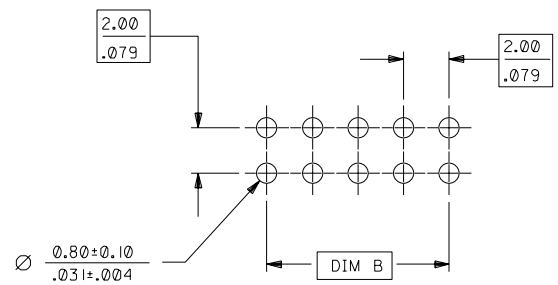

RECOMMENDED PCB PATTERN
(SCALE 5:1)

MM
INCH

				MATERIAL : HOUSING : 30% G.F NYLON 46 94V-0 COLOR BLACK PIN : 0.50mm SQ. PHOSPHOR BRONZE 510		MOLEX SINGAPORE PTE LTD SHEET 1 OF 1	
				FINISH : SEE NOTE 3		GENERAL TOLERANCES ± 0.20/0.008 REV B1	
B1 ADD DIM. "A" ON CKT 6 & 4		S50392	JACK	950215		DWC. NO. : SD 1 87089-**-91	
B ADD CKT SIZE MXS-PDR-1344		S40048	JACK	930727			
A RELEASE TO TOOLING		S30302	JACK	921130			
LTR	REVISION RECORD	ECN	DR	CHK	DATE	DRAWN BY 921130 J.WAN	CHK'D BY 921202 S.K.TOH
REVISE ONLY ON CAD SYSTEM						APPR'D BY 921202 R.WONG	TITLE : "MILLI-GRID" 2mm VERTICAL HEADER