

APPROVED: _____
 DATE: _____ TITLE: _____

Rev	AWO #	Description	Date	Appr
-		RELEASED	06/29/05	
A		REVISED SHAPE	9/9/11	
B		ADDED DIM.	6/22/15	AV/LL

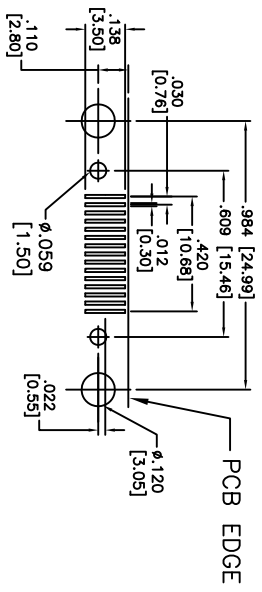
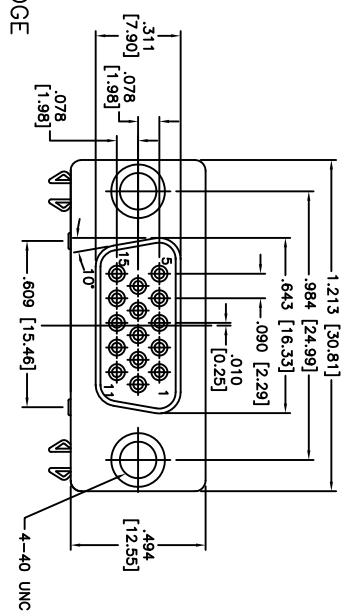

PIN LAYOUT: 6, 11, 1, 7, 12, 2, 8, 13, 3, 9, 14, 4, 10, 15, 5

RECOMMENDED PCB LAYOUT

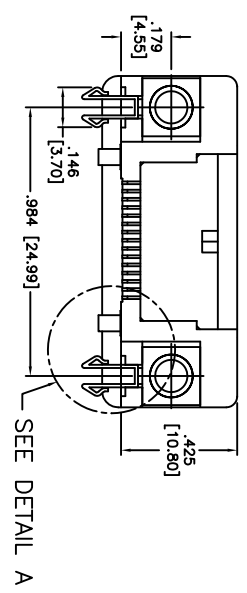

SEE DETAIL A

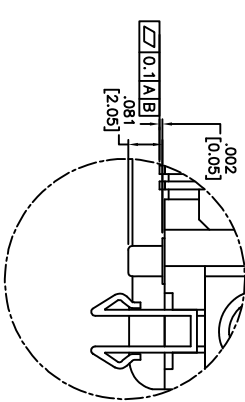

DETAIL A
SCALE 3:1

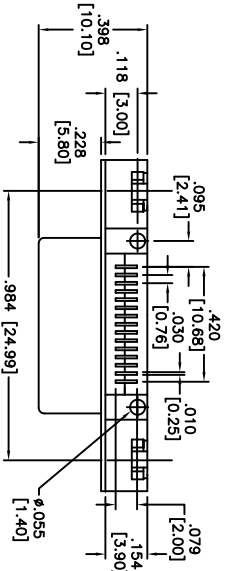

SPECIFICATIONS:

Material:
 Insulator: Hi-temp thermoplastic, rated UL 94V-0
 Insulator color: Black
 Contacts: Copper alloy
 Shell: SPCC, Nickel plated
 Board lock: Copper alloy, Tin plated
 Nut: Copper alloy, Nickel plated
Plating:
 Gold Flash over Nickel underplate on mating area,
 Tin over Copper underplate on SMT tails

Electrical:

Operating voltage: 300 VAC max
 Current rating: 5 Amps max
 Contact resistance: 13 mohms max.
 Insulation resistance: 1000 Mohms min
 Dielectric withstanding voltage: 500 VAC for 1 minute

Temperature Rating:

Operating temperature: -55°C to +105°C
 Environmental:
 Lead free, RoHS compliant.



UNLESS OTHERWISE SPECIFIED
 ALL DIMENSIONS ARE INCHES [MM]
 TOLERANCES: EXCEPT AS NOTED
 INCHES HOLES

.X	± .10	Ø.X	± .10
.XX	± .020	Ø.XXX	± .015
.XXX	± .015	Ø.XXX	± .010

APPROVALS

DRAWN	SS	DATE	06/29/05
CHECKED			
APPROVED			

ADAM TECH
 909 Railway Avenue, Union, NJ 07083
 Phone: 908-687-5000 Fax: 908-687-5710

TITLE: D-SUB, 15 POS FEMALE, RIGHT ANGLE, SMT

SIZE	PART NO.	REV.
X	HDL15-SS-24	B
REF:	S00003T	SHEET 1 OF 1
SCALE:	NIS	