

2

1

THIS COPY IS PROVIDED ON A RESTRICTED BASIS AND IS NOT TO BE USED IN ANY WAY DETRIMENTAL TO THE INTERESTS OF PANDUIT CORP.

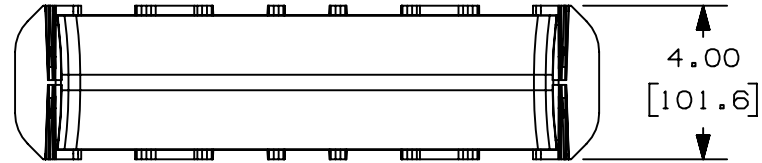

PANDUIT PART NUMBER	WEIGHT	MATERIAL
FRBC12X4**	1.2 LB/EACH (544g/EACH)	ABS-STEEL
FRBC12X4L**	1.2 LB/EACH (544g/EACH)	PC/ABS-STEEL

NOTES:

- SEE CURRENT CATALOG FOR ADDITIONAL PART SUFFIXES TO INDICATE COLOR AND/OR PACKAGE QUANTITY.
- DIMENSIONS IN PARENTHESES ARE IN METRIC.

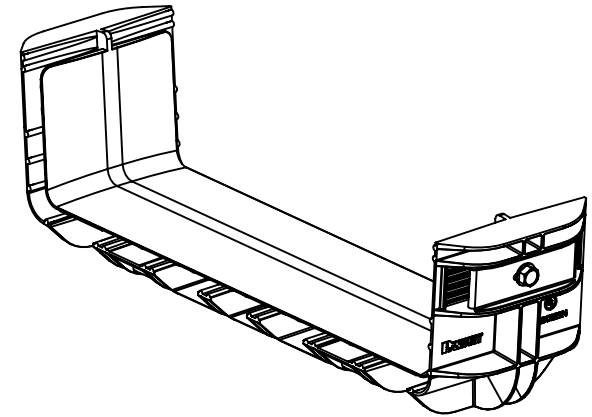
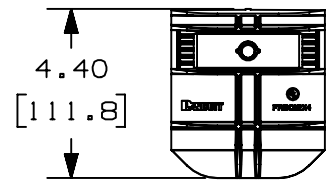
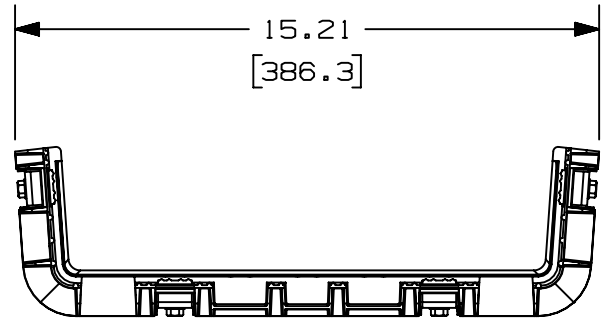

A

A

REV	DATE	BY	CHK	APR	DESCRIPTION	ECN
04B	1-14-20	MES	DWR	DWR	K. ADDED FRBC12X4L** PART NUMBER	V09002DZ/01
4	05-16-13	JBN	RTFI	RN	J. UPDATED DRAWING BORDER & TITLE BLOCK	37617-78

TITLE		FIBERRUNNER 12X4 QUIKLOCK COUPLER FRBC12X4**, FRBC12X4L**	
ITEM REVISION NAME		D37617DT/03	
DATASET FILE NAME		D37617DT_DC/04B	
UNLESS OTHERWISE SPECIFIED, DIMENSIONAL TOLERANCES ARE: IN [mm]		MATERIAL:	
.X ± .03 [.8]		SEE PART NUMBER TABLE ABOVE	
.XXX ± ANGLES ±		DRAWING NUMBER:	
THIRD ANGLE PROJECTION		37617-78	
DRAWN BY	DATE	CHK	SCALE
JHNU	01-03-01	DJWA	NONE
SHT 1 OF 1			SIZE
			A

D10100DA/15

2

1