

CUSTOMER PRINT

PART NUMBER: W4282-1XPG-300

ASS'Y P/N	CONTACTS	HOLE POS. CLOSED
W4282-10PG-300	10 - # 20	11, 12
W4282-11PG-300	11 - # 20	12
W4282-12PG-300	12 - # 20	NONE
W4282-1XPG-300		

NO. OF CONTACTS

- NOTES:
 1. ALL PARTS TO BE BULK PACKED.
 2. CONTACTS ASSEMBLED INTO CONNECTOR. SOLDER CUPS FACING TOP KEY.
 3. ALL DIMENSIONS ARE REFERENCE ONLY EXCEPT WHERE NOTED WITH A TOLERANCE. DIMENSIONS IN BRACKETS [] ARE METRIC.

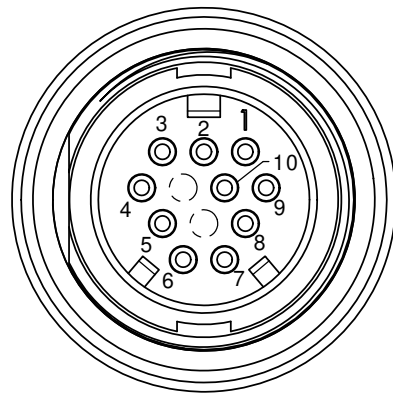

FACE VIEW
W4282-10PG-300
10-POS.

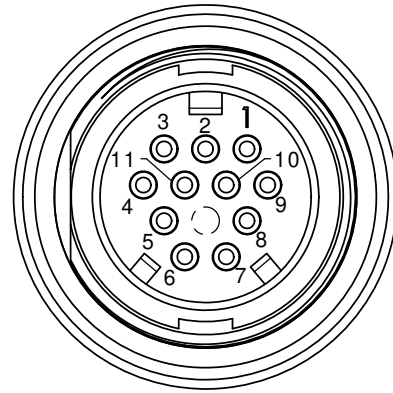

FACE VIEW
W4282-11PG-300
11-POS.

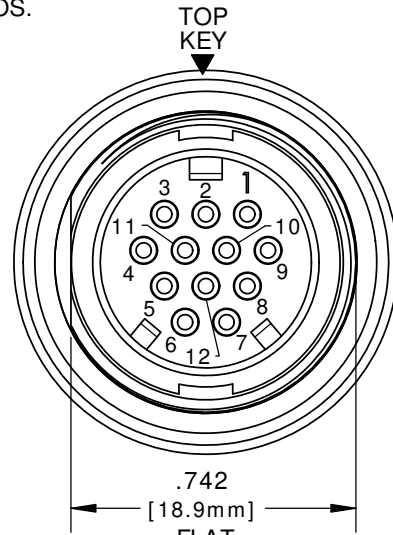

FACE VIEW
W4282-12PG-300
12-POS.

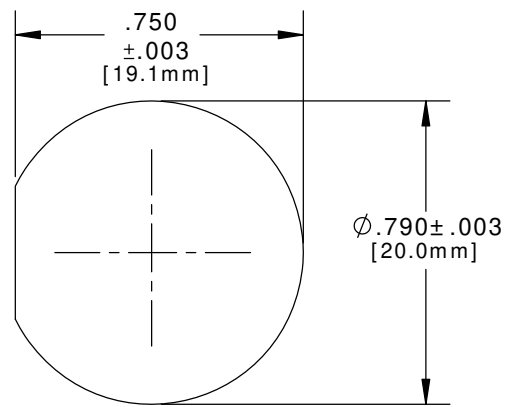
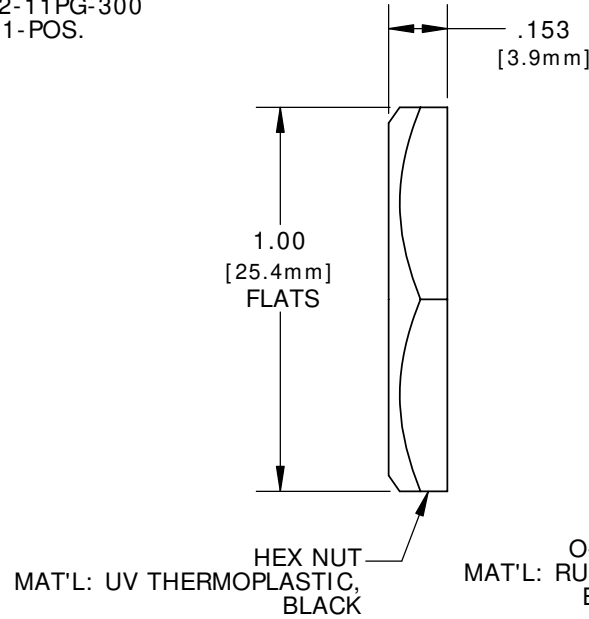
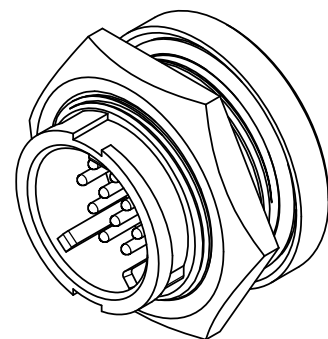

**RECOMMENDED
 PANEL CUTOUT
 STANDARD MULTI-CON-X**

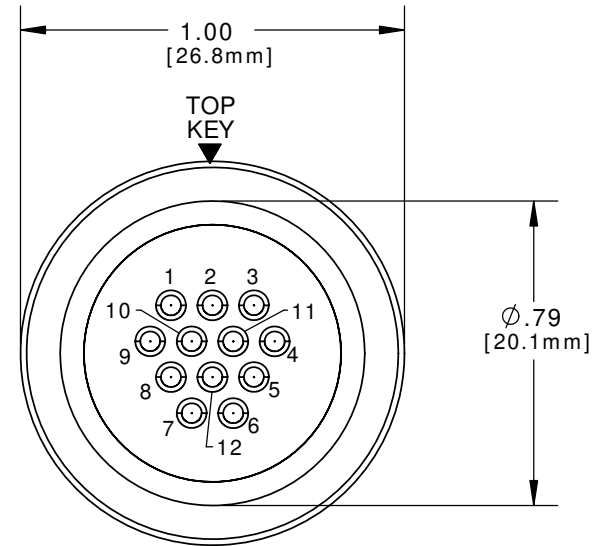
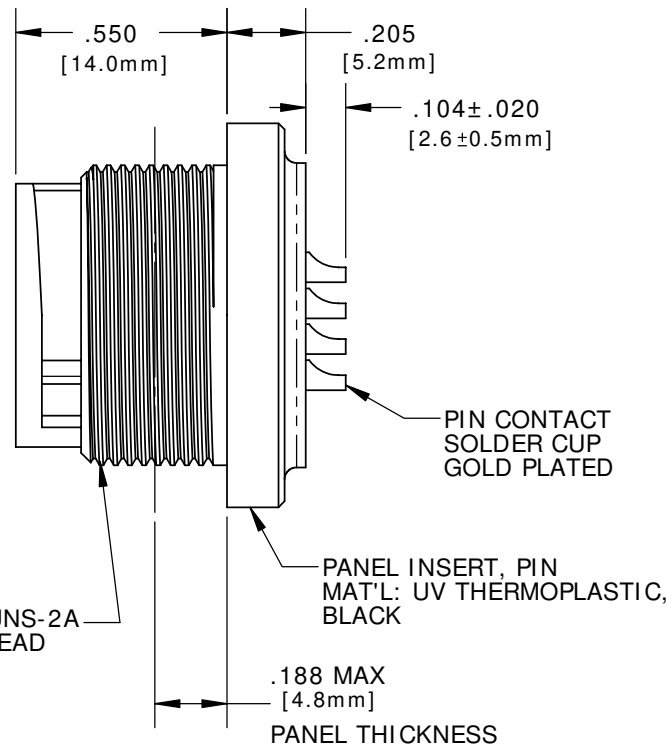

WIRE VIEW
 W4282-10PG-300 - 10-POS. (11&12 CLOSED)
 W4282-11PG-300 - 11-POS. (12 CLOSED)
 W4282-12PG-300 - 12-POS. (ALL OPEN)

CUSTOMER APPROVAL

THIS DOCUMENT CONTAINS CONFIDENTIAL INFORMATION PROPRIETARY TO CONXALL CORPORATION. ANY REPRODUCTION, DISCLOSURE, OR USE OF THIS DOCUMENT / INFORMATION IS EXPRESSLY PROHIBITED UNLESS AUTHORIZED IN WRITING BY CONXALL CORPORATION.

APPROVED BY: _____
 DATE: _____

A	PAK	09/12/19	DRAWING CREATED AND RELEASED PER DOR 10-2523JS-1
REV.	INIT.	DATE	DESCRIPTION
			ORIG. DRAWN BY: DATE: PAK 10/07/14
ALL INFORMATION ILLUSTRATED IS THE PROPERTY OF CONXALL CORPORATION. UNAUTHORIZED DUPLICATION OR DISTRIBUTION OF THIS DOCUMENT IS PROHIBITED.			<p>601 E. WILDWOOD VILLA PARK, IL 60181</p>
UNLESS OTHERWISE SPECIFIED TOLERANCES: 3 PLACE DECIMALS ±.005 ANGLES ±1° FRACTIONS ±1/16			
APPROVED BY:		SCALE: NTS	TITLE: PANEL PIN, E-KEY #20 SOLDER, 12-POS. PATTERN MULTI-CON-X, WEATHER RESISTANT STANDARD PRODUCT
FILE: W4282-1XPG-300	DIRECTORY: SLW	SHEET: 1 OF 1	CUSTOMER: STANDARD PRODUCT
PART NUMBER: W4282-1XPG-300			REV: A