

SECTION Z-Z

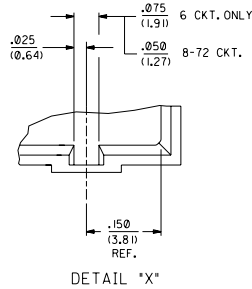

NOTES:

- 1- 20 CIRCUIT SIZE SHOWN FOR ILLUSTRATION PURPOSES.
- 2- PIN PUSHOUT FORCE (17.79N)/4 LBS. MIN.
- 3- PINS MUST MEET SOLDERABILITY SPEC. MIL-STD-202, METHOD 208B.
- 4- THIS PART CONFORMS TO MOLEX PRODUCT SPEC. NO. 70227 AND 70229.

MATERIAL:

SHROUDED WAFER: G.F. POLYESTER, COLOR: BLACK, 94V-0.
PINS: PHOS. BRONZE 510
SEE SHEET 2 FOR FINISHES.

CT.	DIM. 'A'	DIM. 'B'	DIM. 'X'					
06	.200 (5.08)	.500 (12.70)	.130 (3.30)					
08	.300 (7.62)	.600 (15.24)	.130 (3.30)					
10	.400 (10.16)	.700 (17.78)	.174 (4.42)					
12	.500 (12.70)	.800 (20.32)	.174 (4.42)					
14	.600 (15.24)	.900 (22.86)	.174 (4.42)					
16	.700 (17.78)	1.000 (25.40)	.174 (4.42)					
18	.800 (20.32)	1.100 (27.94)	.174 (4.42)					
20	.900 (22.86)	1.200 (30.48)	.174 (4.42)					
22	1.000 (25.40)	1.300 (33.02)	.174 (4.42)					
24	1.100 (27.94)	1.400 (35.56)	.174 (4.42)					
26	1.200 (30.48)	1.500 (38.10)	.174 (4.42)					
28	1.300 (33.02)	1.600 (40.64)	.174 (4.42)					
30	1.400 (35.56)	1.700 (43.18)	.174 (4.42)					
32	1.500 (38.10)	1.800 (45.72)	.174 (4.42)					
34	1.600 (40.64)	1.900 (48.26)	.174 (4.42)					
36	1.700 (43.18)	2.000 (50.80)	.174 (4.42)					
38	1.800 (45.72)	2.100 (53.34)	.174 (4.42)					
40	1.900 (48.26)	2.200 (55.88)	.174 (4.42)					
42	2.000 (50.80)	2.300 (58.42)	.174 (4.42)					
44	2.100 (53.34)	2.400 (60.96)	.174 (4.42)					
46	2.200 (55.88)	2.500 (63.50)	.174 (4.42)					
48	2.300 (58.42)	2.600 (66.04)	.174 (4.42)					
50	2.400 (60.96)	2.700 (68.58)	.174 (4.42)					
52	2.500 (63.50)	2.800 (71.12)	.174 (4.42)					
54	2.600 (66.04)	2.900 (73.66)	.174 (4.42)					
56	2.700 (68.58)	3.000 (76.20)	.174 (4.42)					
58	2.800 (71.12)	3.100 (78.74)	.174 (4.42)					
60	2.900 (73.66)	3.200 (81.28)	.174 (4.42)					
62	3.000 (76.20)	3.300 (83.82)	.174 (4.42)					
64	3.100 (78.74)	3.400 (86.36)	.174 (4.42)					
66	3.200 (81.28)	3.500 (88.90)	.174 (4.42)					
68	3.300 (83.82)	3.600 (91.44)	.174 (4.42)					
70	3.400 (86.36)	3.700 (93.98)	.174 (4.42)					
72	3.500 (88.90)	3.800 (96.52)	.174 (4.42)					

OPTION A ASSEMBLY
SEE SHEET 2 FOR OPTION B ASSEMBLY WITH DRAIN HOLES

3	K				
2	J2				
1	K				
1	K				

MFG.	SH.	REV.	REV.	REV.	REV.
3	K				
2	J2				
1	K				

DATE	REV.	APP.	DESCRIPTION
08/29/07			
08/29/07			
08/29/07			

DATE	REV.	APP.	DESCRIPTION
08/29/07			
08/29/07			
08/29/07			

