

REVISIONS				
P	LTR	DESCRIPTION	DATE	APVD
	K2	REV PER ECN-22-156403	03JUN2022	RK CSD

**AMP**  
WIRE RANGE

---

24-20 AWG  
STRANDED

- 1 WIRE INSULATION DIA 1.02 [.040] TO 2.54 [.100].
- 2 FINISH: BODY AND SLEEVE: TIN/LEAD (93-7) PLATE PER ASTM B545. (3% MIN LEAD CONTENT)
- 3 MATERIAL: BODY AND SLEEVE, COPPER PER ASTM B152  
INSULATION: PVF<sup>2</sup>  
COLOR- NATURAL

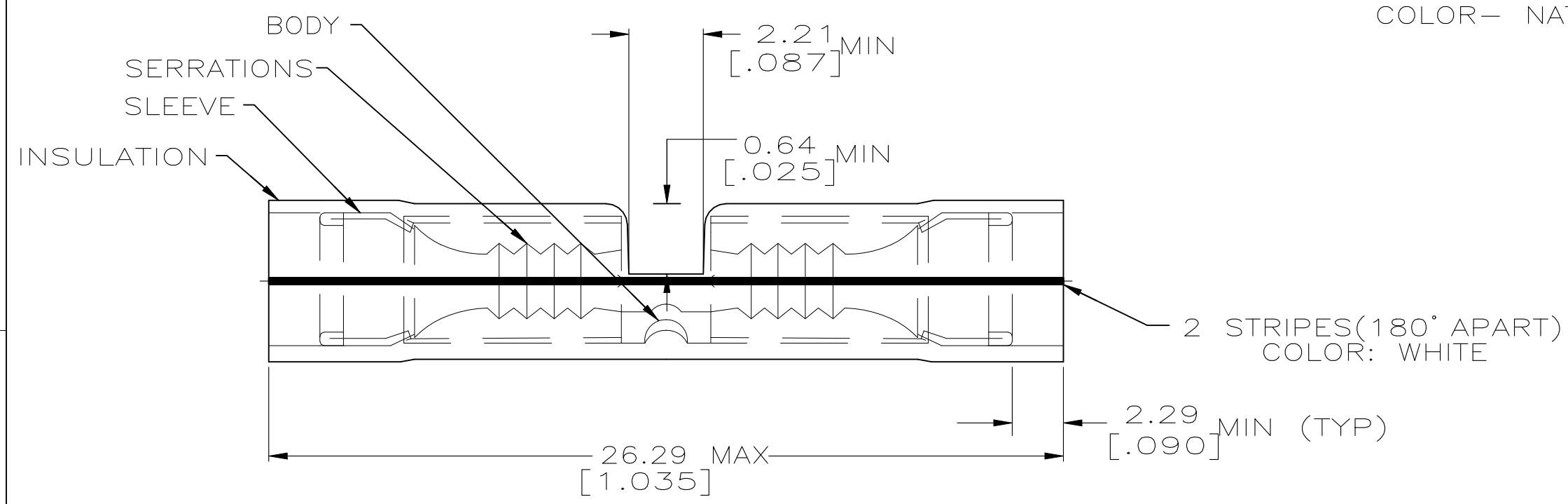

-	2500	ON TAPE	53547-2
M7928/6-2 CLASS 1	1000	LOOSE PIECE	53547-1
MILITARY PART NUMBER & CLASS PER MIL-T-7928	QTY	PACKAGE TYPE	PART NO.

<b>AMP INCORPORATED CUSTOMER SERVICE SYSTEMS</b>		MAX RECOMMENDED OPERATING TEMPERATURE: 150°C
FOR ADDITIONAL PRODUCT INFORMATION OR COPIES OF DRAWINGS AND TECHNICAL DOCUMENTS	PRODUCT INFORMATION CENTER 1-800-522-6752	VOLTAGE RATING: -
FOR APPLICATION TOOLING INFORMATION	TOOLING ASSISTANCE CENTER 1-800-722-1111	CIRCULAR MIL AREA: 0.16-0.65mm <sup>2</sup> [202-1,290] STRANDED
FOR ORDER ENTRY	1-800-526-5142	THIS DRAWING IS A CONTROLLED DOCUMENT FOR AMP INCORPORATED. IT IS SUBJECT TO CHANGE AND THE CONTROLLING ENGINEERING ORGANIZATION SHOULD BE CONTACTED FOR THE LATEST REVISION.

THIS DRAWING IS A CONTROLLED DOCUMENT.	
DIMENSIONS: MM [INCHES]	TOLERANCES UNLESS OTHERWISE SPECIFIED:
	0 PLC ± -
	1 PLC ± -
	2 PLC ± 0.20 [.008]
	3 PLC ± -
	4 PLC ± -
	ANGLES ± -
MATERIAL	FINISH
- 3	- 2

DWN S.S. GOULDEN 9-28-93	<b>STE</b> TE Connectivity	NAME		SPLICE, BUTT, PVF <sup>2</sup> , P.I.D.G. WIRE SIZE: 24-20 AWG			
CHK R. HERSEY 9-28-93		APVD M ELLIS 9-28-93		-			
PRODUCT SPEC		108-11023		SIZE	CAGE CODE	DRAWING NO	RESTRICTED TO
APPLICATION SPEC		-		A3	00779	C-53547	-
WEIGHT	-		CUSTOMER DRAWING		SCALE 1:1	SHEET 1 OF 1	REV K2