

RCU-G-02.00-AMS-AM

RCU SERIES

IP68 SEALED USB CABLE PLUG

SPECIFICATIONS

For complete specifications see www.samtec.com?RCU

- Insulator Material:** Glass Filled Thermoplastic
- Contact Material:** Phosphor Bronze
- Current Rating:** 4.2 A per pin (1 pin powered)
- Operating Temp Range:** -20 °C to +80 °C
- Shield Material:** Phosphor Bronze
- Wire:** 20 AWG (Power)
25 AWG (Signal)
28 AWG (Drain)

Mates with:
RPCU, RPBU

DUST CAPS

- AMS = DCA-RCU-01-01-A
- BMS = DCA-RCU-01-01-B

ALSO AVAILABLE (MOQ Required)

- Other wire lengths
- End option 2 with -AMS, -BMS or -BM

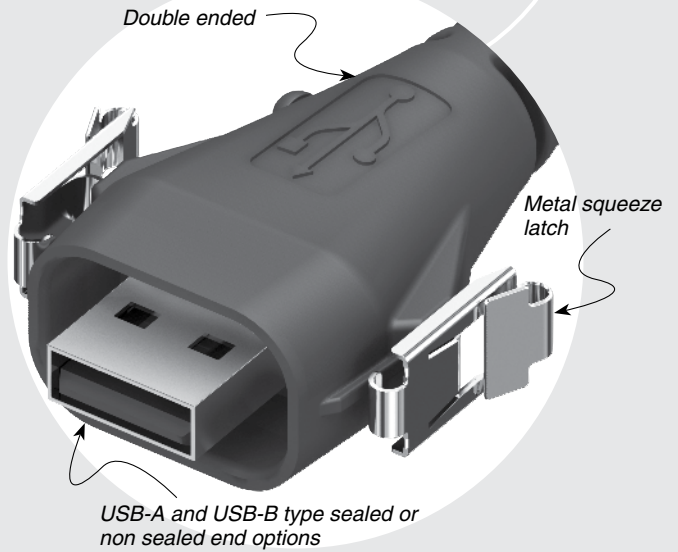

RCU	PLATING	WIRE LENGTH	END 1 OPTION	END 2 OPTION
	<p>-G = 30 μ" (0.76 μm) Gold on contact, Nickel on shell</p>	<p>-01.00 = (1 m) 40" Cable</p> <p>-02.00 = (2 m) 79" Cable</p> <p>Standard lengths</p>	<p>-AMS = USB A Type, Sealed</p> <p>-BMS = USB B Type, Sealed</p>	<p>-AM = USB A Type, Not Sealed</p> <p>-BC = Blunt Cut</p>

