

- NOTES:
- 1) THIS SOCKET COMPLIES WITH ALL SPECIFICATIONS AND PERFORMANCE REQUIREMENTS FOR INTEL rPGA98X SERIES CPU PROCESSORS.
 - 2) SOCKET SHOWN IN OPEN POSITION.
 - 3) SEE SHEET 2 FOR DETAILS PERTAINING TO KEYING, MATERIAL AND PACKAGING OPTIONS.
 - 4) THIS PRODUCT SERIES COMPLIANT TO RoHS DIRECTIVE 2002/95/EC AND ELV DIRECTIVE 2000/53/EC.

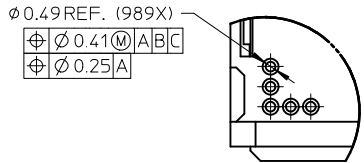
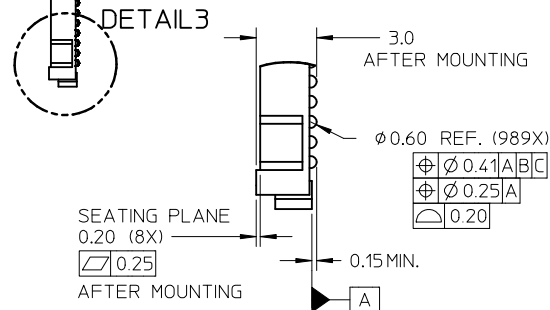
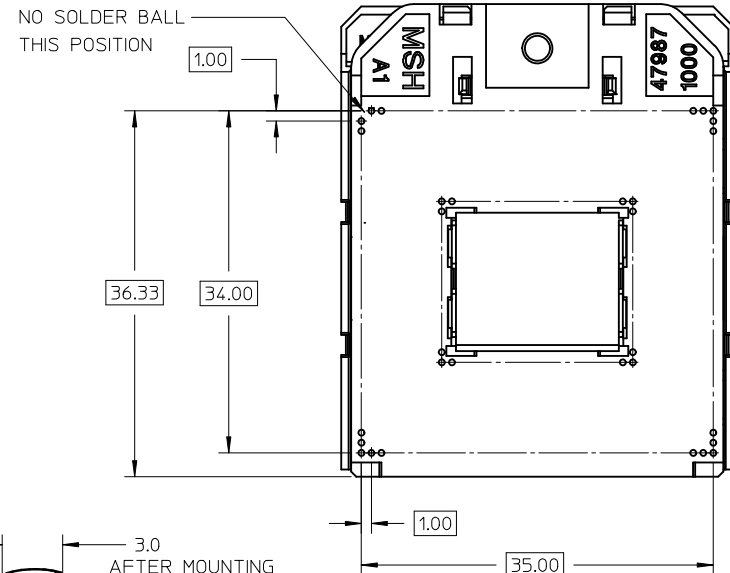

DETAIL 2

REVISED EC NO: SH2011-0076 DRWN:ZYAN CHKD: APPR:AYIN REV B	DESCRIPTION 2010/09/03 2010/09/06 2010/09/17	QUALITY SYMBOLS	GENERAL TOLERANCES (UNLESS SPECIFIED)		DIMENSION STYLE	SCALE	DESIGN UNITS	THIRD ANGLE PROJECTION	
		$F_A=0$ $F_C=0$ $F_P=0$	mm	INCH	MM ONLY	2:1	METRIC		
		4 PLACES ± --- ± --- 3 PLACES ± --- ± --- 2 PLACES ± 0.10 ± --- 1 PLACE ± 0.20 ± ---	DRAWN BY QWFANG DATE 2008/04/25		CHECKED BY JKACHLIC DATE 2008/05/29		APPROVED BY CL IANG DATE 2008/05/29		TITLE
		ANGULAR ± 2 °	DRAFT WHERE APPLICABLE MUST REMAIN WITHIN DIMENSIONS		MATERIAL NO. SEE TABLE		MATERIAL NO. SD-47989-001		SHEET NO. 1 OF 6

REMOVEABLE PICK & PLACE CAP

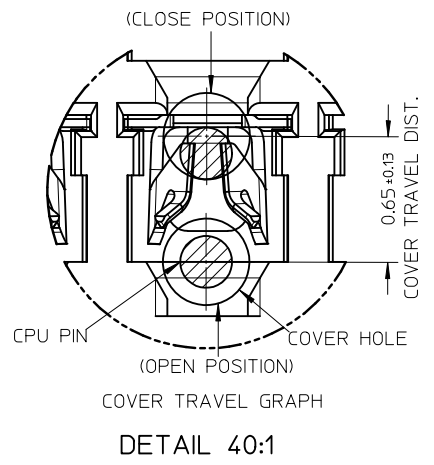
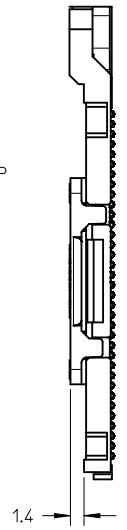
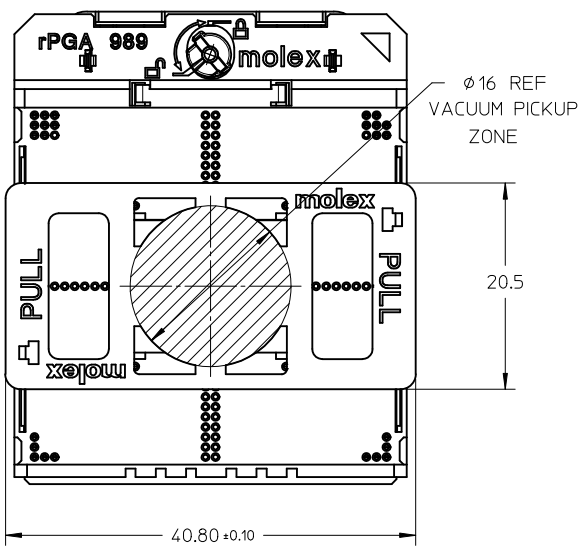

NOTES:

- 1) MATERIALS:
 MOLDED COMPONENTS: LIQUID CRYSTAL POLYMER (LCP) UL 94V-0
 BASE HOUSING COLOR: BLACK
 COVER COLOR: NATURAL
 MYLAR(POLYIMIDE, COLOR:ORANGE) OR PhP COVER(LCP, COLOR: BLACK)
 FOR PICK & PLACE.
 CONTACTS: HIGH STRENGTH COPPER ALLOY
 PLATING: GOLD THICKNESS AS FOLLOWING TABLE 1-3 IN CONTACT AREA,
 1.3um NICKEL OVERALL
 CAM COMPONENTS: STAINLESS STEEL
 SOLDER BALL: LEAD-FREE BALL SnAg3.0Cu0.5
- 2) DATE CODE *****
 MOLEX INTERNAL USE
 WORKING DAY
 MONTH
 YEAR
- 3) PRODUCT SPECIFICATION PS-47989-00* APPLIES
 4) PACKAGING SPECIFICATION: PK-47989-001 (TAPE & REEL)
 PK-47989-002 (HARD TRAY)

REVISED EC NO: SH2011-0076 DRWN:ZYUAN CHKD: APPR:AYIN	2010/09/03 2010/09/06 2010/09/17	REV DESCRIPTION	QUALITY SYMBOLS	GENERAL TOLERANCES (UNLESS SPECIFIED)	DIMENSION STYLE	SCALE	DESIGN UNITS	THIRD ANGLE PROJECTION	
			▽F=0	mm INCH	MM ONLY	2:1	METRIC	□	
			▽F=0	4 PLACES ± --- ± ---	DRAWN BY DATE	TITLE	MATERIAL NO.	DOCUMENT NO.	SHEET NO.
			▽F=0	3 PLACES ± --- ± ---	QWFANG 2008/04/25				
			2 PLACES ± 0.10 ± ---	CHECKED BY DATE					
			1 PLACE ± 0.20 ± ---	APPROVED BY DATE					
			ANGULAR ± 2 °	CL IANG 2008/05/29					
			DRAFT WHERE APPLICABLE MUST REMAIN WITHIN DIMENSIONS	SEE TABLE					
				SIZE A3	THIS DRAWING CONTAINS INFORMATION THAT IS PROPRIETARY TO MOLEX INCORPORATED AND SHOULD NOT BE USED WITHOUT WRITTEN PERMISSION				

PART NO. OF GF PLATING- TABLE 1

PART NUMBER	PICK UP TYPE		PACKAGE TYPE		PRODUCT SPEC.
	MYLAR	CAP	T&R	HARD TRAY	
47989-0110	◆			◆	PS-47989-002
47989-0120	◆		◆		
47989-0130		◆		◆	
47989-0140		◆	◆		
47989-0210	◆			◆	
47989-0220	◆		◆		
47989-0230		◆		◆	
47989-0240		◆	◆		

PART NO. OF 10u" MIN. GOLD PLATING- TABLE 2

PART NUMBER	PICK UP TYPE		PACKAGE TYPE		PRODUCT SPEC.
	MYLAR	CAP	T&R	HARD TRAY	
47989-0111	◆			◆	PS-47989-003
47989-0121	◆		◆		
47989-0131		◆		◆	
47989-0141		◆	◆		
47989-0211	◆			◆	
47989-0221	◆		◆		
47989-0231		◆		◆	
47989-0241		◆	◆		

PART NO. OF 15u" MIN. GOLD PLATING- TABLE 3

PART NUMBER	PICK UP TYPE		PACKAGE TYPE		PRODUCT SPEC.
	MYLAR	CAP	T&R	HARD TRAY	
47989-0112	◆			◆	PS-47989-001
47989-0122	◆		◆		
47989-0132		◆		◆	
47989-0142		◆	◆		
47989-0212	◆			◆	
47989-0222	◆		◆		
47989-0232		◆		◆	
47989-0242		◆	◆		

SOCKET KEYING OPTIONS

MYLAR PICK & PLACE OPTION

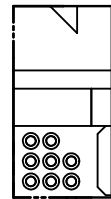
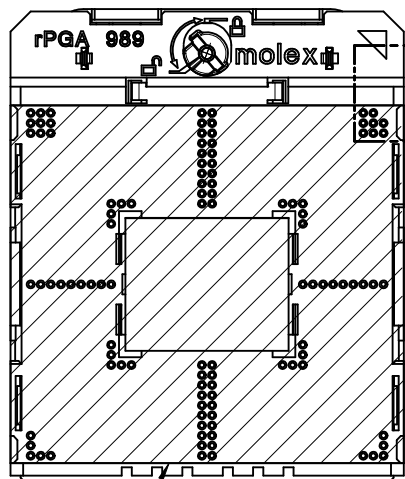

rPGA989
47989-01**

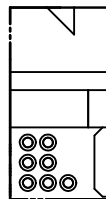

rPGA988A
47989-02**

MYLAR (NORMAL)

REVISED EC NO: SH2011-0076 DRWN:ZYAN CHKD: APPR:AYIN 2010/09/03 2010/09/06 2010/09/17	QUALITY SYMBOLS $F_A=0$ $F_C=0$ $F_P=0$	GENERAL TOLERANCES (UNLESS SPECIFIED)		DIMENSION STYLE MM ONLY		SCALE 2:1	DESIGN UNITS METRIC	THIRD ANGLE PROJECTION			
		4 PLACES ± --- ± --- 3 PLACES ± --- ± --- 2 PLACES ± 0.10 ± --- 1 PLACE ± 0.20 ± ---	mm INCH	DRAWN BY QWFANG	DATE 2008/04/25	TITLE RPGA989 SOCKET ASSEMBLY					
		ANGULAR ± 2 °		CHECKED BY JKACHLIC	DATE 2008/05/29	APPROVED BY CL IANG					
DRAFT WHERE APPLICABLE MUST REMAIN WITHIN DIMENSIONS	SEE TABLE		MATERIAL NO.		MOLEX INCORPORATED				SHEET NO. 3 OF 6		
THIS DRAWING CONTAINS INFORMATION THAT IS PROPRIETARY TO MOLEX INCORPORATED AND SHOULD NOT BE USED WITHOUT WRITTEN PERMISSION		DOCUMENT NO. SD-47989-001									

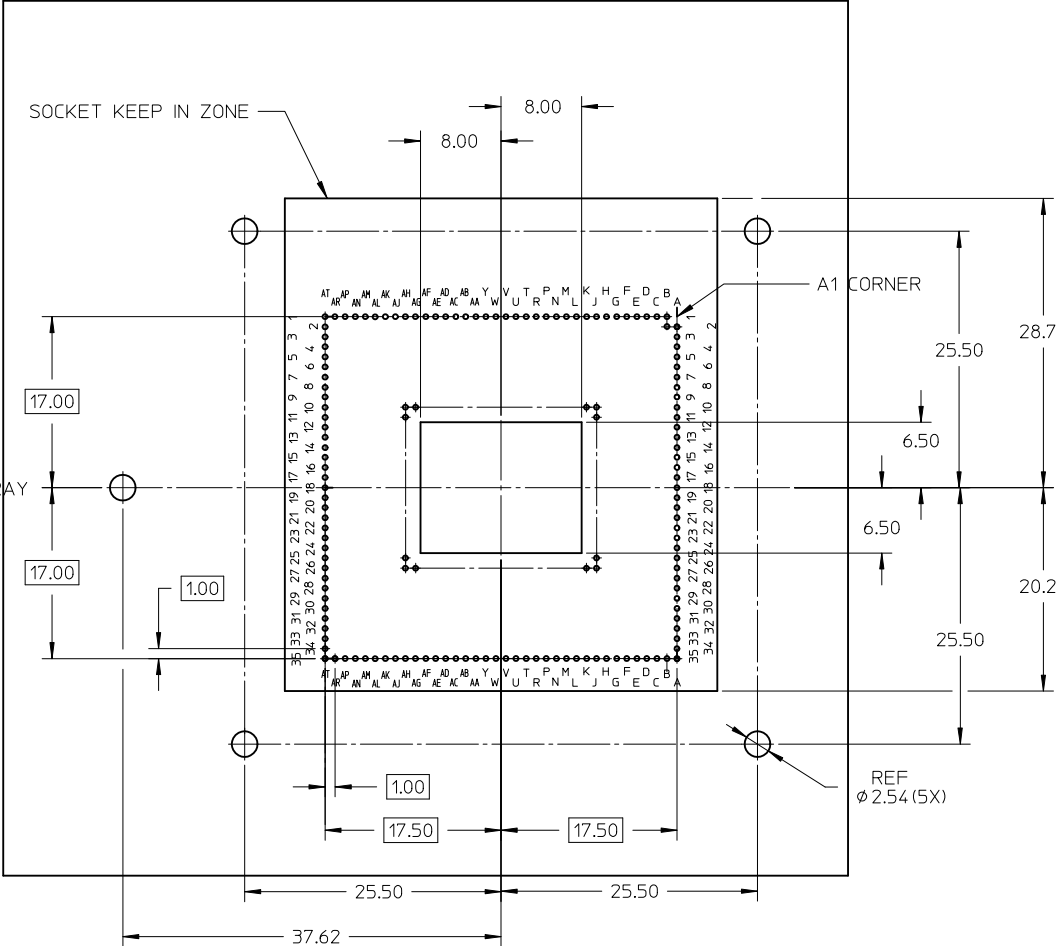

MOTHERBOARD KEEP IN ZONE (KIZ)
(FOR NORMAL)

NOTES:
shape pada of PCB are recommended

TYPE1-Corner Pads

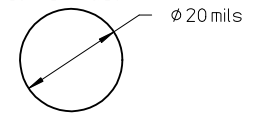

TYPE2-Peripheral Pads (Oblong-shape pada are recommended)

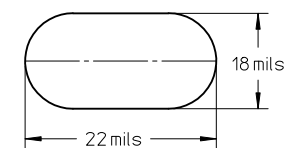

TYPE3-All Other Location Except for those of Type1 and Type2 Locations)

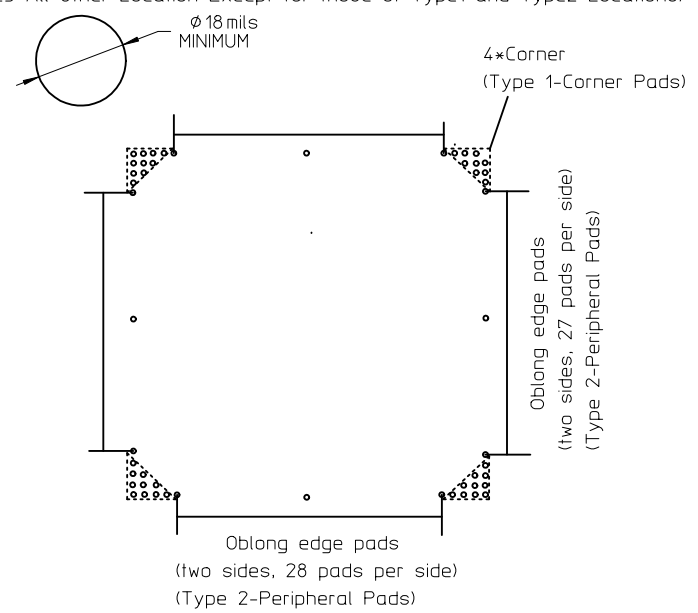

REVISED EC NO: SH2011-0076 DRWN:ZYAN CHKD: APPR:AYIN	2010/09/03 2010/09/06 2010/09/17	DESCRIPTION REV	QUALITY SYMBOLS	GENERAL TOLERANCES (UNLESS SPECIFIED)		DIMENSION STYLE		SCALE	DESIGN UNITS	THIRD ANGLE PROJECTION
			$F_A = 0$ $F_C = 0$ $F_D = 0$	mm INCH	MM ONLY		METRIC			
			4 PLACES ± --- ± --- 3 PLACES ± --- ± --- 2 PLACES ± 0.10 ± --- 1 PLACE ± 0.20 ± ---	DRAWN BY: QWFANG DATE: 2008/04/25 CHECKED BY: JKACHLIC DATE: 2008/05/29 APPROVED BY: CL IANG DATE: 2008/05/29	TITLE		RPGA989 SOCKET ASSEMBLY			
			ANGULAR ± 2 °	MATERIAL NO. DOCUMENT NO.	MOLEX INCORPORATED SD-47989-001		SHEET NO. 4 OF 6			
DRAFT WHERE APPLICABLE MUST REMAIN WITHIN DIMENSIONS			SIZE A3	THIS DRAWING CONTAINS INFORMATION THAT IS PROPRIETARY TO MOLEX INCORPORATED AND SHOULD NOT BE USED WITHOUT WRITTEN PERMISSION						

PART NO. OF GF PLATING- TABLE 1

PART NUMBER	PICK UP TYPE		PACKAGE TYPE		PRODUCT SPEC.
	MYLAR	CAP	T&R	HARD TRAY	
47989-9110	◆			◆	PS-47989-002
47989-9120	◆		◆	◆	
47989-9130		◆		◆	
47989-9140		◆	◆	◆	
47989-9210	◆			◆	
47989-9220	◆		◆	◆	
47989-9230		◆		◆	
47989-9240		◆	◆	◆	

PART NO. OF 10u" MIN. GOLD PLATING- TABLE 2

PART NUMBER	PICK UP TYPE		PACKAGE TYPE		PRODUCT SPEC.
	MYLAR	CAP	T&R	HARD TRAY	
47989-9111	◆			◆	PS-47989-003
47989-9121	◆		◆	◆	
47989-9131		◆		◆	
47989-9141		◆	◆	◆	
47989-9211	◆			◆	
47989-9221	◆		◆	◆	
47989-9231		◆		◆	
47989-9241		◆	◆	◆	

PART NO. OF 15u" MIN. GOLD PLATING- TABLE 3

PART NUMBER	PICK UP TYPE		PACKAGE TYPE		PRODUCT SPEC.
	MYLAR	CAP	T&R	HARD TRAY	
47989-9112	◆			◆	PS-47989-001
47989-9122	◆		◆	◆	
47989-9132		◆		◆	
47989-9142		◆	◆	◆	
47989-9212	◆			◆	
47989-9222	◆		◆	◆	
47989-9232		◆		◆	
47989-9242		◆	◆	◆	

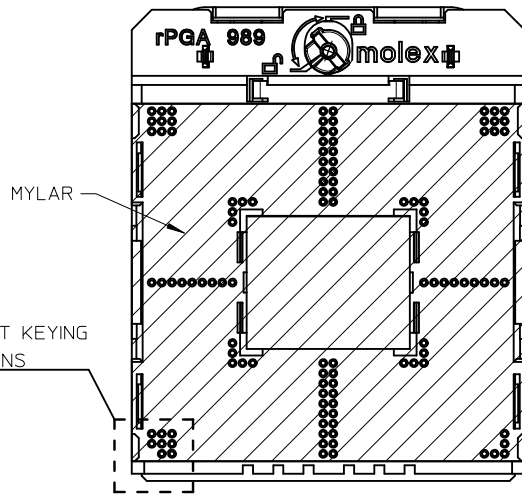
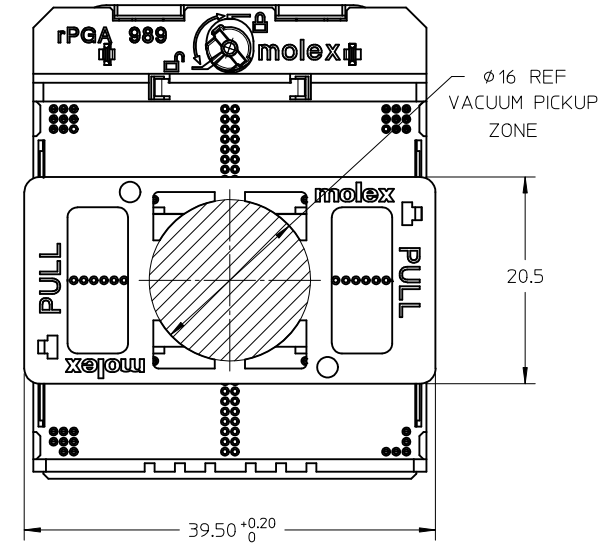

(180° ROTATION)

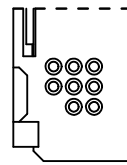

rPGA989
47989-91**

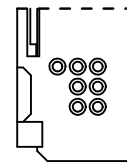

rPGA988A
47989-92**

REVISED EC NO: SH2011-0076 DRWN:ZYAN CHKD: APPR:AYIN	2010/09/03	2010/09/06	2010/09/17	QUALITY SYMBOLS $F_A=0$ $F_C=0$ $F_P=0$	GENERAL TOLERANCES (UNLESS SPECIFIED) mm INCH 4 PLACES ± --- ± --- 3 PLACES ± --- ± --- 2 PLACES ± 0.10 ± --- 1 PLACE ± 0.20 ± --- ANGULAR ± 2 °	DIMENSION STYLE MM ONLY DRAWN BY: QWFANG DATE: 2008/04/25 CHECKED BY: JKACHLIC DATE: 2008/05/29 APPROVED BY: CL IANG DATE: 2008/05/29	SCALE 2:1 DESIGN UNITS METRIC THIRD ANGLE PROJECTION	TITLE RPGA989 SOCKET ASSEMBLY			
	REV B	REV	MATERIAL NO. SEE TABLE						DOCUMENT NO. SD-47989-001	SHEET NO. 5 OF 6	
	DRAFT WHERE APPLICABLE MUST REMAIN WITHIN DIMENSIONS								MOLEX INCORPORATED THIS DRAWING CONTAINS INFORMATION THAT IS PROPRIETARY TO MOLEX INCORPORATED AND SHOULD NOT BE USED WITHOUT WRITTEN PERMISSION		

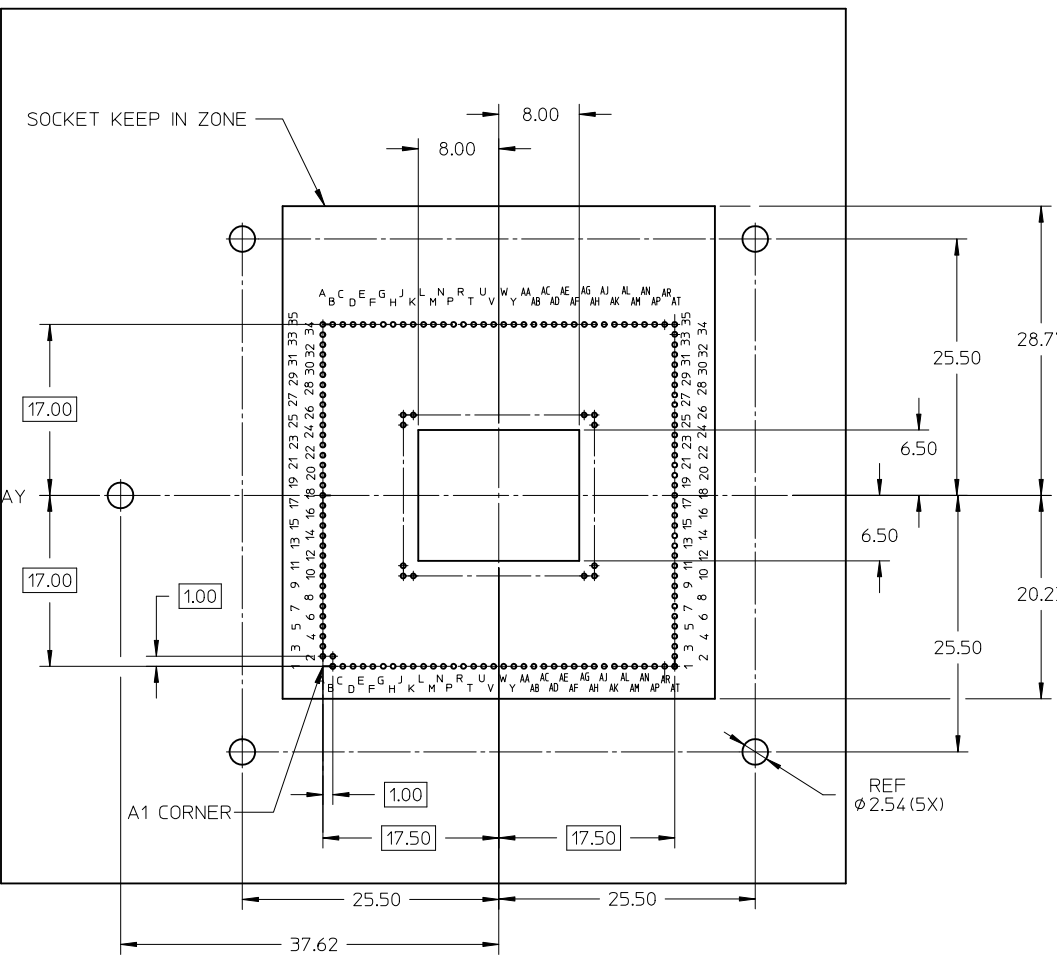

NOTES:
shape pada of PCB are recommended

TYPE1-Corner Pads

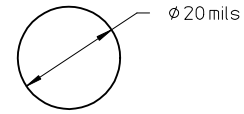

TYPE2-Peripheral Pads(Oblong-shape pada are recommended)

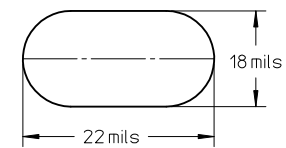

TYPE3-All Other Location Except for those of Type1 and Type2 Locations)

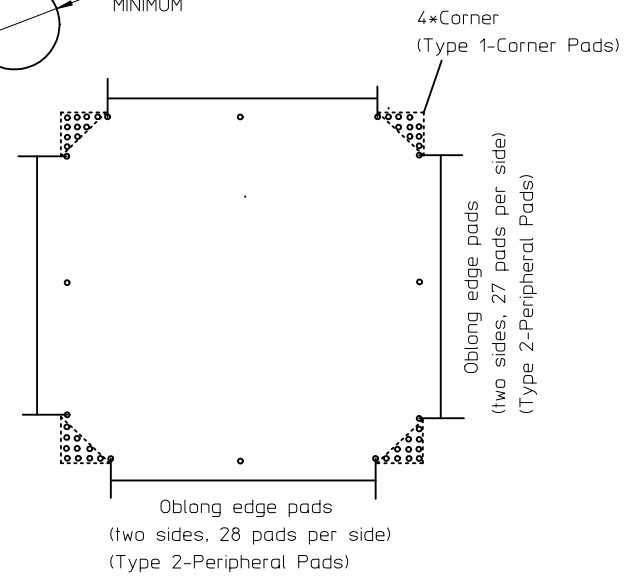
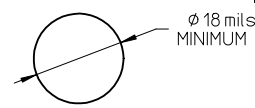

MOTHERBOARD KEEP IN ZONE (KIZ)
(FOR 180° ROTATION)

REVISED EC NO: SH2011-0076 DRWN:ZYXAN CHKD: APPR:AYIN	QUALITY SYMBOLS $\nabla = 0$ $\nabla = 0$ $\nabla = 0$	GENERAL TOLERANCES (UNLESS SPECIFIED)		DIMENSION STYLE		SCALE	DESIGN UNITS	THIRD ANGLE PROJECTION			
				MM ONLY		2:1	METRIC				
				mm	INCH	DRAWN BY	DATE	TITLE			
						QWFANG	2008/04/25	RPGA989 SOCKET ASSEMBLY			
				3 PLACES ± --- ± ---		CHECKED BY	DATE	MOLEX INCORPORATED DOCUMENT NO. SD-47989-001			
				2 PLACES ± 0.10 ± ---		JKACHLIC	2008/05/29				SHEET NO. 6 OF 6
				1 PLACE ± 0.20 ± ---		APPROVED BY	DATE	THIS DRAWING CONTAINS INFORMATION THAT IS PROPRIETARY TO MOLEX INCORPORATED AND SHOULD NOT BE USED WITHOUT WRITTEN PERMISSION			
				ANGULAR ± 2 °		CL IANG	2008/05/29				
				DRAFT WHERE APPLICABLE MUST REMAIN WITHIN DIMENSIONS		MATERIAL NO.					
						SEE TABLE					
						SIZE A3					

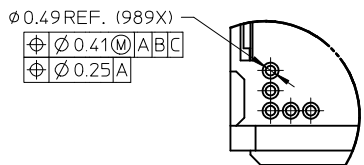
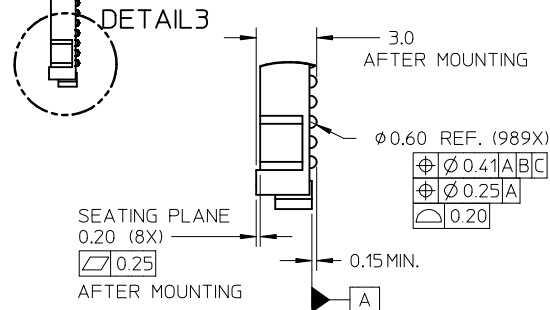
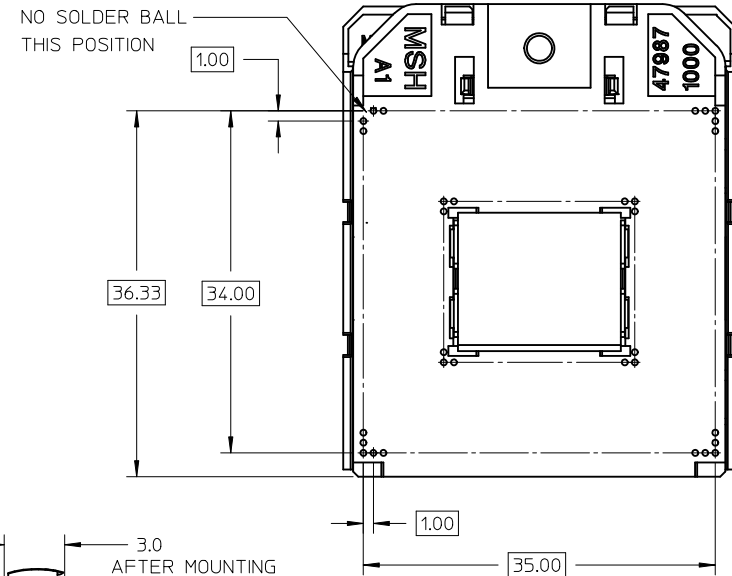
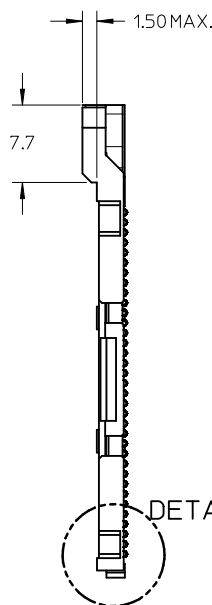
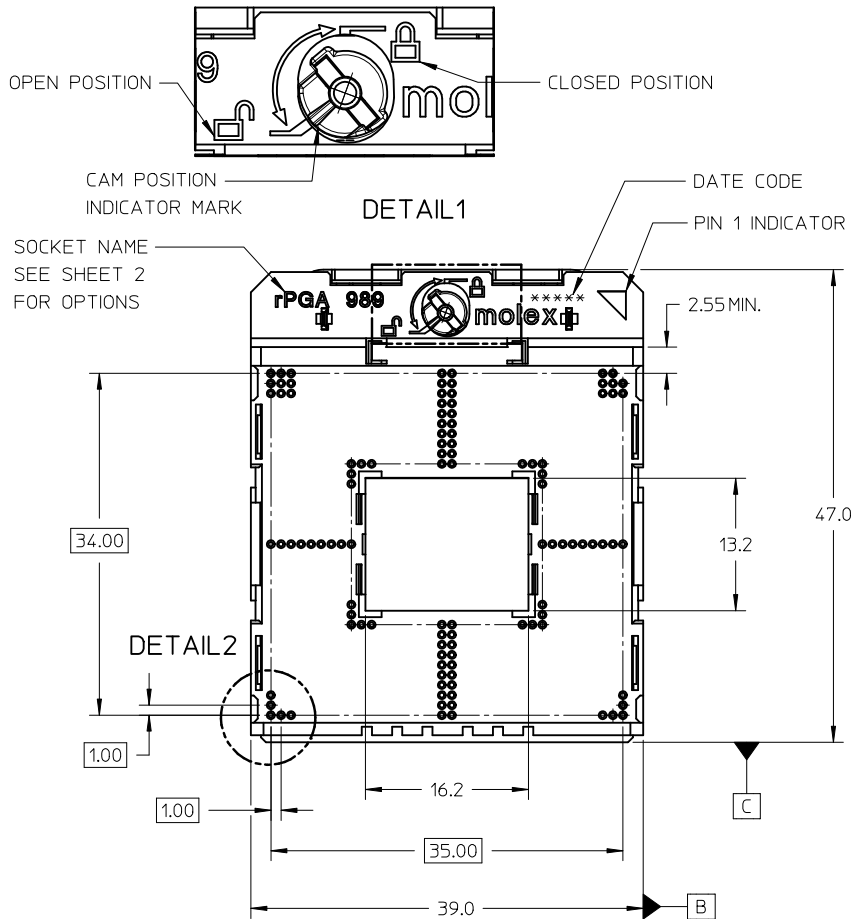

DETAIL 2

DETAIL 3

- NOTES:
- 1) THIS SOCKET COMPLIES WITH ALL SPECIFICATIONS AND PERFORMANCE REQUIREMENTS FOR INTEL rPGA98X SERIES CPU PROCESSORS.
 - 2) SOCKET SHOWN IN OPEN POSITION.
 - 3) SEE SHEET 2 FOR DETAILS PERTAINING TO KEYING, MATERIAL AND PACKAGING OPTIONS.
 - 4) THIS PRODUCT SERIES COMPLIANT TO RoHS DIRECTIVE 2002/95/EC AND ELV DIRECTIVE 2000/53/EC.

REVISED EC NO: SH2011-0076 DRWN:ZYAN CHKD: APPR:AYIN REV B	DESCRIPTION 2010/09/03 2010/09/06 2010/09/17	QUALITY SYMBOLS	GENERAL TOLERANCES (UNLESS SPECIFIED)		DIMENSION STYLE	SCALE	DESIGN UNITS	THIRD ANGLE PROJECTION
		$F_A=0$ $F_C=0$ $F_P=0$	mm	INCH	MM ONLY	2:1	METRIC	TITLE RPGA989 SOCKET ASSEMBLY
		4 PLACES ± --- ± --- 3 PLACES ± --- ± --- 2 PLACES ± 0.10 ± --- 1 PLACE ± 0.20 ± ---	DRAWN BY QWFANG CHECKED BY JKACHLIC APPROVED BY CL IANG		DATE	DATE	DATE	
		ANGULAR ± 2 ° DRAFT WHERE APPLICABLE MUST REMAIN WITHIN DIMENSIONS	SEE TABLE		DATE	DATE	DATE	MATERIAL NO. MOLEX INCORPORATED

REMOVEABLE PICK & PLACE CAP

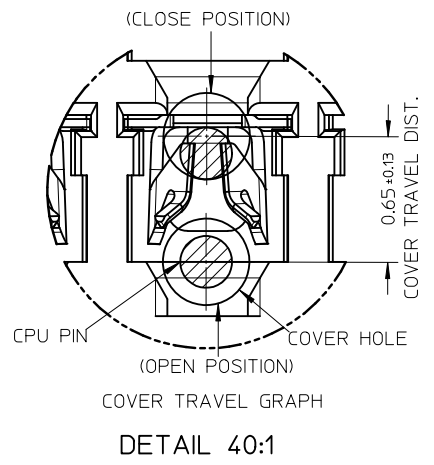
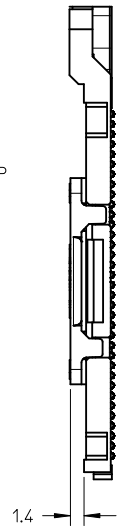
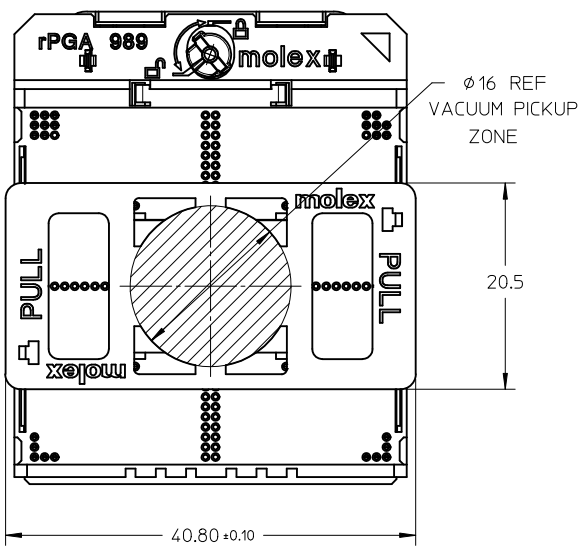

NOTES:

- 1) MATERIALS:
 MOLDED COMPONENTS: LIQUID CRYSTAL POLYMER (LCP) UL 94V-0
 BASE HOUSING COLOR: BLACK
 COVER COLOR: NATURAL
 MYLAR(POLYIMIDE, COLOR:ORANGE) OR PhP COVER(LCP, COLOR: BLACK)
 FOR PICK & PLACE.
 CONTACTS: HIGH STRENGTH COPPER ALLOY
 PLATING: GOLD THICKNESS AS FOLLOWING TABLE 1-3 IN CONTACT AREA,
 1.3um NICKEL OVERALL
 CAM COMPONENTS: STAINLESS STEEL
 SOLDER BALL: LEAD-FREE BALL SnAg3.0Cu0.5
- 2) DATE CODE *****
 MOLEX INTERNAL USE
 WORKING DAY
 MONTH
 YEAR
- 3) PRODUCT SPECIFICATION PS-47989-00* APPLIES
 4) PACKAGING SPECIFICATION: PK-47989-001 (TAPE & REEL)
 PK-47989-002 (HARD TRAY)

REVISED EC NO: SH2011-0076 DRWN:ZYUAN CHKD: APPR:AYIN	REV 2010/09/03 2010/09/06 2010/09/17	QUALITY SYMBOLS F=0 F=0 F=0	GENERAL TOLERANCES (UNLESS SPECIFIED)		DIMENSION STYLE MM ONLY	SCALE 2:1	DESIGN UNITS METRIC	THIRD ANGLE PROJECTION
				mm	INCH	DRAWN BY QWFANG	DATE 2008/04/25	TITLE RPGA989 SOCKET ASSEMBLY
			4 PLACES	± ---	± ---	CHECKED BY JKACHLIC	DATE 2008/05/29	
			3 PLACES	± ---	± ---	APPROVED BY CLIANG	DATE 2008/05/29	
			2 PLACES	± 0.10	± ---			
			1 PLACE	± 0.20	± ---			
			ANGULAR ± 2 °					
			DRAFT WHERE APPLICABLE MUST REMAIN WITHIN DIMENSIONS		SEE TABLE		MATERIAL NO.	DOCUMENT NO.
					SIZE A3	THIS DRAWING CONTAINS INFORMATION THAT IS PROPRIETARY TO MOLEX INCORPORATED AND SHOULD NOT BE USED WITHOUT WRITTEN PERMISSION		SHEET NO. 2 OF 6

PART NO. OF GF PLATING- TABLE 1

PART NUMBER	PICK UP TYPE		PACKAGE TYPE		PRODUCT SPEC.
	MYLAR	CAP	T&R	HARD TRAY	
47989-0110	◆			◆	PS-47989-002
47989-0120	◆		◆		
47989-0130		◆		◆	
47989-0140		◆	◆		
47989-0210	◆			◆	
47989-0220	◆		◆		
47989-0230		◆		◆	
47989-0240		◆	◆		

PART NO. OF 10u" MIN. GOLD PLATING- TABLE 2

PART NUMBER	PICK UP TYPE		PACKAGE TYPE		PRODUCT SPEC.
	MYLAR	CAP	T&R	HARD TRAY	
47989-0111	◆			◆	PS-47989-003
47989-0121	◆		◆		
47989-0131		◆		◆	
47989-0141		◆	◆		
47989-0211	◆			◆	
47989-0221	◆		◆		
47989-0231		◆		◆	
47989-0241		◆	◆		

PART NO. OF 15u" MIN. GOLD PLATING- TABLE 3

PART NUMBER	PICK UP TYPE		PACKAGE TYPE		PRODUCT SPEC.
	MYLAR	CAP	T&R	HARD TRAY	
47989-0112	◆			◆	PS-47989-001
47989-0122	◆		◆		
47989-0132		◆		◆	
47989-0142		◆	◆		
47989-0212	◆			◆	
47989-0222	◆		◆		
47989-0232		◆		◆	
47989-0242		◆	◆		

SOCKET KEYING OPTIONS

MYLAR PICK & PLACE OPTION

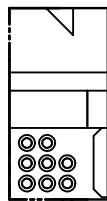
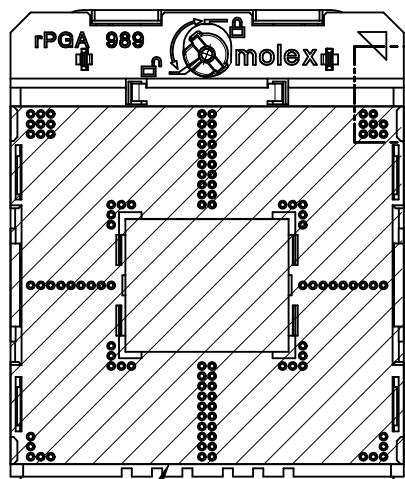

rPGA989
47989-01**

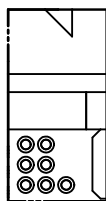

rPGA988A
47989-02**

MYLAR (NORMAL)

REVISED EC NO: SH2011-0076 DRWN:ZYAN CHKD: APPR:AYIN 2010/09/03 2010/09/06 2010/09/17	QUALITY SYMBOLS $F_A=0$ $F_C=0$ $F_P=0$	GENERAL TOLERANCES (UNLESS SPECIFIED)		DIMENSION STYLE MM ONLY		SCALE 2:1	DESIGN UNITS METRIC	THIRD ANGLE PROJECTION		
		4 PLACES ± --- ± ---	mm INCH	DRAWN BY QWFANG	DATE 2008/04/25	TITLE RPGA989 SOCKET ASSEMBLY				
		3 PLACES ± --- ± ---		CHECKED BY JKACHLIC	DATE 2008/05/29	MOLEX INCORPORATED				
		2 PLACES ± 0.10 ± --- 1 PLACE ± 0.20 ± ---		APPROVED BY CL IANG	DATE 2008/05/29	MATERIAL NO. SEE TABLE	DOCUMENT NO. SD-47989-001	SHEET NO. 3 OF 6		
DRAFT WHERE APPLICABLE MUST REMAIN WITHIN DIMENSIONS		THIS DRAWING CONTAINS INFORMATION THAT IS PROPRIETARY TO MOLEX INCORPORATED AND SHOULD NOT BE USED WITHOUT WRITTEN PERMISSION								

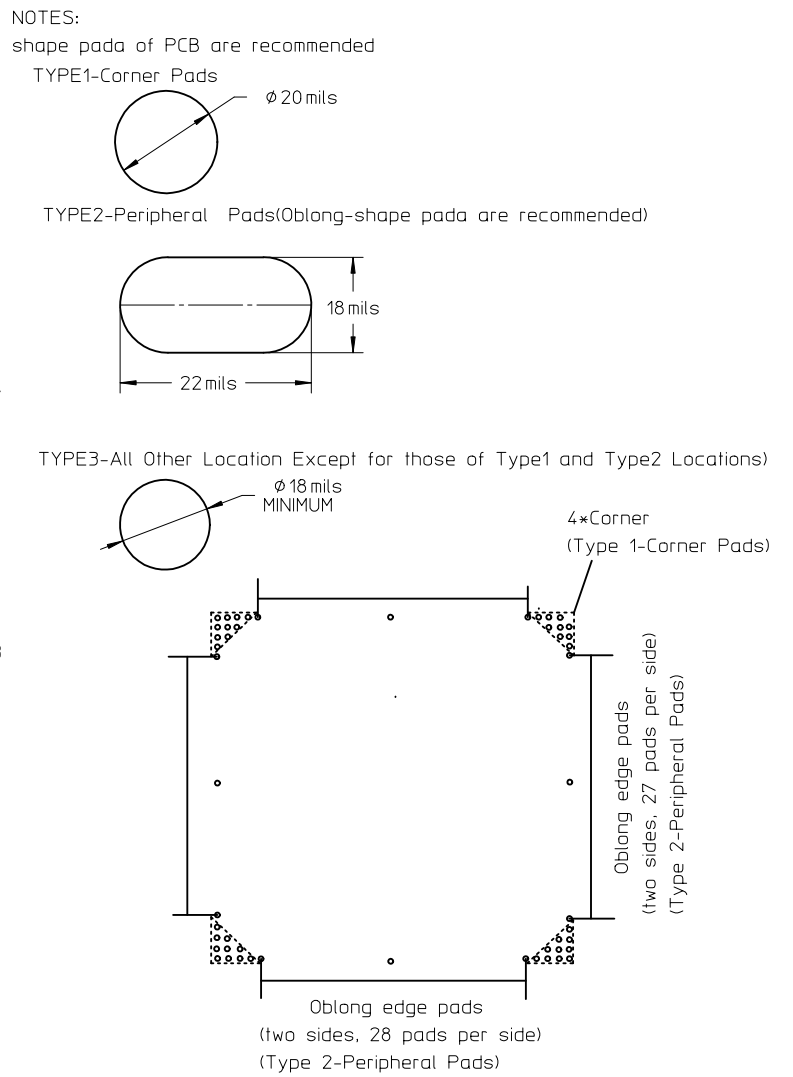
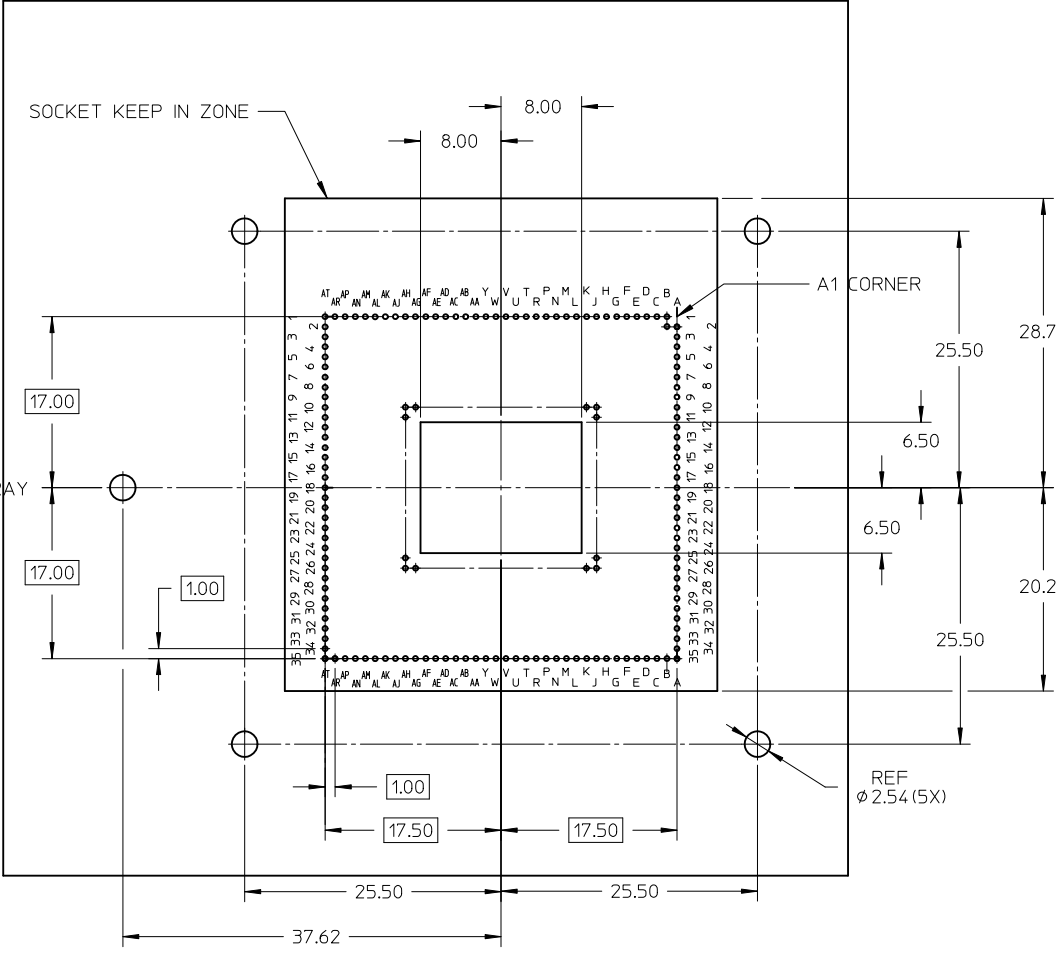

MOTHERBOARD KEEP IN ZONE (KIZ)
(FOR NORMAL)

REVISED EC NO: SH2011-0076 DRWN:ZYAN CHKD: APPR:AYIN	2010/09/03 2010/09/06 2010/09/17	DESCRIPTION REV	QUALITY SYMBOLS	GENERAL TOLERANCES (UNLESS SPECIFIED)		DIMENSION STYLE		SCALE	DESIGN UNITS	THIRD ANGLE PROJECTION
			$F_A = 0$ $F_C = 0$ $F_D = 0$	mm	INCH	MM ONLY		METRIC		
			4 PLACES ± --- ± --- 3 PLACES ± --- ± --- 2 PLACES ± 0.10 ± --- 1 PLACE ± 0.20 ± ---	DRAWN BY QWFANG DATE 2008/04/25		TITLE		RPGA989 SOCKET ASSEMBLY		
			ANGULAR ± 2 °	CHECKED BY JKACHLIC DATE 2008/05/29		APPROVED BY CL IANG DATE 2008/05/29		MOLEX INCORPORATED		
DRAFT WHERE APPLICABLE MUST REMAIN WITHIN DIMENSIONS			MATERIAL NO. SEE TABLE		DOCUMENT NO. SD-47989-001		SHEET NO. 4 OF 6			
			SIZE A3		THIS DRAWING CONTAINS INFORMATION THAT IS PROPRIETARY TO MOLEX INCORPORATED AND SHOULD NOT BE USED WITHOUT WRITTEN PERMISSION					

PART NO. OF GF PLATING- TABLE 1

PART NUMBER	PICK UP TYPE		PACKAGE TYPE		PRODUCT SPEC.
	MYLAR	CAP	T&R	HARD TRAY	
47989-9110	◆			◆	PS-47989-002
47989-9120	◆		◆	◆	
47989-9130		◆		◆	
47989-9140		◆	◆	◆	
47989-9210	◆			◆	
47989-9220	◆		◆	◆	
47989-9230		◆		◆	
47989-9240		◆	◆	◆	

PART NO. OF 10u" MIN. GOLD PLATING- TABLE 2

PART NUMBER	PICK UP TYPE		PACKAGE TYPE		PRODUCT SPEC.
	MYLAR	CAP	T&R	HARD TRAY	
47989-9111	◆			◆	PS-47989-003
47989-9121	◆		◆	◆	
47989-9131		◆		◆	
47989-9141		◆	◆	◆	
47989-9211	◆			◆	
47989-9221	◆		◆	◆	
47989-9231		◆		◆	
47989-9241		◆	◆	◆	

PART NO. OF 15u" MIN. GOLD PLATING- TABLE 3

PART NUMBER	PICK UP TYPE		PACKAGE TYPE		PRODUCT SPEC.
	MYLAR	CAP	T&R	HARD TRAY	
47989-9112	◆			◆	PS-47989-001
47989-9122	◆		◆	◆	
47989-9132		◆		◆	
47989-9142		◆	◆	◆	
47989-9212	◆			◆	
47989-9222	◆		◆	◆	
47989-9232		◆		◆	
47989-9242		◆	◆	◆	

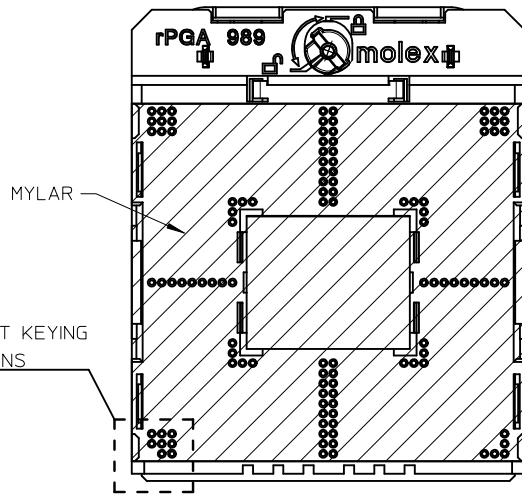
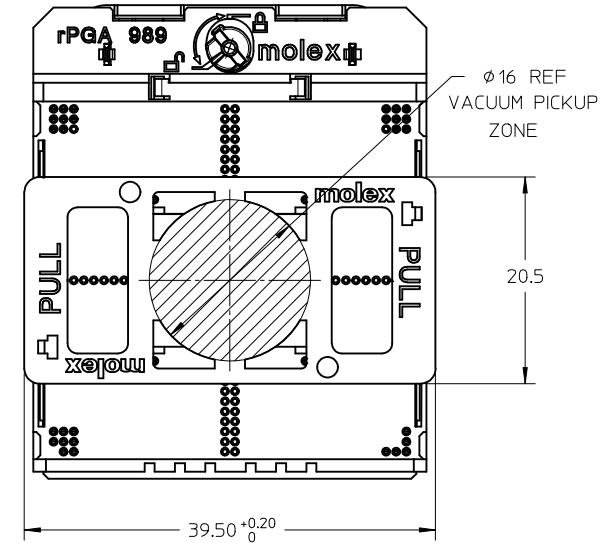

(180° ROTATION)

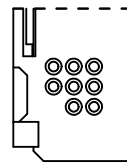

rPGA989
47989-91**

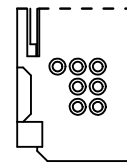

rPGA988A
47989-92**

REVISED EC NO: SH2011-0076 DRWN:ZYAN CHKD: APPR:AYIN	2010/09/03	2010/09/06	2010/09/17	QUALITY SYMBOLS $F_A=0$ $F_C=0$ $F_P=0$	GENERAL TOLERANCES (UNLESS SPECIFIED) mm INCH 4 PLACES ± --- ± --- 3 PLACES ± --- ± --- 2 PLACES ± 0.10 ± --- 1 PLACE ± 0.20 ± --- ANGULAR ± 2 °	DIMENSION STYLE MM ONLY DRAWN BY: QWFANG DATE: 2008/04/25 CHECKED BY: JKACHLIC DATE: 2008/05/29 APPROVED BY: CL IANG DATE: 2008/05/29	SCALE 2:1 DESIGN UNITS METRIC THIRD ANGLE PROJECTION	TITLE RPGA989 SOCKET ASSEMBLY			
	REV B	REV	MATERIAL NO. SEE TABLE						DOCUMENT NO. SD-47989-001	SHEET NO. 5 OF 6	
	DRAFT WHERE APPLICABLE MUST REMAIN WITHIN DIMENSIONS								MOLEX INCORPORATED THIS DRAWING CONTAINS INFORMATION THAT IS PROPRIETARY TO MOLEX INCORPORATED AND SHOULD NOT BE USED WITHOUT WRITTEN PERMISSION		

NOTES:
shape pada of PCB are recommended

TYPE1-Corner Pads

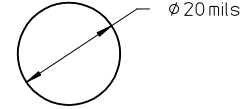

TYPE2-Peripheral Pads(Oblong-shape pada are recommended)

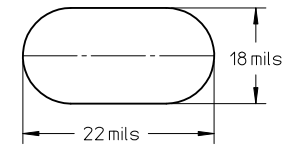

TYPE3-All Other Location Except for those of Type1 and Type2 Locations)

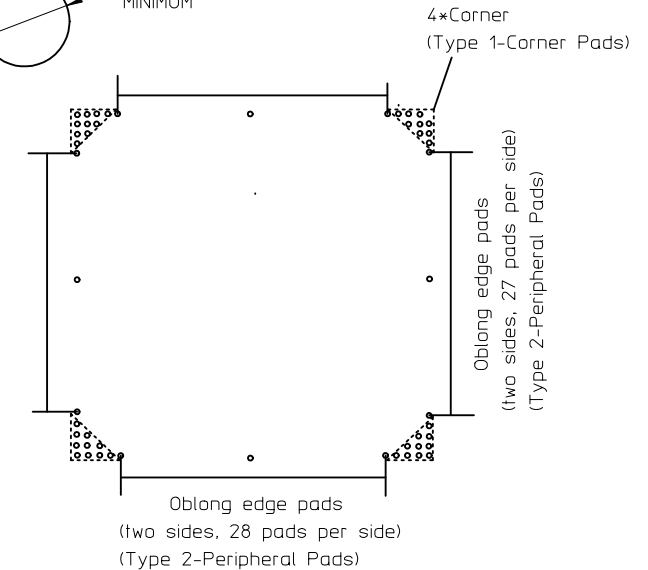
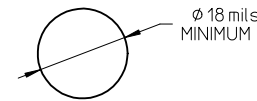

SOCKET KEEP IN ZONE

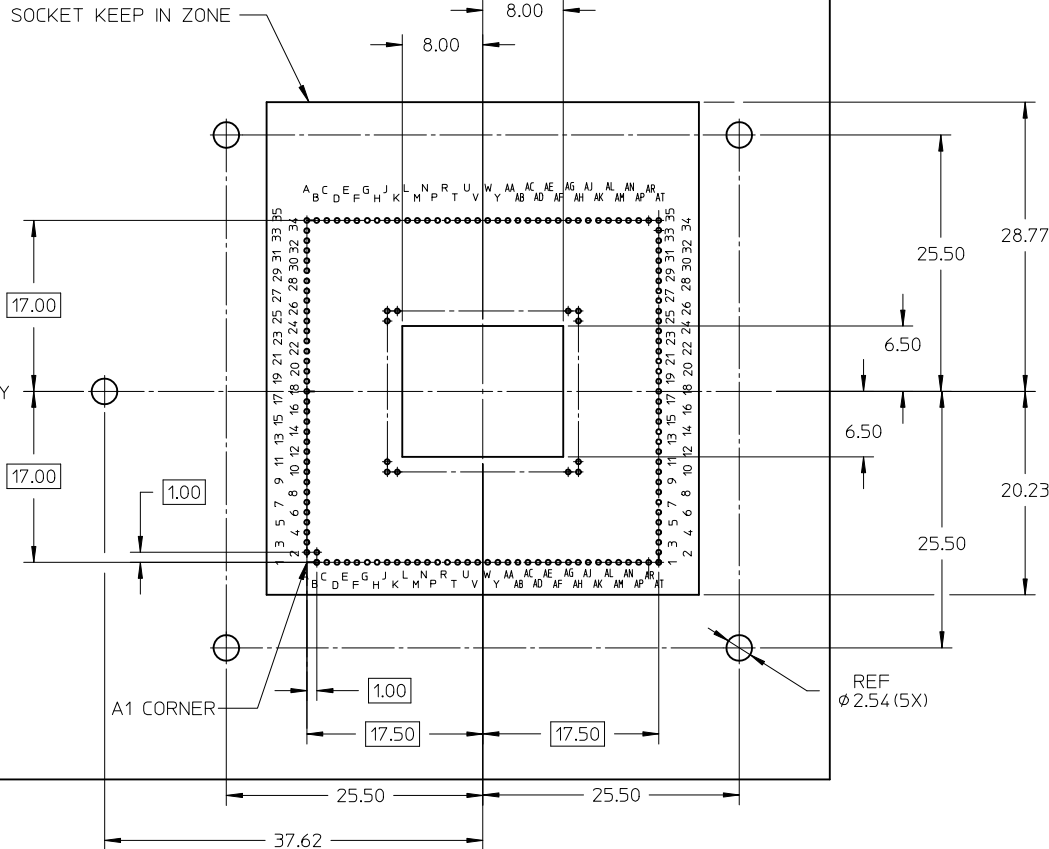

MOTHERBOARD KEEP IN ZONE (KIZ)
(FOR 180° ROTATION)

REVISED EC NO: SH2011-0076 DRWN:ZYAN CHKD: APPR:AYIN	2010/09/03 2010/09/06 2010/09/17	QUALITY SYMBOLS F=0 F=0 F=0	GENERAL TOLERANCES (UNLESS SPECIFIED)		DIMENSION STYLE MM ONLY		SCALE 2:1	DESIGN UNITS METRIC	THIRD ANGLE PROJECTION			
				mm	INCH	DRAWN BY QWFANG	DATE 2008/04/25	TITLE RPGA989 SOCKET ASSEMBLY				
			4 PLACES	± ---	± ---	CHECKED BY JKACHLIC	DATE 2008/05/29	MOLEX INCORPORATED DOCUMENT NO. SD-47989-001 SHEET NO. 6 OF 6				
			3 PLACES	± ---	± ---	APPROVED BY CL IANG	DATE 2008/05/29					
2 PLACES		± 0.10	± ---	MATERIAL NO.		SEE TABLE						
1 PLACE		± 0.20	± ---	ANGULAR ± 2 °		THIS DRAWING CONTAINS INFORMATION THAT IS PROPRIETARY TO MOLEX INCORPORATED AND SHOULD NOT BE USED WITHOUT WRITTEN PERMISSION						
DRAFT WHERE APPLICABLE MUST REMAIN WITHIN DIMENSIONS												