

NOTES:

1. METALSHELLS: COPPER ALLOY; min. 315µin TIN over 40-80µin NICKEL
2. INSULATORS: PBT GF UL 94 V-0, BLACK
3. CONTACTS: COPPER ALLOY
PLATING: 30µin HARD GOLD over min. 50µin NICKEL
SOLDER CUP ACCEPTS CABLE AWG 20
4. RUBBER-GASKET: TPE
5. CONNECTOR IS PART MARKED: PART NO CONEC ABC

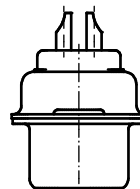
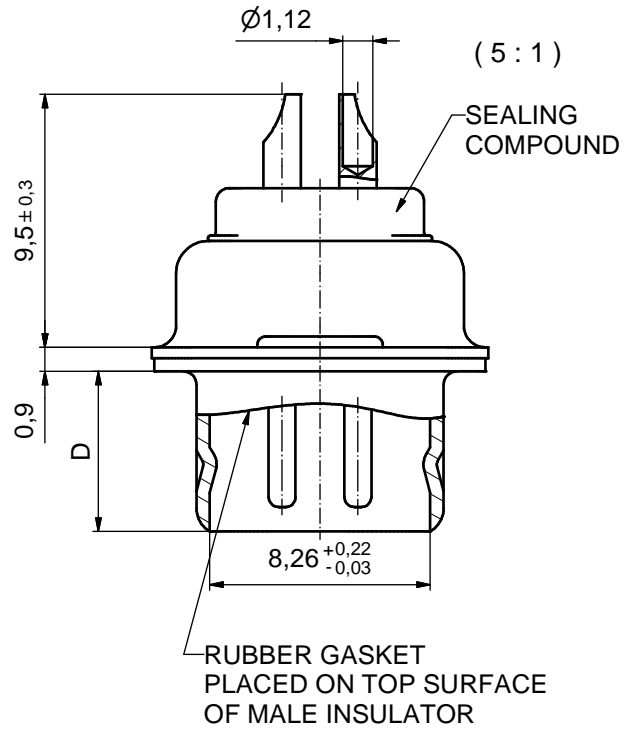
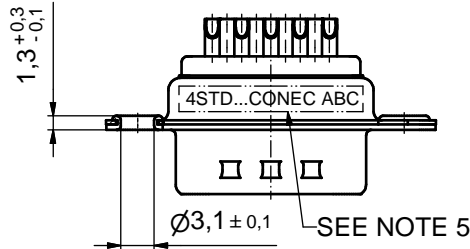
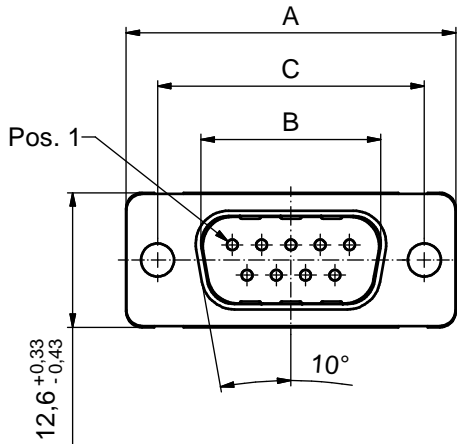

(b)

No. of pos.	A	B	C	D	Part-No.
9	30,88 +0,31 -0,45	16,84 +0,2 -0,05	24,99 +0,13 -0,12	6,00 +0,12 -0,18	4STD09PCM99A10X
15	39,22 +0,3 -0,46	25,17 +0,2 -0,05	33,32 +0,13 -0,12	6,00 +0,12 -0,18	4STD15PCM99A10X
25	53,09 +0,33 -0,43	38,86 +0,23 -0,02	47,04 ± 0,13	6,00 -0,3	4STD25PCM99A10X
37	69,39 +0,31 -0,45	55,30 +0,25	63,50 ± 0,13	6,00 -0,3	4STD37PCM99A10X

Directive 2002/95/EC
"RoHS"
Compliant

APPROVAL # FREIGABE # DEBLOCAGE # AUTORIZACION # APPROVAL

CUSTOMER APPROVAL DATE:

NAME: _____ TITLE: _____

COMPANY NAME: _____

APPROVAL # FREIGABE # DEBLOCAGE # AUTORIZACION # APPROVAL

THIS DRAWING MAY NOT BE COPIED OR REPRODUCED IN ANY WAY AND MAY NOT BE PASSED ON TO A THIRD PARTY WITHOUT WRITTEN PERMISSION. OWNERSHIP AND COPYRIGHT OF CONEC GmbH

DO NOT ALTER CAD DRAWING BY HAND

rev.	description	date	name	tolerance
1 x c	Ä 3495	10.11.09	Petker	
1 x b	Ä 2179	07.03.05	Lehm.	
a	Origin			

dim. in mm

scale:	2:1 (5:1)
material:	SEE NOTES
title:	D-SUB MALE SOLDER CUP 9-37pos. for installation into water resistant hood
dwg no:	Inventor 10 (C) DIN-A3 sh: 1
part no:	18K11B3A
part no:	SEE TABLE

