

Boardlocks not shown in this view

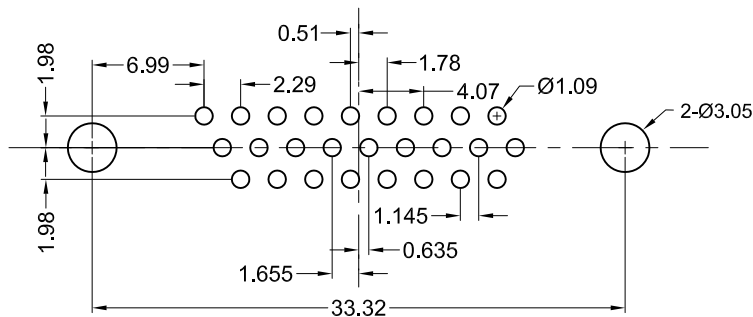

Recommended PCB Layout  
(Top View)

### Material and Finish

Shell: Steel, Nickel Plated

Insulator: PBT thermoplastic  
with glass-fiber reinforcement,  
UL94V-0 rated  
Color: Black

Contact Material:  
Socket - Brass

Contact Plating Options:

Standard: gold flash on  
mating end, tin on  
termination end, nickel  
underplate on entire contact

15 Option: 15u" gold on  
mating end, tin on  
termination end, nickel  
underplate on entire contact

30 Option: 30u" gold on  
mating end, tin on  
termination end, nickel  
underplate on entire contact

### Electrical Specifications

Rated Current: 1.5A

Rated Voltage: 30Vac

Insulation Resistance:  
more than 1000 megohms at  
500V DC

Contact Resistance:  
13 milliohms max.

Dielectric Withstanding Voltage:  
1000V for 1 minute

Operating Temperature:  
-55°C to +75°C

Part Number	Gold Option
K86X-AD-26S-BR	Gold Flash (standard)
K86X-AD-26S-BR15	15u" Gold (15 option)
K86X-AD-26S-BR30	30u" Gold (30 option)



Tolerances
X.X ± 0.25
X.XX ± 0.15
Unless Stated Otherwise

REV.	DATE	DESCRIPTION	REV. BY	CHK. BY	DRAWN BY	DATE
A1	12/29/05	New Drawing	R. Aguirre	H. MA	R. Aguirre	12/29/05
A2	1/16/08	ECO# 07-052	WILL H.	H. MA		
A3	8/29/14	ECO# 14-028	H. MA	P. DalCanto		
A4	12/31/17	ECO# 17-033	G. Serrato	C. Furumasu		

**K86X-AD-26S-BR**

High Density, D-Sub, Vertical Mount,

26 pin socket, RoHS Compliant

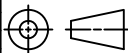

UNITS  
mm