

LOOSE PIECE		SPECIFICATIONS				
MATERIAL NUMBER	ENGINEERING NUMBER	STUD SIZE	"S" ±.005 [0.13]	"W" ±.010 [0.25]	"C" MIN.	"L" MAX.
191960005	A-535-06	6	.146 [3.71]	.316 [8.02]	.303 [7.70]	1.070 [27.18]
191960007	A-535-08	8	.173 [4.39]			
191960009	A-535-10	10	.198 [5.03]			

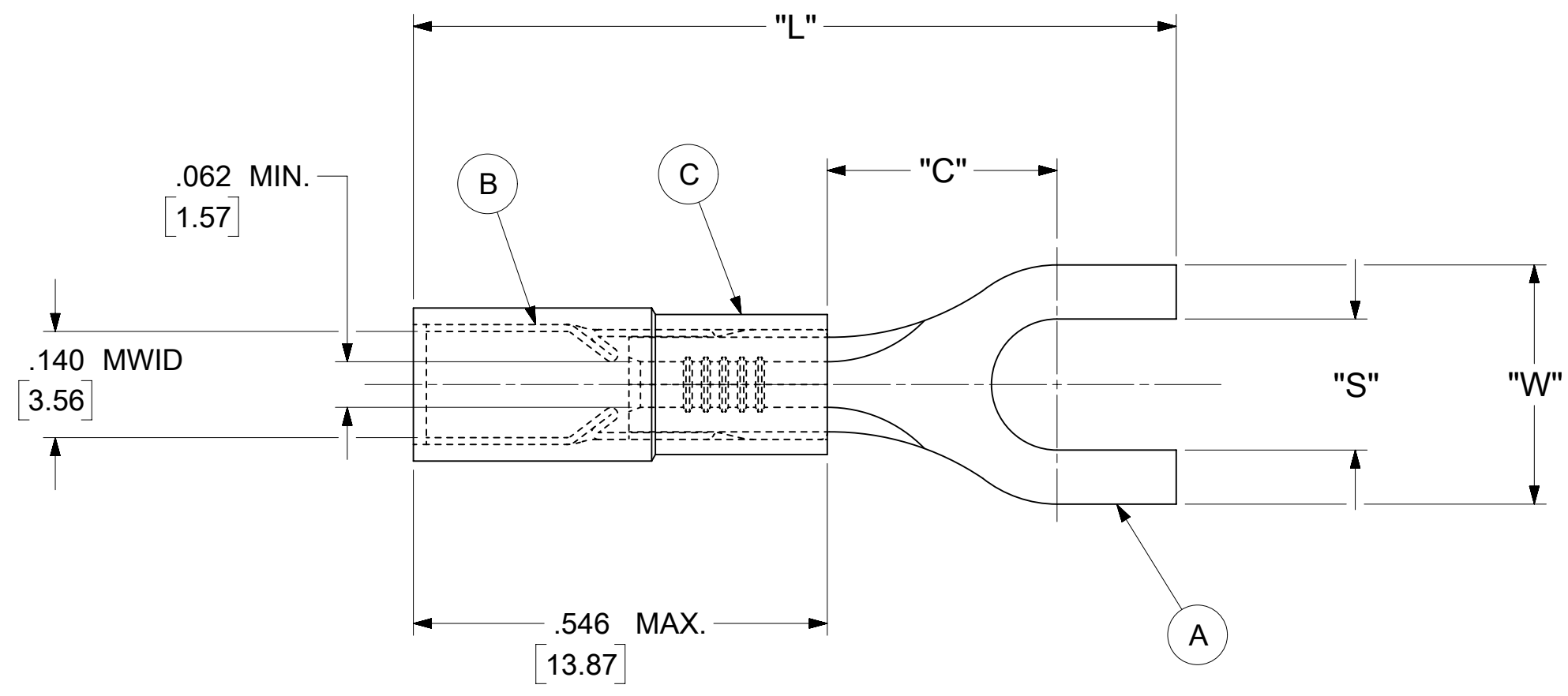

- NOTES:
- MATERIAL:
    - (A). TERMINAL: COPPER ( STOCK THICKNESS  $.028 \begin{smallmatrix} +.001 \\ -.000 \end{smallmatrix}$  [0.71] )
    - PLATING: ELECTRO-TIN (.0003 MIN.)
    - (B). TIN-PLATED BRASS FUNNEL FERRULE
    - (C). INSULATION: NYLON (COLOR CODED RED)
  - MWID: MAXIMUM WIRE INSULATION DIAMETER
  - WIRE SIZE: 22 - 18 AWG  
.25 - 1.5 MM<sup>2</sup>
  - "UL" LISTING #E32244  
"CSA" LISTING #18689
  - ALL DIMENSIONS IN INCHES/[MM].
  - PARTS ARE ROHS COMPLIANT.
  - DIMS. SHOWN ARE FOR REFERENCE ONLY.

<b>SYMBOLS</b> $\nabla = 0$ $\nabla = 0$ $\nabla = 0$ $\nabla = 0$ $\nabla = 0$ $\nabla = 0$ $\nabla = 0$ $\nabla = 0$ $\nabla = 0$ $\nabla = 0$ $\nabla = 0$	THIS DRAWING CONTAINS INFORMATION THAT IS PROPRIETARY TO MOLEX ELECTRONIC TECHNOLOGIES, LLC AND SHOULD NOT BE USED WITHOUT WRITTEN PERMISSION			
	DIMENSION UNITS		SCALE	
	INCH/MM		NTS	
	CURRENT REV DESC: MIGRATION TO ECTR/NX			
GENERAL TOLERANCES (UNLESS SPECIFIED)				
		MM	INCH	EC NO: 626470
4 PLACES ± --- ± ---				DRWN: ABENJAMINLW 2019/09/20
3 PLACES ± --- ± 0.005				CHK'D: GROJAS01 2019/10/29
2 PLACES ± 0.13 ± 0.01				APPR: JMACNEIL 2019/11/04
1 PLACE ± 0.26 ± ---				INITIAL REVISION:
0 PLACES ± --- ± ---				DRWN: JJ 1984/11/14
ANGULAR TOL ± 0.5°				APPR:
DRAFT WHERE APPLICABLE MUST REMAIN WITHIN DIMENSIONS		THIRD ANGLE PROJECTION	DRAWING	SERIES
			C-SIZE	19196
DOCUMENT STATUS		P1	RELEASE DATE	2019/11/04 15:52:23
12		11	10	9

<b>molex</b>			
SPADE TONGUE TERMINAL AVIKRIMP 500-SERIES			
PRODUCT CUSTOMER DRAWING			
DOCUMENT NUMBER	DOC TYPE	DOC PART	REVISION
ACD50302	PSD	001	A
MATERIAL NUMBER	CUSTOMER	SHEET NUMBER	
SEE TABLE	GENERAL MARKET	1 OF 1	