



PART NO.

10116040-001LF

NOTES:

- MATERIAL:
HOUSING: HIGH PERFORMANCE RESIN, GLASS FILLED, UL94 V-0, COLOR: NATURAL.
TERMINAL: TI-CU ALLOY.
CAP: STAINLESS SLEEL.
HOLDDOWN: STAINLESS SLEEL.
- FINISH:
TERMINAL:
CONTACT AREA: GOLD PLATED 30u" MIN.
ALL AREA: GOLD PLATED 1u" MIN.
UNDER NICKEL PLATED 50u" MIN.
HOLDDOWN:
ALL AREA: GOLD PLATED 1u" MIN.
UNDER NICKEL PLATED 50u" MIN.
- NORMAL FORCE: 1.25N Min. FOR 1.6mm COMPRESSION.
- THE PRODUCT SPEC. PLS. REFER TO GS-12-674.
- THE PACKING SPEC. PLS. REFER TO GS-14-1545.
- THE SUFFIX "LF" MEANS FOR LEAD FREE PROCESS.

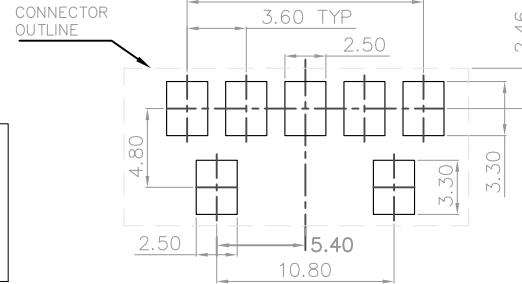
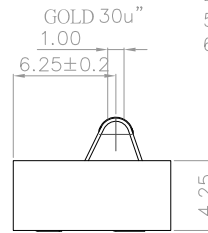
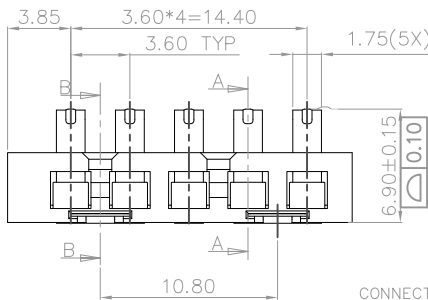
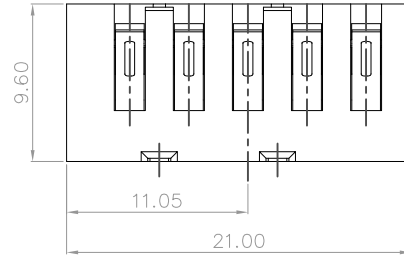
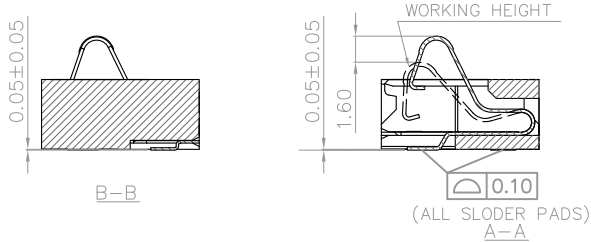

RECOMMENDED P.C.B.LAYOUT
TOLERANCE: +/-0.05

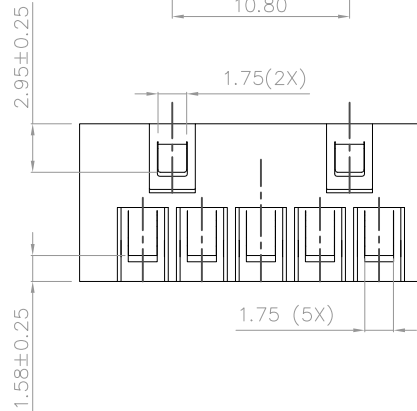
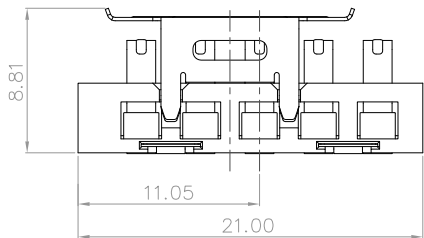
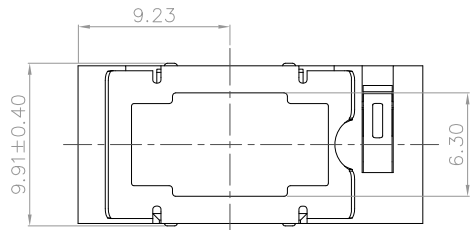
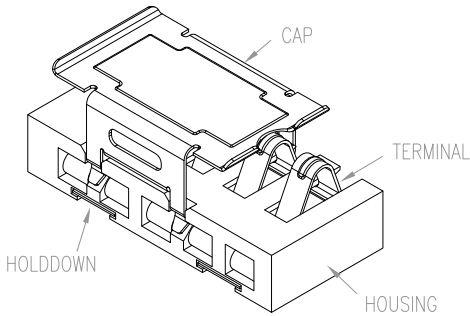
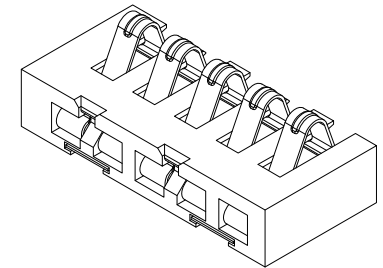

mat'l. code		surface ASME Y14.5		tolerance ASME Y14.5		projection		product family BATTERY		
ltr ecn no dr date		tolerances unless otherwise specified		angles		MM		title		
A	T10-0130	LS	01-19-11	line	.X±0.25	FCI		5 PINS 3.60mm PITCH BATTERY CONNECTOR		
				line	.XX±0.15			dwg no		sheet 1 of 1
				line	.XXX±0.10			10116040		A4
sheet index		revision sheet		dr LEIF SHEN 01-19-11		scale		type		
		1		enr LEIF SHEN 01-19-11				CUSTOMER Drawing		
				chr GARY HSIEH 01-19-11						
				appd JOSEPH HSIA 01-19-11						