

吸着エリア/VACUUM AREA

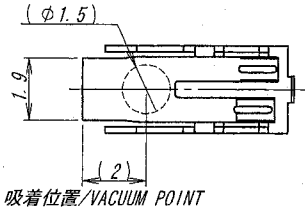

吸着位置/VACUUM POINT

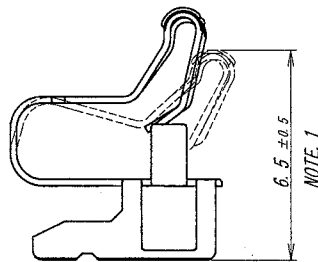
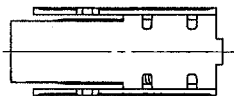
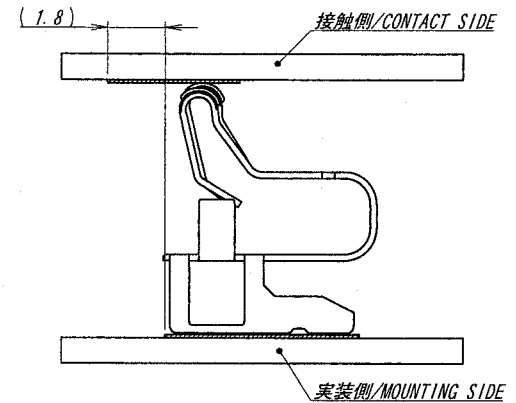
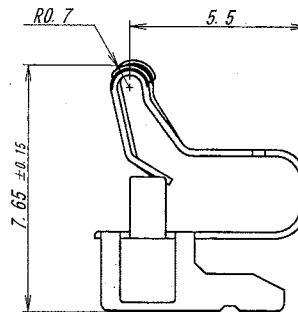
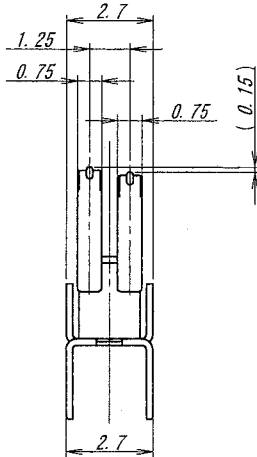
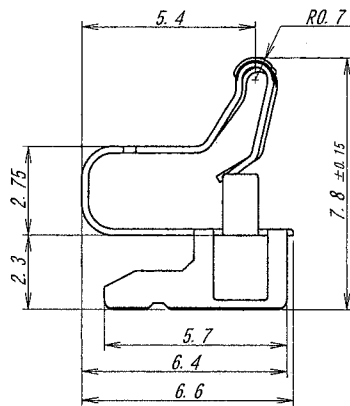

NOTE

1. 使用圧縮範囲: $6.5 \pm 0.5\text{mm}$
COMPRESSION RANGE: $6.5 \pm 0.5\text{mm}$ CONTACT HEIGHT
2. 接触力: $1.25 \pm 0.3\text{N}$ (接点高さ: 6.5mm 時)
CONTACT FORCE: $1.25 \pm 0.3\text{N}$ (CONTACT HEIGHT: 6.5mm HEIGHT)
3. 本製品は、錫系のめっきを施しておりますので、ウイスキーが発生する可能性がございます。その為、ウイスキー発生に対する保証は困難であり、御社にて御判断の上御使用をお願いします。
THIS PRODUCT UTILIZES LEAD-FREE TIN PLATING. ANY PRODUCT WITH LEAD-FREE TIN PLATING IS SUSCEPTIBLE TO TIN WHISKER. IRISO PROVIDES NO ASSURANCES AGAINST THE GROWTH OF TIN WHISKER EVEN UNDER NORMAL OPERATING CONDITIONS. CUSTOMERS ASSUME ALL RESPONSIBILITY FOR ANY PRODUCT FAILURES DUE SOLELY TO THE GROWTH OF TIN WHISKERS.

実装側/MOUNTING SIDE

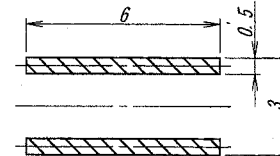

推奨基板/RECOMMEND PCB
一般公差/GENERAL TOLERANCE: $\pm 0.05\text{mm}$

接触側/CONTACT SIDE

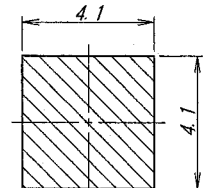

推奨基板/RECOMMEND PCB
一般公差/GENERAL TOLERANCE: $\pm 0.05\text{mm}$

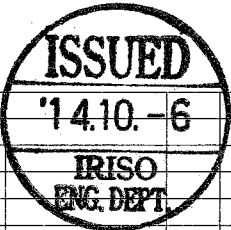

△				MATERIAL 材質	GENERAL TOLERANCES 一般公差	SCALE 尺度	UNIT 單位	TITLE 名称
△				C5210R ($t=0.20 \pm 0.01$)	DIM 寸法 ± 0.2	DR '14-10-01 M. Tajima	MM	16105シリーズ コンタクト SERIES 16105 CONTACT
△				FINISH 仕上げ	ANGLE 角度 \pm	CHK '14 M. Tajima	DSK '12-07-12 J. Oguro	EDP No
△				後めっき/AFTER PLATE ニッケル下地めっき/OVER Ni PLATE: $1.5 \sim 3.5\mu\text{m}$ 半光沢銅めっき/TIN MATT PLATE: $3 \sim 6\mu\text{m}$	3RD. ANG. PROJ. 三角法	APP '14 M. Yoshida		PARTS No 部番
△	42424	NOTE REV	M.T	14.7				IPS-16105T-01B-TM1
△	42653	REVISED	J.O	7.7				DWG No 図番
△	ECN No	REVISION RECORD	DR	CHK	DATE 年月日			110-116105-002
								REV. 2