

REVISIONS

| P | LTR | DESCRIPTION | DATE | DWN | APVD |
|---|-----|---------------------------|-----------|-----|------|
| | C1 | REVISED PER ECN-21-123302 | 25OCT2021 | RZ | WK |

NOTES

- 1 SINGLE PACK IN ACCORDANCE WITH AMP SPEC 107-3275
- 2 100 TRAY PACK IN ACCORDANCE WITH AMP SPEC 107-3275
- 3 Ni PLATING
- 4 TIN PLATING
- 5. FOR TECHNICAL DATA REFER TO YOUR LOCAL TE CONNECTIVITY SALES OFFICE
- 6. ALL DIMENSIONS ARE NOMINAL FOR REFERENCE ONLY UNLESS OTHERWISE STATED

| | | E | D | C | B | A | | | |
|------------|------------------------|-----------------|-----------------|-----------------|-----------------|-----------------|---|--|------------------------|
| | 9-1478243-0 | 8.30 | 9.30 | 8.30 | 7.00 | 5.70 | CT125 | | 5-1814826-7 |
| OBSOLETE | 9-1478243-0 | 8.30 | 9.30 | 8.30 | 7.00 | 5.70 | CT125 | | 5-1814826-6 |
| | 9-1478242-0 | 6.50 | 7.50 | 6.70 | 5.60 | 4.60 | CT100 | | 5-1814826-5 |
| | 9-1478242-0 | 6.50 | 7.50 | 6.70 | 5.60 | 4.60 | CT100 | | 5-1814826-4 |
| OBSOLETE | 9-1478243-0 | 8.60 | 9.60 | 8.70 | 6.80 | 4.85 | RG6/U | | 5-1814826-3 |
| | 9-1478243-0 | 8.60 | 9.60 | 8.70 | 6.80 | 4.85 | RG6/U | | 5-1814826-2 |
| OBSOLETE | 9-1478242-0 | 6.50 | 7.50 | 6.80 | 4.90 | 3.90 | RG59B/U, 62A/U, 140/U, 210/U, URM90, Belden 9291, 9291, KX6A, KX25, KX52, KX53 | | 5-1814826-1 |
| | 9-1478242-0 | 6.50 | 7.50 | 6.60 | 4.90 | 3.90 | RG59B/U, 62A/U, 140/U, 210/U, URM90, Belden 9291, 9291, KX6A, KX25, KX52, KX53 | | 5-1814826-0 |
| | DIE SET | | | | | | CABLE GROUPS | | PART NO. |
| DIMENSIONS | | | | | | | | | |

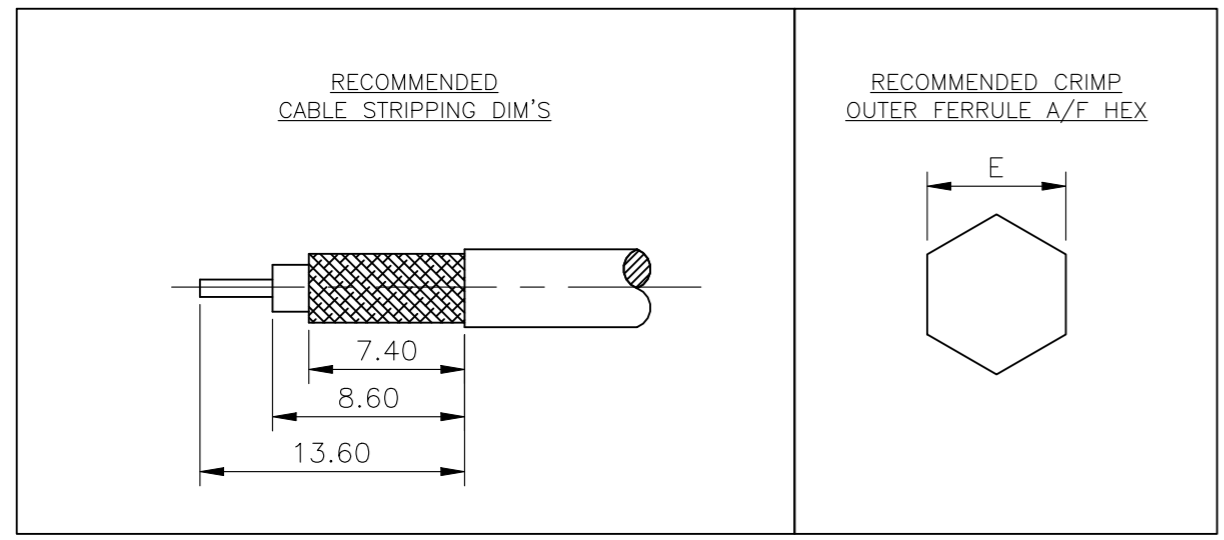
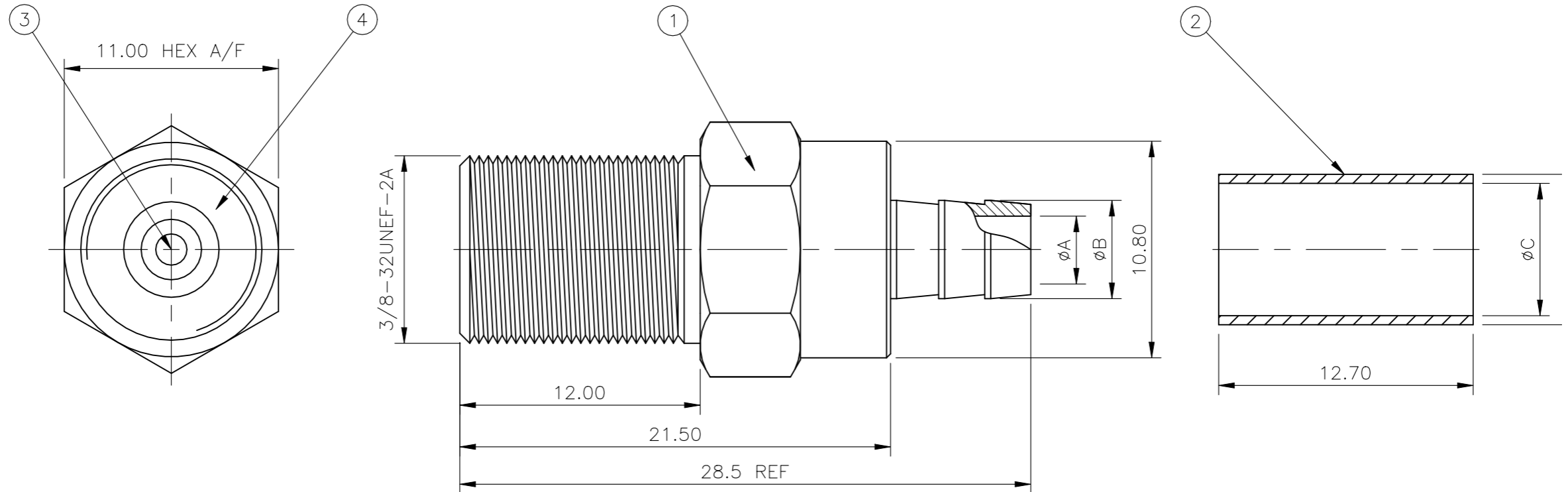

| | OBSOLETE | OBSOLETE | OBSOLETE | | | | | | | | |
|-------------------|----------|----------|----------|----|----|----|----|---|---------------|-------------|------|
| 1 | 1 | 1 | 1 | 1 | 1 | 1 | 1 | 1 | POLYPROPYLENE | INSULATOR | 4 |
| 1 | 1 | 1 | 1 | 1 | 1 | 1 | 1 | 1 | BRASS | CONTACT | 3 |
| 1 | 1 | 1 | 1 | 1 | 1 | 1 | 1 | 1 | ZINC ALLOY | FERRULE | 2 |
| 1 | 1 | 1 | 1 | 1 | 1 | 1 | 1 | 1 | BRASS | BODY | 1 |
| 5 | 75 | 65 | 55 | 45 | 35 | 25 | 15 | 0 | MATERIAL | DESCRIPTION | ITEM |
| QUANTITY PER ASSY | | | | | | | | | | | |
| PARTS LIST | | | | | | | | | | | |

THIS DRAWING IS A CONTROLLED DOCUMENT.

DIMENSIONS: mm

TOLERANCES UNLESS OTHERWISE SPECIFIED:

| | |
|--------|-------|
| 0 PLC | ± - |
| 1 PLC | ± - |
| 2 PLC | ± 0.3 |
| 3 PLC | ± - |
| 4 PLC | ± - |
| ANGLES | ± - |
| FINISH | - |

MATERIAL: SEE TABLE

DWN ANSON MA 14FEB09

CHK RITA ZUO 14FEB09

APVD BOB ZHAO 14FEB09

PRODUCT SPEC 108-112000

APPLICATION SPEC

STE TE Connectivity

F TYPE BLK JK R/M

SIZE CAGE CODE DRAWING NO RESTRICTED TO

WEIGHT 0.000000 A3 00779 C-1814826

CUSTOMER DRAWING SCALE NTS SHEET 1 OF 1 REV C1