

STANDARD EXECUTIONS

Plain or threaded blind hole.

- **PLM:** polished steel.
- **PLM-SST:** AISI 303 stainless steel, sandblasted matte finish.



**Conversion Table**  
1 mm = 0.039 inch

D	
mm	inch
16	0.63
20	0.79
25	0.98
32	1.26
40	1.57
50	1.97

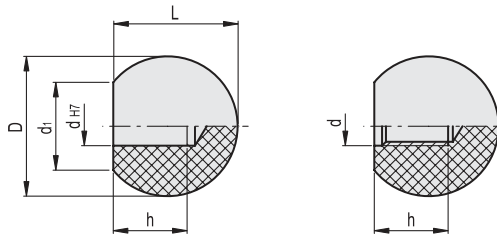

PLM		METRIC						
Code	Description	D	L	d	dH7	d1	h	△
504011	PLM.16-6	16	15	-	6	8	9	14
504012	PLM.16-M4	16	15	M4	-	8	7	15
504021	PLM.20-8	20	18	-	8	12	11	25
504022	PLM.20-M5	20	18	M5	-	12	9	26
504031	PLM.25-10	25	22.5	-	10	15	14	50
504032	PLM.25-M6	25	22.5	M6	-	15	11	59
504041	PLM.32-12	32	29	-	12	18	17	106
504042	PLM.32-M8	32	29	M8	-	18	14.5	116
504051	PLM.40-16	40	37	-	16	22	22	206
504052	PLM.40-M10	40	37	M10	-	22	18	235
504061	PLM.50-20	50	46	-	20	27	28	384
504062	PLM.50-M12	50	46	M12	-	27	21	475

PLM-SST		INOX STAINLESS STEEL METRIC						
Code	Description	D	L	d	dH7	d1	h	△
504111	PLM.16-SST-6	16	15	-	6	8	9	15
504112	PLM.16-SST-M4	16	15	M4	-	8	7	16
504121	PLM.20-SST-8	20	18	-	8	12	11	20
504122	PLM.20-SST-M5	20	18	M5	-	12	9	26
504131	PLM.25-SST-10	25	22.5	-	10	15	14	25
504132	PLM.25-SST-M6	25	22.5	M6	-	15	11	59
504141	PLM.32-SST-12	32	29	-	12	18	17	50
504142	PLM.32-SST-M8	32	29	M8	-	18	14.5	125
504151	PLM.40-SST-16	40	37	-	16	22	22	175
504152	PLM.40-SST-M10	40	37	M10	-	22	18	260
504161	PLM.50-SST-20	50	46	-	20	27	28	384

Fixed & Revolving handles