

NOTES:

1. REFER TO THE BOM FOR MATERIAL INFORMATION;
2. THE EXTERNAL ADHESIVE (P/N:2178530018) MOLEX IS NOT PASTED ON THE PRODUCT, AND THE CUSTOMER CHOOSES TO PASTE IT ON THE A/B FACE OF THE PRODUCT.
3. ANTENNA B FACES THE SKY, PLEASE REFER TO THE DIRECTION OF THE ARROW ON THE SIDE OF THE PRODUCT.

REV	DATE	DESCRIPTION
A1	2022/10/28	FIRST RELEASE

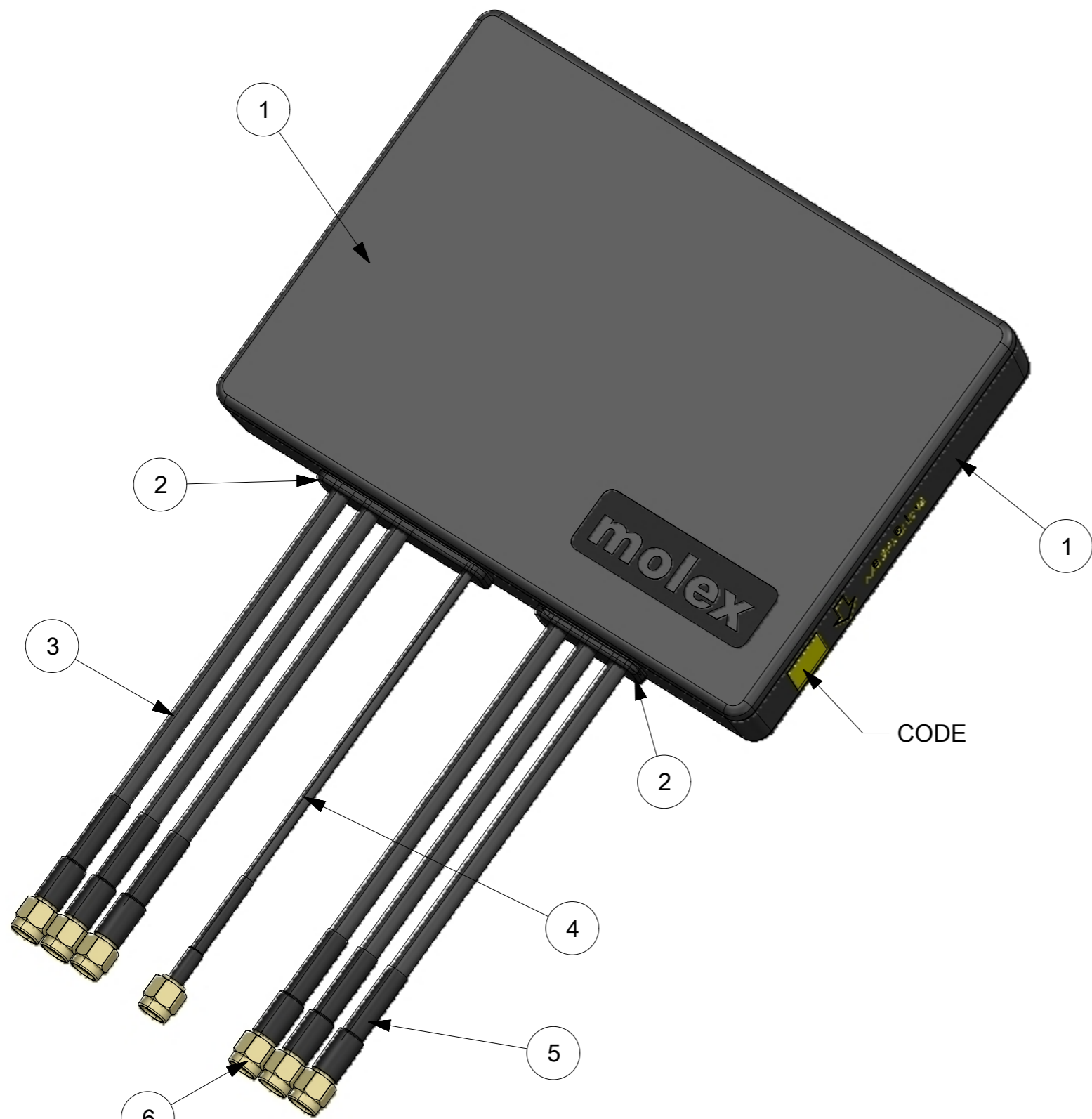

3D VIEW

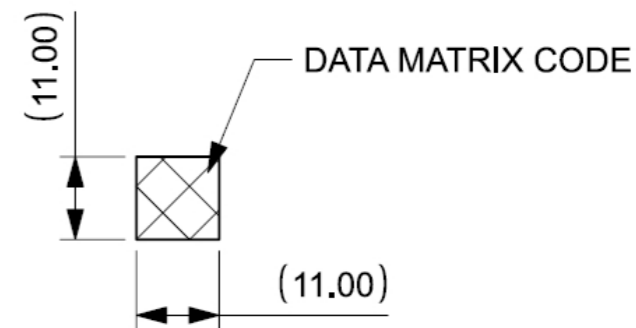

DATA MATRIX CODE

SIZE:11X11mm

CODING:7IN1 ANTENNA#2178531000#XXXXXXXXXX#XXXX

PROJECT NAME MOLEX P/N YEAR MONTH DATE ROLLING NO.

FOR EXAMPLE:7 IN 1 ANTENNA#2178531000#20210906#0005
 MEANS PROJECT:7IN1 ANTENNA, PRODUCT:2178531000
 THE FIFTH PRODUCT ON SEP6, 2021

BOM TABLE-A			
LTEM	PART NAME	QTY	REMARK
1	HOUSING	2 PCS	PC&ABS BLACK
2	SEALING RING	2 PCS	SILICONE BLACK
3	CABLE-1	6 PCS	Ø5MM BLACK JACK
4	CABLE-2	1 PCS	Ø2.8MM BLACK JACK
5	HEAT SHRINK TUBE	7 PCS	BLACK IN COLOR
6	CONNECTOR	7 PCS	SMA STRAIGHT CABLE PLUGS (MALE) GOLD PLATING

FUNCTIONAL SYMBOLS $\nabla_A = 0$ $\nabla_E = 0$ $\nabla_V = 0$	THIS DRAWING CONTAINS INFORMATION THAT IS PROPRIETARY TO MOLEX ELECTRONIC TECHNOLOGIES, LLC AND SHOULD NOT BE USED WITHOUT WRITTEN PERMISSION	SCALE	CURRENT REV DESC:							
	DIMENSION UNITS	1:1								
	GENERAL TOLERANCES (UNLESS SPECIFIED)									
	ANGULAR TOL	± °	EC NO: 726265 DRWN: KCHENG06 2022/10/28 CHK'D: HORACM1 APPR: HORACM1 2022/10/28							
DIVISIONAL SYMBOLS 4 PLACES ± 3 PLACES ± 1.5 2 PLACES ± 2.0 1 PLACE ± 3.0 0 PLACES ±	DRAFT WHERE APPLICABLE MUST REMAIN WITHIN DIMENSIONS	THIRD ANGLE PROJECTION	DRAWING	SERIES	MATERIAL NUMBER	CUSTOMER	DOCUMENT NUMBER	DOC TYPE	DOC PART	REVISION
			A3-SIZE	217853	2178531000	GENERAL MARKET	2178531000	PSD	000	A1

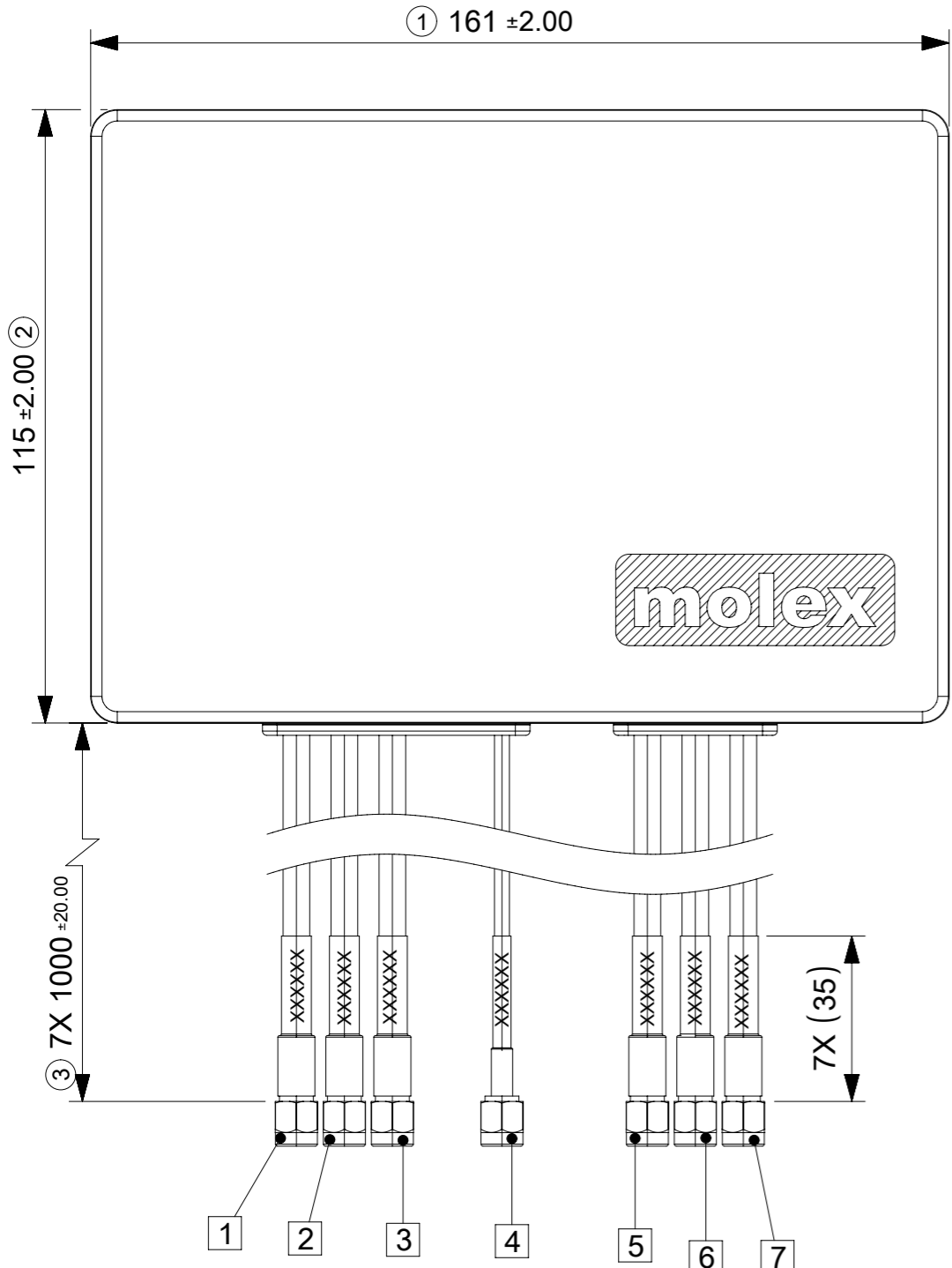

TOP VIEW

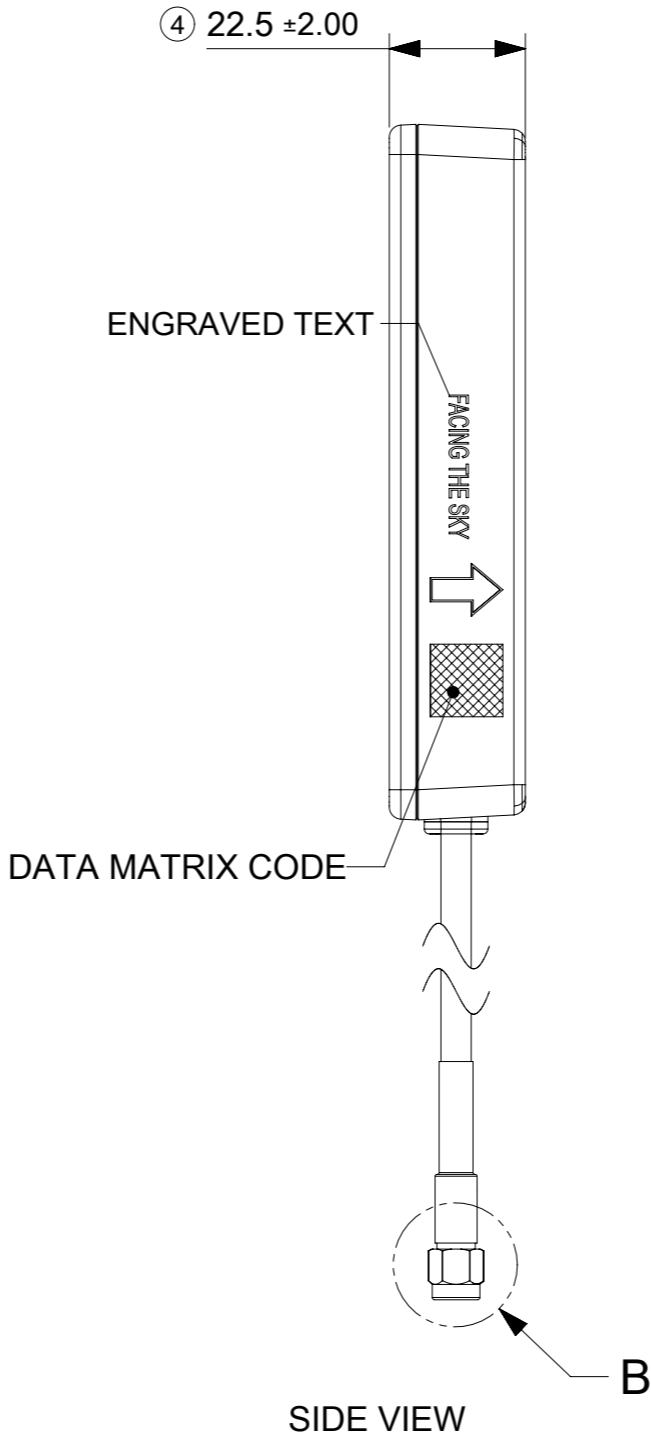

SIDE VIEW

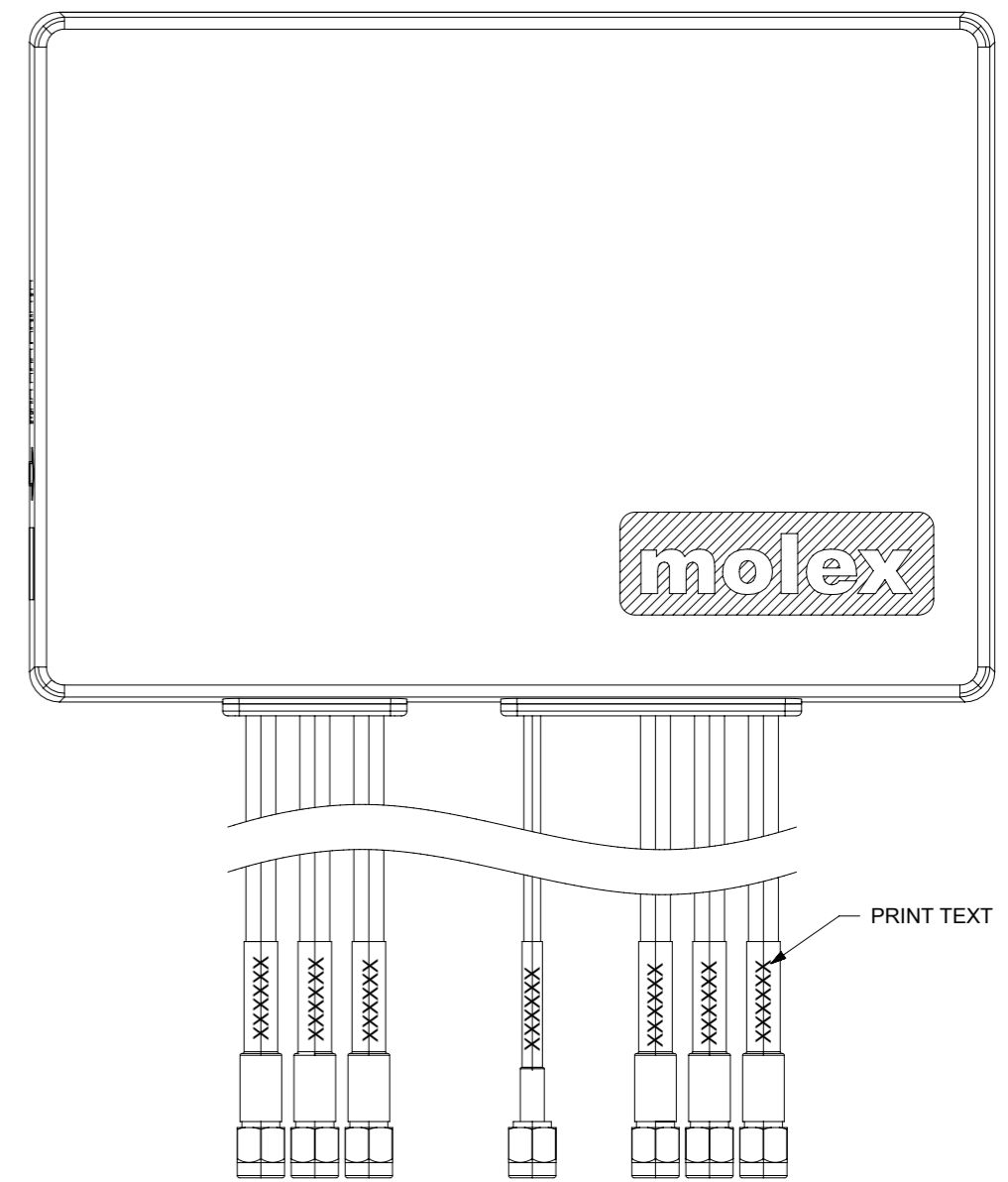

BOTTOM VIEW

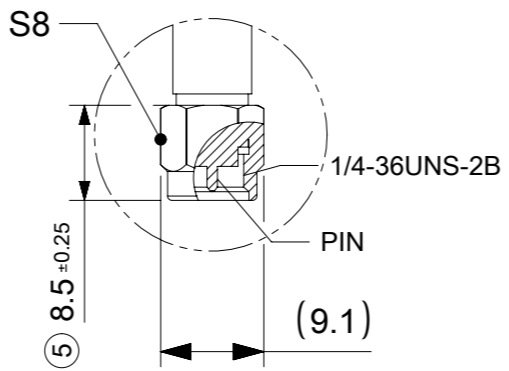

DETAIL B
SCALE 3:2

CABLE INFORMATION		
LTEM	REMARK	PRINT TEXT
1	Ø5±0.15	5G High Band-2
2		WIFI-2
3		LTE/5G Full Band-2
4	Ø2.8±0.15	GNSS
5	Ø5±0.15	WIFI-1
6		LTE/5G Full Band-1
7		5G High Band-1

FUNCTIONAL SYMBOLS $\nabla_A = 0$ $\nabla_E = 0$ $\nabla_F = 0$	DIMENSION UNITS: mm SCALE: 1:1	THIS DRAWING CONTAINS INFORMATION THAT IS PROPRIETARY TO MOLEX ELECTRONIC TECHNOLOGIES, LLC AND SHOULD NOT BE USED WITHOUT WRITTEN PERMISSION CURRENT REV DESC: EC NO: 726265 DRWN: KCHENG06 CHK'D: HORACM1 APPR: HORACM1 INITIAL REVISION: DRWN: KCHENG06 APPR: HORACM1					
	GENERAL TOLERANCES (UNLESS SPECIFIED) ANGULAR TOL ± °					MOLEX MULTI-HUB ANTENNA 7-IN-1	
	DIVISIONAL SYMBOLS 4 PLACES ± 3 PLACES ± 1.5 2 PLACES ± 2.0 1 PLACE ± 3.0 0 PLACES ±		DRAFT WHERE APPLICABLE MUST REMAIN WITHIN DIMENSIONS		PRODUCT CUSTOMER DRAWING		
			THIRD ANGLE PROJECTION		DOCUMENT NUMBER: 2178531000	DOC TYPE: PSD	DOC PART: 000
A3-SIZE		SERIES: 217853	MATERIAL NUMBER: 2178531000	CUSTOMER: GENERAL MARKET	SHEET NUMBER: 2 OF 3		

EXTERNAL ADHESIVE(P/N:2178530018):

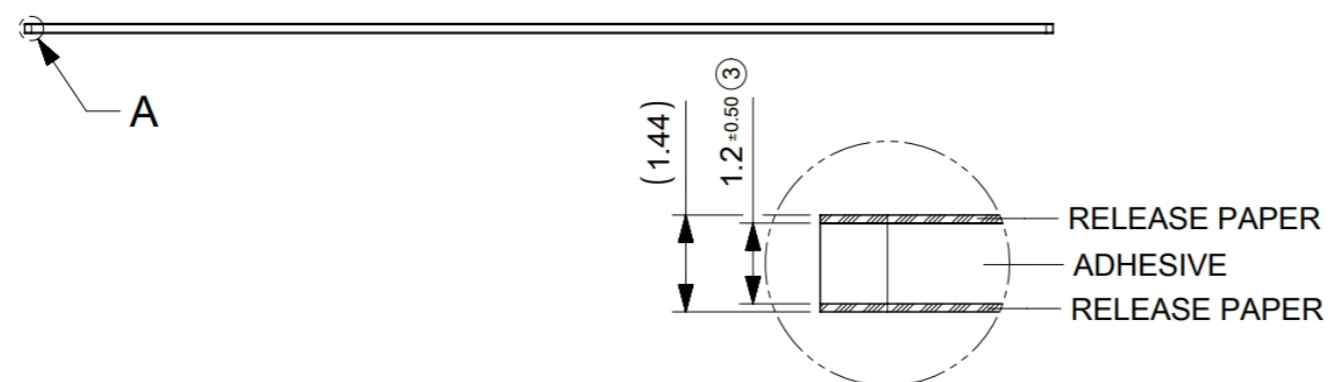
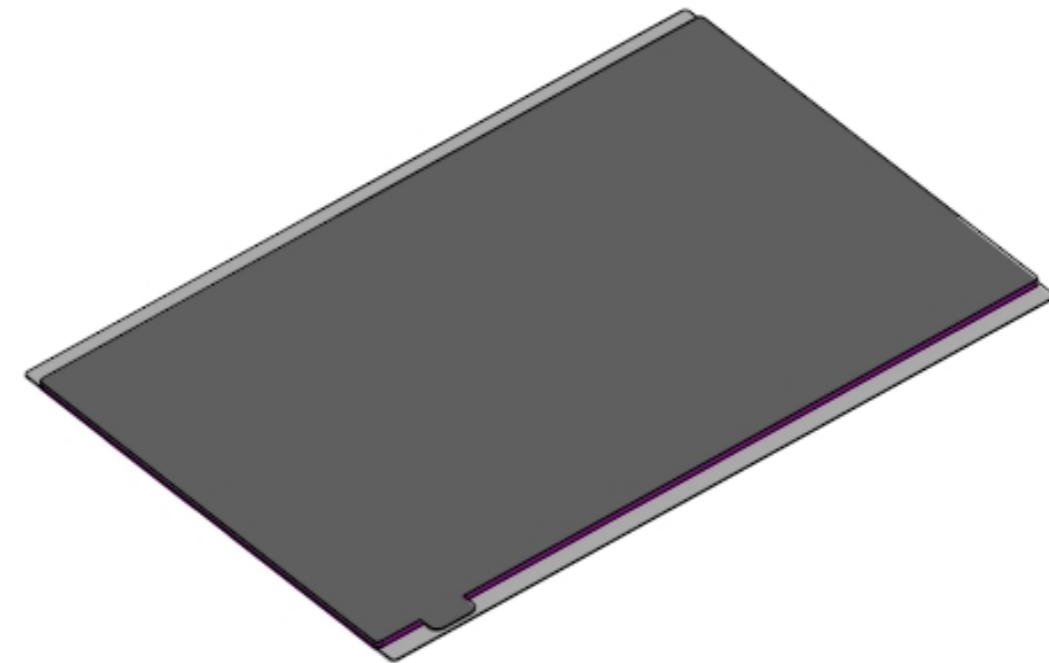
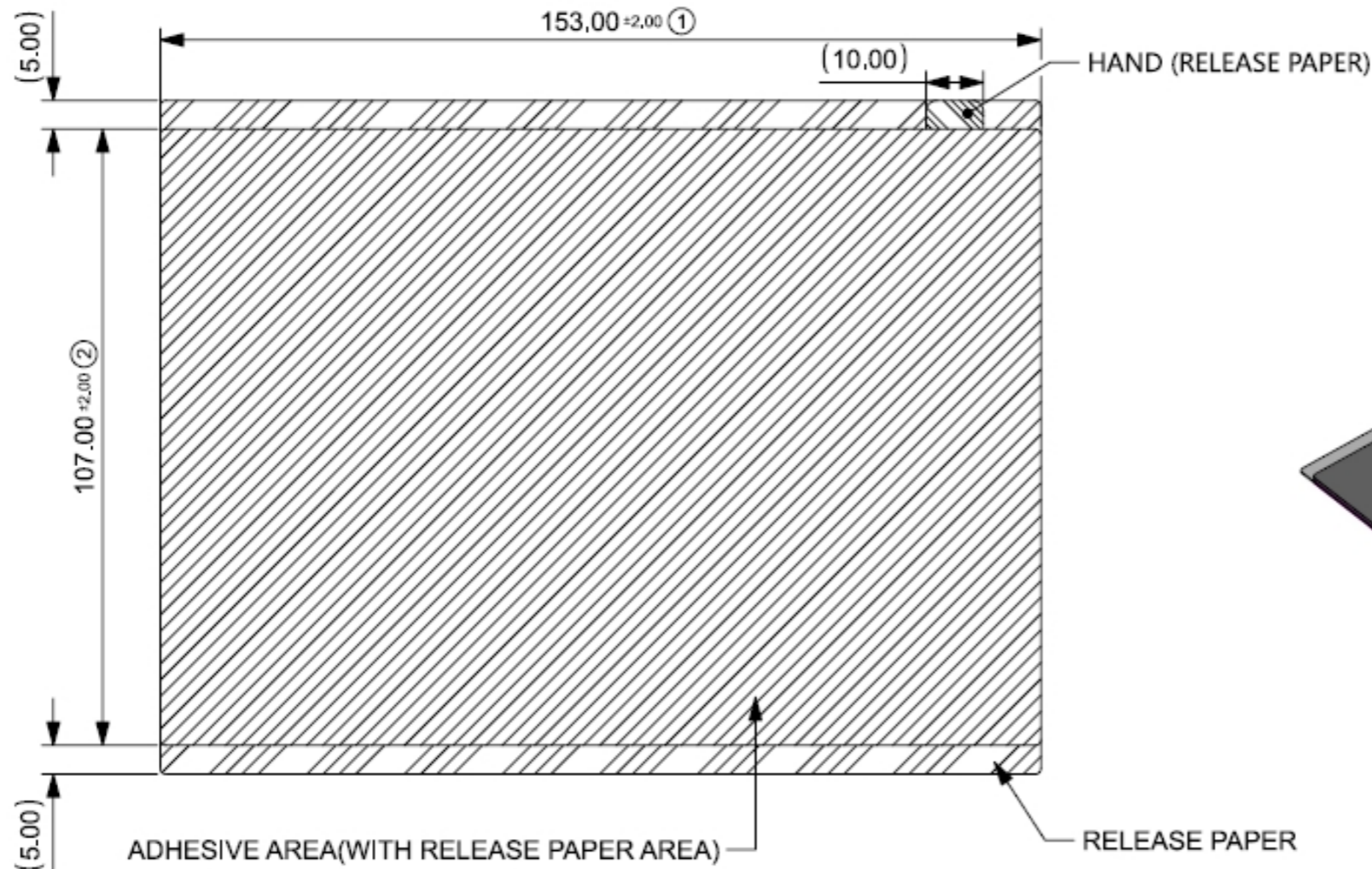

NOTES:
1. MATERIAL THICKNESS 1.2MM, COLOR: BLACK.

FUNCTIONAL SYMBOLS	THIS DRAWING CONTAINS INFORMATION THAT IS PROPRIETARY TO MOLEX ELECTRONIC TECHNOLOGIES, LLC AND SHOULD NOT BE USED WITHOUT WRITTEN PERMISSION		CURRENT REV DESC:			molex			
	DRWN: KCHENG06	2022/10/28							MOLEX MULTI-HUB ANTENNA 7-IN-1
GENERAL TOLERANCES (UNLESS SPECIFIED)	mm		SCALE 1:1		PRODUCT CUSTOMER DRAWING				
ANGULAR TOL	±	°	EC NO: 726265		DOCUMENT NUMBER				
4 PLACES	±		DRWN: KCHENG06		2022/10/28		DOC TYPE		
3 PLACES	±	1.5	CHK'D: HORACM1		2022/10/28		DOC PART		
2 PLACES	±	2.0	APPR: HORACM1		2022/10/28		REVISION		
1 PLACE	±	3.0	INITIAL REVISION:		2022/03/15		2178531000		
0 PLACES	±		DRWN: KCHENG06		2022/10/14		PSD 000 A1		
DRAFT WHERE APPLICABLE MUST REMAIN WITHIN DIMENSIONS		THIRD ANGLE PROJECTION		DRAWING		SERIES		MATERIAL NUMBER	
		A3-SIZE		217853		CUSTOMER		GENERAL MARKET	
								SHEET NUMBER	
								3 OF 3	