

Product data sheet

Characteristics

XZCPA1164L10

Pre wired connectors XZ, elbowed female, M12, 5 pins, cable PVC 10 m



Main

Range of Product	Telemecanique Cabling components
Accessory / separate part category	Cabling accessory
Accessory / Separate Part Type	Pre-wired connectors
Series name	Application

Complementary

Electrical connection	Elbowed female connector M12, 5 pins (included earth pin)
Cable connector fixing	Screw-on
Collar material	Stainless steel 316L
Status LED	Without
Cable length	32.81 ft (10 m)
Cable outer diameter	0.22 in (5.7 mm)
Cable composition	5 x 0.34 mm ²
Wire insulation material	PVC
[Ue] rated operational voltage	60 V AC 75 V DC
Line Rated Current	4 A
Contact resistance	5000 µOhm
Minimum insulating resistance	1 GΩ
Net Weight	1.07 lb(US) (0.485 kg)

Environment

IP Degree of Protection	IP69K
Ambient air temperature for operation	-13...185 °F (-25...85 °C) static
Ambient Air Temperature for Storage	-31...212 °F (-35...100 °C)



Ordering and shipping details

Category	22483-MACHINE CABLES
Discount Schedule	DS3
GTIN	3389119021524
Nbr. of units in pkg.	1
Package weight(Lbs)	17.21 oz (488.0 g)
Returnability	No
Country of origin	PL

Packing Units

Unit Type of Package 1	PCE
Package 1 Height	1.57 in (4 cm)
Package 1 width	9.84 in (25 cm)
Package 1 Length	9.84 in (25 cm)

Offer Sustainability

California proposition 65	WARNING: This product can expose you to chemicals including: Diisononyl phthalate (DINP), which is known to the State of California to cause cancer, and Di-isodecyl phthalate (DIDP), which is known to the State of California to cause birth defects or other reproductive harm. For more information go to www.P65Warnings.ca.gov
REACH Regulation	 REACH Declaration
REACH free of SVHC	Yes
EU RoHS Directive	Pro-active compliance (Product out of EU RoHS legal scope)  EU RoHS Declaration
Toxic heavy metal free	Yes
Mercury free	Yes
RoHS exemption information	 Yes

Contractual warranty

Warranty	18 months
----------	-----------

Dimensions

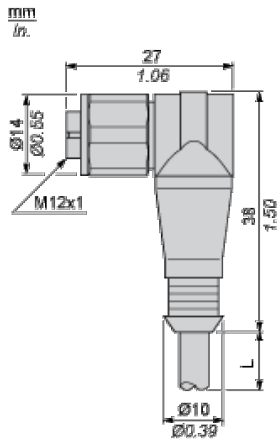

L : Length of cable

Connections and Schemes

Connectors

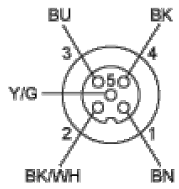

BU : Blue
BN : Brown
BK : Black
Y/G : Yellow / Green
BK/ Black / White
WH :