

THIS INFORMATION IS CONFIDENTIAL AND IS DELIVERED TO YOU ON CONDITION THAT
 YOU WILL NOT DISCLOSE IT TO OTHERS WITHOUT THE WRITTEN PERMISSION OF THE
 CONTROLLING ENGINEERING ORGANIZATION SHOULD BE CONTACTED FOR THE LATEST REVISION.

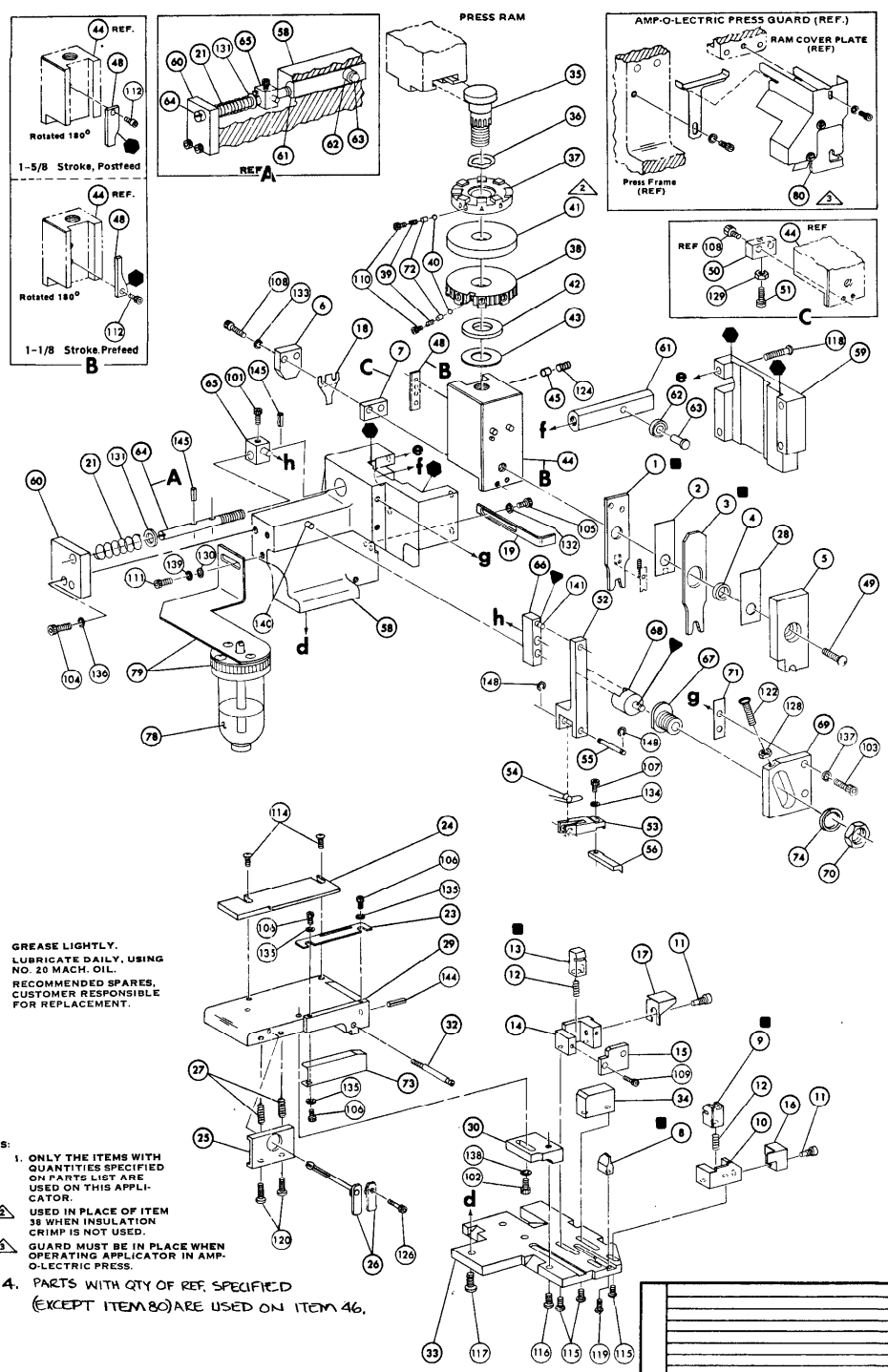

KEY:
 ■ GREASE LIGHTLY.
 LUBRICATE DAILY, USING
 NO. 20 MACH. OIL.
 ■ RECOMMENDED SPARES,
 CUSTOMER RESPONSIBLE
 FOR REPLACEMENT.

NOTES:
 1. ONLY THE ITEMS WITH
 QUANTITIES SPECIFIED
 ON PARTS LIST ARE
 USED ON THIS APPLI-
 CATOR.
 ⚠ USED IN PLACE OF ITEM
 38 WHEN INSULATION
 CRIMP IS NOT USED.
 ⚠ GUARD MUST BE IN PLACE WHEN
 OPERATING APPLICATOR IN AMP-
 O-LECTRIC PRESS.
 4. PARTS WITH QTY OF REF. SPECIFIED
 (EXCEPT ITEM 80) ARE USED ON ITEM 46.

162	REF	690517-1	SPACER	71
161		22594-8	NUT, HEX	70
160		24062-1	PLATE, ADJUSTMENT	69
159		240626-1	SHAFT, PIVOT	68
158		240633-1	BUSHING	67
157		455680-1	LEVER, INTERMEDIATE	66
156		240629-1	BLOCK, PIVOT	65
155		240632-2	SCREW, ADJUSTMENT, FEED ROD	64
154		240659-3	PIN, CAM ROLLER	63
153		240658-1	ROLLER, CAM	62
152		454398-2	ROD, FEED	61
151		454178-1	GUIDE, FEED ROD	60
149		454220-1	CAP, HOUSING	59
148	REF	454485-1	HOUSING	58
147	REF	21045-3	RING, RETNG "C" (.187 DIA) FEED FINGER PIN	57
146		690542-2	PAWL, FEED	56
145	REF	240624-1	PIN, FEED FINGER	55
144	REF	691499-1	SPRING, FEED FINGER	54
143	REF	690541-1	FINGER, FEED	53
142		455679-1	LEVER, TERMINAL FEED ARM	52
141		811242-2	BUMPER, HOLDDOWN	51
140	REF	690753-1	SPACER, TONKER	50
139		121002-9	BOLT, CRIMPER	49
138		690501-4	CAM POSTFEED 5/8STROKE	48
137		459456-1	APPL, BASIC SUB ASSY	47
136		690191-1	PLUG, NYLON	46
135		455673-1	RAM	45
134		690125-1	WASHER, LAMINATED	44
133		690124-1	WASHER, RAM	43
132		23241-6	DISC, SPACER	42
131	Z	23241-6	BALL, STEEL	41
130	Z	690170-1	SPRING, COMPRESSION	40
129		690147-1	DISC, INSULATION	39
128		690692-3	DISC, WIRE	38
127		22480-5	WASHER, SPRING	37
126		690212-1	POST, RAM	35
125		690786-6	SUPPORT, TERMINAL	34
124	REF	455675-1	PLATE, BASE	33
123		690432-3	SCREW, ADJUSTMENT	32
122		21064-2	SCREW, RD HD MACH (6-32 x 1.50) FEED ADJ	31
121	REF	455689-1	BLOCK, STRIP GUIDE ADJ	30
120		455611-1	PLATE, STRIP GUIDE	29
119		1-455688-0	SPACER, F. SHEAR DEPRESSOR	28
118		1-27284-0	SPRING, DRAG	27
117		690546-1	LEVER, DRAG RELEASE	26
116		240192-1	DRAG, STOCK	25
115		690504-1	GUIDE, STRIP REAR	24
114		690438-1	GUIDE, STRIP FRONT	23
113		42284-9	SPRING, FEED RETURN	22
112	REF	690472-1	STRIPPER	21
111		690472-1	HOLDER, TERMINAL	20
110		690472-1	GUARD, CHIP REAR	19
109		690472-1	GUARD, CHIP FRONT	18
108		690472-1	PLATE, SHEAR REAR	17
107		690472-1	HOLDER, SHEAR REAR	16
106		690472-1	SHEAR, FLOAT REAR	15
105		690472-1	SPACER, DEPRESSOR REAR	14
104		690472-1	DEPRESSOR, SHEAR REAR	13
103		690472-1	DEPRESSOR, SHEAR FRONT	12
102		690472-1	SPACER, TUBULAR, INS CRIMPER	11
101		690472-1	CRIMPER, INSULATION	10
100		690472-1	CRIMPER, CRIMPER	9
99		690472-1	CRIMPER, WIRE	8
98		690472-1	CRIMPER, WIRE	7
97		690472-1	CRIMPER, WIRE	6
96		690472-1	CRIMPER, WIRE	5
95		690472-1	CRIMPER, WIRE	4
94		690472-1	CRIMPER, WIRE	3
93		690472-1	CRIMPER, WIRE	2
92		690472-1	CRIMPER, WIRE	1

REG.	PART NO.	DESCRIPTION	NO.	REG.	PART NO.	DESCRIPTION	NO.
REF	458109-1	WASHER, FLAT, SPECIAL	76				
1	454811-3	PLATE, STRIP GUIDE COVER	75				
2	690603-1	SPRING, ASSIST	74				
			73				
			72				

CRIMPING DATA				THIS APPLICATOR WILL APPLY	
PAC LETTER	CRIMP HEIGHT	WIRE SIZE	WIRE STRIP LENGTH		
A	.068	# 14		SOC	PIN
B	.059	# 16		66578	66577
C	.052	# 18		66651	66650
D	NOT USED				

CRIMP	SIZE	TYPE	FEED	USED ON
WIRE	.030	F	.500	MACH NO.
INSULATION	140	O		

INSULATION RANGE	WIRE RANGE	APPLICATOR INSTRUCTION
105-135	18-14	#3040

REMARKS: AMPOMATOR

APPLICATION SPECIFICATION: 114-10007

F1	ECR15-010/64	DATE	11-29-79
F	0150-6987-96	DATE	11-22-79
E	ECR15-010/64	DATE	11-22-79
D3	REV PER ECR	DATE	11-22-79
D2	REV PER ECR	DATE	11-22-79
D1	ADD TUBULAR INS CRIMPER	DATE	11-22-79
C	REV PER ECR	DATE	11-22-79
B	REV PER ECR	DATE	11-22-79
A	REV PER ECR	DATE	11-22-79
01	ADD ITEM 66551 PER ECR	DATE	11-22-79

I.D. PLATE (REF): 461264-1

LOC	C	NO.	687997-3
TE Connectivity			

APPLICATOR MINIATURE QUICK CHANGE SIDE-FEED (TYPE II .062 DIA. PIN & SOC.)

THIS INFORMATION IS CONFIDENTIAL AND IS DELIVERED TO YOU ON CONDITION THAT
 YOU WILL NOT DISCLOSE IT TO OTHERS WITHOUT THE WRITTEN PERMISSION OF THE
 CONTROLLING ENGINEERING ORGANIZATION SHOULD BE CONTACTED FOR THE LATEST REVISION.

DIMENSIONS IN INCHES DO NOT SCALE PRINT
 11/23/79
 11/23/79

114-10007-3