

P	LTR	DESCRIPTION	DATE	DWN	APVD
A3		REVISED PER ECR-22-146621	26JUL2022	RZ	WK

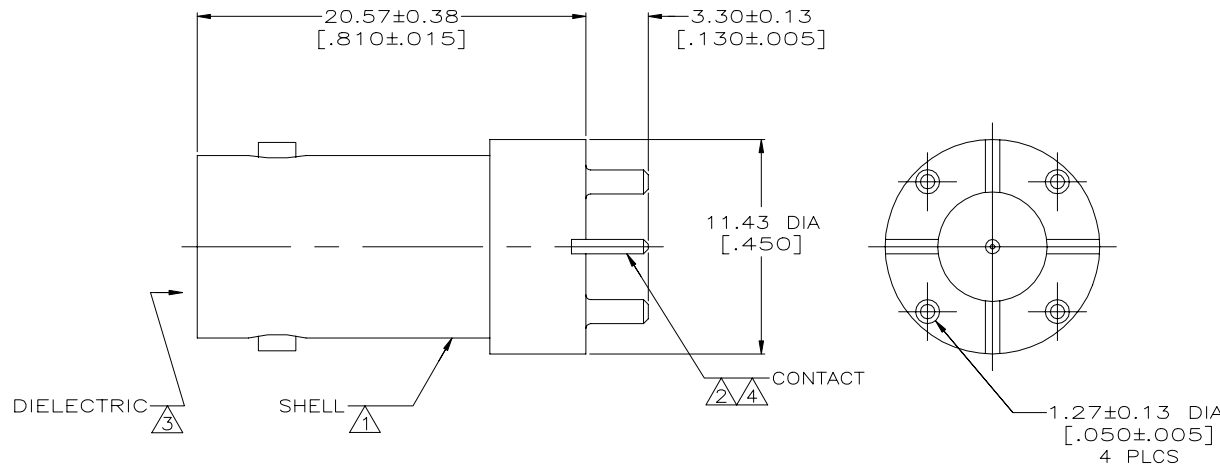

- ① ZINC PER QQ-Z-363
- ② BERYLLIUM COPPER PER ASTM-B-196
- ③ PTFE PER MIL-P-19468
- ④ GOLD PLATE PER MIL-G-45204  
0.76 μm [.000030] MINIMUM THICK.
- ⑤ TIN PLATE PER ASTM-B-545,  
3.04 μm [.000120] MINIMUM THICK.
- 6. SEE INSTRUCTION SHEET 408-9889.
- ⑦ NICKEL PLATE PER QQ-N-290  
5.08 μm [.000200] MINIMUM THICK.
- ⑧ PACKAGE: 100 PER BAG/CARTON
- ⑨ PACKAGE: 28 PER TRAY PACKAGE

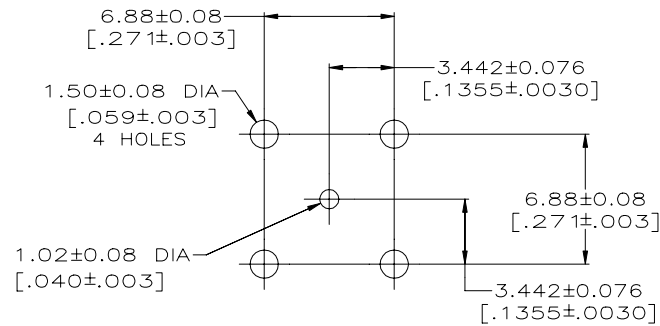

PCB CONFIGURATION

⑨	⑤	1-6274291-1
⑧	⑦	6274291-2
⑧	⑤	6274291-1
SHELL FINISH		PART NUMBER

THIS DRAWING IS A CONTROLLED DOCUMENT.		DWN L. VARELA - 02FEB2005	TE Connectivity																								
DIMENSIONS: INCHES		CHK J. HAVFNER - 02FEB2005	NAME																								
TOLERANCES UNLESS OTHERWISE SPECIFIED:		APVD J. LIPPERT - 02FEB2005	PRODUCT SPEC: 108-12078																								
<table border="1"> <tr><td>0</td><td>PLC</td><td>±</td><td>-</td></tr> <tr><td>1</td><td>PLC</td><td>±</td><td>-</td></tr> <tr><td>2</td><td>PLC</td><td>±</td><td>0.20 [.008]</td></tr> <tr><td>3</td><td>PLC</td><td>±</td><td>-</td></tr> <tr><td>4</td><td>PLC</td><td>±</td><td>-</td></tr> <tr><td colspan="2">ANGLES</td><td>±</td><td>-</td></tr> </table>		0	PLC	±	-	1	PLC	±	-	2	PLC	±	0.20 [.008]	3	PLC	±	-	4	PLC	±	-	ANGLES		±	-	APPLICATION SPEC: -	
0	PLC	±	-																								
1	PLC	±	-																								
2	PLC	±	0.20 [.008]																								
3	PLC	±	-																								
4	PLC	±	-																								
ANGLES		±	-																								
MATERIAL SEE NOTES 1 - 3		FINISH SEE NOTES 4, 5	WEIGHT 0.000000	RESTRICTED TO -																							
CUSTOMER DRAWING		SCALE 5:1	SHEET 1 of 1	REV A3																							