

IN THE CONSTANT PURPOSE OF IMPROVING ITS PRODUCTS, AMPHENOL SOCAPEX RESERVES THE RIGHT TO MODIFY ANY DIMENSION OR CHARACTERISTICS.
FM.NPD.0036.THYEZ.PUNE rev C

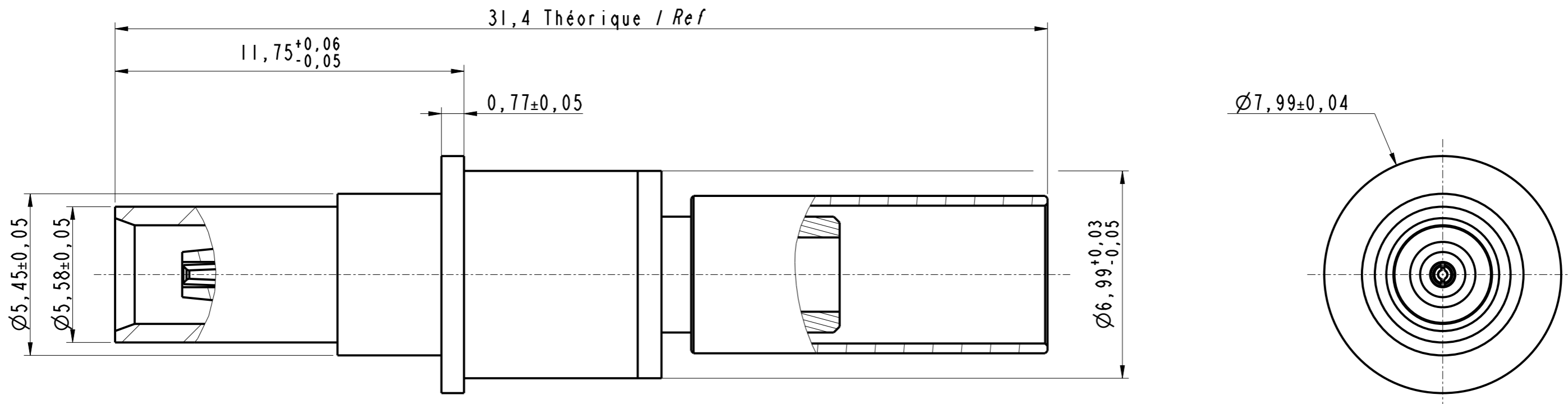

Note

- ① - Contact livré non assemblé
Contact delivered unassembled
 - ② - Cable compatible: V73263
Cable compatible: V73263
 - ③ - Outil de sertissage:
Contact intérieur TBD
Contact extérieur TBD
- *Crimping tool:*
Inner contact TBD
Outer contact TBD
 - ④ - *Matières:*
 - Contact extérieur: inox
 - Contact intérieur: alliage de cuivre
 - Fut de sertissage et ferrule: laiton
 - Isolants: PTFE ou équivalent
 - ⑤ - *Traitements:*
 - Contact extérieur: passivation
 - Contact intérieur, fut de sertissage et ferrule: dorure
- Material:*
- Outer contact: Stainless steel
 - Inner contact: copper alloy
 - Crimping barrel and ferrule: brass
 - Inserts: PTFE or equivalent
- Finish:*
- Outer contact: passivation
 - Inner contact, crimping barrel and ferrule: Gold

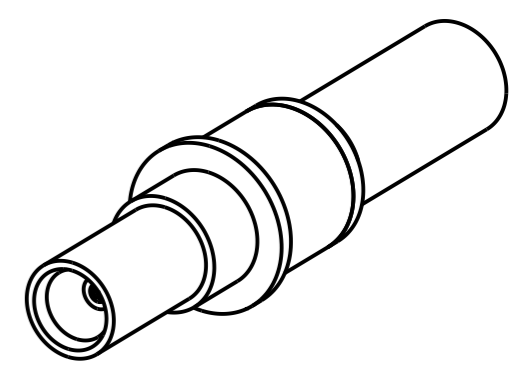

Broche Coax T8 75 ohms 6G-SDI Pin coax S8 75 ohms 6G-SDI Ref : 612470			
DRAWN BY : M.PRUD'HOM		UPDATED BY : M.LAINE	
		LAST APPROVED BY : L.LAGRANGE	
<small>ALL DIMENSIONS ARE IN MM</small> SCALE : 7 	AMPHENOL SOCAPEX B.P. 29 74311 THYEZ CEDEX		ORIGINAL DRAWING DATE : 24/02/21 CONFIGURATION DATA ARE AVAILABLE IN PDM
			REV : B PAGE : 1/1
172-PLC-269-00			