

PART NUMBER	REV	DESCRIPTION	PROGRAMMED MEMORY CHIP
1911259-1	A	CUTS CARRIER	8-1911259-1
1911259-6	A	CONTINUOUS CARRIER	8-1911259-6
7-1911259-1	A	-1 AND SPARE PARTS	9-1911259-1
7-1911259-6	A	-6 AND SPARE PARTS	9-1911259-6
7-1911259-7	A	SPARE PARTS KIT	-

APPLICATOR DATA		
CRIMP	SIZE	TYPE
WIRE	.074 [1.88mm]	F
INSUL	.090 [2.29mm]	O
APPL INSTRUCTIONS 408-10135		

TERMINAL DATA: DEUTSCH TERMINAL		DEUTSCH CRIMP SPEC	
TERMINAL NAME: TERMINAL, PIN			
WIRE STRIP LENGTH .150-.200 IN [3.8-5.1 mm]		INSULATION DIAMETER RANGE .075-.105 IN [1.91-2.66mm]	
TERMINAL APPL SPEC	0425-207-0000	-	-

TE TERMINAL	DEUTSCH TERMINAL	TE TERMINAL	DEUTSCH TERMINAL
286680-1	1062-20-0122	286680-8	1062-20-0444
286680-2	1062-20-0144	1572032-1	1060-20-0122
286680-3	1062-20-0222	1572032-2	1060-20-0144
286680-4	1062-20-0244	1572032-3	1060-20-0222
286680-5	1062-20-0322	1572032-4	1060-20-0244
286680-6	1062-20-0344	1572032-5	1060-20-0422
286680-7	1062-20-0422	1572032-6	1060-20-0444

WIRE SIZE	CRIMP HEIGHT INCH[mm]
16AWG or 1mm <sup>2</sup>	.050 ± .001 [1.27 ± .03]
18AWG	.049 ± .001 [1.24 ± .03]
0.75mm <sup>2</sup>	.048 ± .001 [1.22 ± .03]
0.6mm <sup>2</sup>	.042 ± .001 [1.07 ± .03]
20AWG	.039 ± .001 [.99 ± .03]
0.5mm <sup>2</sup>	.038 ± .001 [.97 ± .03]
22AWG	.037 ± .001 [.94 ± .03]

- ⚠ RECOMMENDED SPARE PARTS.
- ⚠ GREASE BEARING SURFACES LIGHTLY.
- 3. LUBRICATE DAILY PER THE APPLICATOR INSTRUCTION SHEET SUPPLIED WITH THE APPLICATOR.
- ⚠ ITEM 19 - OPTIONAL STRIPPER FOR BENCH MACHINE APPLICATIONS.
- ⚠ APPLICATOR SPECIFIC DATA TO BE ENTERED INTO BLANK MEMORY CHIP AT ASSEMBLY.
- ⚠ APPLY P/N 1-23419-5 LOCTITE(R) TO THREADS.
- ⚠ SEE CHART ON SHEET 2 FOR ADDITIONAL APPLICATORS TO RUN THIS TERMINAL WITH ADDITIONAL INSULATION DIAMETER RANGES.
- ⚠ RECOMMENDED INSULATION RANGE .105-.118. INSULATION DIAMETER ABOVE .118 NOT RECOMMENDED. STRANDING COULD RESULT.

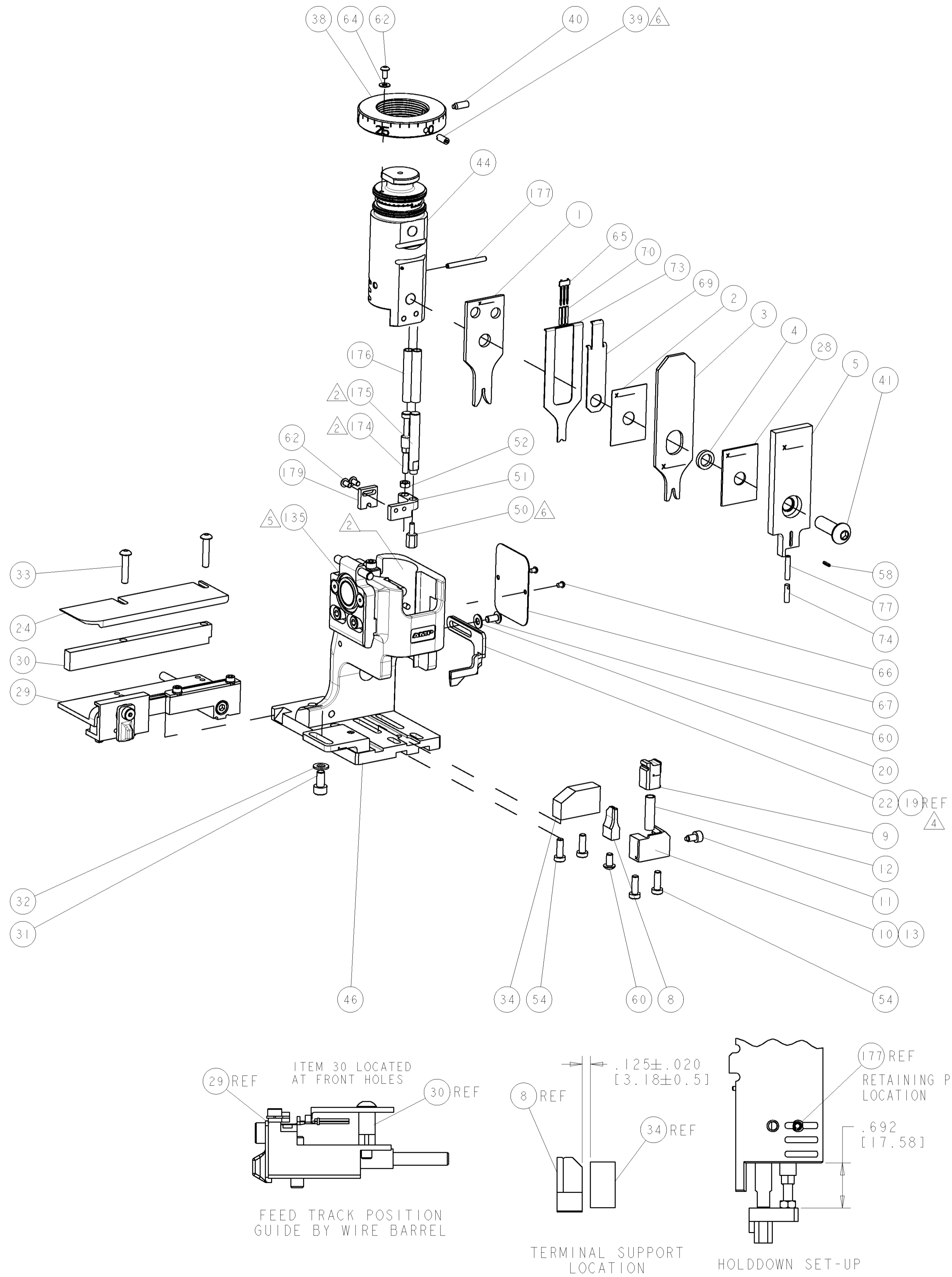

FEED FINGER	SET UP GAGE	LOC	DIST	REVISIONS			
1901694-1	1901067-1	A	66	REV	DATE	BY	APPV
				A	RELEASED	28OCT2008	MEH GB

REV	QTY	DESCRIPTION	ITEM NO
-	1	1976053-1 LOCATER BLOCK, TERMINAL	179
-	1	1-993111-6 PIN, SLOTTED SPRING 3.0 X 30.0	177
-	2	3-22280-7 SPRING, COMPRESSION	176
-	1	1752353-1 GUIDE PIN, HOLDDOWN	175
-	1	1901680-1 GUIDE PIN, HOLDDOWN	174
-	REF	SEE TABLE MEMORY CHIP, PROGRAMMED	135
-	1	22278-7 SPRING, COMPRESSION	77
-	1	854769-4 HOLDER, INS	74
-	1	1490525-3 DEPRESSOR, WIRE	73
-	1	1633565-1 DOCUMENTATION PACKAGE S111	71
-	3	2-23147-2 SPRING, COMPRESSION	70
-	1	1490524-1 DEPRESSOR, SPACER	69
-	1	1901048-1 TAG, IDENTIFICATION	67
-	2	21017-1 SCREW, DRIVE	66
-	1	1424350-1 HOLDER, PIN, WIRED	65
-	1	18028-1 WASHER, FLAT, REG M3	64
-	3	1655785-9 SCR, BTN SKT HD CAP (M3 X 6)	62
-	2	1655785-1 SCR, BTN SKT HD CAP (M4 X 8)	60
-	1	21028-2 PIN, SLOTTED SPRING .062 X .250	58
-	4	1655783-3 SCR, CAP, SOC HD, LOW HEAD, M4 X 12	54
-	1	1-18030-0 NUT, HEX, REG M3.5	52
-	1	1901681-8 HOLDDOWN, TERMINAL	51
-	1	1-1752354-8 STANDOFF, HOLD-DOWN	50
-	1	1752300-1 SF SYSTEM III APPLICATOR	46
-	1	1752308-1 RAM	44
-	1	2-1655785-3 SCR, BTN SKT HD CAP (M8 X 25)	41
-	1	993002-4 SCREW, SET, SFT TIP	40
-	1	1962043-1 PLUNGER, BALL, METRIC	39
-	1	1752309-3 RING, INSULATION CRIMP	38
-	1	1-1752356-2 SUPPORT, TERMINAL	34
-	2	3-1655785-3 SCR, BTN SKT HD CAP (M4 X 20)	33
-	1	18028-3 WASHER, FLAT, REG M5	32
-	1	5-1655316-3 SCR, SKT HD CAP, M5 X 10.0	31
-	1	1320908-1 SPACER, STRIP GUIDE	30
-	1	1901087-1 ASSEMBLY, STRIP GUIDE	29
-	1	1-455888-0 SPACER, CRIMPER	28
-	1	1320928-1 PLATE, STRIP GUIDE	24
-	1	1976045-1 STRIPPER	22
-	1	18028-2 WASHER, FLAT, REG M4	20
-	REF	1752311-1 STRIPPER	19
-	1	1338684-2 SHEAR HOLDER, FRONT	13
-	1	3-22280-3 SPRING, COMPRESSION	12
-	1	356885-5 STOP, SHEAR	11
-	-	1-1320921-0 SHEAR HOLDER, FRONT, CUT	10
-	1	462006-6 FLOATING SHEAR, FRONT	9
-	1	1633703-6 ANVIL, COMBINATION	8
-	1	854772-1 DEPRESSOR, SHEAR	5
-	1	1-238011-0 BLOCK, CRIMPER SPACER	4
-	1	5-904741-8 CRIMPER, INSUL O PREMIUM	3
-	1	455888-3 SPACER, CRIMPER	2
-	1	6-1673600-7 CRIMPER, WIRE	1

DIMENSIONS: INCHES[mm]	TOLERANCES UNLESS OTHERWISE SPECIFIED:	FINISH	APPLICATOR SPEC	SEE TABLE
0 PLC	±			
1 PLC	±			
2 PLC	±			
3 PLC	±			
4 PLC	±			
5 PLC	±			
6 PLC	±			
ANGLES	±			

LOC	DIST	REVISIONS					
A	66	F	LTR	DESCRIPTION	DATE	DWN	APVD
		-		SEE SHEET 1	-	-	-

## TERMINAL APPLICATION CHART

TERMINAL PART NUMBERS (PIN TERMINALS)		TOOLING INSULATION RANGE	APPLICATOR PART NUMBER	ANVIL	INSULATION CRIMPER	WIRE CRIMPER	INSULATION CRIMP WIDTH	WIRE CRIMP WIDTH
DEUTSCH	TYCO ELECTRONICS							
1060-20-0222 1060-20-0244 1060-20-0422 1060-20-0444	1572032-3 1572032-4 1572032-5 1572032-6	.050-.075	1911257-1	1633703-4	5-904741-4	6-1673600-7	.062 (O)	.074 (F)
1060-20-0122 1060-20-0144 1060-20-0222 1060-20-0244 1060-20-0422 1060-20-0444	1572032-1 1572032-2 1572032-3 1572032-4 1572032-5 1572032-6	.063-.094	1911258-1	1633703-5	5-904741-3	6-1673600-7	.080 (O)	.074 (F)
1060-20-0122 1060-20-0144	1572032-1 1572032-2	.075-.105	1911259-1	1633703-6	5-904741-8	6-1673600-7	.090 (O)	.074 (F)
1060-20-0122 1060-20-0144	1572032-1 1572032-2	.085-.111	1911253-1	1633703-3	5-456135-0	6-1673600-7	.100 (O)	.074 (F)
1060-20-0122 1060-20-0144	1572032-1 1572032-2	.105-.125 <span style="font-size: small;">△</span>	1911260-1	1633703-7	6-683454-4	6-1673600-7	.110 (O)	.074 (F)

<small>THIS DRAWING IS UNPUBLISHED. RELEASED FOR PUBLICATION BY TYCO ELECTRONICS CORPORATION. ALL RIGHTS RESERVED.</small>		DWN: M. HERR 25SEP2008 CHK: G. BAILEY 25SEP2008 APVD: N. DEMING 25SEP2008	Tyco Electronics Harrisburg, PA 17105-3608
DIMENSIONS: INCHES(mm)	TOLERANCES UNLESS OTHERWISE SPECIFIED: 0 PLC ± 1 PLC ± 2 PLC ± 3 PLC ± 4 PLC ± ANGLES ±	NAME: SIDE FEED SYSTEM III APPLICATOR PRODUCT SPEC: - APPLICATION SPEC: - SEE TABLE	SIZE: A   CAGE CODE: 00779   DRAWING NO: 1911259 RESTRICTED TO: -
MATERIAL: -	FINISH: -	WEIGHT: -	SCALE: 3:5   SHEET: 2 OF 3   REV: A
CUSTOMER DRAWING			

LOC	DIST	REVISIONS					
A	66	F	LTR	DESCRIPTION	DATE	DWN	APVD
		-		SEE SHEET 1		-	-

## TERMINAL APPLICATION CHART

TERMINAL PART NUMBERS (SOCKET TERMINALS)		TOOLING INSULATION RANGE	APPLICATOR PART NUMBER	ANVIL	INSULATION CRIMPER	WIRE CRIMPER	INSULATION CRIMP WIDTH	WIRE CRIMP WIDTH
DEUTSCH	TYCO ELECTRONICS							
1062-20-0222 1062-20-0244 1062-20-0422 1062-20-0444	286680-3 286680-4 286680-7 286680-8	.050-.075	1911257-1	1633703-4	5-904741-4	6-1673600-7	.062 (O)	.074 (F)
1062-20-0122 1062-20-0144 1062-20-0222 1062-20-0244 1062-20-0322 1062-20-0344 1062-20-0422 1062-20-0444	286680-1 286680-2 286680-3 286680-4 286680-5 286680-6 286680-7 286680-8	.063-.094	1911258-1	1633703-5	5-904741-3	6-1673600-7	.080 (O)	.074 (F)
1062-20-0122 1062-20-0144 1062-20-0322 1062-20-0344	286680-1 286680-2 286680-5 286680-6	.075-.105	1911259-1	1633703-6	5-904741-8	6-1673600-7	.090 (O)	.074 (F)
1062-20-0122 1062-20-0144 1062-20-0322 1062-20-0344	286680-1 286680-2 286680-5 286680-6	.085-.111	1911253-1	1633703-3	5-456135-0	6-1673600-7	.100 (O)	.074 (F)
1062-20-0122 1062-20-0144 1062-20-0322 1062-20-0344	286680-1 286680-2 286680-5 286680-6	.105-.125 	1911260-1	1633703-7	6-683454-4	6-1673600-7	.110 (O)	.074 (F)

<small>THIS DRAWING IS UNPUBLISHED. RELEASED FOR PUBLICATION BY TYCO ELECTRONICS CORPORATION. ALL RIGHTS RESERVED.</small> <small>THIS DRAWING IS UNPUBLISHED. RELEASED FOR PUBLICATION BY TYCO ELECTRONICS CORPORATION. ALL RIGHTS RESERVED.</small>		DWN: M. HERR 25SEP2008 CHK: G. BAILEY 25SEP2008 APVD: N. DEMING 25SEP2008	Tyco Electronics Harrisburg, PA 17105-3608
DIMENSIONS: INCHES(mm)	TOLERANCES UNLESS OTHERWISE SPECIFIED: 0 PLC ± 1 PLC ± 2 PLC ± 3 PLC ± 4 PLC ± ANGLES ±	NAME: SIDE FEED SYSTEM III APPLICATOR PRODUCT SPEC: - APPLICATION SPEC: - SEE TABLE	SIZE: A   00779   C=1911259 SCALE: 3:5 SHEET 3 OF 3 REV A
MATERIAL: -	FINISH: -	WEIGHT: -	CUSTOMER DRAWING