

2 BAY EDGE LINE

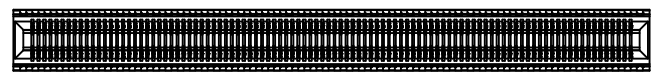

1 BAY EDGE LINE

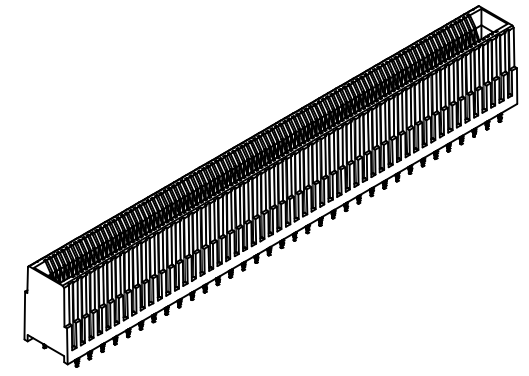
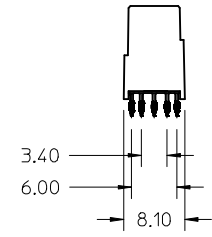
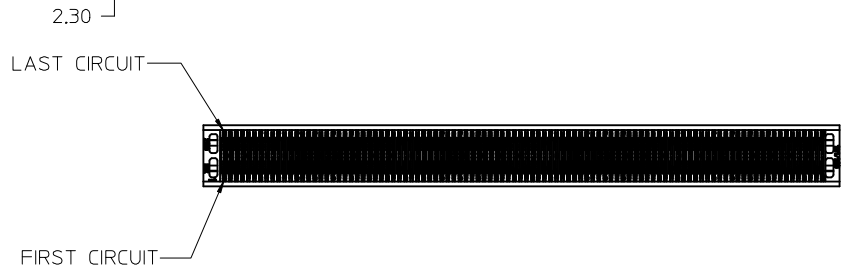
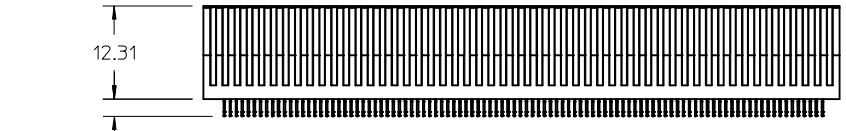

PART NUMBER	VERSION	BAY 1/BAY 2	TOTAL CIRCUITS	DIM A	SALES DRAWING (SEE NOTE 9)
76693-2294	2 BAY	122/172	294	125.03	RSD-76693-110
76693-2274*	2 BAY	122/172	294	125.03	RSD-76693-107
76693-2278	2 BAY	146/132	278	118.63	RSD-76693-2278
76693-1200	1 BAY	200	200	84.20	RSD-76693-1200
76693-1170	1 BAY	170	170	72.20	RSD-76693-1170
76693-3170	1 BAY	170	170	72.20	RSD-76693-3170

- NOTES:
- MATERIAL:
HOUSING - GLASS FILLED THERMOPLASTIC, 94-V0, BLACK
TERMINALS - COPPER ALLOY
 - FINISH:
CONTACT AREA: HARD GOLD - 0.76μm MIN OVER 3.80μm NICKEL
COMPLIANT AREA: TIN - 0.76/1.52μm OVER NICKEL
 - REFER TO PS-75594-999 PRODUCT SPECIFICATION FOR ALL ELECTRICAL, MECHANICAL AND ENVIRONMENTAL SPECIFICATIONS.
 - REFER TO PK-76693-900 FOR ALL PACKAGING SPECIFICATIONS.
 - PROCESSING: PRESSFIT TO PC BOARD.
 - MATING PC BOARD THICKNESS = 2.36±0.16MM OVER CONTACT PADS.
 - THIS PART CONFORMS TO CLASS B REQUIREMENTS OF COSMETIC SPEC PS-45499-002
 - FOR EDGE CARD AND MOUNTING PCB LAYOUT DETAIL SEE CORRESPONDING SALES DRAWING.

INITIAL RELEASE EC NO: UCP2015-1097 DRWR:RWHIPPLE 2014/09/17 CHKD:MPOFF 2014/09/17 APPR:SMILLER 2014/09/29	DESCRIPTION REV A	QUALITY SYMBOLS	GENERAL TOLERANCES (UNLESS SPECIFIED)	DIMENSION STYLE MM ONLY	SCALE 2:1	DESIGN UNITS METRIC	THIRD ANGLE PROJECTION
		▽=0	mm INCH	DRAWN BY DATE RWHIPPLE 2014/09/17	EDGE LINE 12.5GB 0.093*PCB 0.8MM PITCH		SHEET NO. 1 OF 1
		▽=0	4 PLACES ± --- ± ---	CHECKED BY DATE MPOFF 2014/09/17			
		▽=0	3 PLACES ± --- ± ---	APPROVED BY DATE SMILLER 2014/09/29			
	2 PLACES ± 0.13 ± ---	MATERIAL NO.					
		1 PLACE ± 0.25 ± ---	DRAFT WHERE APPLICABLE MUST REMAIN WITHIN DIMENSIONS	SEE TABLE	DOCUMENT NO.	RSD-76693-100	
		0 PLACE ± --- ± ---		SIZE C	THIS DRAWING CONTAINS INFORMATION THAT IS PROPRIETARY TO MOLEX INCORPORATED AND SHOULD NOT BE USED WITHOUT WRITTEN PERMISSION		

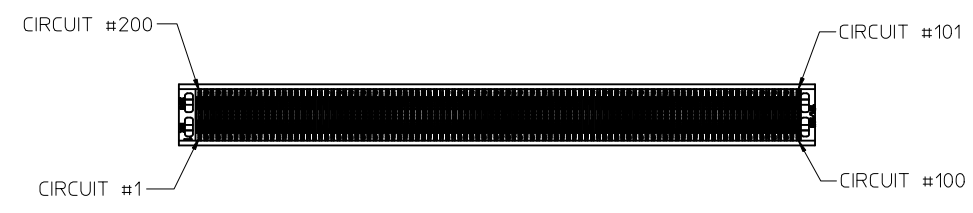
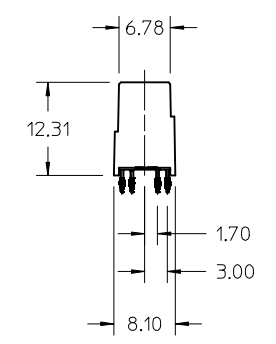
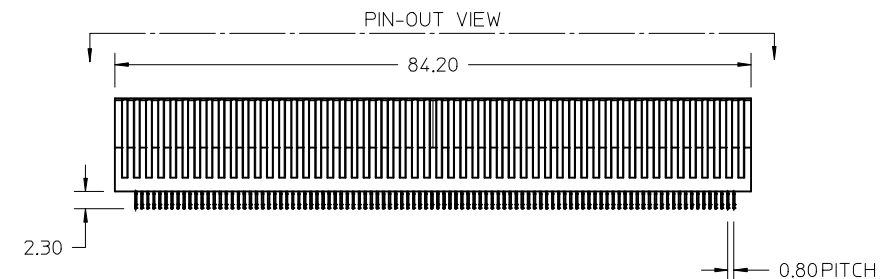
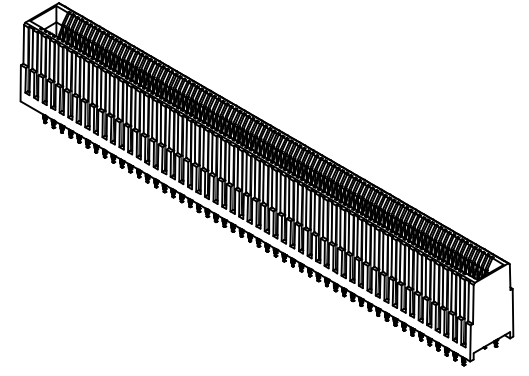
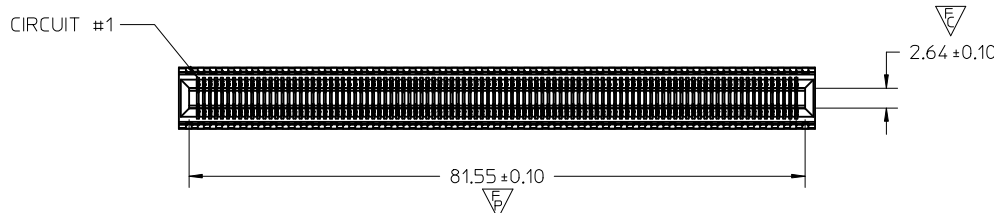

- NOTES:
- MATERIAL:
HOUSING - GLASS FILLED THERMOPLASTIC, 94-V0, BLACK
TERMINALS - COPPER ALLOY
 - FINISH:
CONTACT AREA: HARD GOLD -0.76µm MIN OVER 3.80µ NICKEL
COMPLIANT AREA: TIN - 0.76/1.52µm OVER NICKEL
 - REFER TO PS-75594-999 PRODUCT SPECIFICATION FOR ALL ELECTRICAL, MECHANICAL AND ENVIROMENTAL SPECIFICATIONS.
 - REFER TO PK-76693-900 FOR ALL PACKAGING SPECIFICATIONS.
 - PROCESSING: PRESSFIT TO PC BOARD.
 - MATING PC BOARD THICKNESS = 2.36±0.16MM OVER CONTACT PADS.
 - THIS PART CONFORMS TO CLASS B REQUIREMENTS OF COSMETIC SPEC PS-45499-002

INITIAL RELEASE EC NO: UCP2015-1097 DRWN:RWHIPPLE 2014/09/18 CHKD:MPOFF 2014/09/18 APPR:SMILLER 2014/09/29	DESCRIPTION REV	QUALITY SYMBOLS	GENERAL TOLERANCES (UNLESS SPECIFIED)	DIMENSION STYLE	SCALE	DESIGN UNITS	THIRD ANGLE PROJECTION
		$\nabla = 0$ $\nabla = 1$ $\nabla = 1$	mm INCH 4 PLACES ± --- ± --- 3 PLACES ± --- ± --- 2 PLACES ± 0.15 ± --- 1 PLACE ± 0.25 ± --- 0 PLACE ± ±	MM ONLY	2:1	METRIC	TITLE EDGELINE 12.5GB 200CKTS 0.093" PCB 0.8MM PITCH
		DRAWN BY DATE RWHIPPLE 2014/09/18 CHECKED BY DATE MPOFF 2014/09/18 APPROVED BY DATE SMILLER 2014/09/29	ANGULAR ± 2 ° DRAFT WHERE APPLICABLE MUST REMAIN WITHIN DIMENSIONS	MATERIAL NO. 766931200	DOCUMENT NO. RSD-76693-1200	SHEET NO. 1 OF 4	
		SIZE C	THIS DRAWING CONTAINS INFORMATION THAT IS PROPRIETARY TO MOLEX INCORPORATED AND SHOULD NOT BE USED WITHOUT WRITTEN PERMISSION				

EDGE LINE CONNECTOR BOARD MOUNTING

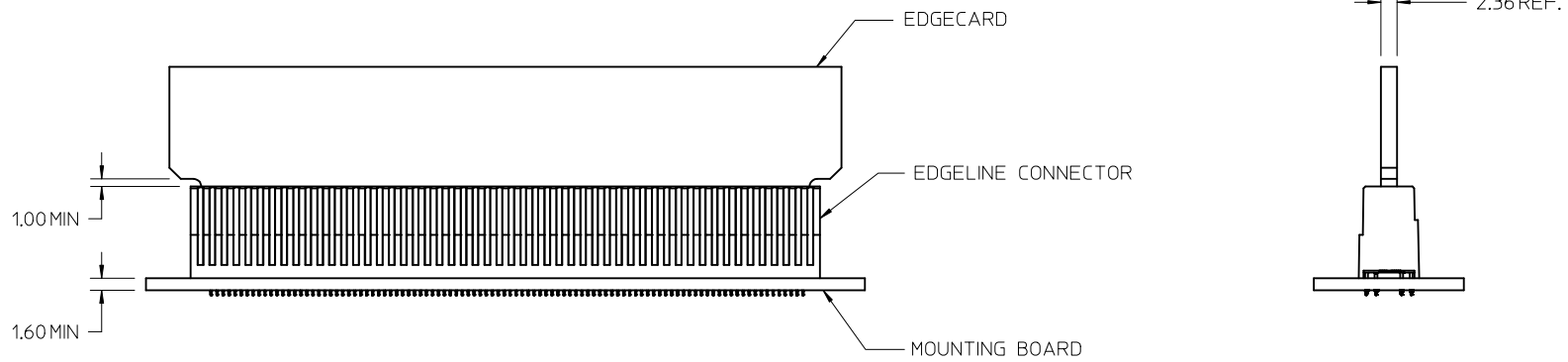

SEE SHEET 1 EC NO: UCP2015-1097 DRAWN BY: RWHIPPLE 2014/09/18 CHECKED BY: MPOFF 2014/09/18 APPR: SMILLER 2014/09/29	QUALITY SYMBOLS 	GENERAL TOLERANCES (UNLESS SPECIFIED)		DIMENSION STYLE MM ONLY	SCALE 2:1	DESIGN UNITS METRIC	THIRD ANGLE PROJECTION
		4 PLACES ± --- ± ---	DRAWN BY RWHIPPLE	DATE 2014/09/18	TITLE EDGE LINE 12.5GB 200CKTS 0.093" PCB 0.8MM PITCH		
		3 PLACES ± --- ± ---	CHECKED BY MPOFF	DATE 2014/09/18			
		2 PLACES ± 0.15 ± ---	APPROVED BY SMILLER	DATE 2014/09/29	MATERIAL NO. SEE SHEET 1	DOCUMENT NO. RSD-76693-1200	SHEET NO. 2 OF 4
1 PLACE ± 0.25 ± ---	ANGULAR ± 2 °		DRAFT WHERE APPLICABLE MUST REMAIN WITHIN DIMENSIONS			THIS DRAWING CONTAINS INFORMATION THAT IS PROPRIETARY TO MOLEX INCORPORATED AND SHOULD NOT BE USED WITHOUT WRITTEN PERMISSION	
0 PLACE ± ±	SEE SHEET 1		SIZE C				

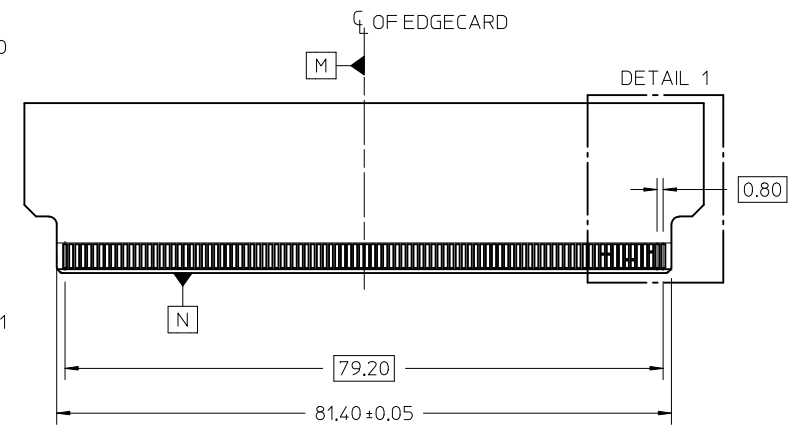
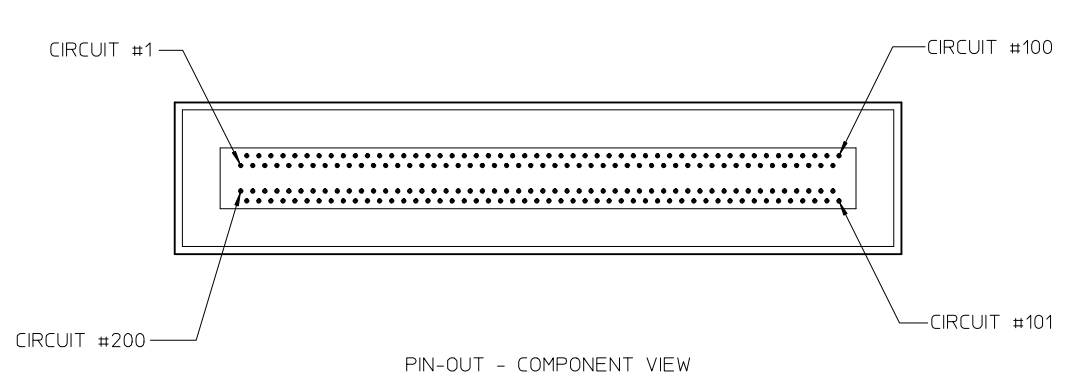
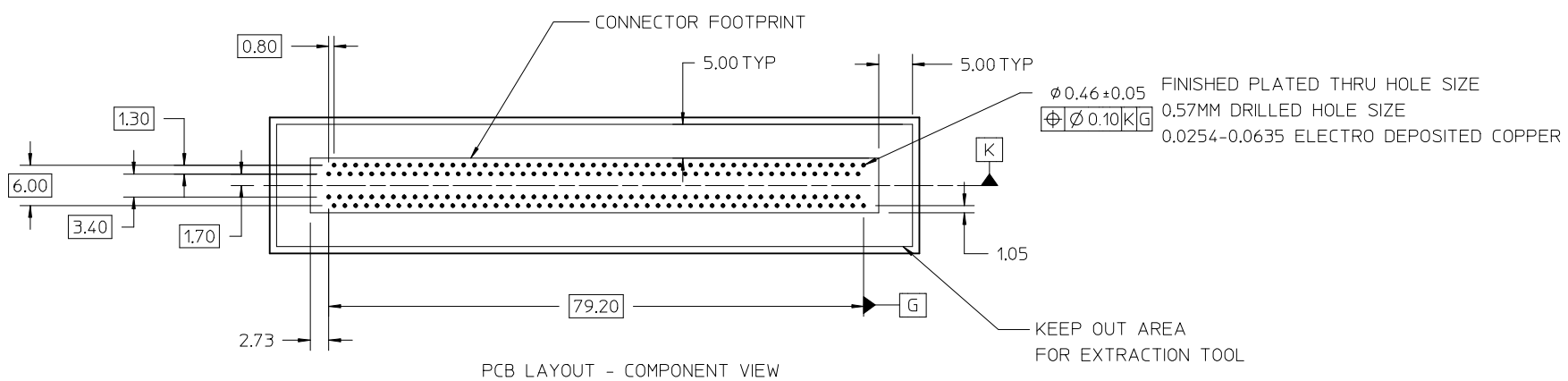

SEE SHEET 1 EC NO: UCP2015-1097 DRW:RWHIPPLE 2014/09/18 CHKD:MPOFF 2014/09/18 APPR:SMILLER 2014/09/29	QUALITY SYMBOLS $\nabla = 0$ $\nabla = 0$ $\nabla = 0$	GENERAL TOLERANCES (UNLESS SPECIFIED) <table border="1"> <tr> <th></th> <th>mm</th> <th>INCH</th> </tr> <tr> <td>4 PLACES</td> <td>± 0.15</td> <td>± 0.006</td> </tr> <tr> <td>3 PLACES</td> <td>± 0.25</td> <td>± 0.010</td> </tr> <tr> <td>2 PLACES</td> <td>± 0.38</td> <td>± 0.015</td> </tr> <tr> <td>1 PLACE</td> <td>± 0.51</td> <td>± 0.020</td> </tr> <tr> <td>0 PLACE</td> <td>± 0.64</td> <td>± 0.025</td> </tr> </table>		mm	INCH	4 PLACES	± 0.15	± 0.006	3 PLACES	± 0.25	± 0.010	2 PLACES	± 0.38	± 0.015	1 PLACE	± 0.51	± 0.020	0 PLACE	± 0.64	± 0.025	DIMENSION STYLE MM ONLY DRAWN BY: RWHIPPLE DATE: 2014/09/18 CHECKED BY: MPOFF DATE: 2014/09/18 APPROVED BY: SMILLER DATE: 2014/09/29	SCALE: 2:1 DESIGN UNITS: METRIC THIRD ANGLE PROJECTION	TITLE: EDGELINE 12.5GB 200CKTS 0.093" PCB 0.8MM PITCH
		mm	INCH																				
	4 PLACES	± 0.15	± 0.006																				
	3 PLACES	± 0.25	± 0.010																				
2 PLACES	± 0.38	± 0.015																					
1 PLACE	± 0.51	± 0.020																					
0 PLACE	± 0.64	± 0.025																					
MATERIAL NO. SEE SHEET 1	DOCUMENT NO. RSD-76693-1200	SHEET NO. 3 OF 4																					
DRAFT WHERE APPLICABLE MUST REMAIN WITHIN DIMENSIONS	SIZE: C	THIS DRAWING CONTAINS INFORMATION THAT IS PROPRIETARY TO MOLEX INCORPORATED AND SHOULD NOT BE USED WITHOUT WRITTEN PERMISSION																					
molex																							

