

# HPC-7242

## 2U Rackmount Chassis for ATX Motherboard with 4 Hot-Swap SAS/SATA HDD Trays and RPS



### Features

- Supports ATX motherboard with dual processors
- Four shock-resistant hot-swap disk trays supporting 3.5" or 2.5" SAS/SATA drives for RAID 5/10 application, one slim ODD, and two 2.5" internal drives
- Dual front USB 3.0 ports
- Supports 80plus single or redundant power supply up to 700W
- Front-accessible system fan without opening top cover for easy maintenance
- LED indicators and audible alarm notification for system fault detection
- Built-in Intelligent System Module enabling whole system fan control and remote manageability

### Quiet Specifications

CE FCC

		External	Internal
Drive Bay	Slim Optical Drive	1	-
	2.5"	-	2
	Hot Swap	4 SASII / SATAIII HDDs	
Cooling	Fan	1 (8 cm/47CFM) + 2 (6 cm/28CFM) for SAS/SATA storage unit	
	Air Filter	Yes	
Front I/O Interface	USB 3.0*	2	
Miscellaneous	LED Indicators	Power, HDD, temperature, fan, LAN1, and LAN2	
	Rear Panel	Two 9-pin D-Sub	
Intelligent System Module Remote Monitoring	CPU/System fan speed, CPU/System temperature, motherboard voltage (Only selected Advantech MBs/CPU cards with SUSIAccess installed can fully enabled these functions, check with Advantech local rep. for detailed information.)		
Environment	Temperature	Operating 0 ~ 40 °C (32 ~ 104 °F)	Non-Operating -40 ~ 70 °C (-40 ~ 156 °F)
	Humidity	10 ~ 95% @ 40 °C, non-condensing	
	Vibration (5 ~ 500 Hz)	1 Grms	2 G
	Shock	10 G (with 11 ms duration, half sine wave)	
Physical Characteristics	Dimensions (W x H x D)	426.4 x 88 x 525 mm (16.79" x 3.46" x 20.67")	
	Weight	13.7 kg (30.12 lb)	

\* The USB ports do not operate if a main board without on-board USB 3.0 internal box header is installed.

### Front View

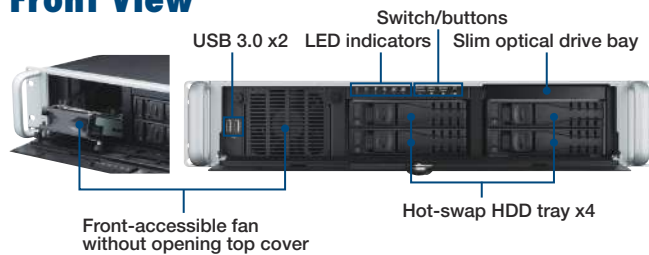

### Rear View

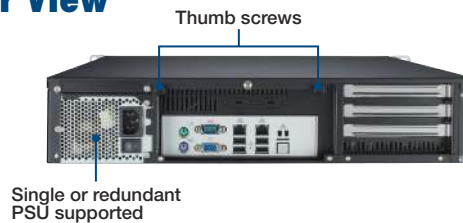

### Top view

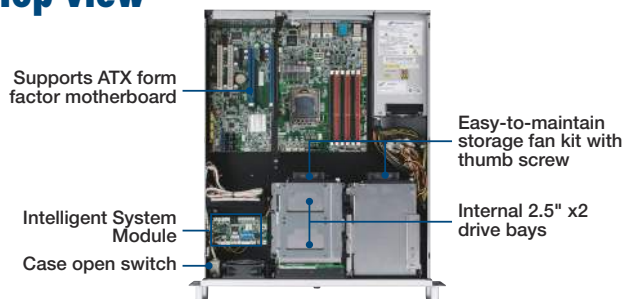

Rear I/O bracket for low profile add-on cards

\*Note: Motherboard and power supply are not included.

**Dimensions**

Unit: mm [inch]

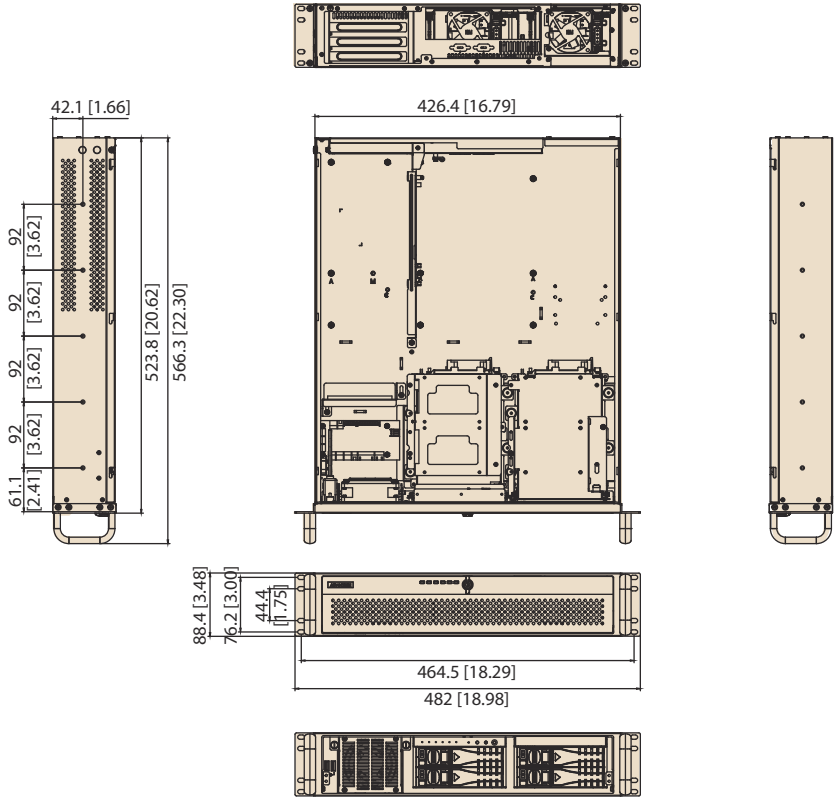

**Ordering Information**

Part Number	Description
HPC-7242MB-00XE	Without PSU, with ATX switch

**Packing List**

Part Number	Description
9662132020E	Black mobile HDD tray
1990021407T000	Door filter

**Power Supply Options**

Part Number	80 Plus Grade	Wattage	Type	Input
PS8-350FATX-XE	Bronze	350W	Single	AC 100 ~ 240 V (full range)
PS8-500U2-XE	Bronze	500W	Single	AC 100 ~ 240 V (full range)
RPS8-500U2-XE	Bronze	500W	(1+1) Redundant	AC 100 ~ 240 V (full range)
RPS8-700U2-XE	Bronze	700W	(1+1) Redundant	AC 100 ~ 240 V (full range)

**Optional Accessories**

Part Number	Description
96CB-SATAPOWER-6P2	SATA power wire 6-pin to big 4-pin (for slim ODD)
96CB-SAS-SATA-4P1	Mini SAS to 4-port SATA Cable
9680006905	26" Slide Rail
<b>Rear I/O panel kit for low-profile add-on cards</b>	
1939000361	Screws (should purchase 7 pcs)
1960034816N000	I/O bracket (should purchase 7 pcs)
1960019475T201	Rear panel for low-profile