

LOADING PATTERN MATING SIDE

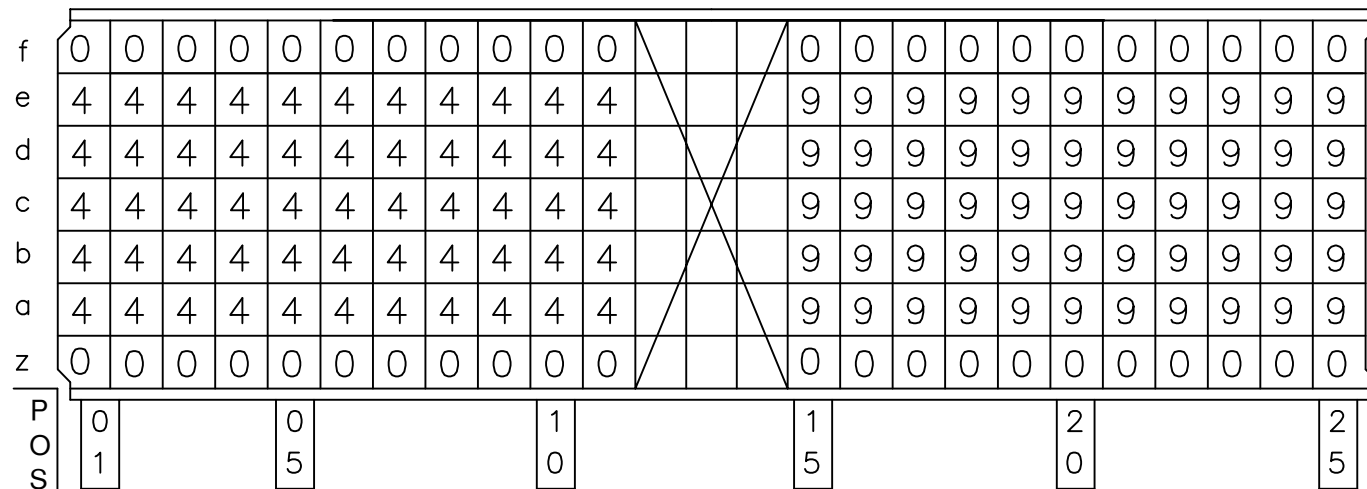

LOADED CONNECTOR ASSEMBLY (FOR EXAMPLE)

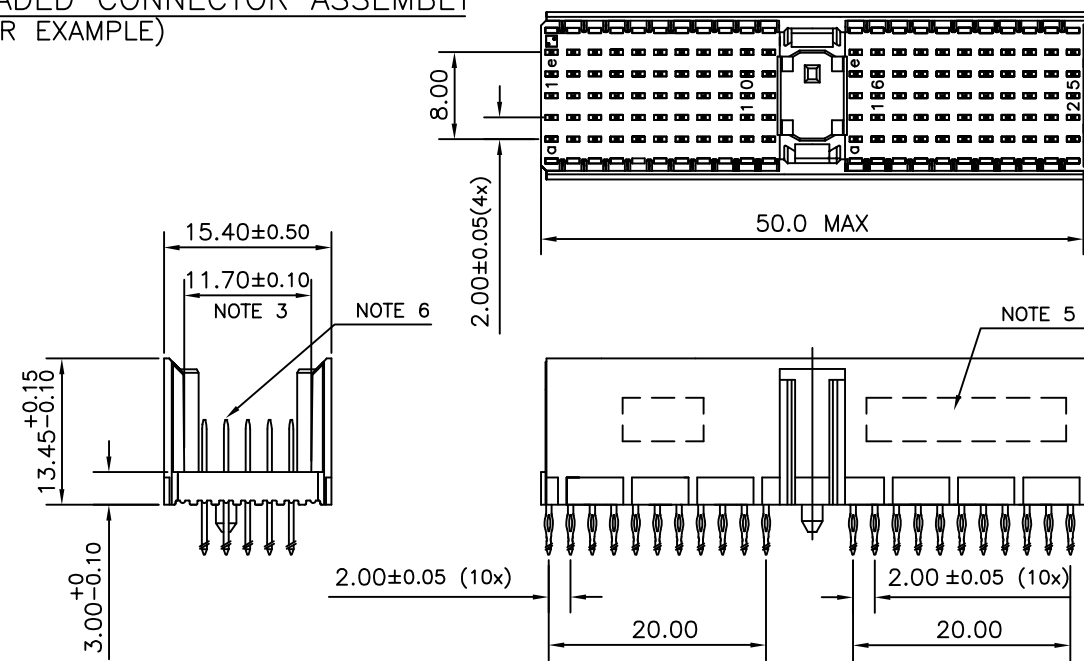

CONTACT OVERVIEW

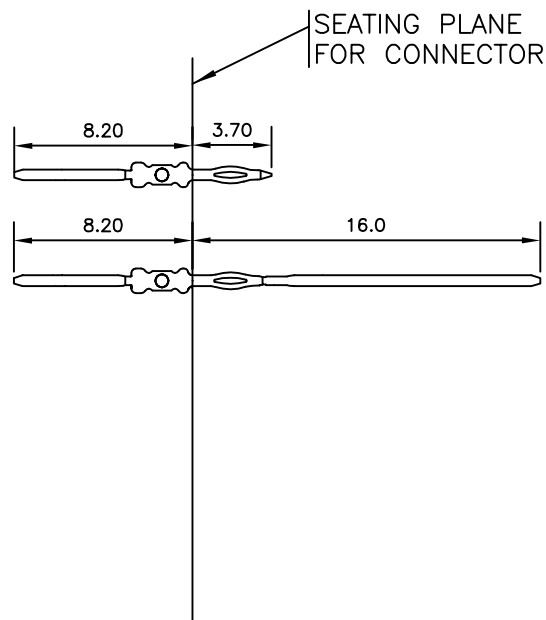

LAY-OUT P.C.B.-HOLE

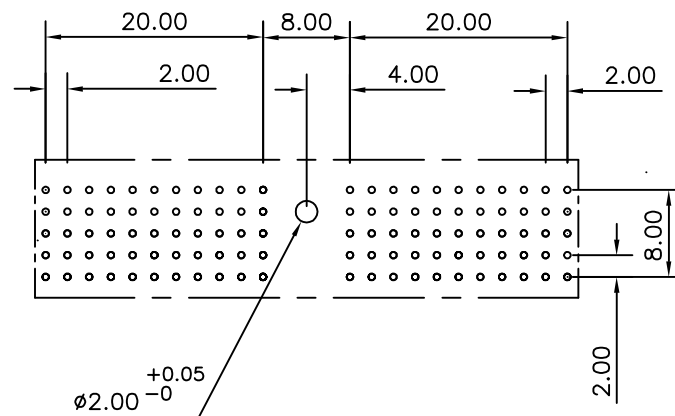

LEAD FREE INDICATOR : LF = LEAD FREE (DIGIT 15 & 16)

HM2P07PNM130

PLATING CODE (DIGIT 13 AND 14) (REF DRW NO. BS,C , 201844 , 003)

NOTES

1. THIS PRODUCT IS CSA APPROVED.
2. THIS PRODUCT IS UL RECOGNIZED.
3. MEASURED AT THE BOTTOM.
4. MATERIAL CONTACT: PHOSPHORBRONZE
HOUSING: CREAM WHITE GLASS FILLED POLYESTER UL-94V0
5. CONNECTOR PRINTED WITH P/N AND DATE CODE.
6. FOR ACTUAL CONTACT LOADINGS, SEE LOADING PATTERN MATING SIDE.
7. SHAPE OF CONNECTOR HOUSING CAN ALTER DEPENDING ON PRODUCTION LOCATION
8. THE PRODUCT (LF) MEETS EUROPEAN UNION DIRECTIVES AND OTHER COUNTRY REGULATIONS AS DESCRIBED IN GS-22-008
9. FOR RECOMMENDED PTH DIMENSIONS REFER DRAWING : BS, A , 201572 , 001

CATALOG NO: HM2P07PNM130- ---

mat'l. code SEE NOTE 4				surface ISO 1302 <input checked="" type="checkbox"/> ISO 406 <input type="checkbox"/> ISO 1101		tolerance tolerances unless otherwise specified		projection MM		product family MILLIPACS		
A	103-0008	JAY	21/05/2003	angles linear	0°±1°	.0±0.2		MM	title MPACS 5+2R STR HDR PF CONN TYPE A			
B	105-0171	MINI	23/09/2005			.00±0.1			dwg no sheet 1 of 1 size 5			
C	106-0077	MINI	17/06/2006						BS, C, 203028, 006 A3			
sheet index			revision sheet	c		dr JAYADEEP P 21/05/2003		FCI	type Product Customer Drawing			
					enr BIJU K PAUL 21/05/2003							
					chr BIJU K PAUL 17/062006							
					appd K V SIVADAS 17/062006							