

FRONT VIEW

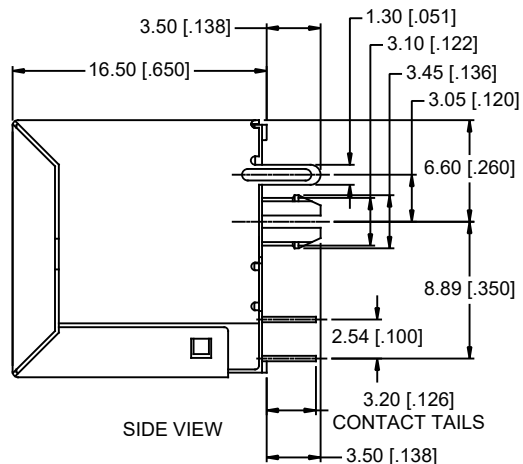

SIDE VIEW

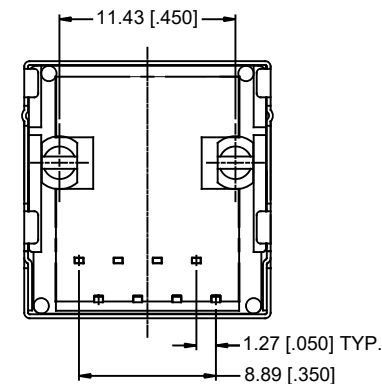

BACK VIEW

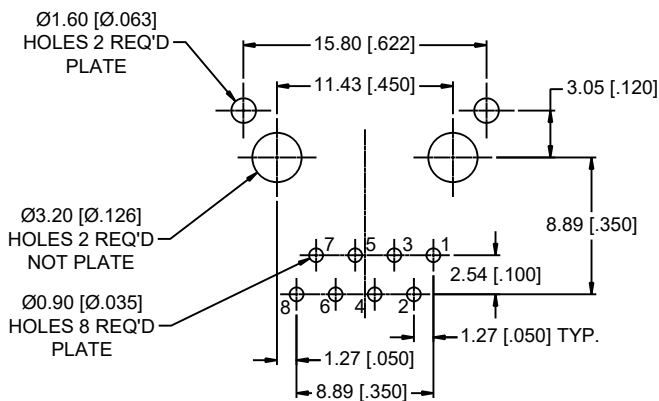

RECOMMENDED P.C.B LAYOUT
(TOLERANCE: $\pm 0.05[\pm 0.002]$)
(PCB THICKNESS: 1.60 [0.063])
(COMPONENT SIDE OF PC BOARD)



NOTES:

- MATERIALS:**
CONTACTS: PHOSPHOR BRONZE, 0.35MM THICKNESS,
PLATING: 6μ [0.152 MICRONS] MIN. GOLD PLATING
 30μ [0.762 MICRONS] MIN. NICKEL OVERALL.
HOUSING: ENGINEERING THERMOPLASTIC, FLAMMABILITY RATING UL 94V-0
COLOR - BLACK.
SHIELD: BRASS WITH NICKEL PLATING
 - MECHANICAL:**
MATING FORCE: 5.0 LBS MAXIMUM
 - ELECTRICAL:**
CONTACT RESISTANCE: 20 MILLIOHMS MAXIMUM
INSULATION RESISTANCE: 500 MEGOHMS MINIMUM
CURRENT RATING: 1.5 AMPS
VOLTAGE RATING: 125 VOLTS AC
 - ENVIRONMENTAL:**
STORAGE TEMPERATURE: -40°C TO $+85^{\circ}\text{C}$
 - RECOMMENDED SOLDERING TEMPERATURE:**
WAVE SOLDERING PEAKED AT 235°C FOR 5 SECONDS.
- AMPHENOL PART NUMBER: RJE74-188-6110

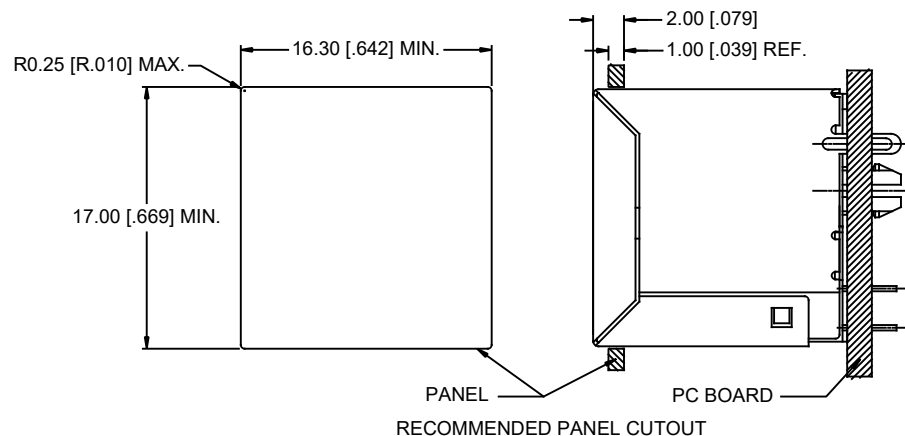

RECOMMENDED PANEL CUTOUT

THIS DOCUMENT CONTAINS PROPRIETARY INFORMATION AND SUCH INFORMATION MAY NOT BE DISCLOSED TO OTHERS FOR ANY PURPOSE OR USED FOR MANUFACTURING PURPOSES WITHOUT WRITTEN PERMISSION FROM AMPHENOL CANADA CORP.

REVISIONS			
REV	DESCRIPTION, ECN, EAR NO.	DATE	APP'D
A	NEW PROPOSAL	JUL19/22	KELVIN

UNLESS SPECIFIED OTHERWISE	DRAWN	RONNIE.C	JUL19/22
PRIMARY UNITS MILLIMETERS	CHECKED	KELVIN.T	JUL19/22
SECONDARY INCHES	M.E. APP'D		
REFERENCE IN PARENTHESES	Q.A. APP'D		
GENERAL TOLERANCES	DWG APP'D		
1 DECIMAL PLACE ± 0.35	ENG. REL. NO.		
2 DECIMAL PLACES ± 0.25	REF.		
3 DECIMAL PLACES ± 0.15	THIRD ANGLE PROJECTION		
ANGULAR DEGREES $\pm 2.0^{\circ}$	DO NOT SCALE DRAWING		

Amphenol Canada Corp. Commercial Products	
SINGLE PORT, VERTICAL MODULAR JACK, 8 POSITION, 8 CONTACTS, SHIELDED -RoHS COMPLIANT	
DWG NO.	P-RJE74-188-6110
REV	A
CODE ID NO. 03554	DWG SIZE X SCALE N/A SHEET 1 OF 1