

Extrusion

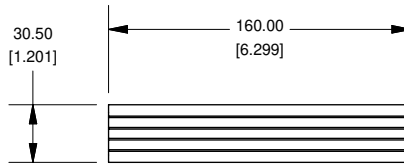

EXTRUSION DESIGNED FOR 120MM WIDE PC BOARD

Slot Details

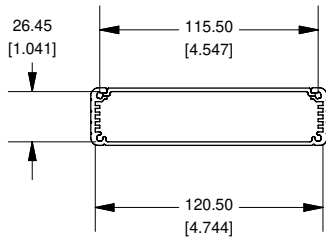
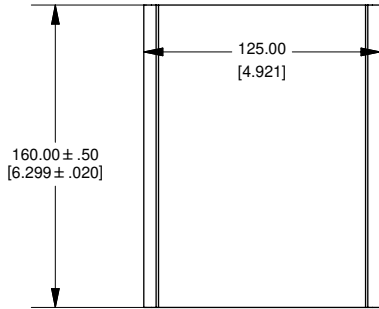
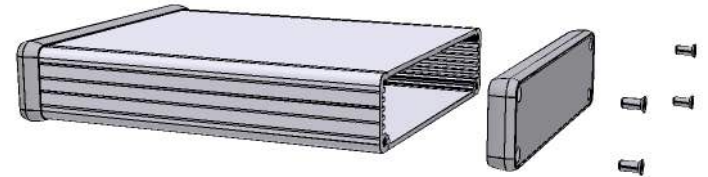
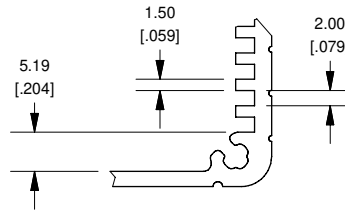

Closed Bezel

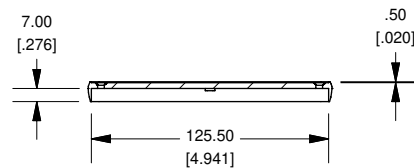
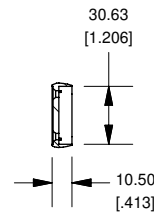
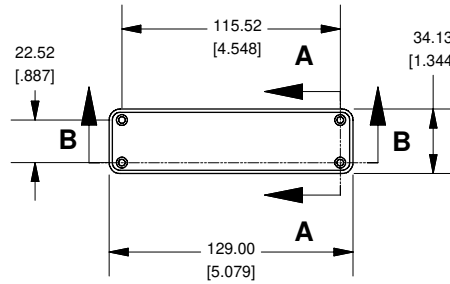

Enclosures can be Factory Modified (Milling, Drilling, Printing etc.)
 Solid models of this enclosure available in STEP or IGES.
 Contact Factory mjm@hammondmfg.com

| NOTE | |
|--|--|
| Purchased assembly includes box, plastic bezels, #6 Taptight screws and self adhesive rubber feet. | |
| Box made from Extruded Aluminum 6063. | |
| Bezels made with ABS. | |

| 1455P1602 | |
|------------------------------|-------------|
| PART NUMBERS | |
| Clear Anodized | 1455P1602 |
| Black Anodized | 1455P1602BK |
| ACCESSORIES | |
| See website for accessories. | |



HAMMOND
MANUFACTURING™

1455P1602

www.hammondmfg.com