

\*\* Not all features are shown in this drawing. For more detailed information, please contact your Fair-Rite representative.

SIZE	PART NO.	REV.
B	9379054002	~

UNCONTROLLED ~CATALOG~ DRAWING

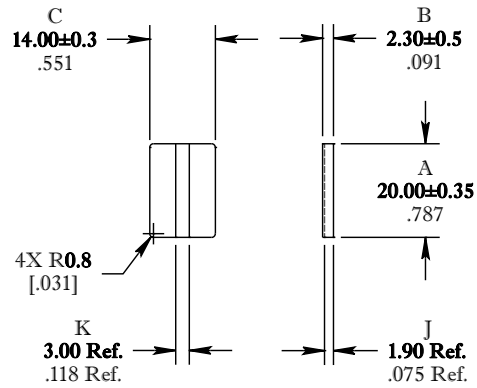

ELECTRICAL SPECIFICATIONS						
$\Sigma l/A(\text{mm}^{-1})$	$l_e$ (mm)	$A_e$ (mm <sup>2</sup> )	$A_{\text{Min}}$ (mm <sup>2</sup> )	$V_e$ (mm <sup>3</sup> )	$A_L$ (nH) @ 10 kHz <10gauss	$\tan \delta/\mu_i$ @ 500 kHz <1gauss
0.412	25.2	61.2	55.0	1540	3300±25%	≤15X10E-6
MATE WITH FR# 9579200602: CLAMPING FORCE = 5 lbs.						

POWER LOSS @ 100°C

f = 500 kHz, 500g P.L. < 0.20 Watts

DIMENSIONS  
**BOLD NUMBERS ARE IN MILLIMETERS**  
 LIGHT NUMBERS ARE IN INCHES

FR# 79

<b>FAIR-RITE PRODUCTS CORP.</b>						
TITLE "I" CORE						
DRAWN BY D. FOOTE	DATE 3/21/2019	SIZE	PART NO.	REV.		
CHKD BY		B	9379054002	~		
APPRVD BY		SCALE	NONE	SHEET	1 of 1	