

APPROVED: _____
 DATE: _____ TITLE: _____

Rev	AWO #	Description	Date	Appr
-		RELEASED	4/7/05	
A		ADDED DIM.	4/25/13	

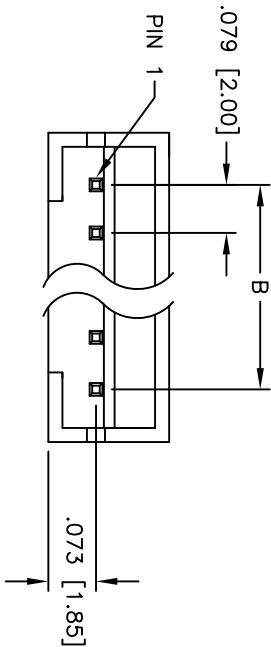

PCB LAYOUT

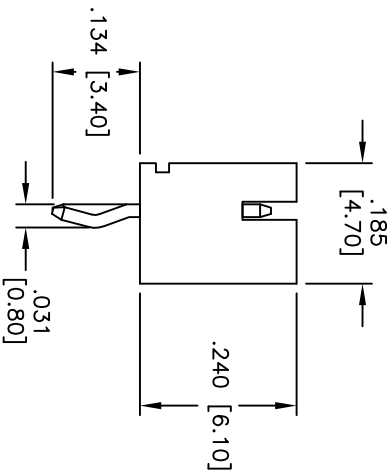
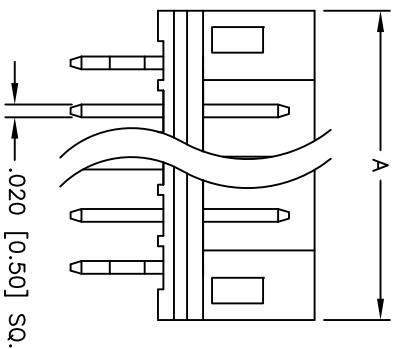
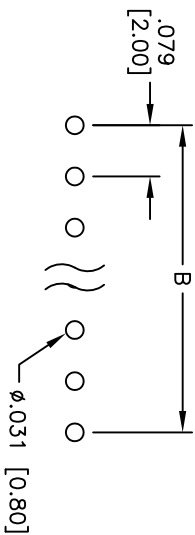

SPECIFICATIONS:

Material: Insulator: Nylon 66, rated UL 94V-0
 Insulator color: White
 Contacts: Brass

Plating: Tin over Copper underplate overall

Electrical: Operating voltage: 100 VAC max

Current rating: 2 Amps max

Contact resistance: 10 mohms max

Insulation resistance: 1,000 Mohms min @ 500 VDC

Dielectric withstanding voltage: 1,000 VAC for 1 minute

Temperature Rating:

Operating temperature: -25°C to +85°C

Environmental:

Lead free, RoHS compliant

Positions: 2 thru 15
 A = .079 [2.00] x No. of Positions + .075 [1.90]
 B = .079 [2.00] x No. of Spaces

UNLESS OTHERWISE SPECIFIED
 ALL DIMENSIONS ARE INCHES [MM]
 TOLERANCES: EXCEPT AS NOTED

INCHES	HOLES
.X ± .10	ØX ± .10
.XX ± .020	ØXX ± .015
.XXX ± .015	ØXXX ± .010

APPROVALS: _____ DATE: _____

DRAWN: SS 4/7/05

CHECKED: _____

APPROVED: _____

ADAM TECH

909 Rahway Avenue, Union, NJ 07083
 Phone: 908-687-5000 Fax: 908-687-5710

TITLE: .079 [2.00] SHROUNDED HEADER
 STRAIGHT, PCB

SIZE	PART NO.	SCALE	SHEET 1 OF 1	REV.
X	2SH-C-XX-TS	NIS	1	A

6

5

4

3

2

1