

10 9 8 7 6 5 4 3 2 1

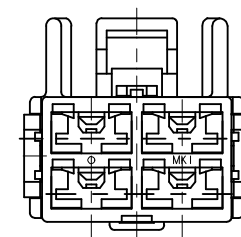
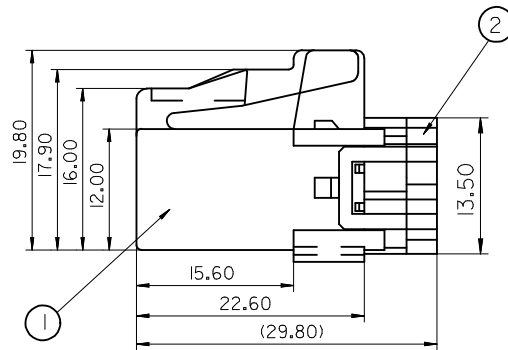
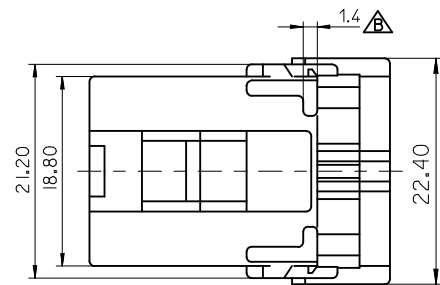
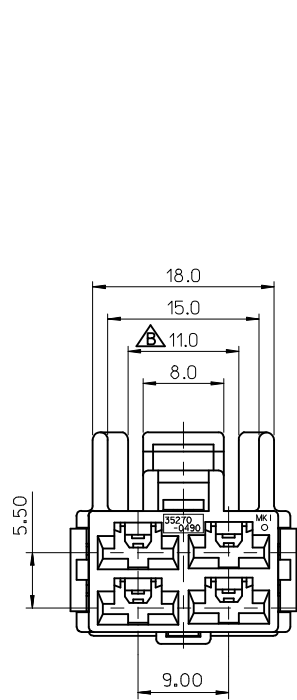

	P/NO.	PART NAME	MATERIAL
①	35270-0490	POWERMATE FEMALE HS'G 4P	PBT
②	35271-0480	POWERMATE FEMALE TPA 4P	PBT

* APPLICABLE TERMINAL : 35427-97**,98**,99**
35430-1700,1800,1900

REVISED EC NO: KTR2015-0006 DRWN:Y.IBAEK 2014/08/22 CHKD: APPR:SRTAK 2014/09/04	DESCRIPTION REV	QUALITY SYMBOLS	GENERAL TOLERANCES (UNLESS SPECIFIED)	DIMENSION STYLE	SCALE	DESIGN UNITS	THIRD ANGLE PROJECTION
		▼=0 □=0	mm INCH 4 PLACES ± --- ± --- 3 PLACES ± --- ± --- 2 PLACES ± 0.20 ± --- 1 PLACE ± 0.20 ± --- ANGULAR ± 3 °	MM ONLY		METRIC	☉ □ THIRD ANGLE PROJECTION
			DRAFT WHERE APPLICABLE MUST REMAIN WITHIN DIMENSIONS	DRAWN BY DATE J.K.OH 1996/11/13 CHECKED BY DATE B.K.CHOI 1996/11/13 APPROVED BY DATE C.W.LEE 1996/11/13	TITLE POWERMATE FEMALE ASSY 4P	MOLEX INCORPORATED	SHEET NO. 1 OF 1
			SEE TABLE	MATERIAL NO. SD-35270-0410	DOCUMENT NO.		

9 8 7 6 5 4 3 2 1