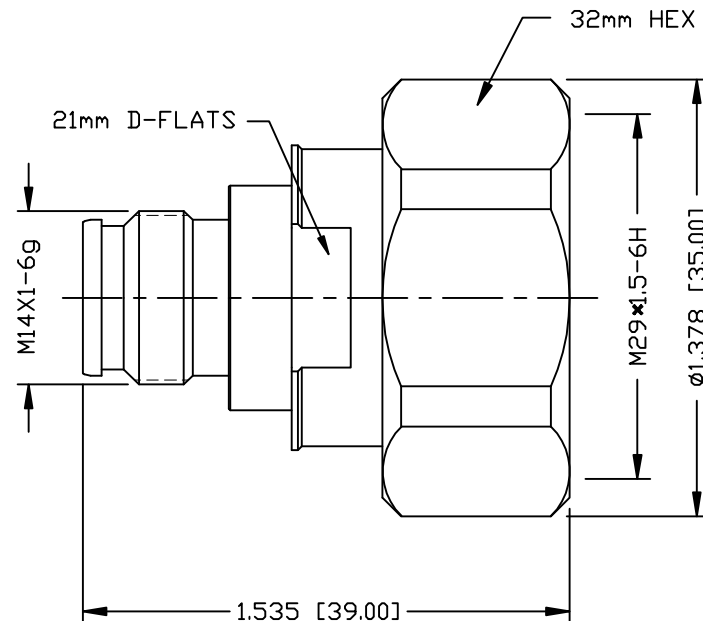

PART NO.

**RFD-225F-716M**

| REV | DESCRIPTION                    | DWN | DATE     | APPROVED |
|-----|--------------------------------|-----|----------|----------|
| -   | ENGINEERING RELEASE            | CZS | 07/17/20 | JDMc     |
| A   | CHANGED GENERAL SPECIFICATIONS | DM  | 10/2/20  | JDMc     |

**SPECIFICATIONS:**

INTERFACE: IEC61169-4/66

IMPEDANCE: 50 Ohms

FREQUENCY RANGE: 0-6 GHz

RETURN LOSS TYPICAL RESULTS:

0-3 GHz 30 dB

3-6 GHz 26 dB

3rd ORDER IM:  $\leq -165$  dBc @ 700 MHz & 1900 MHz

3rd ORDER IM TEST METHOD: 2x43 dBm CARRIERS

INSULATION RESISTANCE: 5000 M $\Omega$ 

TEMPERATURE RANGE: -40°C TO 100°C

DURABILITY: &gt;500 (7/16); &gt;100 (2.2/5) MATING CYCLES

MATING TORQUE: 25 Nm (7/16)

COMPLIANCE/CERTIFICATIONS: RoHS / IP68 MATED

NET WEIGHT: 0.205 lb

NOTE:

CONNECTOR WILL HAVE PROTECTIVE CAPS ON (NOT SHOWN)

| # | DESCRIPTION    | QTY | MATERIAL        | FINISH/COLOR |
|---|----------------|-----|-----------------|--------------|
| 7 | PROTECTIVE CAP | 2   | PE              | WHITE        |
| 6 | GASKET         | 1   | SI RUBBER       | RED          |
| 5 | RETAINING RING | 1   | SST             | PASSIVATED   |
| 4 | GROUND RING    | 1   | PHOSPHOR BRONZE | CuSnZn ALLOY |
| 3 | CONTACT PIN    | 1   | PHOSPHOR BRONZE | SILVER       |
| 2 | INSULATOR      | 1   | PTFE            | ---          |
| 1 | BODY           | 1   | BRASS           | CuSnZn ALLOY |

CUSTOMER  
OUTLINE DRAWINGALL DIMENSIONS  
ARE REFERENCE ONLYUNLESS OTHERWISE SPECIFIED:  
DIMENSIONS ARE IN INCHES  
AND [MILLIMETERS]

|           |               |          |
|-----------|---------------|----------|
| DRAWN     | D. McREYNOLDS | 10/2/20  |
| CHECKED   |               |          |
| ORJ DRAWN | C. ZUÑIGA     | 07/17/20 |

PROPRIETARY AND CONFIDENTIAL

THIS DRAWING CONTAINS  
INFORMATION PROPRIETARY TO  
RF INDUSTRIES. ANY  
UNAUTHORIZED USE OF THIS  
DRAWING IS EXPRESSLY  
PROHIBITED WITHOUT WRITTEN  
PERMISSION FROM RF  
INDUSTRIES. ANY VIOLATION IS  
PUNISHABLE UNDER U.S.  
COPYRIGHT LAWS.

 RFINDUSTRIES.COM  
 7610 MIRAMAR RD.  
 SAN DIEGO, CA 92126  
 (858) 549-6340  
 DIVISION OF RF INDUSTRIES, LTD. (858) 549-6345 FAX

**2.2/5 FEMALE TO  
7/16 DIN MALE ADAPTER**

| CABLE GROUP | DWG #                | REVISION  |              |
|-------------|----------------------|-----------|--------------|
| N/A         | <b>RFD-225F-716M</b> | A         |              |
| FORMAT      | SCALE                | CONTROL # | SHEET 1 OF 1 |
| A           | NTS                  | 000000    |              |