

1

2

3

4

A

B

A

B

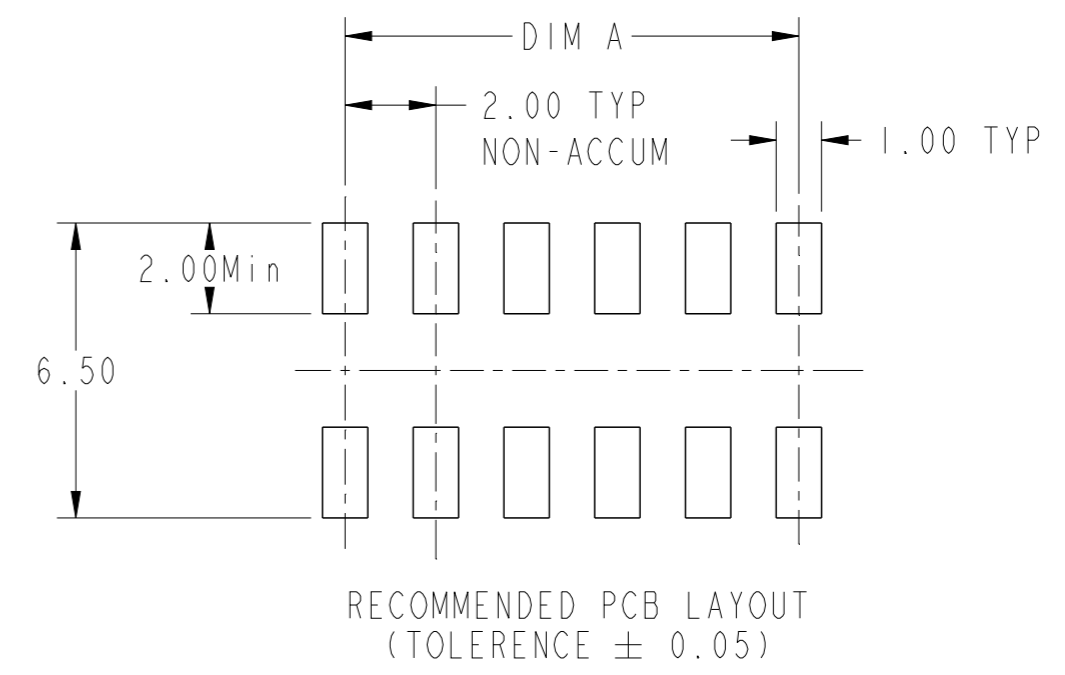
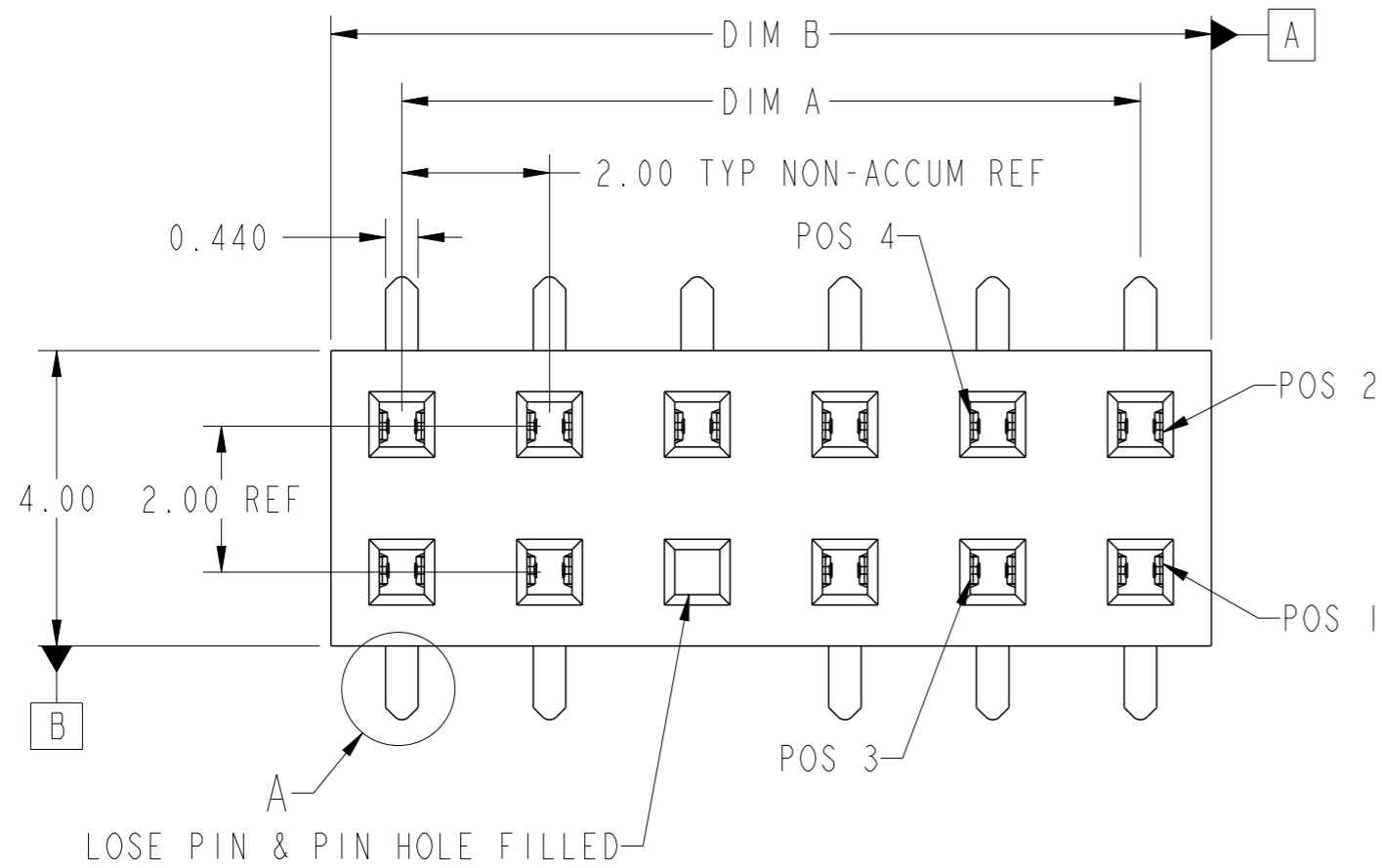

⊕ 0.20 A B

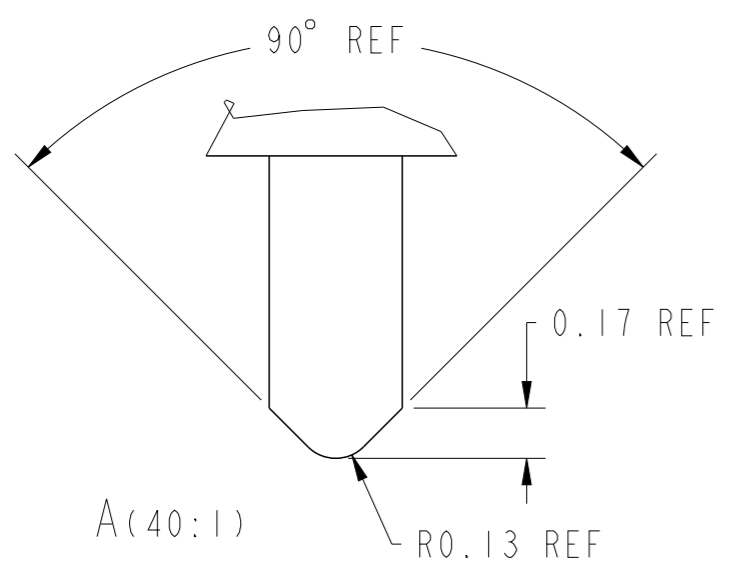
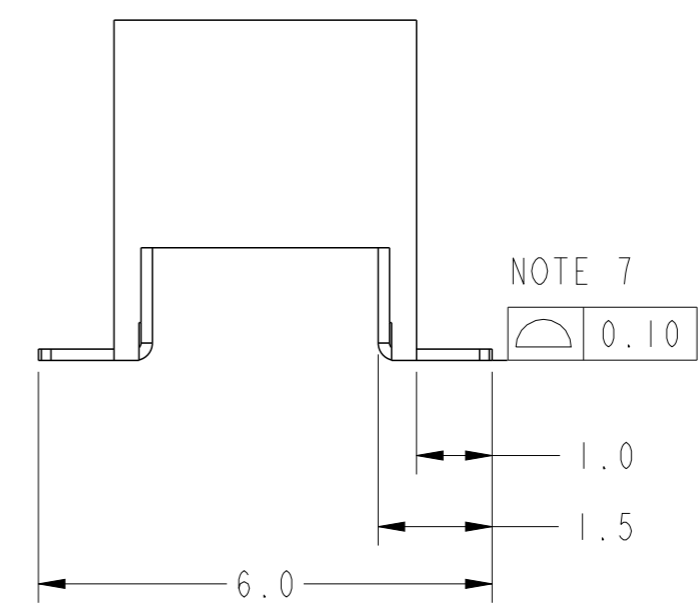
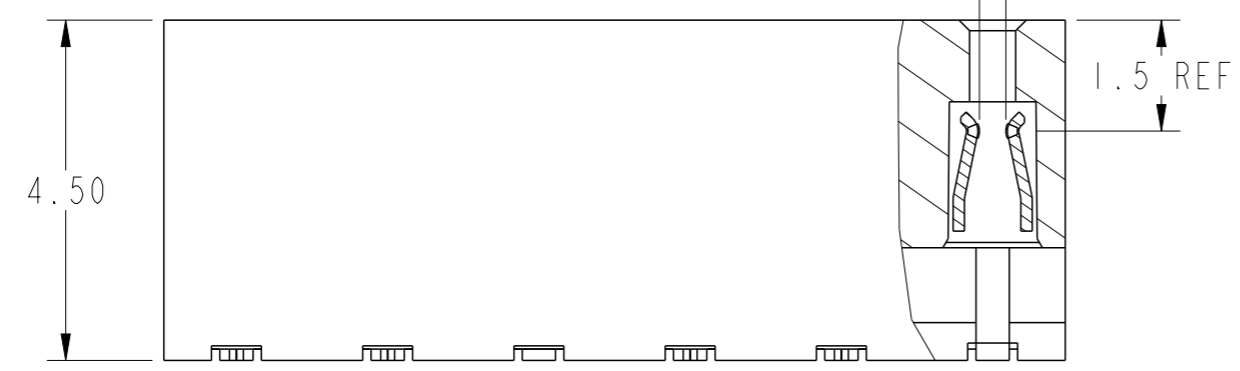

spec ref	dr	Guo-Min Sun	2013/12/19	projection	mm	size	A3	scale	4:1
tolerance std	eng	Laurence Zang	2015/12/17			ecn no	ELX-N-22825-1	rel level	
TOLERANCES UNLESS OTHERWISE SPECIFIED		chr	-			product family	LPVCC	Released	
surface	-	linear	0.X	±0.30		LPVCC	dwg no	10127858	rev
			0.XX	±0.20					
			0.XXX	±0.10					
angular	0°	±3°	www.fci.com	cat. no.	-	Product - Customer Drw	sheet 1 of 3		



Copyright FCI.

PRODUCT NUMBER	POSITION	DIM A	DIM B
10127858-X04XXXLF	2X2	2.00	3.92
10127858-X06XXXLF	2X3	4.00	5.92
10127858-X08XXXLF	2X4	6.00	7.92
10127858-X10XXXLF	2X5	8.00	9.92
10127858-X12XXXLF	2X6	10.00	11.92
10127858-X14XXXLF	2X7	12.00	13.92
10127858-X16XXXLF	2X8	14.00	15.92
10127858-X18XXXLF	2X9	16.00	17.92
10127858-X20XXXLF	2X10	18.00	19.92
10127858-X22XXXLF	2X11	20.00	21.92
10127858-X24XXXLF	2X12	22.00	23.92
10127858-X26XXXLF	2X13	24.00	25.92
10127858-X28XXXLF	2X14	26.00	27.92
10127858-X30XXXLF	2X15	28.00	29.92
10127858-X32XXXLF	2X16	30.00	31.92
10127858-X34XXXLF	2X17	32.00	33.92
10127858-X36XXXLF	2X18	34.00	35.92
10127858-X38XXXLF	2X19	36.00	37.92
10127858-X40XXXLF	2X20	38.00	39.92
10127858-X42XXXLF	2X21	40.00	41.92
10127858-X44XXXLF	2X22	42.00	43.92
10127858-X46XXXLF	2X23	44.00	45.92
10127858-X48XXXLF	2X24	46.00	47.92
10127858-X50XXXLF	2X25	48.00	49.92

PLATING OPTIONS OVER CONTACT AREA
0 = 0.05um/2u" Au
1 = 0.76um/30u" Au
3 = 0.38um/15u" Au
5 = 2.54um/100u" 100%MATTE Tin
7 = 0.76um/30u" GXT
8 = 0.38um/15u" GXT

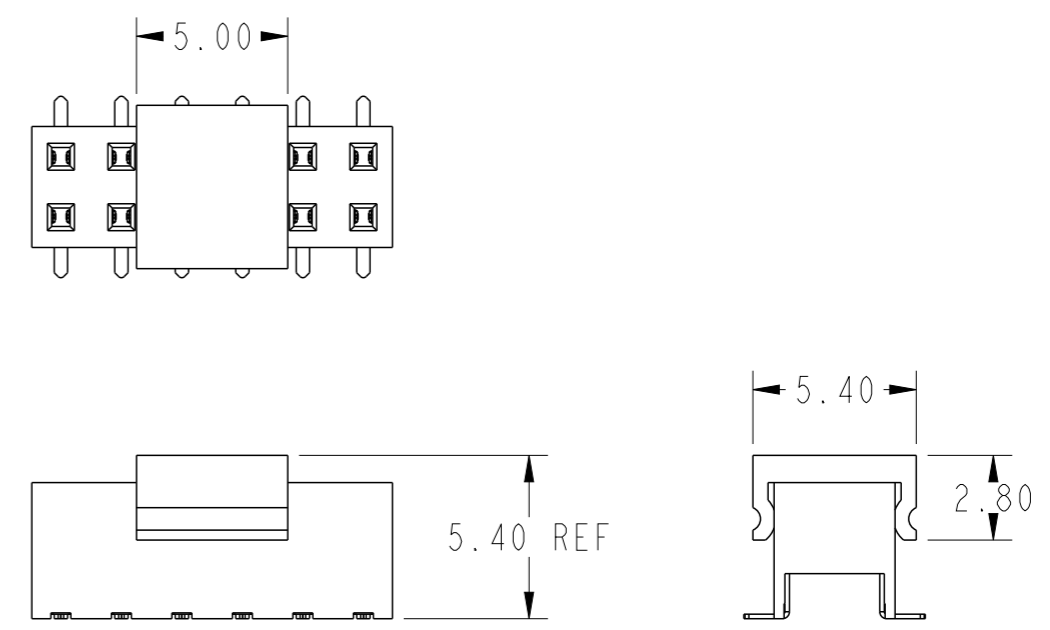

FIG 1
NOTE 6(b)



Copyright FCI.

spec ref	dr	Guo-Min Sun	2013/12/19	projection	mm	size	A3	scale	4:1
tolerance std	eng	Laurence Zang	2015/12/17			ecn no	ELX-N-22825-1		
TOLERANCES UNLESS OTHERWISE SPECIFIED		chr	-			product family	LPVCC	rel level	Released
surface	linear	0.X	±0.30			title LPVCC 4.5mm TOP ENTRY SMT LOSE PIN TYPE dwg no 10127858		rev B	
		0.XX	±0.20						
		0.XXX	±0.10						
	angular	0°	±3°	www.fci.com	cat. no.	-	Product - Customer Drw	sheet 2 of 3	

NOTES:

1. HOUSING MATERIAL : HIGH TEMP PLASTIC.
2. TERMINAL MATERIAL : COPPER ALLOY.
3. TERMINAL RETENTION 0.2Kg/PER PIN
4. 'V' CUT OPTIONAL - MANUFACTURING PROCESS OPTION.
5. PRODUCT DESCRIPTION CODE:

10127858-X XX X XX LF

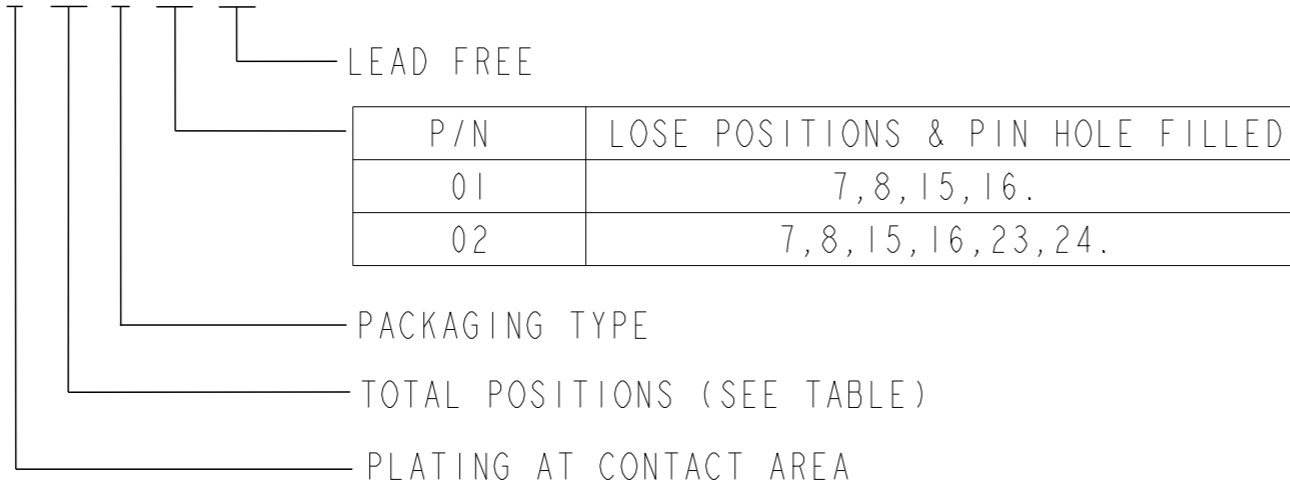

6. PACKAGING:

- (a) 10127858-XXXXXLF --- STD PACKAGING IN TUBE.
- (b) 10127858-XXXTRXXLF --- TAPE AND REEL PACKAGING WITH PICK-UP CAP. (FIG 1)
- (c) 10127858-XXXTNXXLF --- TAPE AND REEL PACKAGING WITHOUT PICK-UP CAP.

7. CO-PLANARITY:

FROM POSITION POS 04 TO POS 38 : 0.10
 POS 40 TO POS 50 : 0.12

8. PRODUCT SPECIFICATION: GS-12-008

9. THE HOUSING WILL WITHSTAND EXPOSURE TO 255~C PEAK TEMPERATURE FOR 10 SECONDS IN A CONVECTION, INFRA-RED OR VAPOR PHASE REFLOW OVEN.

10. THIS PRODUCT MEETS EUROPEAN UNION DIRECTIVES AND OTHER COUNTRY REGULATIONS AS DESCRIBED IN GS-22-008.



Copyright FCI.

spec ref		dr	Guo-Min Sun	2013/12/19	projection	mm	size	A3	scale	4:1
tolerance std		eng	Laurence Zang	2015/12/17		← →	ecn no		ELX-N-22825-1	
TOLERANCES UNLESS OTHERWISE SPECIFIED		chr	-	-			rel level		Released	
surface	✓	linear	0.X	±0.30		LPVCC	dwg no	10127858	rev	B
			0.XX	±0.20						
			0.XXX	±0.10						
angular	0°	±3°	www.fci.com	cat. no.	-	Product - Customer Drw	sheet 3 of 3			