

LTSHSM-5 **XX** - **X** - **XX** - **XX** - **V** - **XXX** - **X** - **XX** - **X** - **XX** - **LF**
(A) **(B)** **(C)** **(D)** **(E)** **(F)** **(G)** **(H)** **(I)** **(J)** **(K)**

- A. Pins Per Row - 1 through 40
- B. Row Specification - S= Single Row - D= Double Row
- C. Pin Options - See Pin Options below
- D. Plating Options - See Plating Options below
- E. Vertical
- F. Polarized Position - Leave blank if not needed - If required, specify empty pin position - e.g. 012 for Pin 12
- G. Footprint option (only for single row) - S= Pin 1 left - M= Pin 1 right
- H. Packing Information - TR= Tape and Reel - TB= Tube
- I. Pad - P= Plastic - O= No Pad - If left blank packaging left to MLE's discretion Pad may be metal, mylar or plastic
- J. Alignment Pin Option (Only for Double Row) - Leave blank if not needed. - AP=With
- K. Lead Free

Mates with:
LSSH
SMSS
SSHS

Pin Options	
Post Height	
01	0.150 3.81
02	0.065 1.65
04	0.075 1.91
06	0.120 3.05

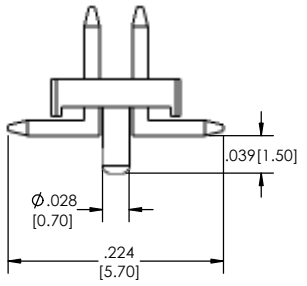
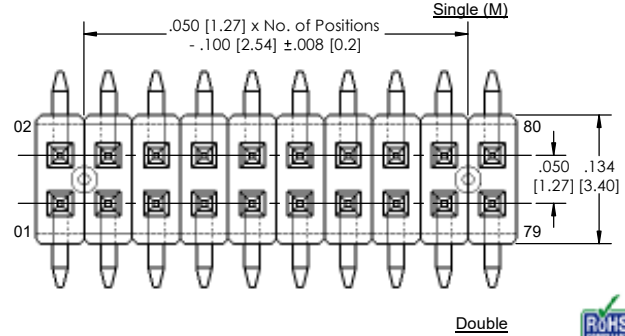
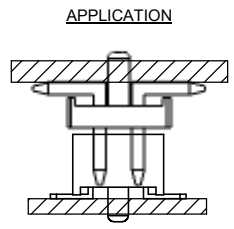
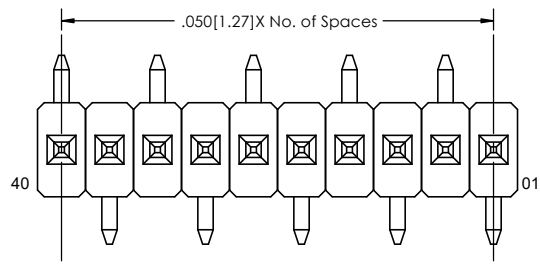
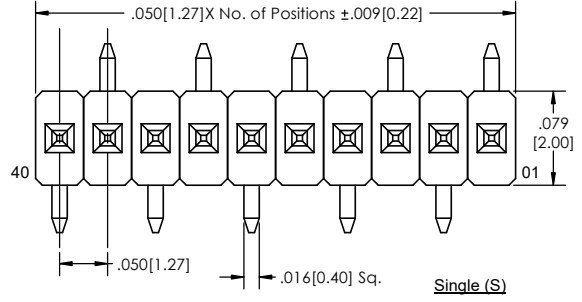
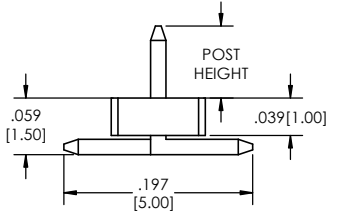

Plating options	
G	-10µ Gold on Contact Area/ Flash on Tail
T	-Matte Tin all Over
GT	-10µ Gold on Contact Area/ Matte Tin on Tail
H	-30µ Gold on Contact Area/ Matte Tin on Tail
F	-Gold Flash over Entire Pin
FT	- Gold Flash on Contact Area/ Matte Tin on Tail

Specifications:
 Current Rating: 1.0 Ampere
 Insulation Resistance: 1000M Ohms Min.
 Dielectric Withstanding: 300V AC
 Contact Resistance: 20M Ohms Max.
 Operation Temperature: -40°C to +105°C
 Max. Process Temperature
 Peak: 260°C up to 10 secs.
 Process: 230°C up to 60 secs.
 Wave: 260°C up to 6 secs.
 Reflow: 260°C up to 10 secs.
 Manual Solder: 350°C up to 5 secs.

Materials:
 Contact Material: Phosphor Bronze
 Insulator Material: Nylon 6T
 Plating: Au or Sn over 50µ" (1.27) Ni
 Tails may be clipped to achieve specific dimensions.

Products cut to specific sizes are uncancelable/ nonreturnable.
 Parts are subject to change without notice.



PROPRIETARY AND CONFIDENTIAL
 THE INFORMATION CONTAINED IN THIS DRAWING IS THE SOLE PROPERTY OF Major League Electronics. ANY REPRODUCTION IN PART OR AS A WHOLE WITHOUT THE WRITTEN PERMISSION OF Major League Electronics IS PROHIBITED.

UNLESS OTHERWISE SPECIFIED:		NAME	DATE
DRAWN		EOW	08/29/16
CHECKED		GWE	08/29/16
ENG APPR.			
MFG APPR.			
INTERPRET GEOMETRIC TOLERANCING PER:		ADDRESS:	
MATERIAL:		2533 Centennial Blvd.	
NEXT ASSY USED ON:		Jeffersonville, In 47130	
FINISH:		Phone: 812-670-4174	
APPLICATION		Fax: 812-670-4175	
DO NOT SCALE DRAWING		E-Mail: mle@mlelectronics.com	



TITLE: LTSHSM-5-V SERIES		REV
SIZE	DWG. NO.	G
C		
SCALE 12:1	SHEET 1 OF 1	