

LOADING PATTERN MATING SIDE

| | | | | | | | | | | | | | | | | | | | | |
|---|---|---|---|---|---|---|---|---|---|---|---|---|---|---|---|---|---|---|---|---|
| f | 0 | 0 | 0 | 0 | 0 | 0 | 0 | 0 | 0 | 0 | 0 | 0 | 0 | 0 | 0 | 0 | 0 | 0 | 0 | 0 |
| e | 5 | 5 | 5 | 5 | 5 | 5 | 4 | 4 | 5 | 5 | 5 | 5 | 5 | 5 | 5 | 5 | 5 | 5 | 5 | 5 |
| d | 5 | 5 | 5 | 5 | 5 | 5 | 5 | 4 | 4 | 5 | 5 | 5 | 5 | 5 | 5 | 5 | 5 | 5 | 5 | 5 |
| c | 5 | 5 | 5 | 5 | 5 | 5 | 5 | 5 | 4 | 5 | 4 | 4 | 5 | 4 | 4 | 5 | 5 | 5 | 5 | 5 |
| b | 5 | 5 | 5 | 5 | 5 | 5 | 5 | 4 | 4 | 5 | 5 | 5 | 5 | 5 | 5 | 5 | 5 | 5 | 5 | 5 |
| a | 5 | 5 | 5 | 5 | 5 | 5 | 4 | 4 | 5 | 5 | 5 | 5 | 5 | 5 | 5 | 5 | 5 | 5 | 5 | 5 |
| z | 0 | 0 | 0 | 0 | 0 | 0 | 0 | 0 | 0 | 0 | 0 | 0 | 0 | 0 | 0 | 0 | 0 | 0 | 0 | 0 |
| P | 0 | 0 | 1 | 1 | 2 | 2 | | | | | | | | | | | | | | |
| S | 1 | 5 | 0 | 5 | 0 | 5 | | | | | | | | | | | | | | |

LOADED CONNECTOR ASSEMBLY (FOR EXAMPLE)

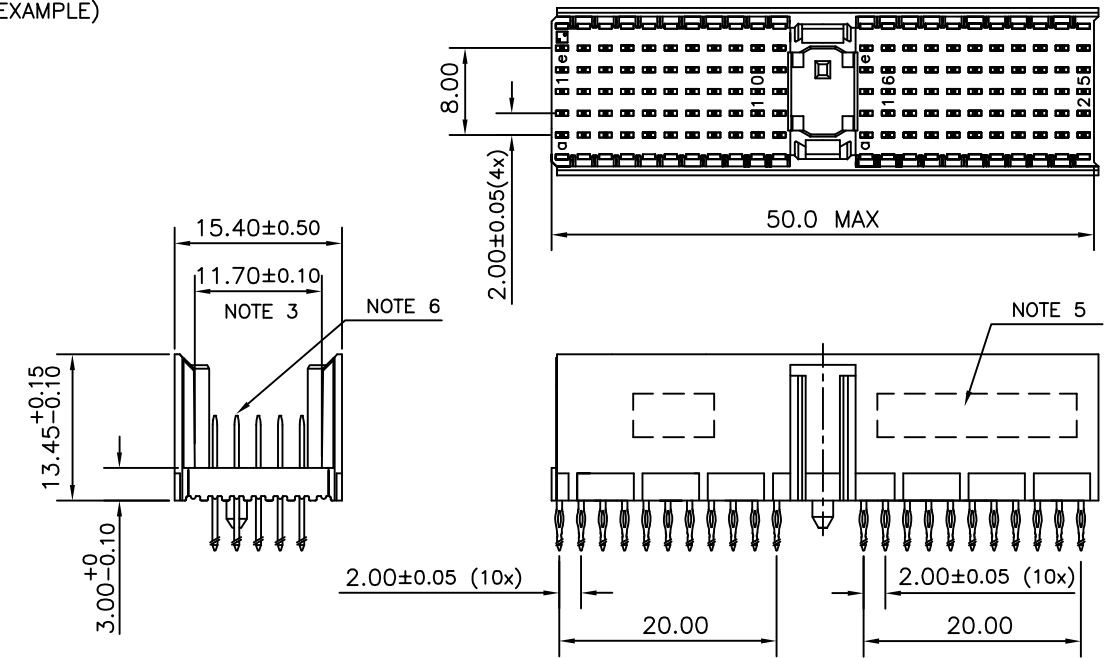

CONTACT OVERVIEW

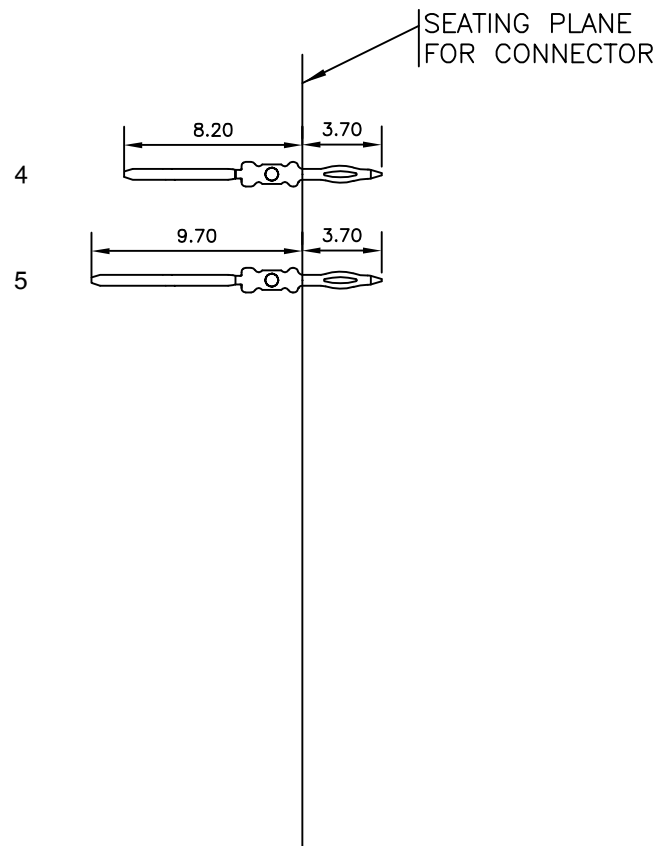

LAY-OUT P.C.B.-HOLE

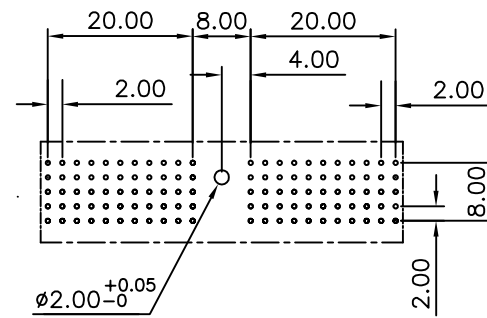

HM2P07PDF3C0-
 LEAD FREE INDICATOR : LF = LEAD FREE (DIGIT 15 & 16)
 PLATING CODE (DIGIT 13 AND 14) (REF DRW NO. BS,C , 201844 , 003)

NOTES

- THIS PRODUCT IS CSA APPROVED.
 - THIS PRODUCT IS UL RECOGNIZED.
 - MEASURED AT THE BOTTOM.
 - MATERIAL CONTACT: PHOSPHORBRONZE
HOUSING: CREAM WHITE GLASS FILLED POLYESTER UL-94V0
 - CONNECTOR PRINTED WITH P/N AND DATE CODE.
 - FOR ACTUAL CONTACT LOADINGS, SEE LOADING PATTERN MATING SIDE.
 - SHAPE OF CONNECTOR HOUSING CAN ALTER DEPENDING ON PRODUCTION LOCATION
 - THE PRODUCT (LF) MEETS EUROPEAN UNION DIRECTIVES AND OTHER COUNTRY REGULATIONS AS DESCRIBED IN GS-22-008
 - FOR RECOMMENDED PTH DIMENSIONS REFER DRAWING : BS, A , 201572 , 001
- CATALOG NO: HM2P07PDF3C0- ---

| | | | | | | | | | | | | | |
|---------------------------|--|----------------|--|-----------------------|--|-------------------------------|--|-------------------------------|--|-----------------------------------|--|--------------------------|--|
| mat'l. code SEE NOTE 4 | | | | surface ISO 1302 ✓ | | tolerance ISO 406 ISO 1101 | | projection MM | | product family MLLIPACS | | | |
| litr | | | | ecn no | | dr | | date | | title | | | |
| A | | | | 104-0093 | | MINI | | 2004/ 10/ 15 | | MPACS 5+2R STR HDR PF CONN TYPE A | | | |
| B | | | | 105-0190 | | MINI | | 2005/ 10/ 13 | | | | | |
| C | | | | 106-0090 | | MINI | | 2006/ 06/ 28 | | | | | |
| | | | | | | dr | | MINI K VANDANATH 2004/ 10/ 15 | | dwg no | | sheet 1 of 1 size 5 | |
| | | | | | | enr | | BIJU K PAUL 2004/ 10/ 15 | | BS, C ,203028, 169 | | A3 | |
| | | | | | | chr | | BIJU K PAUL 2006/ 06/ 28 | | type | | Product Customer Drawing | |
| | | | | | | appd | | BIJU K PAUL 2006/ 06/ 28 | | | | | |
| sheet index | | revision sheet | | c | | | | | | | | | |
| | | 1 | | | | | | | | | | | |