

LOC		DIST		REVISIONS			
GP	00	REV	DATE	BY	CHK	APPV	
H		REVISED PER ECO-13-012013	09AUG2013	CJV	CWR		

- ① CONTACTS DESIGNED FOR 26 & 28 AWG STRANDED OR 26, 28 & 30 AWG SOLID WIRE.
- ② AMP TRADEMARK LOCATED IN APPROX AREA SHOWN.
- ③ STANDOFFS: POSN 8 (2) STANDOFFS AS SHOWN. POSN 14-20 (3) STANDOFFS, (1) CENTERED BETWEEN (2) SHOWN
- ④ .000100-.000200 BRIGHT TIN LEAD OVER .000050 NICKEL ON ENTIRE CONTACT.
- ⑤ HEIGHT AFTER TERMINATION IS .253 REF.
- ⑥ INDICATES NO 1 POSITION.
- ⑥ MATERIAL:
MOLDED PARTS: 94V-0 RATED THERMOPLASTIC, COLOR BLACK.
CONTACTS; PHOSPHOR BRONZE

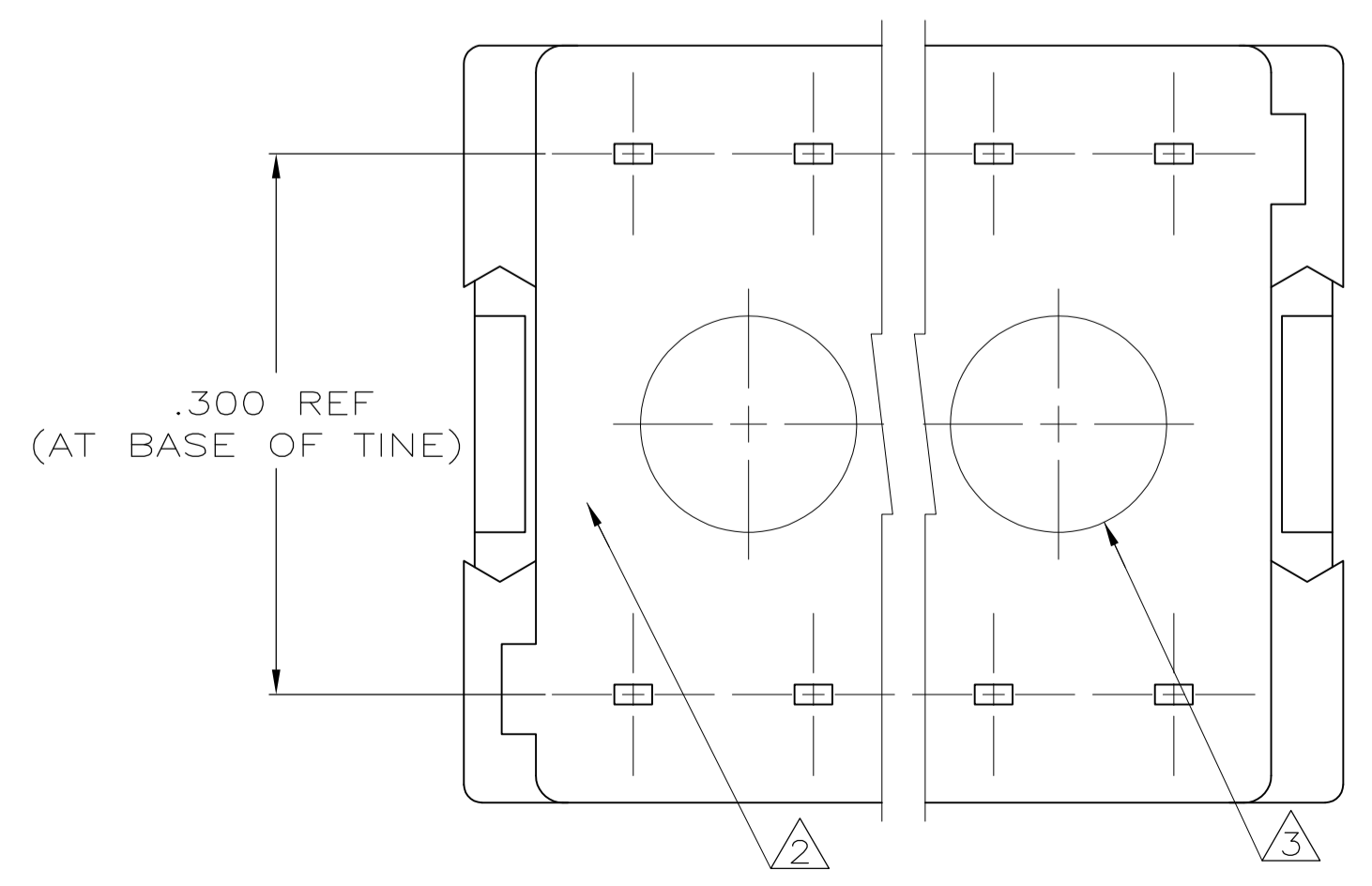
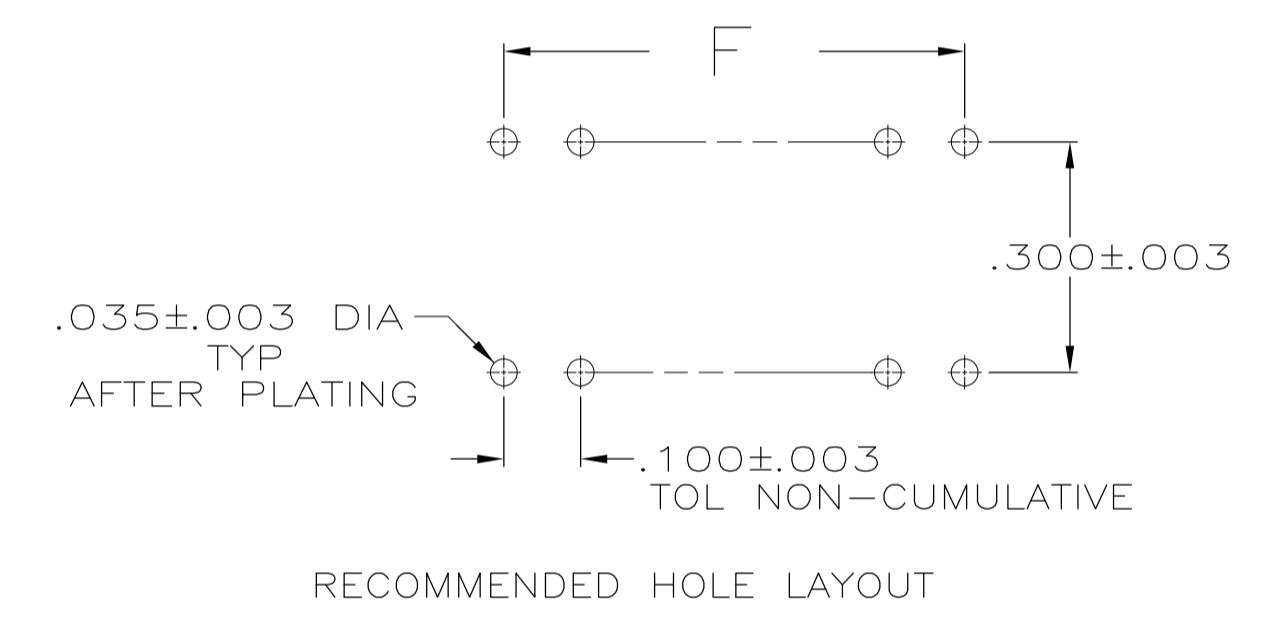
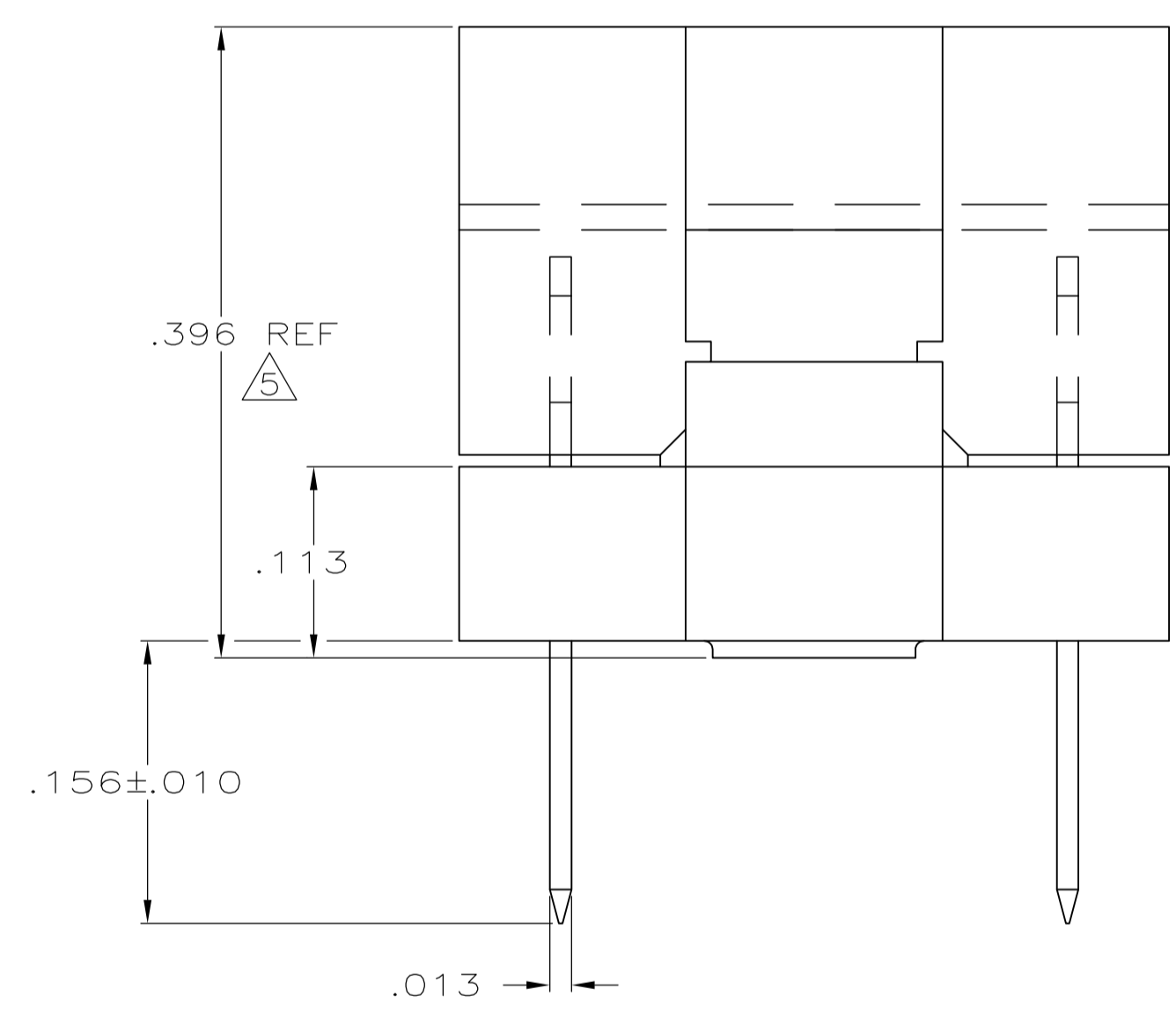
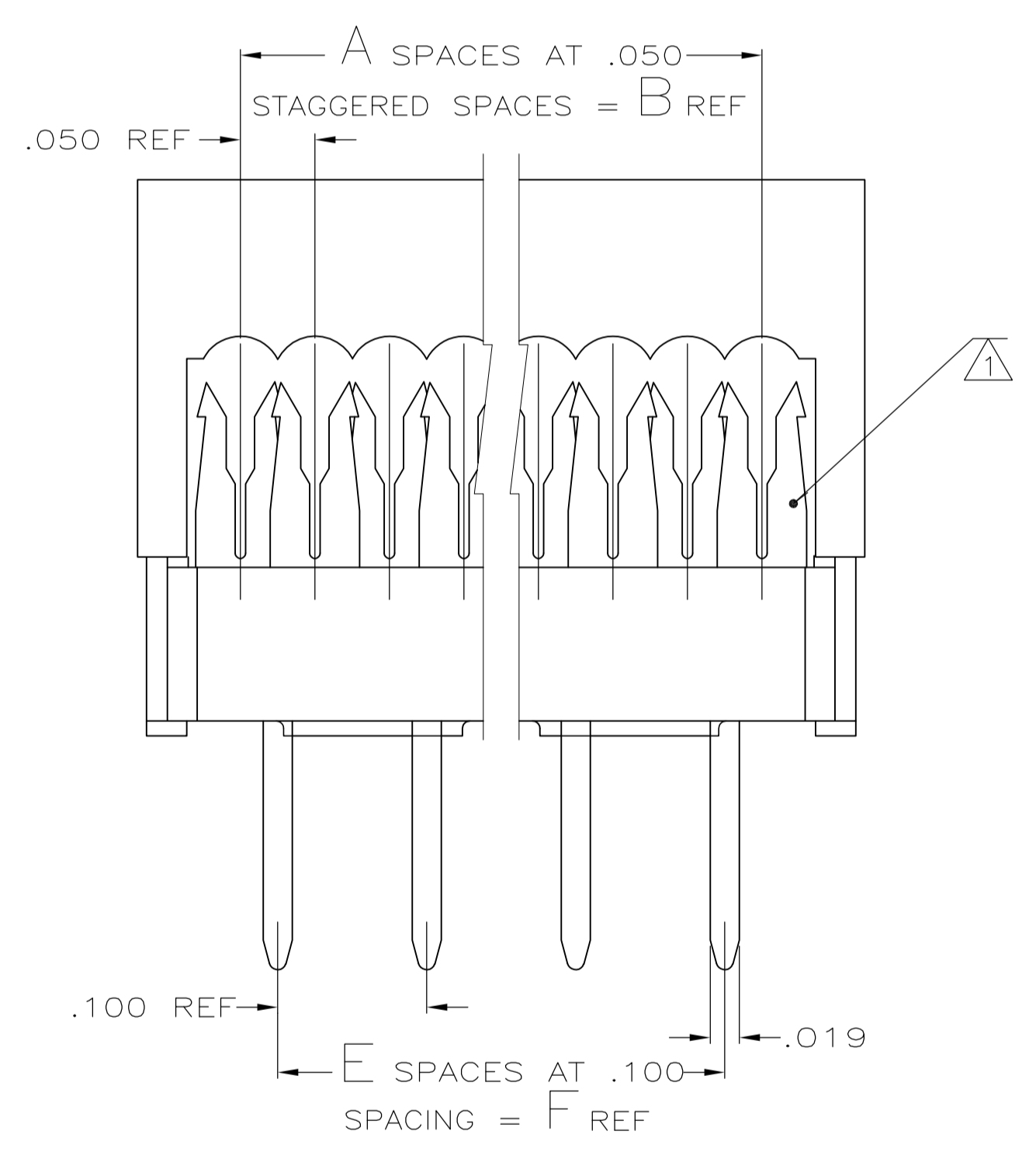
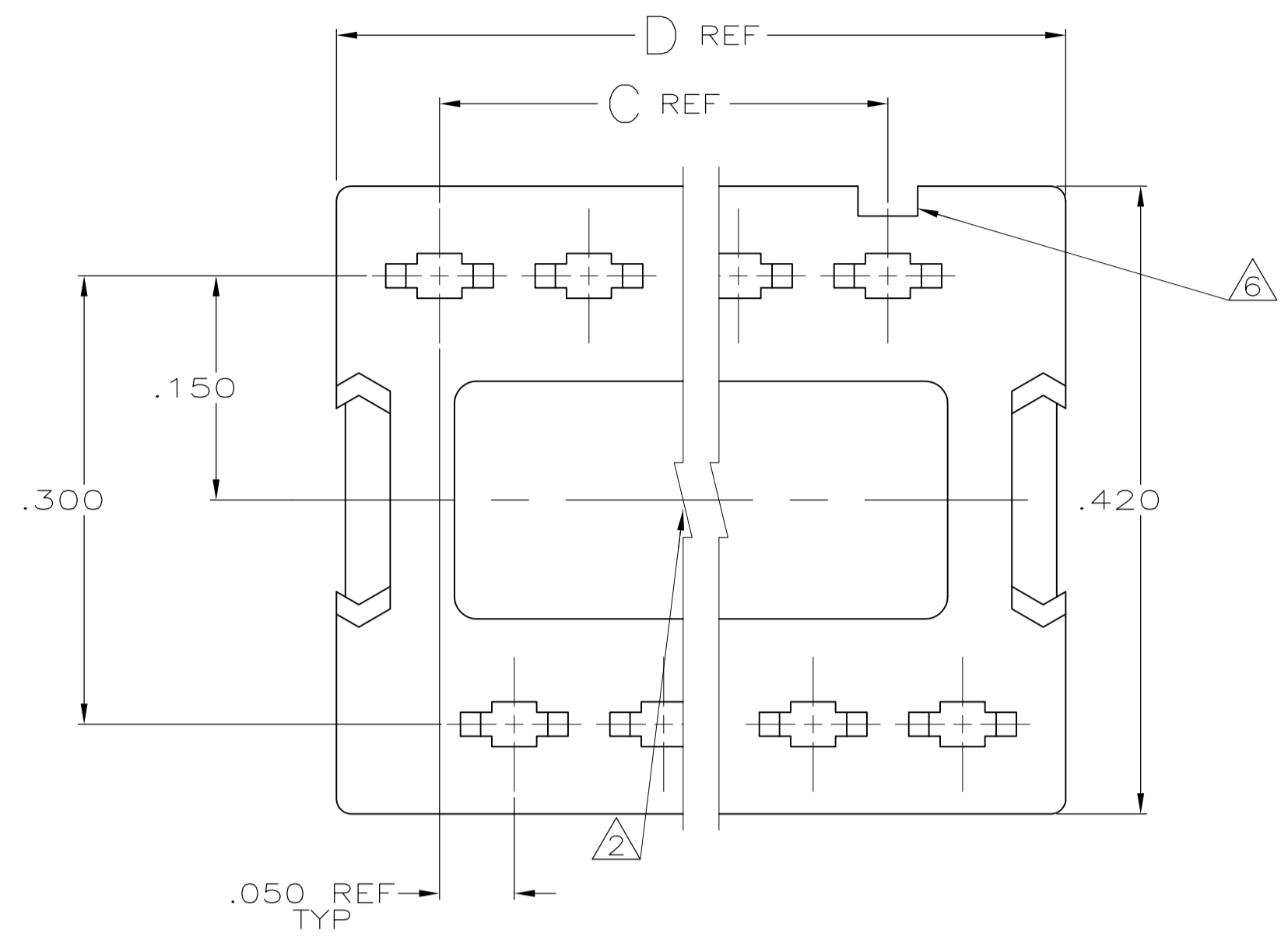

OBSOLETE	.900	9	1.088	.900	.950	19	20	746613-5
OBSOLETE	.800	8	.988	.800	.850	17	18	746613-4
	.700	7	.888	.700	.750	15	16	746613-3
OBSOLETE	.600	6	.788	.600	.650	13	14	746613-2
	.300	3	.488	.300	.350	7	8	746613-1
	F	E	D	C	B	A	NO OF POSN	PART NUMBER

THIS DRAWING IS A CONTROLLED DOCUMENT.

DIMENSIONS: INCHES	TOLERANCES UNLESS OTHERWISE SPECIFIED:	DIN W. E. ZELKO 1-10-86	NAME
0. PLC ± -	1. PLC ± -	CHK J. PEACHEY 1-8-86	STE TE Connectivity
2. PLC ± -	3. PLC ± .005	APPV M. SCULLY 1-10-86	PRODUCT SPEC
4. PLC ± -	ANGLES ± -		108-40013
MATERIAL	FINISH	SIZE	CAGE CODE
⑥	④	A1	00779
		WEIGHT	DRAWING NO
			746613
		CUSTOMER DRAWING	SCALE 10:1 SHEET 1 OF 1 REV H