

REMARK:

1. CHARACTERISTICS:

RATED VOLTAGE: 250V  
 RATED CURRENT: 2.5AMP  
 CONTACT RESISTANCE: 25mohms MAX. INITIAL,  
 40mohms MAX. AFTER.  
 INSULATION RESISTANCE: 5000mohms MIN. at 500V DC  
 DIELECTRIC STRENGTH: 750VRMS  
 OPERATING TEMPERATURE RANGE: -55° C~105° C  
 INSERTION/EXTRACTION FORCE PER CONTACT: 5N Max./0.2N Min..  
 MATING/UNMATING CYCLES: 200MATINGS MIN FOR GOLD-FLASH  
 500MATINGS MIN FOR 30u" GOLD.

2. MATERIAL:

INSULATORS: THERMOPLASTIC G.F(UL94V-0) BLACK  
 CONTACTS: COPPER ALLOY, GOLD(G/F or 30u") TOP OVER CONTACT  
 AREA, 100u" Min MATTE TIN TOP OVER SOLDER AREA,  
 50u" Min NICKEL UNDER PLATE.  
 SHELL: CARBON STEEL, 100u" Min NICKEL TOP OVER,  
 50u" Min COPPER UNDER PLATE.  
 HARPOON: COPPER ALLOY, 100u" Min MATTE TIN PLATED

3. Type H Insulator will withstand exposure to 260° C peak temperature for 10 seconds maximum in a wave soldering application

4. PART NUMBER DESCRIPTION:

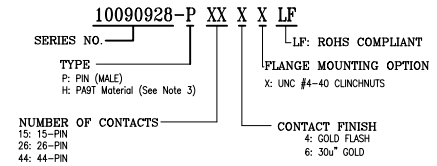

POS.	PART NO.	THREAD TYPE
15	10090928-P15*XLF	UNC #4-40
26	10090928-P26*XLF	UNC #4-40
44	10090928-P44*XLF	UNC #4-40

POS.	A	B	C	D	E	H
15	30.81	24.99	16.92	2.29	5.90 <sup>+0.25</sup> <sub>0</sub>	19.10
26	39.24	33.32	25.25	2.29	5.90 <sup>+0.25</sup> <sub>0</sub>	27.75
44	53.04	47.04	38.96	2.29	5.70 <sup>+0.25</sup> <sub>0</sub>	41.30

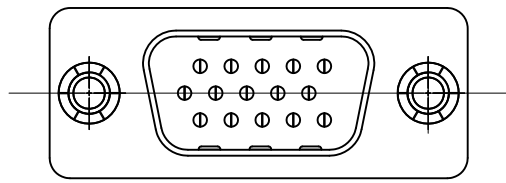

FOR 15P

mat'l. code		surface ISO 1302 ✓		tolerance ISO 406 ISO 1101		projection mm		product family D-SUB	
ltr		ecn no		dr		date		title	
E		ELX-1-20972		AB		2015/05/30		HD D-SUB MALE STRAIGHT	
F		ELX-1-25813		GREGAR		2016/10/31			
G		ELX-1-27111		MP		2017/05/27			
sheet		revision		G		G		G	
index		sheet		1		2		3	

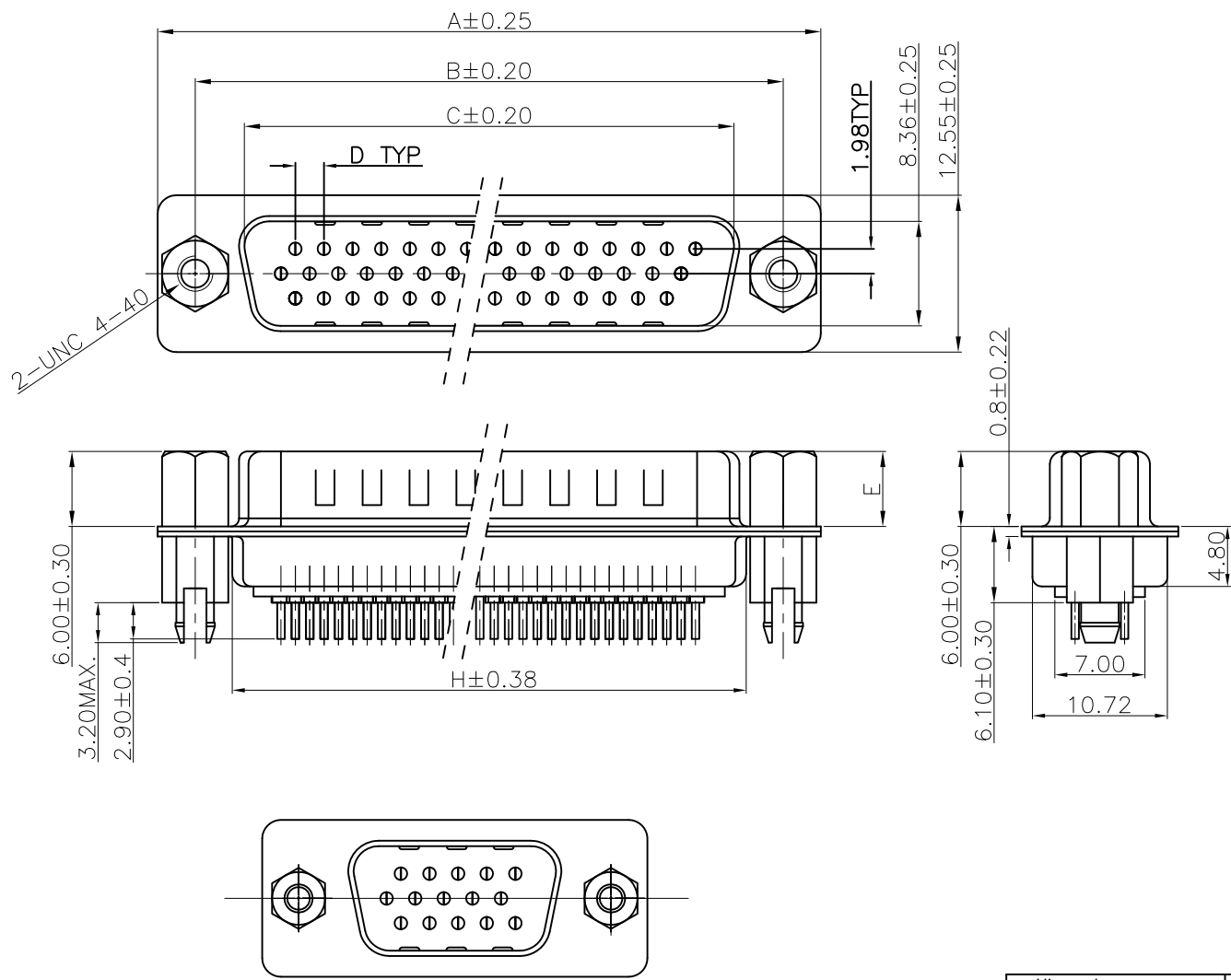

REMARK:

1. CHARACTERISTICS:  
 RATED VOLTAGE: 250V  
 RATED CURRENT: 2.5AMP  
 CONTACT RESISTANCE: 25mohms MAX. INITIAL,  
 40mohms MAX. AFTER.  
 INSULATION RESISTANCE: 5000Mohms MIN. at 500V DC  
 DIELECTRIC STRENGTH: 750VRMS  
 OPERATING TEMPERATURE RANGE: -55° C~105° C  
 INSERTION/EXTRACTION FORCE PER CONTACT: 5N Max./0.2N Min.  
 MATING/UNMATING CYCLES: 200MATINGS MIN FOR GOLD-FLASH  
 500MATINGS MIN FOR 30u" GOLD.

2. MATERIAL:  
 INSULATORS: THERMOPLASTIC G.F(UL94V-0) BLACK  
 CONTACTS: COPPER ALLOY, GOLD(G/F or 30u") TOP OVER CONTACT  
 AREA, 100u" Min MATTE TIN TOP OVER SOLDER AREA,  
 50u" Min NICKEL UNDER PLATE.  
 SHELL: CARBON STEEL, 100u" Min NICKEL TOP OVER,  
 50u" Min COPPER UNDER PLATE.  
 HARPOON: COPPER ALLOY, 100u" Min MATTE TIN PLATED.  
 NUT: COPPER ALLOY, 50u" Min NICKEL PLATED.

3. Type H Insulator will withstand exposure to 260° C peak temperature  
 for 10 seconds maximum in a wave soldering application

4. PART NUMBER DESCRIPTION:

10090928-P XX X V LF

SERIES NO. LF: ROHS COMPLIANT  
 TYPE PLANGE MOUNTING OPTION  
 P: PIN (MALE) V: UNC #4-40 SCREWLOCKS  
 H: PART Material (See Note 3)

NUMBER OF CONTACTS CONTACT FINISH  
 15: 15-PIN 4: GOLD FLASH  
 26: 26-PIN 6: 30u" GOLD  
 44: 44-PIN

POS.	PART NO.
15	10090928-P15*VLF
26	10090928-P26*VLF
44	10090928-P44*VLF

POS.	A	B	C	D	E	H
15	30.81	24.99	16.92	2.29	5.90 <sup>+0.25</sup>	19.10
26	39.24	33.32	25.25	2.29	5.90 <sup>+0.25</sup>	27.75
44	53.04	47.04	38.96	2.29	5.70 <sup>+0.25</sup>	41.30

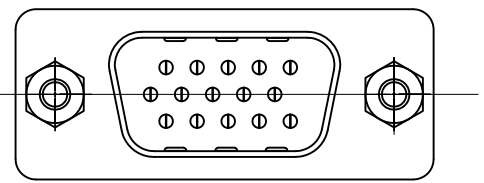

mat'l. code	surface ISO 1302	tolerance ISO 406 ISO 1101	projection mm	product family D-SUB
ltr	ecn no	dr	date	title
g				HD D-SUB MALE STRAIGHT
				scale N.T.S.
				dwg no
				10090928
				sheet 2 of 3
				size A4
				type Product Customer Drawing
sheet index	revision sheet			

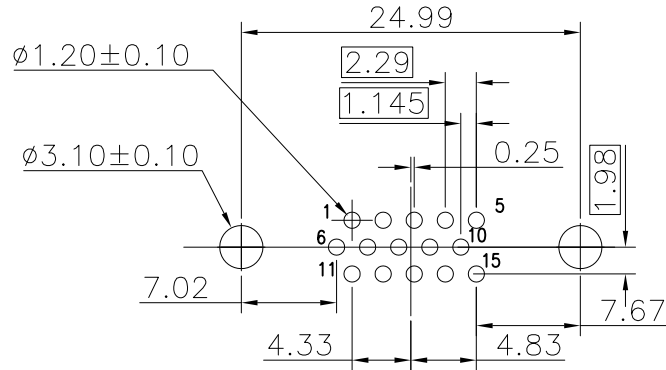

P.C.B LAYOUT (FOR 15P)

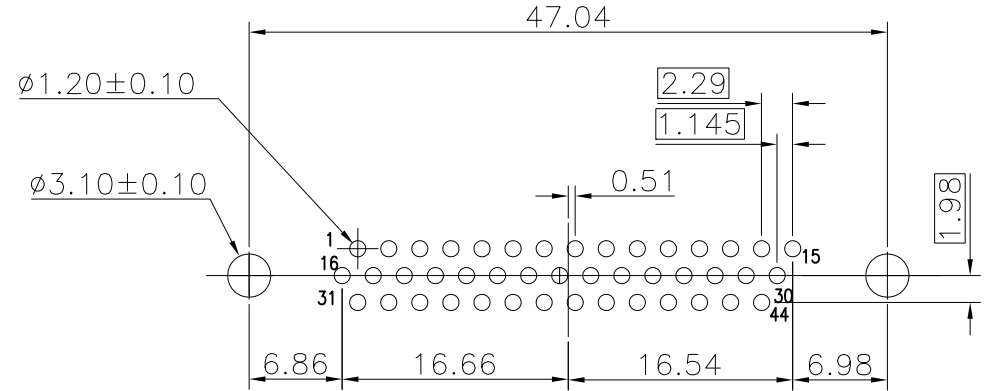

P.C.B LAYOUT (FOR 44P)

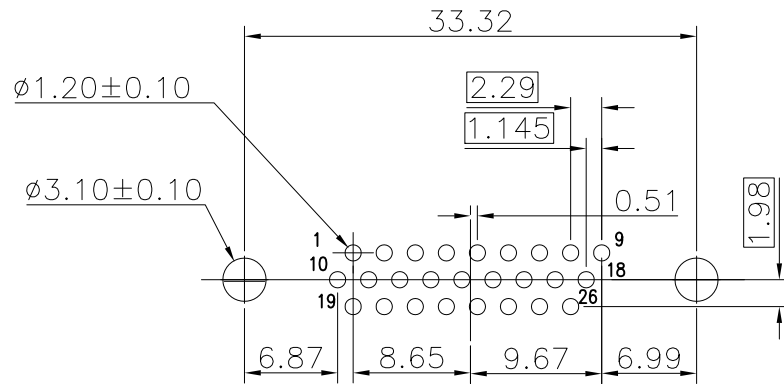

P.C.B LAYOUT (FOR 26P)

mat'l. code		surface ISO 1302 <input checked="" type="checkbox"/> ISO 406 ISO 1101		tolerance ISO 406 ISO 1101		projection 		product family D-SUB	
ltr	ecn no	dr	date	tolerances unless otherwise specified				title	
g				angles	linear	.0±0.38	mm		HD D-SUB MALE STRAIGHT
				0°±2'	profile	.00±0.25	scale N.T.S.		
		dr	JASON HSU	2009/10/12			Amphenol FCi		dwg no
		enr	MITHUN PAUL	2016/10/31					sheet 3 of 3
		chr	GREGAR MATHEW	2016/10/31					size
		app	BIJU K PAUL	2016/10/31					A4
sheet index		revision sheet						type Product Customer Drawing	