

NOTE:

- MATERIAL AND FINISH
SHELL ASSEMBLY: COPPER ALLOY, OUTER SHELL AND COLLECT NUT Cr PLATING, OTHER METALLIC COMPONENTS Ni PLATING.
INSULATOR: PEEK
CONTACT: COPPER ALLOY, GOLD PLATING OVER Ni
- DURABILITY: 5000 CYCLES
- PROTECTION INDEX(MATED): IP66/IP68, IP68 ACHIEVED PROVIDING THAT THE CABLE IS PERFECTLY CIRCULAR AND THAT ASSEMBLY PROCESS ENSURES A HIGH INTEGRITY SEAL.
- HUMIDITY: UP TO 95% AT 60°C
- TEMPERATURE: -55°C,+200°C
- ROHS COMPLIANCE.
- PART NO.:

R - F 2 K S * * 0 * C 1 * * *

CONTACT POS.
02-32=2pin-32pin

SHELL MATERIAL
0=Brass

| CODE | CONTACT TYPE |
|------|-----------------------|
| 2 | Male Solder Contact |
| 4 | Female Solder Contact |
| C | Crimp Male Contact |
| M | Crimp Female Contact |

COLLET NUT
1=Nut for fitting a bend relief

| CODE | KEY ANGLES |
|------|------------|
| 0 | 0° |
| A | 30° |
| * | ** |

| CABLE OD |
|--------------------|
| 15=OD: 1.3mm-1.5mm |
| 20=OD: 1.6mm-2.0mm |
| 25=OD: 2.1mm-2.5mm |
| 30=OD: 2.6mm-3.0mm |
| 35=OD: 3.1mm-3.5mm |
| 40=OD: 3.6mm-4.0mm |
| 45=OD: 4.1mm-4.5mm |
| 50=OD: 4.6mm-5.0mm |
| 55=OD: 5.1mm-5.5mm |
| 60=OD: 5.6mm-6.0mm |
| 65=OD: 6.1mm-6.5mm |
| 70=OD: 6.6mm-7.0mm |
| 75=OD: 7.1mm-7.5mm |
| 80=OD: 7.6mm-8.0mm |
| 85=OD: 8.1mm-8.5mm |

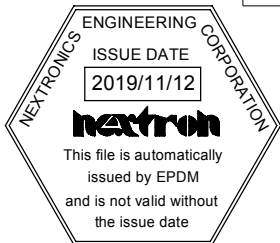
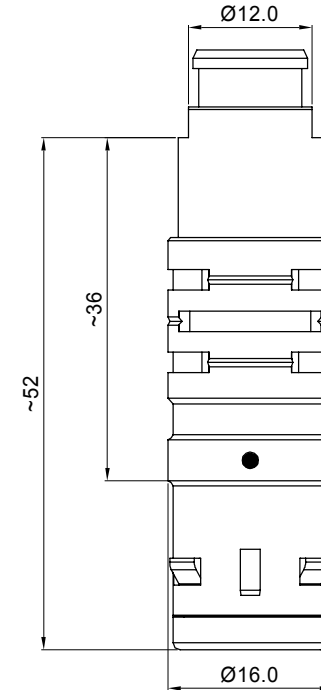

| REV. | DESCRIPTION | DATE |
|------|--------------|----------|
| X3 | UPDATE FRAME | 11/06'19 |
| X2 | ECN-160053 | 6/20'16 |

| | | | |
|--|------------|-----------------------------------|----------------------------------|
| UNITS: ■ mm □ inch | SIZE A3 | NAME: SNAP LATCH METAL 2K PLUG | NEXTRONICS ENGINEERING CORP. |
| GENERAL TOLERANCE: (UNLESS SPECIFIED) | | PART NO: R-F2KS**0*C1*** | |
| 4 PLACE | ± ** | ±. ** | APPD: Alex梁良駒 2019/11/11 |
| 3 PLACE | ± 0.1 | ±. ** | CHKD: Ken張永 2019/11/09 |
| 2 PLACE | ± 0.3 | ±. ** | DRAW: Ellen孫郁婷 2019/11/06 |
| 1 PLACE | ± 0.5 | ±. ** | DESIGN: Cayley梁思雅 2019/11/06 |
| ANGLES | X°±2° | | DWG NO: 010-0000-C12 |
| | | | SCALE SHEET REV. 2/1 1/4 X3 |

NOTE:

- MATERIAL AND FINISH
SHELL ASSEMBLY: COPPER ALLOY, OUTER SHELL AND COLLECT NUT Cr PLATING, OTHER METALLIC COMPONENTS Ni PLATING.
INSULATOR: PEEK
CONTACT: COPPER ALLOY, GOLD PLATING OVER Ni
- DURABILITY: 5000 CYCLES
- PROTECTION INDEX(MATED): IP66/IP68, IP68 ACHIEVED PROVIDING THAT THE CABLE IS PERFECTLY CIRCULAR AND THAT ASSEMBLY PROCESS ENSURES A HIGH INTEGRITY SEAL.
- HUMIDITY: UP TO 95% AT 60°C
- TEMPERATURE: -55°C, +200°C
- ROHS COMPLIANCE.
- PART NO.:

R - F 2 K S * * 0 * C 2 * * *

CONTACT POS.
02-32=2pin-32pin

SHELL MATERIAL
0=Brass

| CODE | CONTACT TYPE |
|------|-----------------------|
| 2 | Male Solder Contact |
| 4 | Female Solder Contact |
| C | Crimp Male Contact |
| M | Crimp Female Contact |

COLLET NUT
2=Nut for Standard

| CODE | KEY ANGLES |
|------|------------|
| 0 | 0° |
| A | 30° |
| * | ** |

| CABLE OD |
|--------------------|
| 15=OD: 1.3mm-1.5mm |
| 20=OD: 1.6mm-2.0mm |
| 25=OD: 2.1mm-2.5mm |
| 30=OD: 2.6mm-3.0mm |
| 35=OD: 3.1mm-3.5mm |
| 40=OD: 3.6mm-4.0mm |
| 45=OD: 4.1mm-4.5mm |
| 50=OD: 4.6mm-5.0mm |
| 55=OD: 5.1mm-5.5mm |
| 60=OD: 5.6mm-6.0mm |
| 65=OD: 6.1mm-6.5mm |
| 70=OD: 6.6mm-7.0mm |
| 75=OD: 7.1mm-7.5mm |
| 80=OD: 7.6mm-8.0mm |
| 85=OD: 8.1mm-8.5mm |

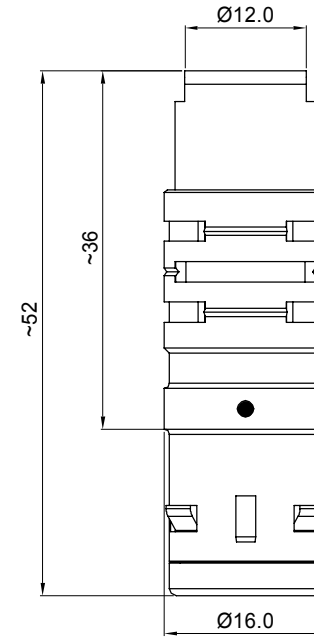

| REV. | DESCRIPTION | DATE |
|------|--------------|----------|
| X3 | UPDATE FRAME | 11/06'19 |
| X2 | ECN-160053 | 6/20'16 |

| UNITS: | SIZE | NAME: | nexttron® NEXTRONICS ENGINEERING CORP. |
|--|---------|--------------------------|---|
| ■ mm □ inch | A3 | SNAP LATCH METAL 2K PLUG | |
| GENERAL TOLERANCE: (UNLESS SPECIFIED) | | PART NO: R-F2KS**0*C2*** | TITLE: CUSTOMER DWG. |
| 4 PLACE | ± ** | inch ± ** | APPD: Alex梁良駒 2019/11/11 |
| 3 PLACE | ± 0.1 | inch ± ** | CHKD: Ken張永 2019/11/09 |
| 2 PLACE | ± 0.3 | inch ± ** | DRAW: Ellen孫郁婷 2019/11/06 |
| 1 PLACE | ± 0.5 | inch ± ** | DESIGN: Cayley梁思雅 2019/11/06 |
| ANGLES | X° ± 2° | | DWG NO: 010-0000-C12 |
| | | | SCALE SHEET REV. 2/1 2/4 X3 |

CONFIDENTIAL: THIS DOCUMENT CONTAINED THE INFORMATION IS PROPRIETARY AND CONFIDENTIAL TO Nexttronics Engineering Corp. NO PERSON IS ALLOWED TO USE COPY, PUBLISH OR OTHERWISE DISCLOSE THE INFORMATION TO OTHERS, UNLESS BY THE PRIOR WRITTEN EXPRESS AUTHORIZATION OF Nexttronics Engineering Corp. (C)COPYRIGHT- Nexttronics Engineering Corp.

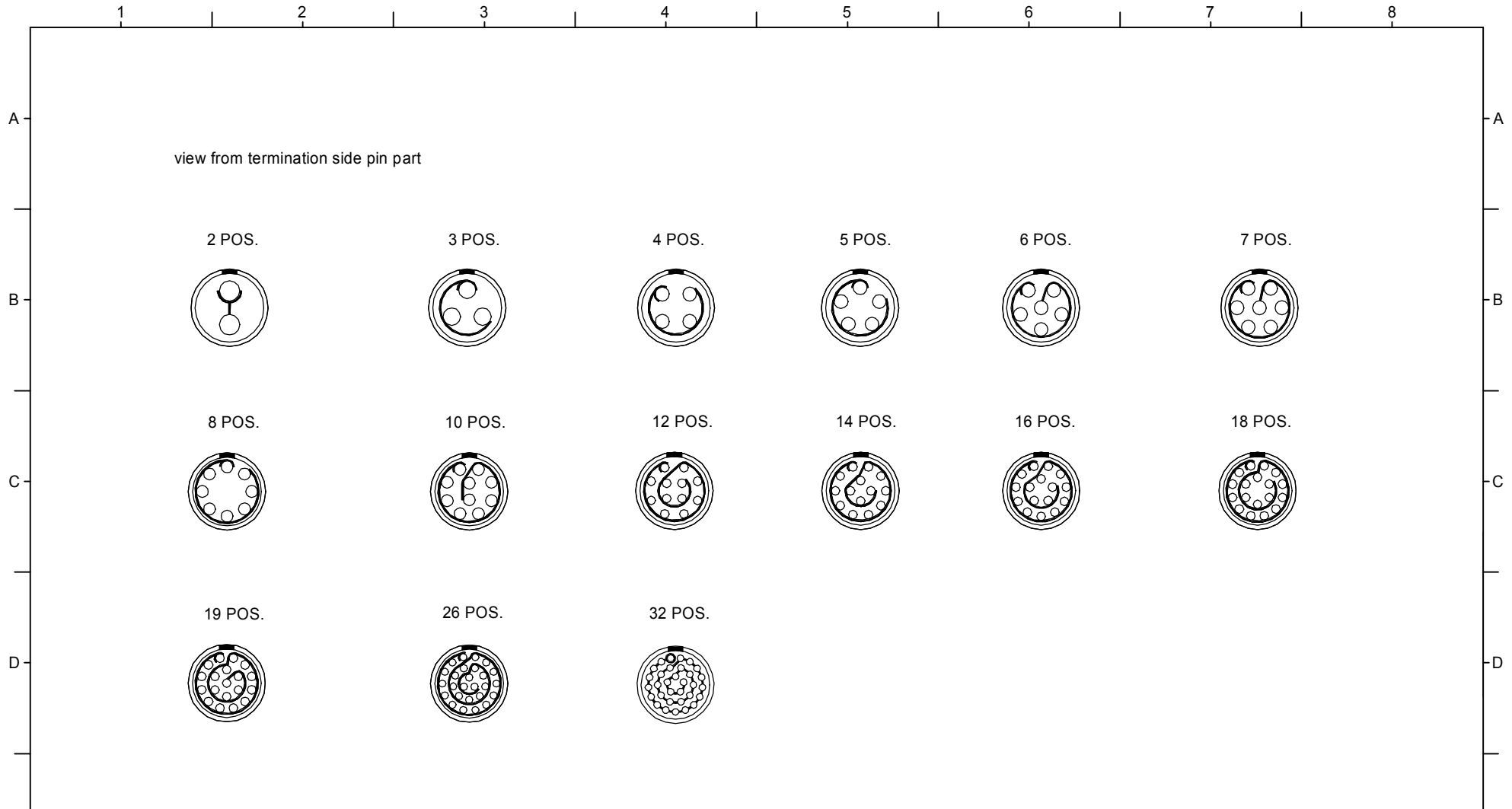

ENGINEERING CORPORATION
 NEXTRONICS
 ISSUE DATE
 2019/11/12
nextron
 This file is automatically issued by EPDM and is not valid without the issue date

| | | |
|------|--------------|----------|
| X3 | UPDATE FRAME | 11/06'19 |
| X2 | ECN-160053 | 6/20'16 |
| REV. | DESCRIPTION | DATE |

| | | | | | |
|--|------------|-----------------------------------|--|------------|--------------------------------|
| UNITS: ■ mm □ inch | SIZE A3 | NAME: SNAP LATCH METAL 2K PLUG | NEXTRONICS ENGINEERING CORP. TITLE: CUSTOMER DWG. | | |
| GENERAL TOLERANCE: (UNLESS SPECIFIED) | | PART NO: R-F2KS****C**** | | | |
| 4 PLACE | ± ** | ±. ** | APPD: Alex梁良駒 | 2019/11/11 | C |
| 3 PLACE | ± 0.1 | ±. ** | CHKD: Ken張永 | 2019/11/09 | |
| 2 PLACE | ± 0.3 | ±. ** | DRAW: Ellen孫郁婷 | 2019/11/06 | |
| 1 PLACE | ± 0.5 | ±. ** | DESIGN: Cayley梁思雅 | 2019/11/06 | |
| ANGLES | X° ± 2° | | | | SCALE SHEET REV. 2/1 3/4 X3 |

CONFIDENTIAL: THIS DOCUMENT CONTAINED THE INFORMATION IS PROPRIETARY AND CONFIDENTIAL TO Nextronics Engineering Corp. NO PERSON IS ALLOWED TO USE COPY, PUBLISH OR OTHERWISE DISCLOSE THE INFORMATION TO OTHERS, UNLESS BY THE PRIOR WRITTEN EXPRESS AUTHORIZATION OF Nextronics Engineering Corp. (C)COPYRIGHT- Nextronics Engineering Corp.

KEY ANGLES (PLUG FRONT VIEW):

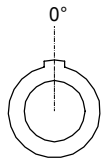

0

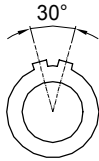

A



D



B

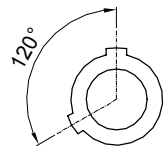

K

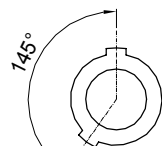

U

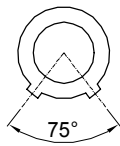

H

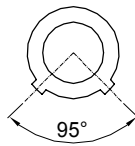

C



| | | |
|------|--------------|----------|
| X3 | UPDATE FRAME | 11/06'19 |
| X2 | ECN-160053 | 6/20'16 |
| REV. | DESCRIPTION | DATE |

| | | | | | | | | | | | |
|--|------------|-----------------------------------|----------------------------------|------------|---|----------------------|-------|------|-----|-----|----|
| UNITS: ■ mm □ inch | SIZE A3 | NAME: SNAP LATCH METAL 2K PLUG | NEXTRONICS ENGINEERING CORP. | | | | | | | | |
| GENERAL TOLERANCE: (UNLESS SPECIFIED) | | PART NO: R-F2KS****C**** | | | | TITLE: CUSTOMER DWG. | | | | | |
| 4 PLACE | ± ** | ±. ** | APPD: Alex梁良駒 | 2019/11/11 | DWG NO: 010-0000-C12 | C | | | | | |
| 3 PLACE | ± 0.1 | ±. ** | CHKD: Ken張永 | 2019/11/09 | | | | | | | |
| 2 PLACE | ± 0.3 | ±. ** | DRAW: Ellen孫郁婷 | 2019/11/06 | <table border="1"> <tr> <td>SCALE</td> <td>SHEET</td> <td>REV.</td> </tr> <tr> <td>2/1</td> <td>4/4</td> <td>X3</td> </tr> </table> | SCALE | SHEET | REV. | 2/1 | 4/4 | X3 |
| SCALE | SHEET | REV. | | | | | | | | | |
| 2/1 | 4/4 | X3 | | | | | | | | | |
| 1 PLACE | ± 0.5 | ±. ** | DESIGN: Cayley梁思雅 | 2019/11/06 | | | | | | | |
| ANGLES | X° ± 2° | | | | | | | | | | |

CONFIDENTIAL: THIS DOCUMENT CONTAINED THE INFORMATION IS PROPRIETARY AND CONFIDENTIAL TO Nexttronics Engineering Corp. NO PERSON IS ALLOWED TO USE COPY, PUBLISH OR OTHERWISE DISCLOSE THE INFORMATION TO OTHERS, UNLESS BY THE PRIOR WRITTEN EXPRESS AUTHORIZATION OF Nexttronics Engineering Corp. (C)COPYRIGHT- Nexttronics Engineering Corp.