

| PRODUCT NUMBER | ASSY. STYLE | BOARD ATTACHMENT | TAIL TERMINATION | TAIL LGTH. DIM "A" | PCB THICKNESS | NOTES |
|-----------------|-------------|------------------|------------------|--------------------|---------------|--------|
| SEE TABLE SH. 3 | 1 | PRESS-PEG | SOLDER-TO-BOARD | 2.90mm | 1.6mm | NOTE 7 |
| | 1 | PRESS-PEG | SOLDER-TO-BOARD | 3.53mm | 2.4mm | NOTE 7 |
| | 2 | HEAT-STAKE | SOLDER-TO-BOARD | 2.90mm | 1.6mm | |
| | 2 | HEAT-STAKE | SOLDER-TO-BOARD | 3.53mm | 2.4mm | |
| | 3 | PRESS-PEG | PRESS-FIT | 2.90mm | 1.6mm | NOTE 7 |
| | 3 | PRESS-PEG | PRESS-FIT | 3.53mm | 2.4mm | NOTE 7 |

| PLATING CONTACT AREA: | |
|-----------------------|-------------------|
| DASH NR: | PERFORMANCE LEVEL |
| -1YY/1YYLF | TELCORDIA CO |
| -2YY/2YYLF | CUSTOMER SPECIAL |
| -3YY/3YYLF | CUSTOMER SPECIAL |

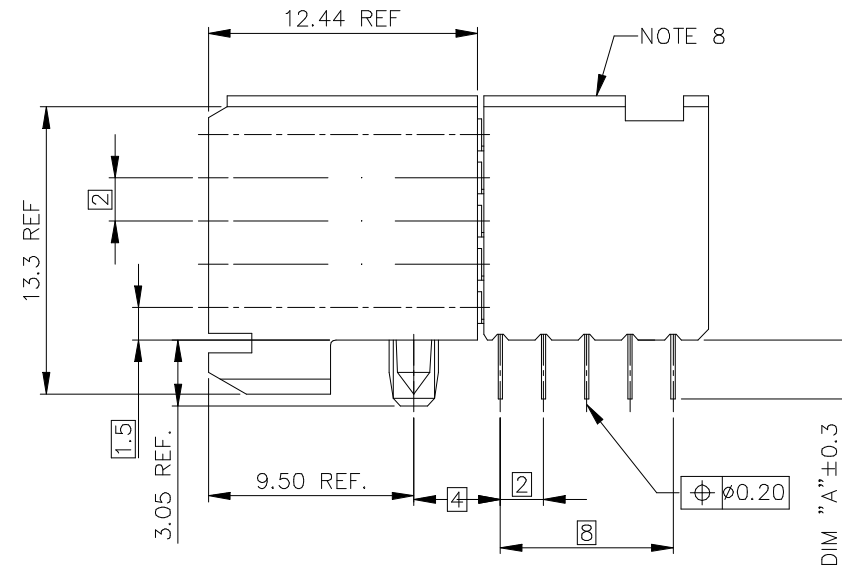
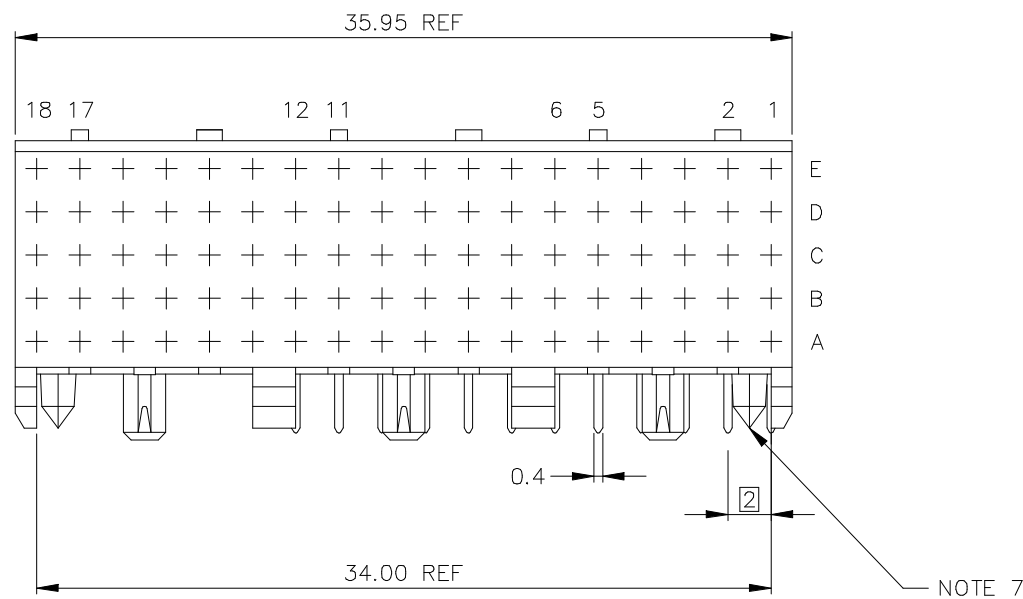

ASSY. STYLE 1

Amphenol FCI

© 2016 AFCI

| | | | | | | | | | | | | | |
|--------------------|-------------|----------------|----------|---------------------------------------|---|----------------------------|--|--------------|--|-------------------------------------|--|--|--|
| mat'l. code | | | | surface ISO 1302 ✓ | | tolerance ISO 406 ISO 1101 | | projection | | product family METRAL | | | |
| ltr ecn no dr date | | | | tolerances unless otherwise specified | | angles linear | | MM | | title | | | |
| J | V05-1012 | JRV | 11/3/05 | | | | | | | R/A SIGNAL HYBRID RECEPTACLE - 36MM | | | |
| K | DG08-0171 | TER | 9/6/08 | | | | | | | | | | |
| L | DG09-0068 | Cenh | 06/06/09 | | | | | | | | | | |
| M | ELX-N-26608 | MZ | 3/28/17 | | | | | | | | | | |
| | | | | dr M.FETROW 7/2/97 | | | | scale 1:1 | | sheet 1 of 3 size | | | |
| | | | | enr C.PENDLETON 7/2/97 | | | | Amphenol FCI | | 73950 A3 | | | |
| | | | | chr C.PENDLETON 7/2/97 | | | | | | type Product Customer Drawing | | | |
| | | | | appd C.PENDLETON 7/2/97 | | | | | | | | | |
| sheet index | | revision sheet | | M | M | M | | | | | | | |
| | | | | 1 | 2 | 3 | | | | | | | |

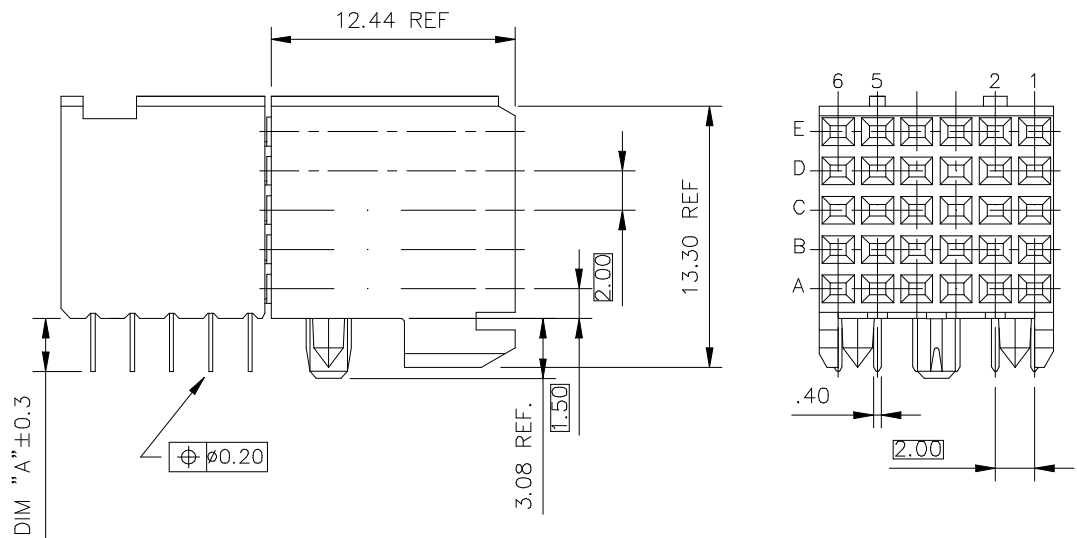

[SM] SIGNAL MODULE

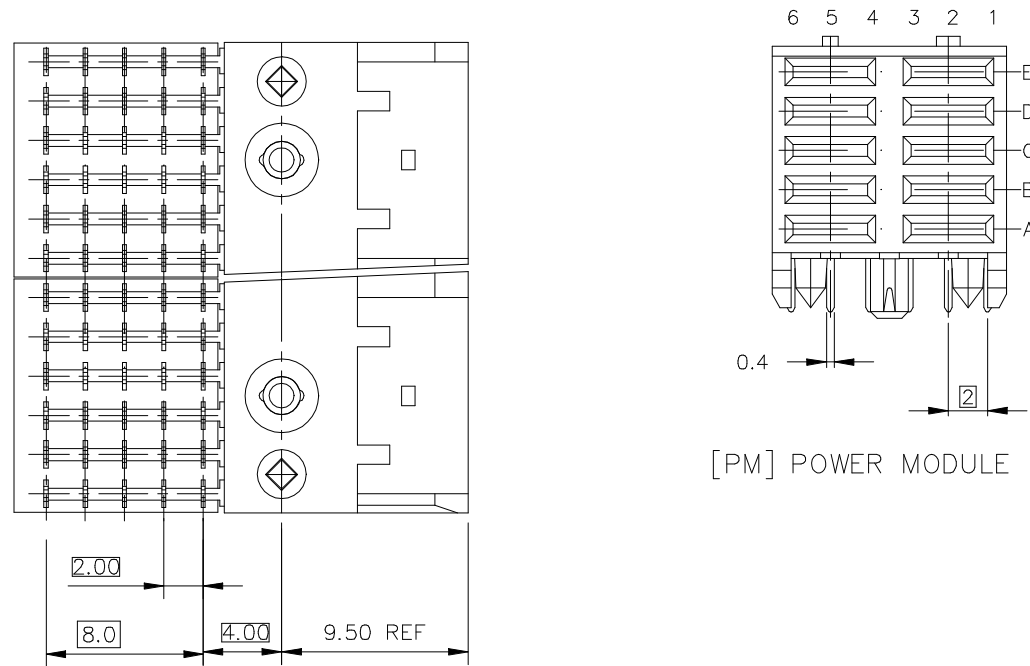

[PM] POWER MODULE

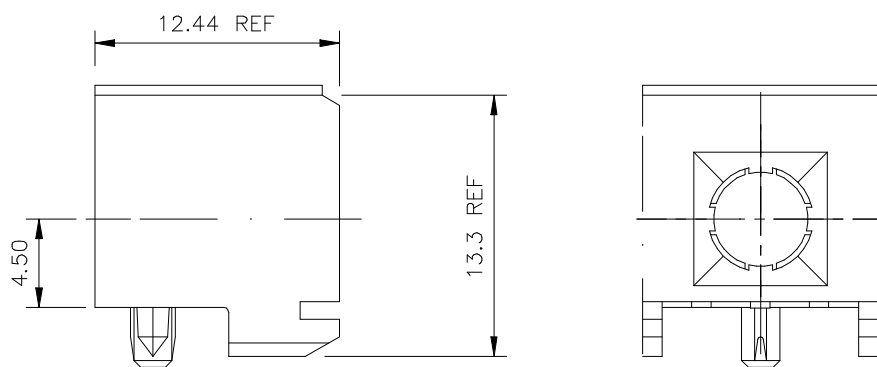

[HM] HYBRID MODULE

| TABLE 1 PLATED THRU HOLE REQUIREMENTS | |
|--|------------------------|
| HOLE DIAMETER AFTER PLATING | 0.65-0.80 |
| DRILLED HOLE | 0.81-0.86 (0.85 DRILL) |
| COPPER PLATING | 0.025 - 0.05 |
| SnPb PLATING | 0.005-0.015 |

SEE DRAWING 58351
FOR OTHER OPTIONS

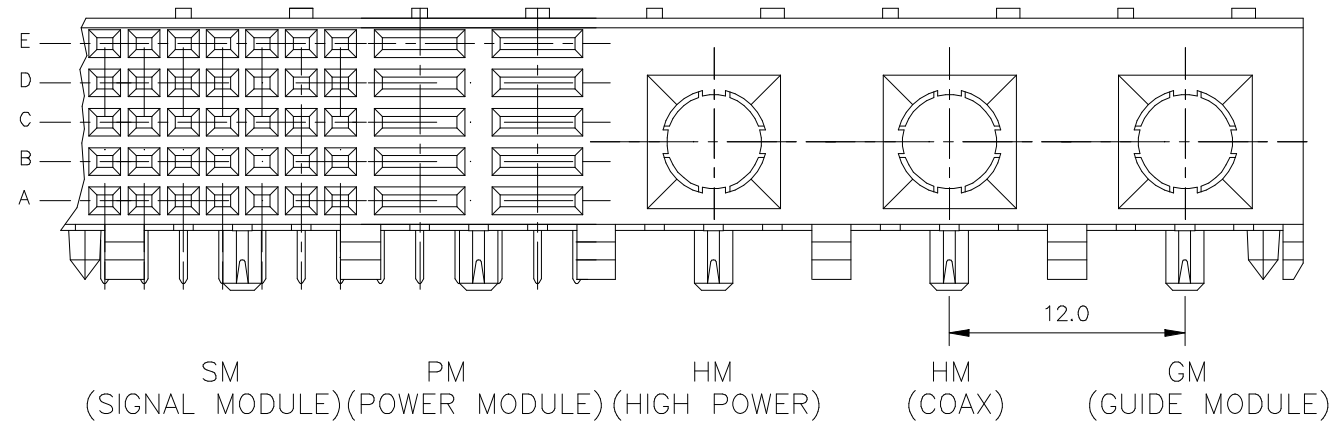

FOR ILLUSTRATION PURPOSES

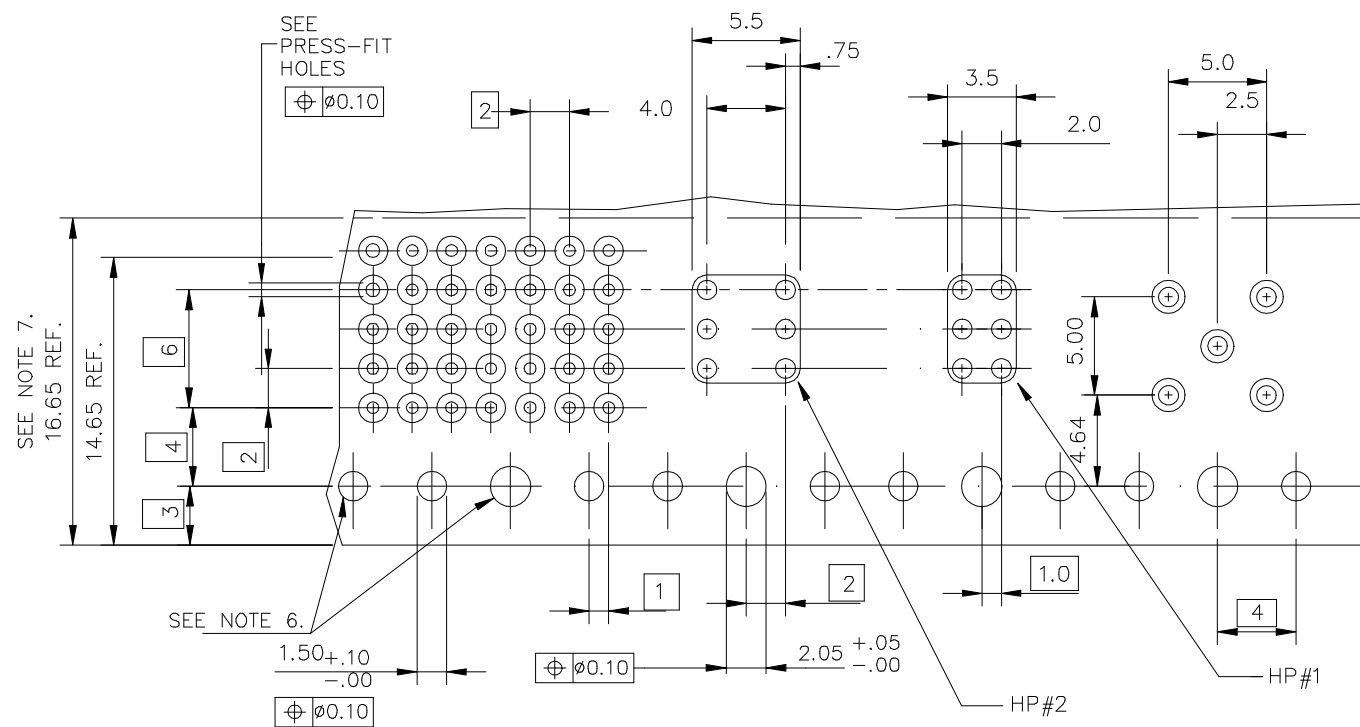

RECOMMENDED HOLE PATTERN,
COMPONENT SIDE.

| | | | | | | | | | | | |
|--------------------|--|----------------|--|---------------------------------------|--|----------------------------------|--|------------------|--|---|--|
| mat'l. code | | | | surface ISO 1302 | | tolerance ISO 406 ISO 1101 | | projection MM | | product family METRAL | |
| ltr ecn no dr date | | | | tolerances unless otherwise specified | | | | | | title R/A SIGNAL HYBRID RECEPTACLE - 36MM | |
| M | | | | angles linear | | .X ±.3 .XX ±.10 .XXX ±.050 | | scale 1:1 | | dwg no 73950 | |
| | | | | dr | | M.FETROW 7/2/97 | | Amphenol FCI | | sheet 2 of 3 size A3 | |
| | | | | enr | | C.PENDLETON 7/2/97 | | | | type Product Customer Drawing | |
| | | | | chr | | C.PENDLETON 7/2/97 | | | | | |
| | | | | appd | | C.PENDLETON 7/2/97 | | | | | |
| sheet index | | revision sheet | | | | | | | | | |

| PRODUCT NO | ASSY TYPE | TAIL LENGTH | ROW | 1 | | | | | 2 | | | | | 3 | | | | | 4 | | | | | 5 | | | | | 6 | | | | | | |
|---|-----------|-------------|-----|----------|----|----|----|----|----|----|----|----|---|-----|---|---|---|---|---|---|---|---|---|---|---|---|---|---|---|---|---|---|---|---|---|
| | | | | 18 | 17 | 16 | 15 | 14 | 13 | 12 | 11 | 10 | 9 | 8 | 7 | 6 | 5 | 4 | 3 | 2 | 1 | 6 | 5 | 4 | 3 | 2 | 1 | 6 | 5 | 4 | 3 | 2 | 1 | 6 | 5 |
| 73950-X001 SEE NOTE 11 FOR LEAD FREE OPTIONS | 1 | 3.53 | E | OBSOLETE | | | | | X | X | | | | | X | X | | | | | | | X | X | | | | | | | | | | | |
| | | | D | X | X | | | | X | X | | | | | X | X | | | | | | | | | X | X | | | | | | | | | |
| | | | C | X | X | | | | X | X | | | | | X | X | | | | | | | | | X | X | | | | | | | | | |
| | | | B | X | X | | | | X | X | | | | | X | X | | | | | | | | | X | X | | | | | | | | | |
| | | | A | X | X | | | | X | X | | | | | X | X | | | | | | | | | X | X | | | | | | | | | |
| MODULE TYPE | | | | HM | | | | | PM | | | | | PM. | | | | | | | | | | | | | | | | | | | | | |
| 73950-X002 SEE NOTE 11 FOR LEAD FREE OPTIONS | 1 | 3.53 | E | X | X | | | | X | X | X | X | X | X | X | X | X | X | X | X | X | X | X | X | X | X | X | X | X | X | X | | | | |
| | | | D | X | X | | | | X | X | X | X | X | X | X | X | X | X | X | X | X | X | X | X | X | X | X | X | X | X | X | | | | |
| | | | C | X | X | | | | X | X | X | X | X | X | X | X | X | X | X | X | X | X | X | X | X | X | X | X | X | X | X | X | | | |
| | | | B | X | X | | | | X | X | X | X | X | X | X | X | X | X | X | X | X | X | X | X | X | X | X | X | X | X | X | X | | | |
| | | | A | X | X | | | | X | X | X | X | X | X | X | X | X | X | X | X | X | X | X | X | X | X | X | X | X | X | X | X | | | |
| MODULE TYPE | | | | PM | | | | | SM | | | | | SM | | | | | | | | | | | | | | | | | | | | | |
| 73950-X003 SEE NOTE 11 FOR LEAD FREE OPTIONS | 3 | 3.53 | E | X | X | X | X | X | X | X | X | X | X | X | X | X | X | X | X | X | X | X | X | X | X | X | X | X | X | X | X | | | | |
| | | | D | X | X | X | X | X | X | X | X | X | X | X | X | X | X | X | X | X | X | X | X | X | X | X | X | X | X | X | X | | | | |
| | | | C | X | X | X | X | X | X | X | X | X | X | X | X | X | X | X | X | X | X | X | X | X | X | X | X | X | X | X | X | X | | | |
| | | | B | X | X | X | X | X | X | X | X | X | X | X | X | X | X | X | X | X | X | X | X | X | X | X | X | X | X | X | X | X | | | |
| | | | A | X | X | X | X | X | X | X | X | X | X | X | X | X | X | X | X | X | X | X | X | X | X | X | X | X | X | X | X | X | | | |
| MODULE TYPE | | | | SM | | | | | SM | | | | | SM | | | | | | | | | | | | | | | | | | | | | |
| 73950-X004 SEE NOTE 11 FOR LEAD FREE OPTIONS | 3 | 2.90 | E | - | X | - | X | - | X | X | X | X | X | X | X | X | X | X | X | X | X | X | X | X | X | X | X | X | X | X | | | | | |
| | | | D | - | - | - | - | - | X | X | X | X | X | X | X | X | X | X | X | X | X | X | X | X | X | X | X | X | X | X | | | | | |
| | | | C | - | X | - | X | - | X | X | X | X | X | X | X | X | X | X | X | X | X | X | X | X | X | X | X | X | X | X | X | | | | |
| | | | B | - | - | - | - | - | X | X | X | X | X | X | X | X | X | X | X | X | X | X | X | X | X | X | X | X | X | X | X | | | | |
| | | | A | - | X | - | X | - | X | X | X | X | X | X | X | X | X | X | X | X | X | X | X | X | X | X | X | X | X | X | X | X | | | |
| MODULE TYPE | | | | SM | | | | | SM | | | | | SM | | | | | | | | | | | | | | | | | | | | | |
| 73950-X005 SEE NOTE 11 FOR LEAD FREE OPTIONS | 3 | 2.90 | E | X | X | | | | | | | | | | X | X | | | | | | | X | X | | | | | | | | | | | |
| | | | D | X | X | | | | | | | | | | | X | X | | | | | | | X | X | | | | | | | | | | |
| | | | C | X | X | | | | | | | | | | | X | X | | | | | | | X | X | | | | | | | | | | |
| | | | B | X | X | | | | | | | | | | | X | X | | | | | | | X | X | | | | | | | | | | |
| | | | A | X | X | | | | | | | | | | | X | X | | | | | | | X | X | | | | | | | | | | |
| MODULE TYPE | | | | PM | | | | | HM | | | | | PM. | | | | | | | | | | | | | | | | | | | | | |
| 73950-X006 SEE NOTE 11 FOR LEAD FREE OPTIONS | 3 | 2.90 | E | X | X | | | | X | X | X | X | X | X | X | X | X | X | X | X | X | X | X | X | X | X | X | X | X | X | | | | | |
| | | | D | X | X | | | | X | X | X | X | X | X | X | X | X | X | X | X | X | X | X | X | X | X | X | X | X | X | X | | | | |
| | | | C | X | X | | | | X | X | X | X | X | X | X | X | X | X | X | X | X | X | X | X | X | X | X | X | X | X | X | | | | |
| | | | B | X | X | | | | X | X | X | X | X | X | X | X | X | X | X | X | X | X | X | X | X | X | X | X | X | X | X | | | | |
| | | | A | X | X | | | | X | X | X | X | X | X | X | X | X | X | X | X | X | X | X | X | X | X | X | X | X | X | X | | | | |
| MODULE TYPE | | | | PM | | | | | SM | | | | | PM | | | | | | | | | | | | | | | | | | | | | |

- NOTES:
- CONNECTOR MATERIALS:
HOUSING: LCP, 30% GLASS FILLED, UL 94-V0 COMPLIANT
TERMINAL: PHOSPHOR BRONZE ALLOY
 - PLATING ON TAIL:
PRESS-FIT TYPE
73950-YYY IS 0.5-1.5um SnPb
73950-YYLF IS 0.5-1.5um Sn (LEAD FREE)
SOLDER-TO-BOARD TYPE
73950-YYY IS 2-8um SnPb
73950-YYLF IS 2-8um Sn (LEAD FREE)
 - PRODUCT SPECIFICATION:
GS-12-002
 - APPLICATION SPECIFICATIONS:
BUS-20-061
GS-20-001
TA-941
 - PRODUCT MARKING: (PART NUMBER & LOT CODE).
 - INDICATED HOLES ARE UNPLATED.
 - LOCATION PEG FEATURES MAY NOT BE AVAILABLE AS SHOWN FOR ASSYS W/ PRESS PEGS.
 - TOP SURFACE OF PRESS BLOCK MAY EXTEND UP TO 0.4MM HIGHER THAN HOUSING. THIS MAY AFFECT THE TAIL LENGTH BEFORE APPLICATION TO A BOARD.
 - DIMENSION APPLIES TO BOTH PRESS-FIT AND SOLDER TAIL TERMINATIONS.
 - THESE PRODUCTS WHERE THE PART NUMBER ENDS IN "LF" MEET THE EUROPEAN UNION DIRECTIVES AND OTHER COUNTRY REGULATIONS AS DESCRIBED IN GS-22-008.

ALL PRODUCTS MANUFACTURED BEFORE APRIL 2006 WILL WITHSTAND EXPOSURE TO 240°C FOR 60 SECONDS IN A CONVECTION, INFAR-RED OR VAPOR PHASE REFLOW OVEN.

ALL PRODUCTS MANUFACTURED AFTER MARCH 2006 WILL WITHSTAND EXPOSURE TO 260°C FOR 60 SECONDS IN A CONVECTION, INFAR-RED OR VAPOR PHASE REFLOW OVEN.
 - FOR LEAD FREE PART NUMBERS ADD "LF" SUFFIX. EXAMPLE: 73950-YYYYLF.
 - FOR THE PRODUCT WITH 30u" GOLD PLATING IN TERMINAL, THEY CAN BE REPLACED BY 30 GXT PLATING.

| LOAD PATTERN | |
|--------------|-------------------|
| X | LOADED |
| - | NOT LOADED |
| HP#1 | PWR. CONN .LOADED |

| | | | | |
|-------------|--------------------|----------------------------------|------------|-------------------------------------|
| mat'l. code | surface ISO 1302 ✓ | tolerance ISO 406 ISO 1101 | projection | product family METRAL |
| ltr | ecn no | dr | date | title |
| M | | | | R/A SIGNAL HYBRID RECEPTACLE - 36MM |
| | angles | linear | scale 1:1 | MM |
| | 0° ±2' | .X ±.3 .XX ±.10 .XXX ±.050 | | |
| | dr | M.FETROW | 7/2/97 | dwg no sheet 3 of 3 size |
| | enr | C.PENDLETON | 7/2/97 | 73950 A3 |
| | chr | C.PENDLETON | 7/2/97 | type Product Customer Drawing |
| | appd | C.PENDLETON | 7/2/97 | |
| sheet index | revision sheet | | | |

Amphenol FCI
 © 2016 AFCI
 D