

**NOTES:**

- MATERIALS:**  
CONNECTOR HOUSING: HIGH TEMPERATURE THERMOPLASTIC  
GLASS FILLED, UL94V-0  
COLOR: BLACK  
EMI HOUSING: DIE CAST ALLOY, NICKEL PLATED FINISH  
TERMINALS: COPPER ALLOY  
COVER: STAINLESS STEEL ALLOY  
EMI GASKET: CONDUCTIVE POLYMER
- PLATING:**  
CONTACT AREA: 0.764mm MIN. GOLD OVER 2.544mm MIN. NICKEL  
COMPLIANT AREA: 0.76-1.524mm TIN OVER 1.274mm MIN. NICKEL
- PACKAGING SPECIFICATION:** TRAY PACK PER PK-76024-001
- MOUNTING HARDWARE:** M2x8mm CAP SCREWS (NOT SUPPLIED)
- THIS CONNECTOR IS DESIGNED TO MATE WITH MOLEX CABLE SERIES 111025**
- THIS CONNECTOR IS FOR PASSIVE COPPER CABLES ONLY**  
NO OPTICAL MODULES OR ACTIVE COPPER CABLES

<b>ADD LOCKING EMI_F</b> EC NO: UCP2014-4635 DRAWING: GPRATT 2014/05/09 CHK'D: MBANAKIS 2014/05/09 APPR: MBANAKIS 2014/08/05	QUALITY SYMBOLS ∇=0 ∇=0 ∇=0	GENERAL TOLERANCES (UNLESS SPECIFIED)		DIMENSION STYLE <b>MM ONLY</b>	SCALE <b>2:1</b>	DESIGN UNITS <b>METRIC</b>	THIRD ANGLE PROJECTION
		4 PLACES ± --- ± ---	DRAWN BY K. LANG	DATE 2008/06/12	TITLE <b>IPASS PLUS HSC 84/84 HIGH SPEED CHANNEL 0.8MM I/O</b>	<b>molex</b> DOCUMENT NO. <b>SD-76024-568</b> SHEET NO. <b>1 OF 4</b>	
		3 PLACES ± --- ± ---	CHECKED BY GPRATT	DATE 2014/05/1			
		2 PLACES ± 0.25 ± ---	APPROVED BY M. BANAKIS	DATE 2008/07/21			
1 PLACE ± --- ± ---	MATERIAL NO. <b>760240569</b>						
0 PLACE ± --- ± ---	ANGULAR ±1/2°		DRAFT WHERE APPLICABLE MUST REMAIN WITHIN DIMENSIONS		THIS DRAWING CONTAINS INFORMATION THAT IS PROPRIETARY TO MOLEX INCORPORATED AND SHOULD NOT BE USED WITHOUT WRITTEN PERMISSION		

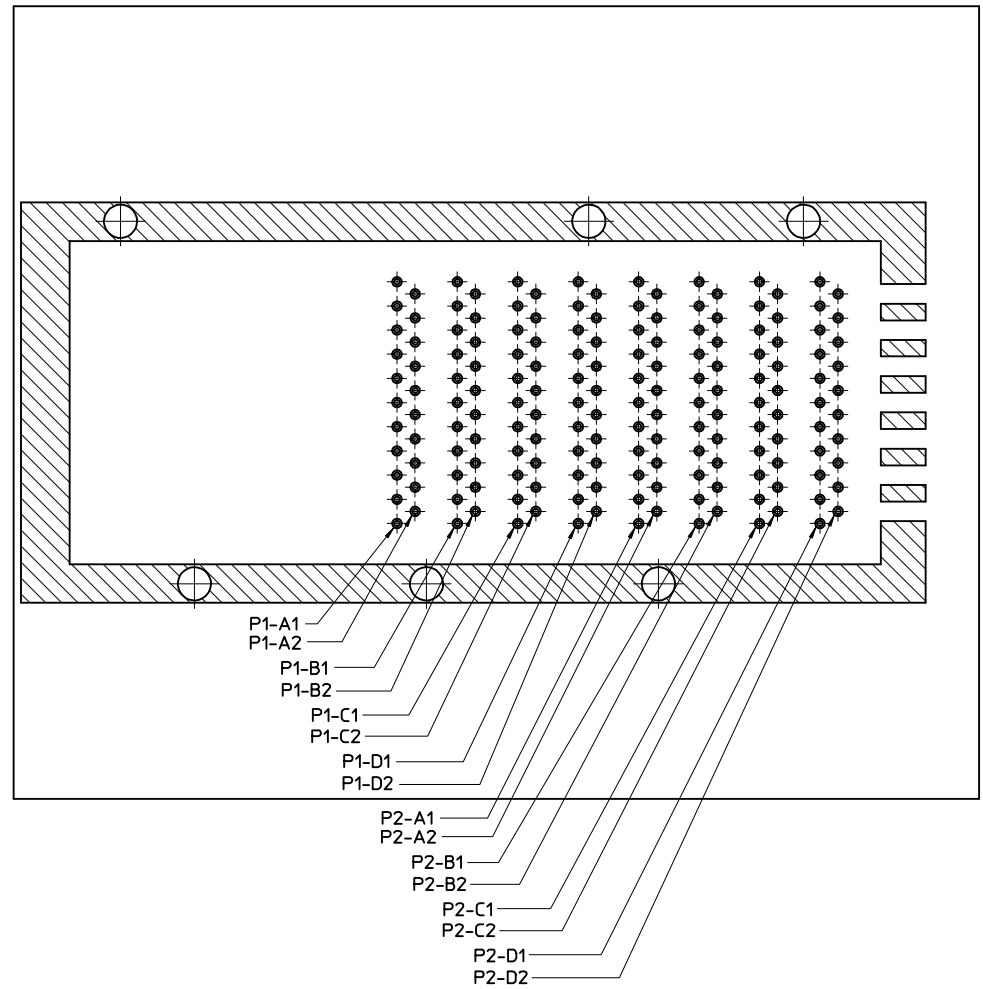

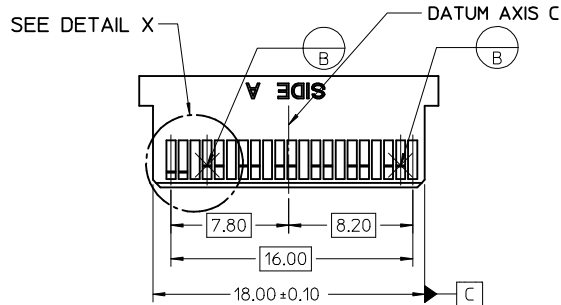
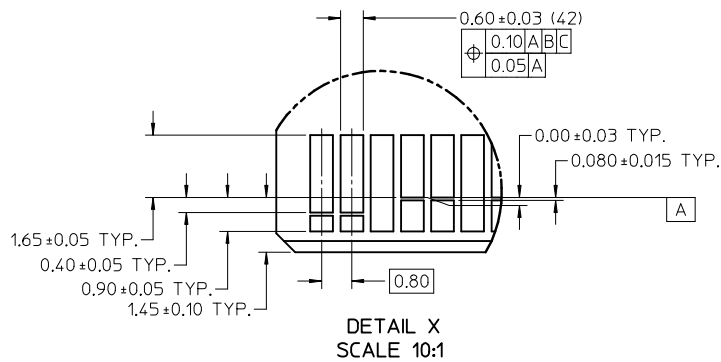
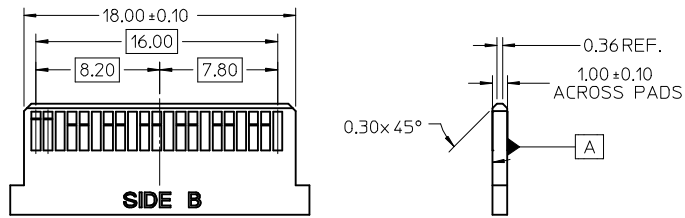

- NOTES:
- 0.03 MINIMUM KEEPOUT FOR SOLDER MASK AROUND ALL PADS
  - DATUM B TARGETS ARE DEFINED BY THE RESPECTIVE PAD CENTER LINES AND THE LEADING EDGE OF THE TARGET PADS

SEE SHEET 1 EC NO: UCP2014-4635 DRAWING: GPRATT 2014/05/09 CHKD: MBANAKIS 2014/05/09 APPR: MBANAKIS 2014/08/05	QUALITY SYMBOLS ▽=0 ▽=0 ▽=0	GENERAL TOLERANCES (UNLESS SPECIFIED)		DIMENSION STYLE MM ONLY	SCALE 4:1	DESIGN UNITS METRIC	THIRD ANGLE PROJECTION												
		4 PLACES ± --- ± ---	3 PLACES ± --- ± ---	2 PLACES ± 0.25 ± ---	1 PLACE ± --- ± ---	0 PLACE ± --- ± ---	ANGULAR ± 1/2°	DRAFT WHERE APPLICABLE MUST REMAIN WITHIN DIMENSIONS	DRAWN BY K. LANG	DATE 2008/06/12	CHECKED BY GPRATT	DATE 2014/05/09	APPROVED BY M. BANAKIS	DATE 2008/07/21	TITLE IPASS PLUS HSC 84/84 HIGH SPEED CHANNEL 0.8MM I/O	<b>molex</b>	DOCUMENT NO. SD-76024-568	SHEET NO. 3 OF 4	
MATERIAL NO.		SEE SHEET 1		THIS DRAWING CONTAINS INFORMATION THAT IS PROPRIETARY TO MOLEX INCORPORATED AND SHOULD NOT BE USED WITHOUT WRITTEN PERMISSION															

