

LOC		DIST		REVISIONS				DATE	APPD
ZONE	LTR	DESCRIPTION	DATE	APPD					
AA	22			H	REV; EC 0502-0711-97		23OCT97	DS EL	

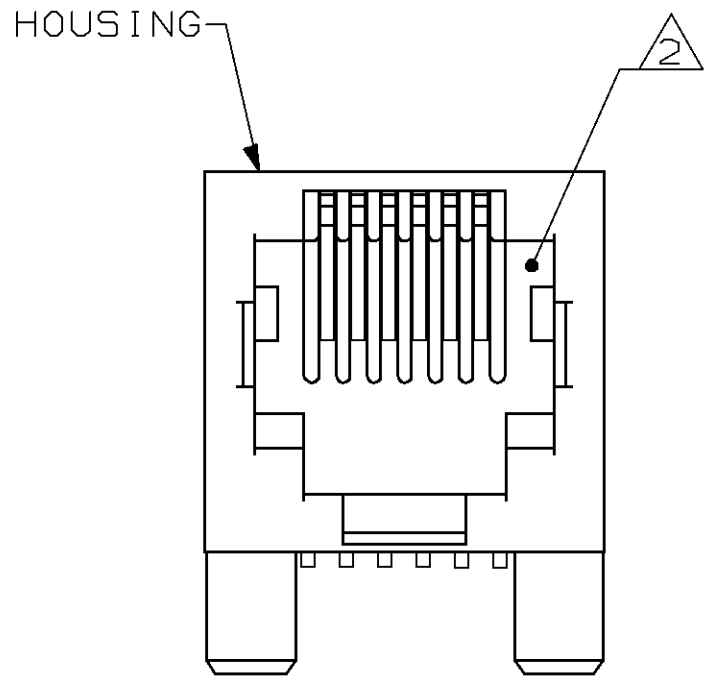

- 1 MATERIAL: HOUSING- HTN MOLDING COMPOUND, 94V0, BLACK.
 TERMINAL- 0.35 [.0138] THICK PHOS BRONZE PLATED WITH 1.27µm [.000050] THICK HARD GOLD IN LOCALIZED GOLD PLATE AREA AND 2.03µm [.000080] THICK TIN-LEAD IN SOLDER AREA OVER 1.27µm [.000050] THICK NICKEL UNDERPLATE.
- 2 CAVITY CONFORMS TO FCC RULES AND REGULATIONS PART 68, SUBPART F.
- 3. SNAP-IN RETENTION FEATURE ACCOMMODATES A 1.57±0.13 [.062±.005] PRINTED CIRCUIT BOARD.
- 4 DIMENSIONS ARE MAXIMUM UNLESS OTHERWISE SPECIFIED AND ARE PRIOR TO SURFACE MOUNT PROCESSING.
- 5 TERMINALS SHALL BE ASSEMBLED IN CENTER POSITIONS FOR -2.
- 6 - 2 PACKAGED 42 ASSEMBLIES PER TUBE.

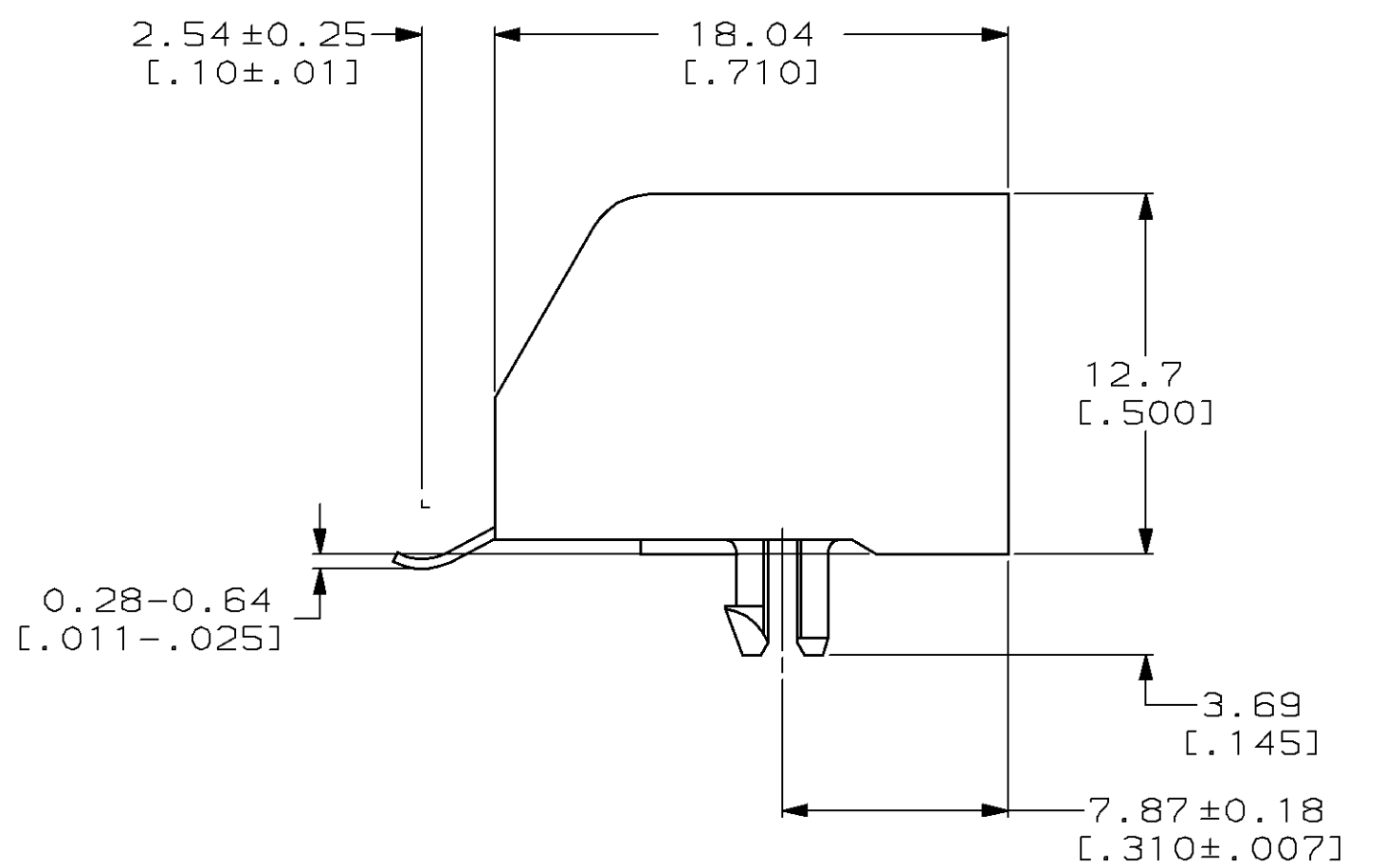
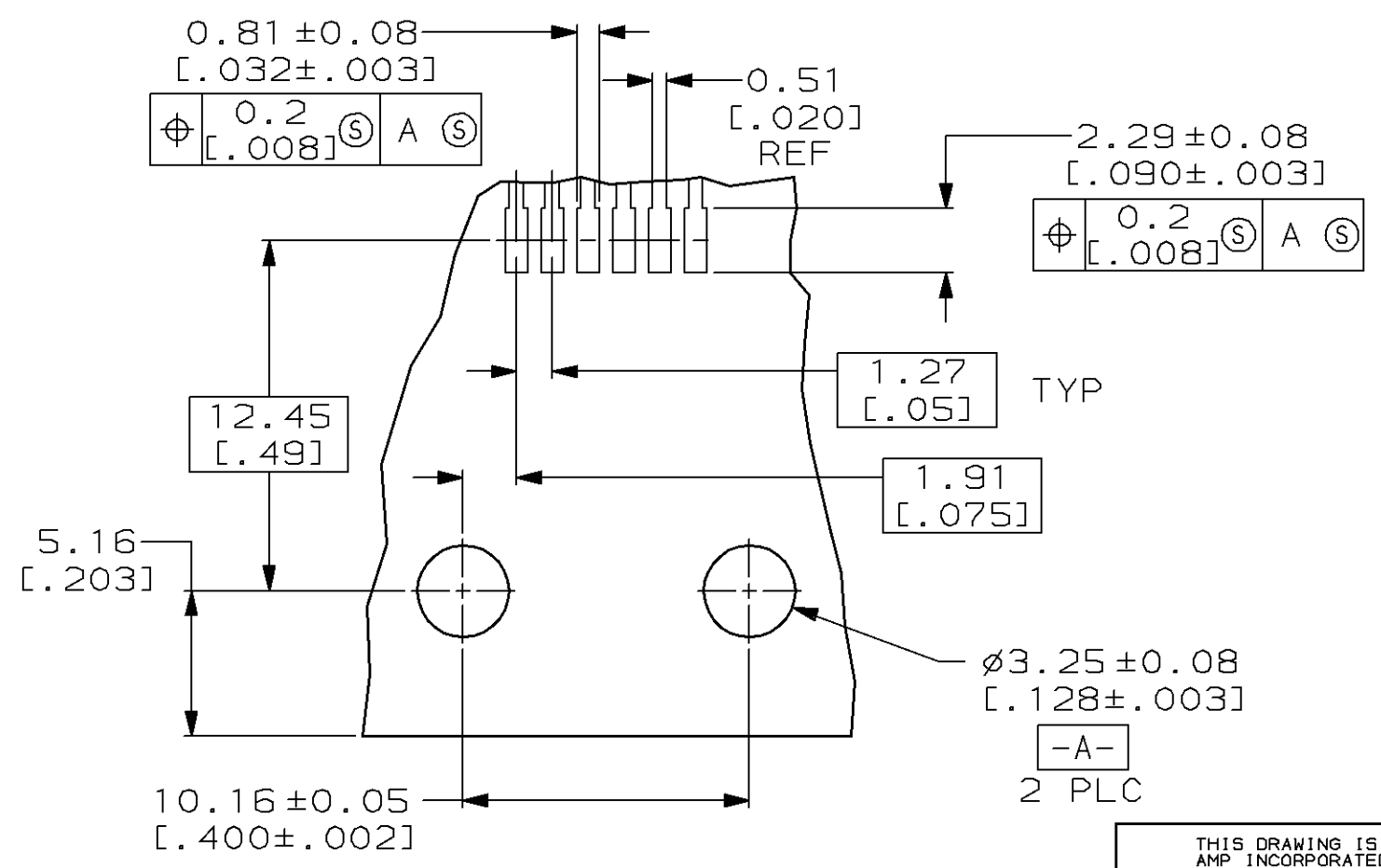
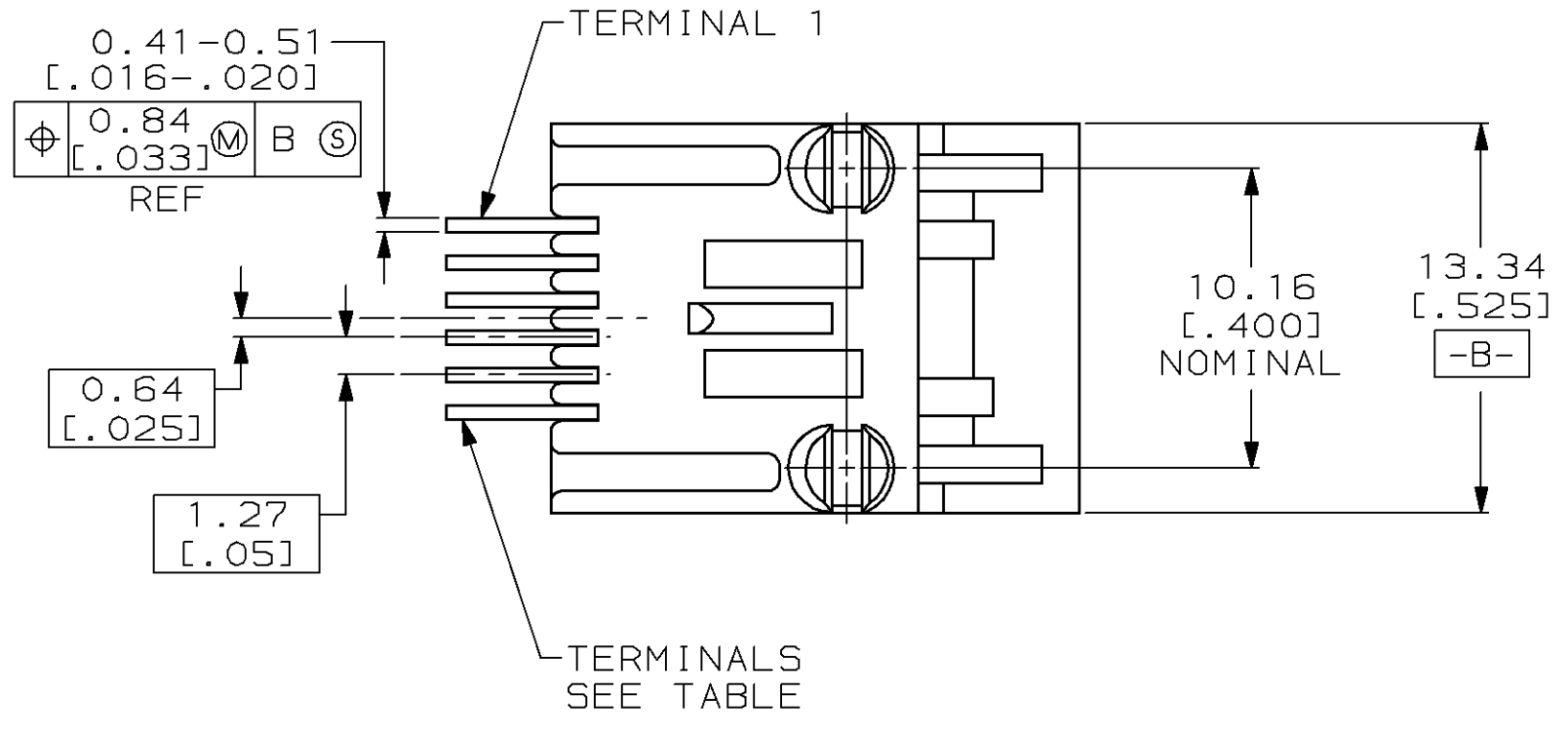

DO NOT SCALE PRINT. UNLESS SPECIFIED DIMENSIONS IN mm [INCHES] TOLERANCES ON: 2 PLC DEC ±- 4 3 PLC DEC ±- ANGLES ±-	DR 12-05-94 L. SMITH	AMP Incorporated Harrisburg, PA 17105-3608	
	CHK 12-09-94 C. WHITT		
MATERIAL	APPD 12-16-94 J. TONEY	NAME MODULAR JACK ASSEMBLY, 6 POSITION, LOW PROFILE, RIGHT ANGLE, SURFACE MOUNT	
FINISH	APPD 12-16-94 H. MCGRATH	SIZE	CAGE CODE
	PRODUCT SPEC 108-1163	C	00779
	APPLICATION SPEC 114-6040	DRAWING NO	G=557314
	WEIGHT -	SCALE	4:1
		SHEET	1 OF 1

THIS DRAWING IS A CONTROLLED DOCUMENT FOR AMP INCORPORATED. IT IS SUBJECT TO CHANGE AND THE CONTROLLING ENGINEERING ORGANIZATION SHOULD BE CONTACTED FOR THE LATEST REVISION.