

This document is the property of Amphenol Corporation and is delivered on the understanding that it is not to be distributed, reproduced or used, in whole or in part, for manufacture or sale by anyone other than Amphenol Corporation without the prior consent, & that no right is granted to distribute or to use any information in this document.

REVISIONS				
SYM	ECN	DESCRIPTION	DATE	APPROVED
A	HK000X	INITIAL RELEASE	4/15/05	Michael.P

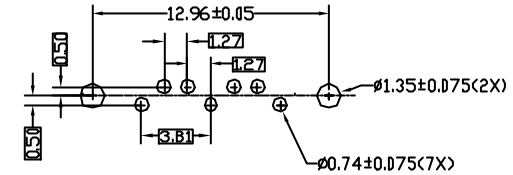
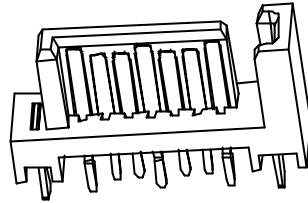
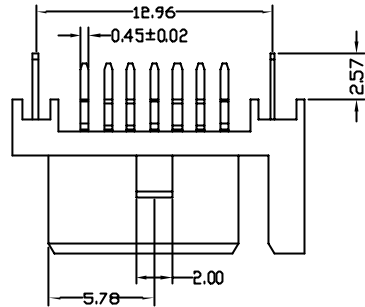

RECOMMENDED PCB LAYOUT
(PCB THICKNESS 1.6mm OR 2.0mm)

NOTE:

- MATERIAL:**
 HOUSING: FR-6145, UL 94 V-0, BLACK;
 CONTACTS: COPPER ALLOY T=0.25mm;
 CONTACT FINISHED: 1.27-2.54um. NICKEL UNDER PLATED ON ENTIRE CONTACT;
 SEE NOTES 4 FOR GOLD PLATING ON MATING AREA;
 2.54-5.08um MATTE TIN PLATED ON TAIL AREA;
 SOLDER TAB: BRASS, t=0.25;
 SOLDER TAB FINISHED: 2.54-5.05um TIN OVER 1.27um MIN. NICKEL;

- SPECIFICATIONS:**
 RATED CURRENT: SIGNAL PIN 1.5A MIN
 POWER PIN 1.5A MIN
 DIELECTRIC STRENGTH: 1000V FOR 1 MINUTE
 INSULATION RESISTANCE: $1 \times 10^5 \text{ M}\Omega$
 TEMPERATURE: -40°C TO +105°C
 CONTACT RESISTANCE: 30mΩ MAX
 PIN RETENTION FORCE: 10N MIN. TOTAL (2.25 LB)

- PACKAGE: PACKING WITH TRAY.**

- ORDERING INFORMATION:**

SATA - 011 - 2017 - X

- GOLD PLATING ON MATING AREA:
 1: 0.76 um MIN.
 2: 0.38 um MIN.
 3: GOLD FLASH

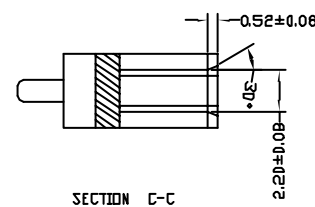
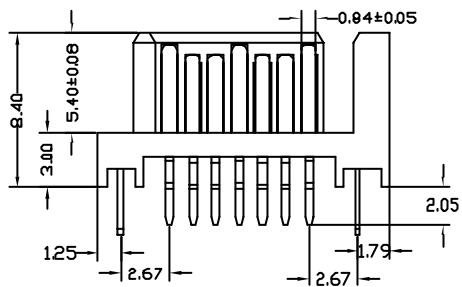
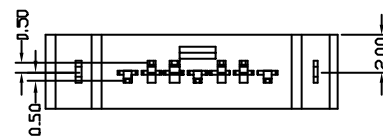
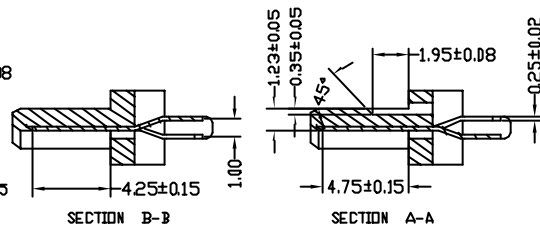
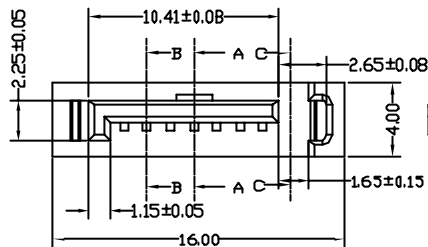

Customer Drawing

UNLESS OTHERWISE SPECIFIED		APPROVAL		DATE	Amphenol
TOLERANCES		DRAWN: Tom.feng	4/15/05		
U.S. METRIC:		CHECKED: Michael.P	4/15/05		TITLE SATA 7 PINS
X +/- 0.3		DRAWING FILE:			
XX +/- 0.15		DRAWING FILE: \DRAWING\DATA\DRAWING\2017\20170405			
XXX +/-		ANGLE OF PROJECTION			
FRACTIONS +/- 2'					
ANGLES +/-		SIZE: DRAWING NO.			
REMOVE SHARP EDGES		A3C SATA-011-2017-X			
DIMENSIONS		SCALE: NONE			
U.S. METRIC:		SHEET 1 OF 1			
(mm) (mm)					