

WIRE RANGE	12-10 AWG STRANDED	E13288 Listed
WIRE RANGE	12-10 AWG STRANDED	MILITARY P/N AND CLASS
NOT CERTIFIED	LR7189 Certified	NOT APPLICABLE

△ STAMP AMP 12-10* APPROX AS SHOWN

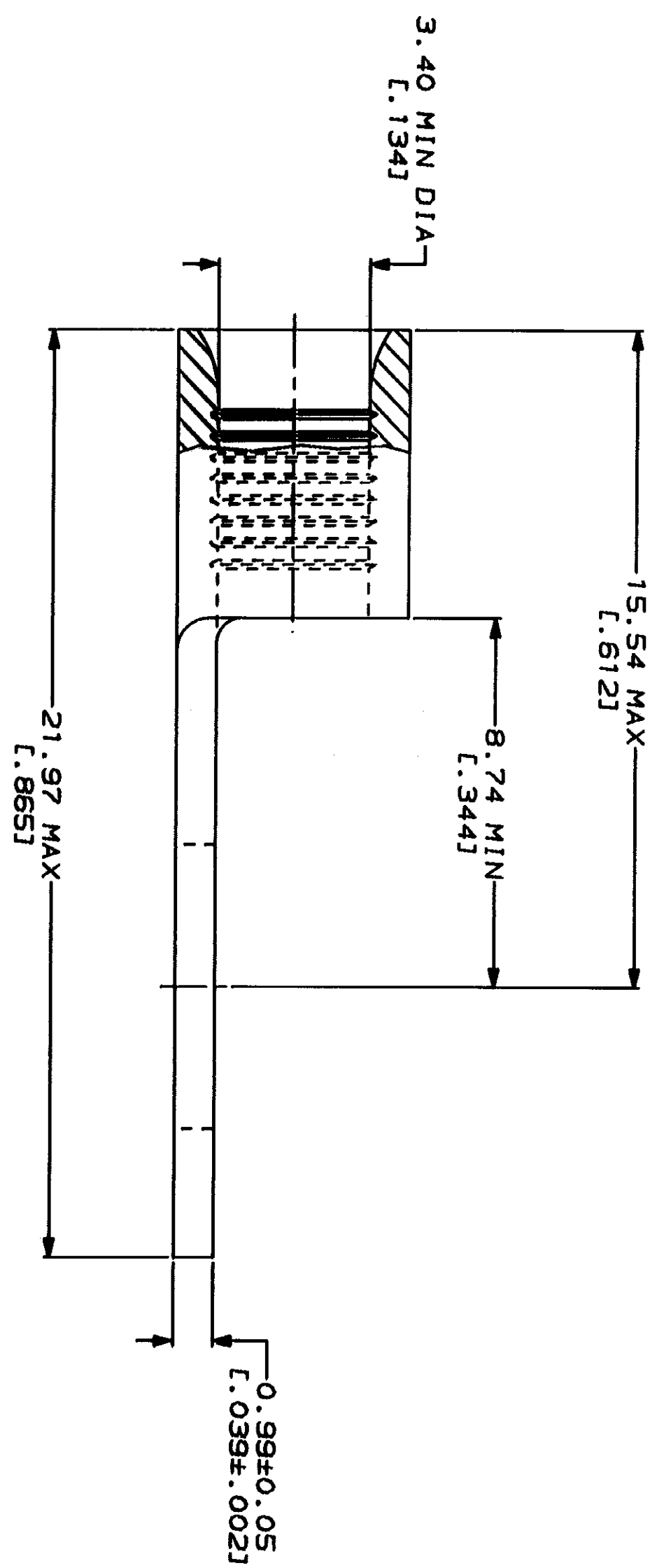

AMP INCORPORATED
CUSTOMER SERVICE SYSTEMS

FOR ADDITIONAL
PRODUCT INFORMATION OR
COPIES OF DRAWINGS
AND TECHNICAL DOCUMENTS

FOR APPLICATION
TOOLING INFORMATION

FOR ORDER ENTRY

MAX RECOMMENDED OPERATING
TEMPERATURE: 170°C MAX

VOLTAGE RATING:
NOT APPLICABLE

WIRE CROSS SECTIONAL AREA RANGE:
STRANDED
2.62-6.64mm² [5,180-13,100] CIR MILS

THIS DRAWING IS A CONTROLLED DOCUMENT FOR
AMP INCORPORATED. IT IS SUBJECT TO CHANGE
WITHOUT NOTICE. FOR THE LATEST REVISION
SEE THE DRAWING FOR THE LATEST REVISION.

DO NOT SCALE PRINT.
UNLESS SPECIFIED
DIMENSIONS IN MILLIMETERS
TOLERANCES ON:
2 PLG DEC ± .05
3 ANGLES ± .05
PATTERN

COPPER PER
ASTM B-152
ANNEALED

FINISH: TIN PLATE
0.00254 [L.000100] MIN
THK PER MIL-T-10727

DR 2-9-93
TA BRINKMAN

CHK 2-9-93
DA PATTERSON

APPD 2-9-93
DE MILLER

APPD 2-9-93
JL NECKLEY

PRODUCT SPEC

APPLICATION SPEC

WEIGHT



AMP Incorporated
Harrisburg, PA 17105-3608

TERMINAL, RING TONGUE,
BUDGET

SIZE: 8:1
CAGE CODE: 00779
DRAWING NO: 34965

34965
PART NO

34965

CUSTOMER DRAWING