

THIS DRAWING IS UNPUBLISHED. RELEASED FOR PUBLICATION
 © COPYRIGHT - By - ALL RIGHTS RESERVED.

LOC	DIST	REVISIONS			
P	LTR	DESCRIPTION	DATE	DWN	APVD
AF	50				
	A4	REVISED PER ECR-18-003610	07MAY2018	BDA	SV

- 1 CONTINUOUS STRIP ON REELS WITH TERMINALS LOCATED ON 5.59±0.08 [.220±.003] CENTERS.
- 2 SLOT TERMINATES EITHER A SINGLE OR DOUBLE MAGNET WIRES OF THE SAME TYPE AND SIZE, COPPER RANGE: 0.29-0.40mm [#29-#26] AWG. ALUMINUM RANGE: 0.36-0.51mm [#27-#24] AWG (THE ALUMINUM RANGE ARE TENTATIVE VALUES AND TO BE VERIFIED BY TE)

IDENTIFICATION NUMBER 7 FOR MAGNET WIRE RANGE

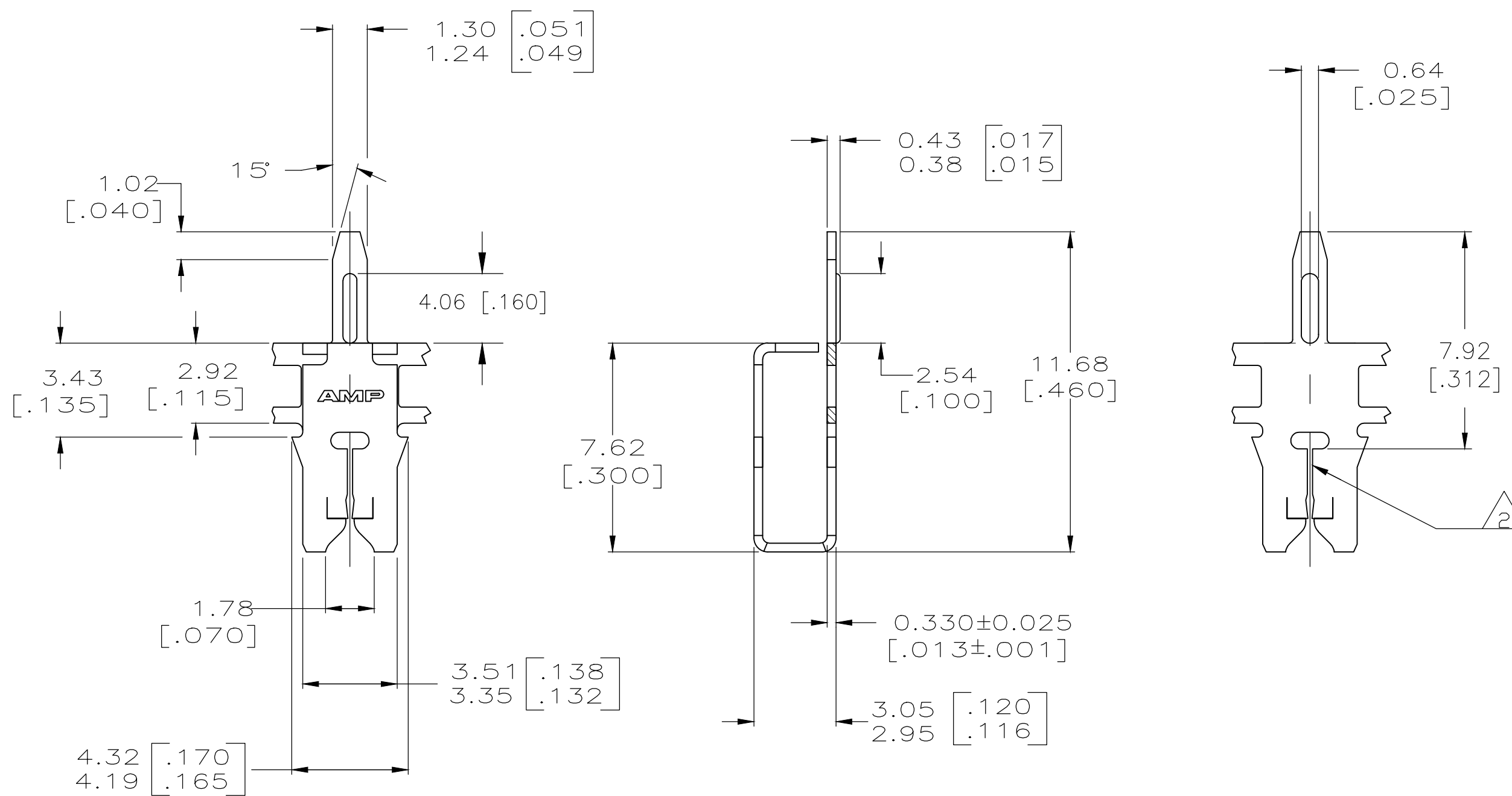
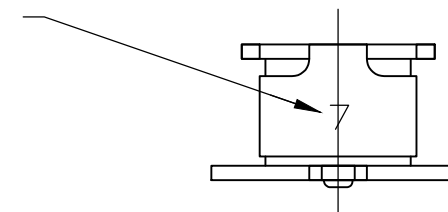

1742940-1
PART NUMBER

THIS DRAWING IS A CONTROLLED DOCUMENT.		DWN	jr ruth	15NOV11		TE Connectivity				
DIMENSIONS: INCHES		CHK	KURT RANDOLPH	15NOV11		NAME				
TOLERANCES UNLESS OTHERWISE SPECIFIED:		APVD	KURT RANDOLPH	15NOV11		PRODUCT SPEC				
0 PLC ± - 1 PLC ± - 2 PLC ± 0.25 [.010] 3 PLC ± - 4 PLC ± - ANGLES ± 1°		APPLICATION SPEC		108-2012		SIZE		CAGE CODE	DRAWING NO	RESTRICTED TO
MATERIAL: BRASS		FINISH: TIN PLATE		WEIGHT		A2 00779		C=1742940		-
CUSTOMER DRAWING						SCALE: 6:1		SHEET: 1 of 1		REV: A4