

LOADING PATTERN MATING SIDE

f	K	K	K	K	K	K	K	K	K	K	K	K	K	K	K	K	K	0	0	0	0	0	0
e	F	F	F	F	F	F	F	F	F	F	F	F	F	F	F	F	F	0	F	0	F	F	F
d	F	F	F	F	F	F	F	F	F	F	F	F	F	F	F	F	F	0	F	0	0	0	0
c	5	5	5	5	5	5	5	5	5	5	5	5	5	5	5	5	5	0	F	0	F	F	F
b	F	F	F	F	F	F	F	F	F	F	F	F	F	F	F	F	F	0	0	0	0	0	0
a	5	5	5	5	5	5	5	5	5	5	5	5	5	5	5	5	F	F	0	F	F	F	F
z	K	K	K	K	K	K	K	K	K	K	K	K	K	K	K	K	0	0	0	0	0	0	0
P	0	0	1	1	2	2																	
S	1	5	0	5	0	5																	

LOADED CONNECTOR ASSEMBLY
(FOR EXAMPLE)

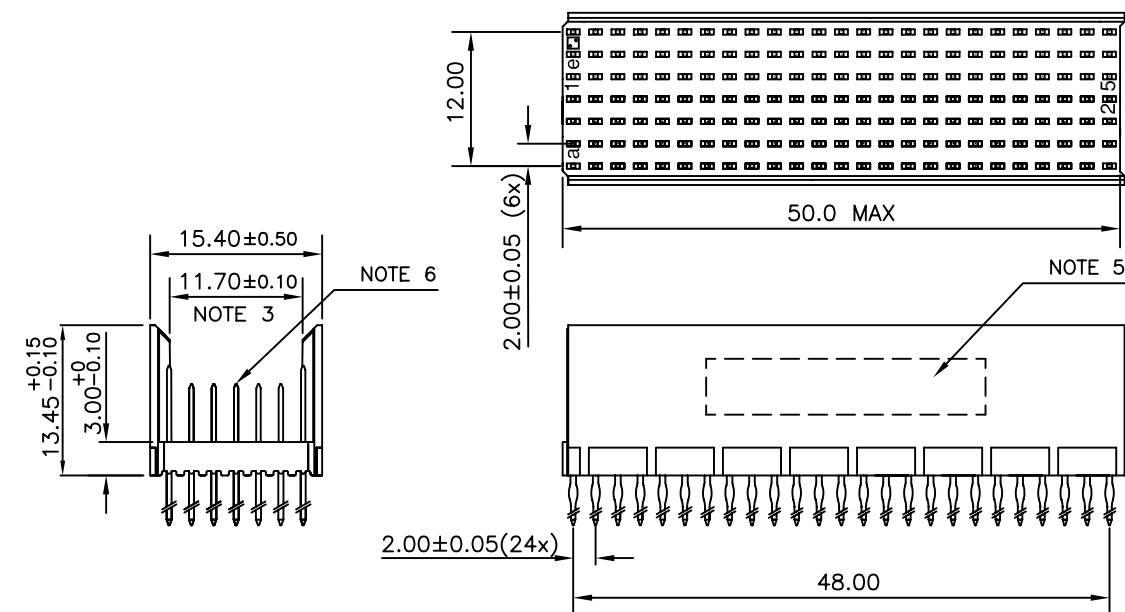

CONTACT OVERVIEW

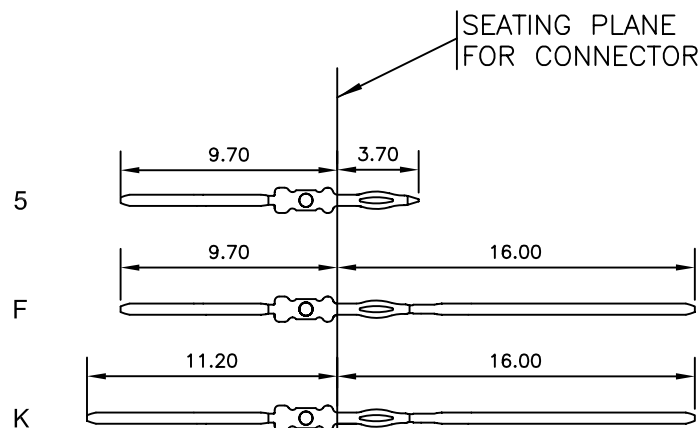

LAY-OUT P.C.B.-HOLE

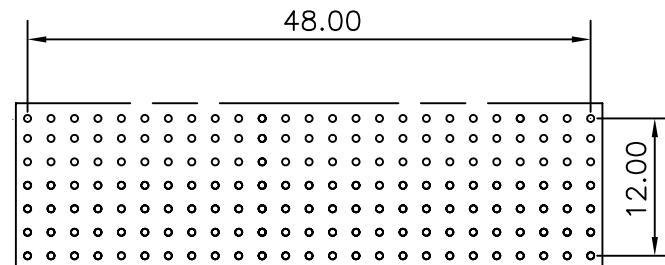

LEAD FREE INDICATOR : LF = LEAD FREE
(DIGIT 15 & 16)

HM2P08PNJ395

PLATING CODE (DIGIT 13 AND 14)
(REF DRW NO. BS,C , 201844 , 003)

NOTES

- THIS PRODUCT IS CSA APPROVED.
- THIS PRODUCT IS UL RECOGNIZED.
- MEASURED AT THE BOTTOM.
- MATERIAL CONTACT: PHOSPHORBRONZE
HOUSING: CREAM WHITE GLASS FILLED POLYESTER UL-94V0
- CONNECTOR PRINTED WITH P/N AND DATE CODE.
- FOR ACTUAL CONTACT LOADINGS, SEE LOADING PATTERN MATING SIDE.
- SHAPE OF CONNECTOR HOUSING CAN ALTER DEPENDING ON PRODUCTION LOCATION
- THE PRODUCT (LF) MEETS EUROPEAN UNION DIRECTIVES AND OTHER COUNTRY REGULATIONS AS DESCRIBED IN GS-22-008
- FOR RECOMMENDED PTH DIMENSIONS REFER DRAWING : BS, A , 201572 , 001

CATALOG NO: HM2P08PNJ395----

mat'l. code SEE NOTE 4		surface ISO 1302 ✓	tolerance ISO 406 ISO 1101	projection 	product family MILLIPACS
ltr	ecn no	dr	date	title MPACS 5+2R STR HDR PF CONN TYPE B	
A	106-0184	MINI	2006-10-06	scale —	
		angles	linear		
		0°±1°	.0±0.2 .00±0.1 .000±.00X		
		dr	MINI K VANDANATH 2006-10-06	dwg no sheet 1 of 1 size 5	
		enr	BIJU K PAUL 2006-10-06	BS, C , 203028, 731 A3	
		chr	BIJU K PAUL 2006-10-06	type Product Customer Drawing	
		appd	BIJU K PAUL 2006-10-06		
sheet index	revision sheet	A	1		